

# What is the function in Excel that retrieves the current date and time?

Do you want to enter today's date into several cells in your Excel spreadsheet? Or are you looking to mark the current date in your Excel calendar? All of this can be done using the TODAY function in Excel. This article will share the formula and illustrative examples to easily use the TODAY function to retrieve the current date in Excel.

In Excel, date, month, and year data can be entered directly by hand or using built-in Excel formulas. So, what is **the function to get the current date in Excel** ? How do you use it? TipsMake will answer all your questions in the article below.



**What data does the TODAY function return in Excel? A guide on how to use the TODAY function in Excel.**

## *1. What is the TODAY function? What does it return?*

The Today function helps you get the current date in Excel. The Today function is quite important because you will need to use it many times. Besides its main function, the Today function is also used in combination with other functions to perform calculations.

When using the TODAY function in an Excel spreadsheet, you need to pay attention to the following issues:

- TODAY() is a mutable function; every time the spreadsheet is opened, the data in the cell using the TODAY function will automatically update.

To enter today's date in Excel as a static, unchangeable value, use the keyboard shortcut: Ctrl + ;

- To quickly insert the current date and time into a cell, you should use the NOW function instead of TODAY.

## 2. The TODAY function formula in Excel

There are two ways to enter today's date in Excel, including using a formula and using a keyboard shortcut. Which method you use depends on whether you want a static or dynamic value.

The syntax for the Today function returns a dynamic result: =TODAY()

The shortcut for the TODAY function returns a static result: **Ctrl + ;**

**For example:** To display the current date, instead of typing it specifically, you can simply type: =TODAY() and then press **Enter** . It will display the current date in the cell for you.

**Note :** If the TODAY function doesn't update the date correctly as you expect, simply go to **File -> Options -> Formulas** and select **Automatic** in the **Calculation Options** section.

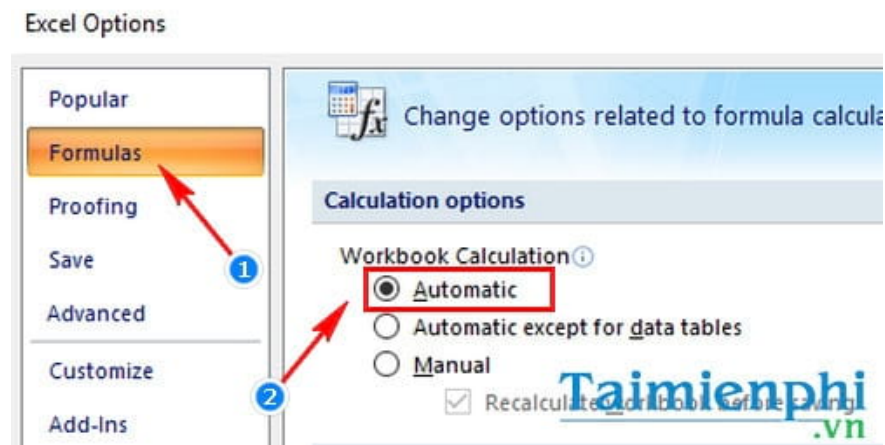

## 3. Examples illustrating the use of the TODAY function

To illustrate the applications of the TODAY function, we have the following spreadsheet:



- First, to get the current date, simply enter the syntax **=TODAY()**. The result will show what day it is today:

Picture 4 of What is the function in Excel that retrieves the current date and time?

To find today's date, combine the DAY function with the TODAY function using the following syntax: **=DAY(TODAY())** . The result you will get is the current date:

Picture 5 of What is the function in Excel that retrieves the current date and time?

- If you want to know what month it is, simply replace the DAY function with the MONTH function. The syntax is: **=MONTH(TODAY())** . You will then receive the current month as the result.

Picture 6 of What is the function in Excel that retrieves the current date and time?

- Next, if you want to know what day it will be 10 days from now, you can use the TODAY function with the syntax: **=TODAY()+10** . The result will be displayed as:

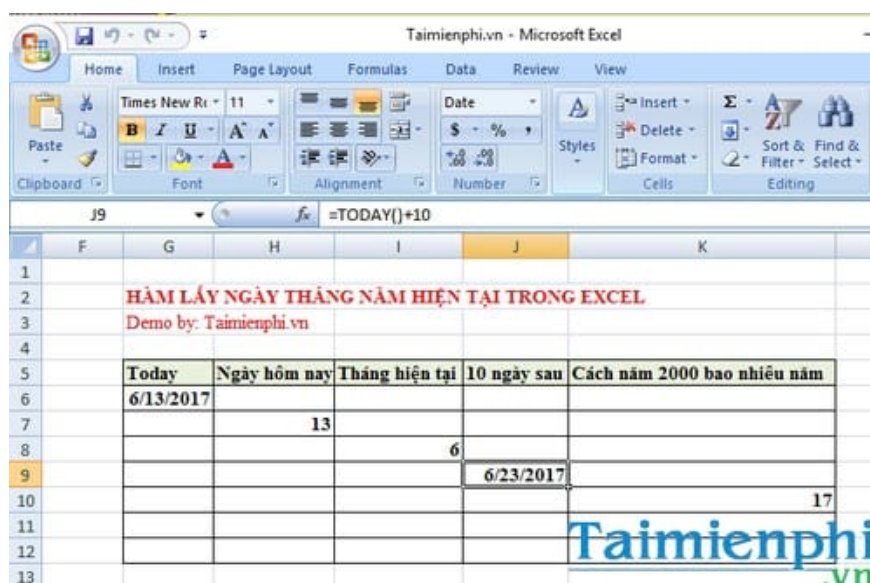

To find out how many years separate the year 2000 from the current year, combine the YEAR and TODAY functions using the following syntax: **=YEAR(TODAY())-2000**

Picture 8 of What is the function in Excel that retrieves the current date and time?

So now you know which function in Excel retrieves the current date, month, and year, right? Above are some examples of how to use the TODAY function in Excel in various specific cases. Additionally, you might be interested in learning how to add and subtract dates in Excel, as this is also an important skill for Excel spreadsheet users.

The IF function in Excel is also one of the most frequently used functions, especially as it helps you perform calculations accurately and efficiently.

You finished reading the article "**What is the function in Excel that retrieves the current date and time?**" edited by the [TipsMake](#) team. We hope this article has provided you with many useful tech tips and tricks. You can search for similar articles on tips and guides. Thank you for reading and for following us regularly.