

What is Protect Battery on Samsung phones? Should I use it?

All smartphones have lithium-ion batteries with a defined lifespan, measured by the number of full charge/discharge cycles the battery can go through before it begins to degrade. The average lifespan of a typical Li-ion battery is about 300 to 500 charging cycles, or about two to three years.

If you want to keep your phone for a while, Samsung's Protect Battery feature can help extend its battery life. Below, we'll talk more about what Protect Battery is, how to use it, and whether you should turn it on.

What is Protect Battery?

Protect Battery is a battery management system (BMS) found in Samsung smartphones running One UI 4.0 (Android 12) or higher. It works by limiting the battery's maximum charge to 85% to prolong its life.

You may wonder how limiting battery capacity can help increase battery life, but the science behind Protect Battery is actually sound.

To start, we need to explain what a complete charging cycle is. That is to fully charge and discharge the battery, that is, fully charge it to 100% and then discharge it to 0%. When your battery goes through a charging cycle, it is depleted and can never be recharged. This is not due to some dangerous design flaw in battery technology. That's how all rechargeable batteries work. Charge cycles are further explained in our guide on how to check the battery cycle count on your iPhone.

So how does Protect Battery help? While it is true that you cannot control the charging cycle and a complete cycle will occur on its own, as long as you keep the phone in use and charging, there is still a certain level of efficiency and safety in charging the battery. than.

By limiting charge to 85%, Protect Battery helps reduce wear on charging and maximizes performance. In other words, it stops the charging process as soon as it reaches the stage where your battery is most likely to degrade. It also helps protect the battery from high temperature and voltage problems when fully charged, two main disadvantages of Li-ion batteries.

How to use Protect Battery

There are two main ways to use Protect Battery on your Samsung smartphone. The first is the simplest way.

1. Find the **Protect Battery** button by pulling down the status bar.
2. Swipe down again to display the **Quick Settings** panel .

3. Protect Battery should be one of the icons displayed in one of the control panel sections.
4. If it's not there, you can add it by tapping the three-dot icon, selecting the **Edit** button , and selecting **Protect Battery** from the list of options.



Additionally, you can enable this feature from the Settings app:

1. **Open the Settings** app and select **Battery and device care** .
2. Tap **Battery** and navigate to **More battery settings** at the bottom.
3. Turn on the switch next to **Protect Battery**.

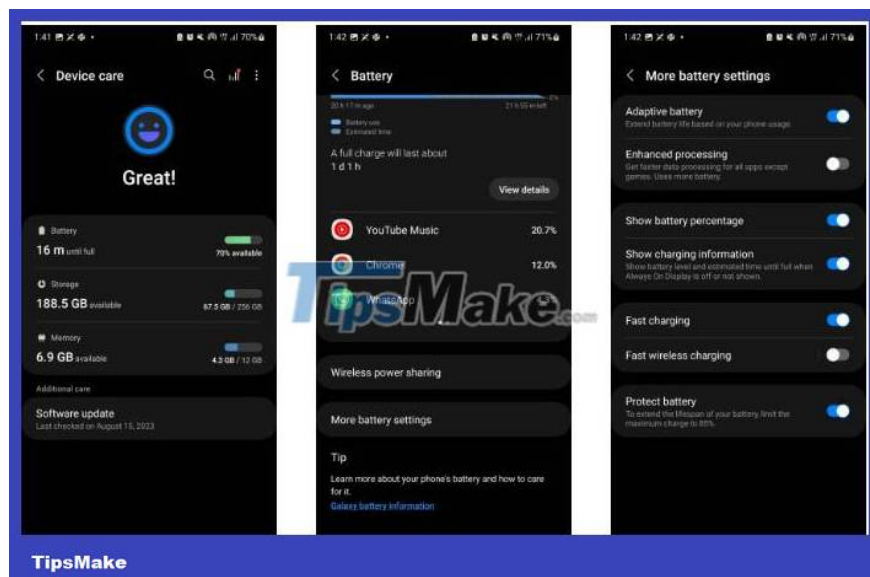

If you want to customize this feature a bit, you can set up a Bixby routine that turns on when certain conditions are met. For example, you can create a routine that turns Protect Battery on when you're sleeping and automatically turns it off right before you wake up.

Should I use Protect Battery?

Protect Battery has its benefits, but it also has a major drawback: it reduces the battery's operating capacity. Essentially, you're trading a larger capacity battery for a longer lasting battery.

So should you use this feature? If you're worried about draining your smartphone's power, Protect Battery may not be for you. If you don't mind spending money to replace the battery (or a new phone) every two to three years, you don't need this feature.

However, if you want to keep your phone/battery as long as possible, Protect Battery is a step in the right direction.

How is Protect Battery different from Optimized Battery Charging?

Optimized Battery Charging is a battery management feature similar to Protect Battery in iOS 13 and later. It works to improve battery life by reducing the time it takes the battery to be fully charged. Unlike Protect Battery, it also uses Machine Learning to recognize periods when your phone is likely to be charged for long periods of time. The algorithm aims to ensure that your battery remains fully charged when unplugged.

However, there is no "better" approach and it all depends on what works for you. Essentially, you can replace Apple's algorithm with the Bixby process and there won't be any difference.

You finished reading the article "**What is Protect Battery on Samsung phones? Should I use it?**" edited by the [TipsMake](#) team. We hope this article has provided you with many useful tech tips and tricks. You can search for similar articles on tips and guides. Thank you for reading and for following us regularly.