

# Top most popular ways to connect laptop to TV today

Nowadays, there are many simple and easy-to-use ways to connect your laptop to your TV to help you have the best experience. Let's explore with HACOM right here.

As technology continues to develop, **connecting a laptop to a TV** has become one of the most popular ways to share content from a small computer screen to a large TV screen. It not only helps you watch movies, videos, or display images more comfortably, but also opens up many other applications for entertainment and work. In this article, TipsMake will send you the most popular and convenient ways **to connect a TV to a laptop today**.

## Connect laptop to TV via HDMI

**HDMI** stands for High Definition Multimedia Interface, a popular connection standard today, allowing the connection of source devices such as laptops and mobile phones to playback devices such as TVs and projectors. **Connecting a laptop to a TV** via HDMI ensures that image and sound quality are transmitted quickly and conveniently, helping users enjoy content easily.

The steps to connect a laptop to a TV via HDMI are as follows:

### Step 1: Prepare the equipment

First, you need a laptop **and** a TV that both support HDMI ports. Most modern flat-screen TVs have HDMI ports on the back. You also need a suitable HDMI cable. HDMI cables can be purchased from electronics stores and cost between 50,000 and 1 million VND depending on the length and quality.



## Step 2: Connect

Connect one end of the HDMI cable to the HDMI port on your laptop and the other end to the HDMI port on your TV.

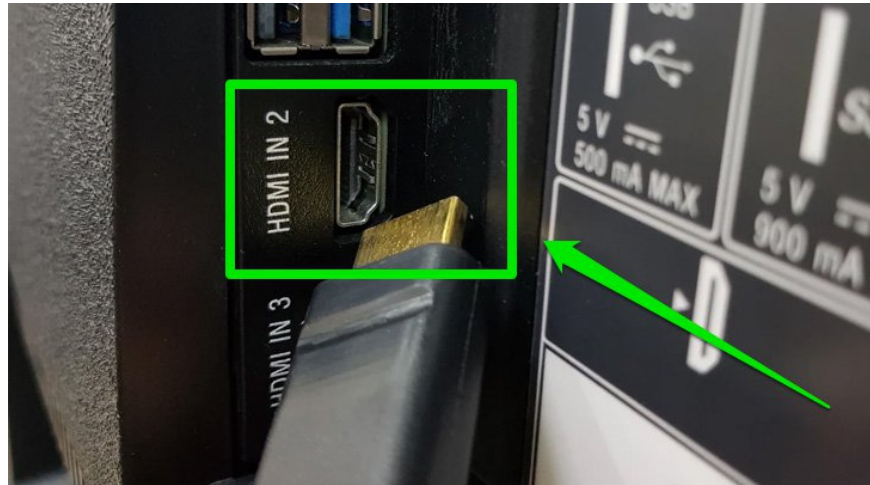

## Step 3: Select input source

On the TV, use the remote control to select the input source as HDMI 2 or the source corresponding to the HDMI port you are connected to.

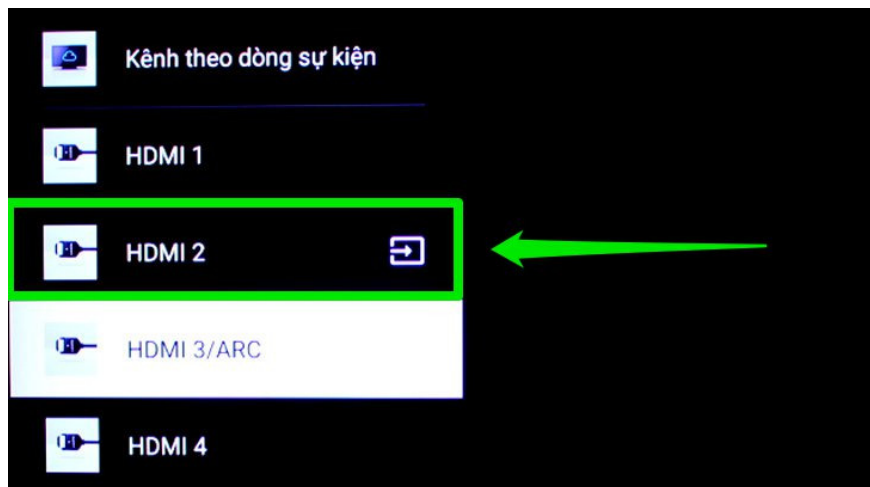

## Step 4: Adjust settings on your laptop

On a laptop, press Windows key + P to open display settings.



### Step 5: Select display mode

Select Duplicate display mode to project content from your laptop to your TV screen.



### Step 6: Finish

After successful connection, you can project images and sounds from your computer onto the big screen of your TV, allowing everyone to enjoy the images.



This is how to **connect a laptop to a TV** via HDMI, you can apply the same steps to connect a desktop computer to a TV.

## Connect laptop to TV wirelessly via Wi-Fi Direct

When you want to **connect your laptop to your TV** wirelessly via Wi-Fi Direct, the TV will emit Wi-Fi without connecting to the Internet. This allows you to conveniently transfer data directly between your laptop and TV. Note that when your laptop is connected via Wi-Fi Direct from the TV, you will not be able to access the Internet to browse the web, watch movies, or read newspapers as when using a regular Wi-Fi connection.

To connect your TV to your laptop via Wi-Fi Direct, you can follow these steps:

**Step 1** : Click on "Settings" on the TV and select "network" and turn on the "Wi-Fi Direct" feature.

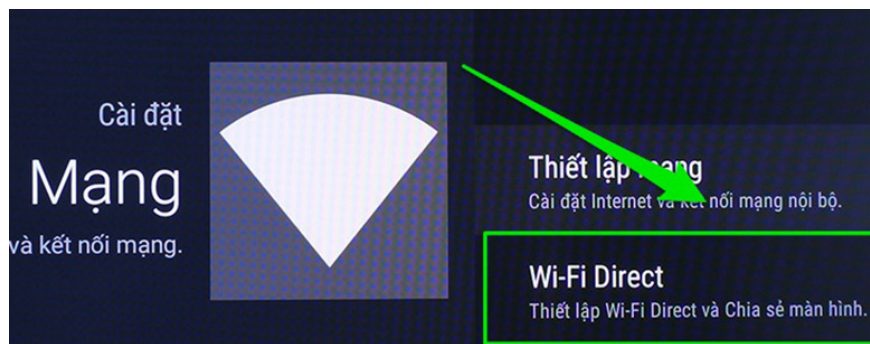

**Step 2** : The TV will display the name and password for the Wi-Fi Direct signal. You need to connect your laptop to this Wi-Fi signal.

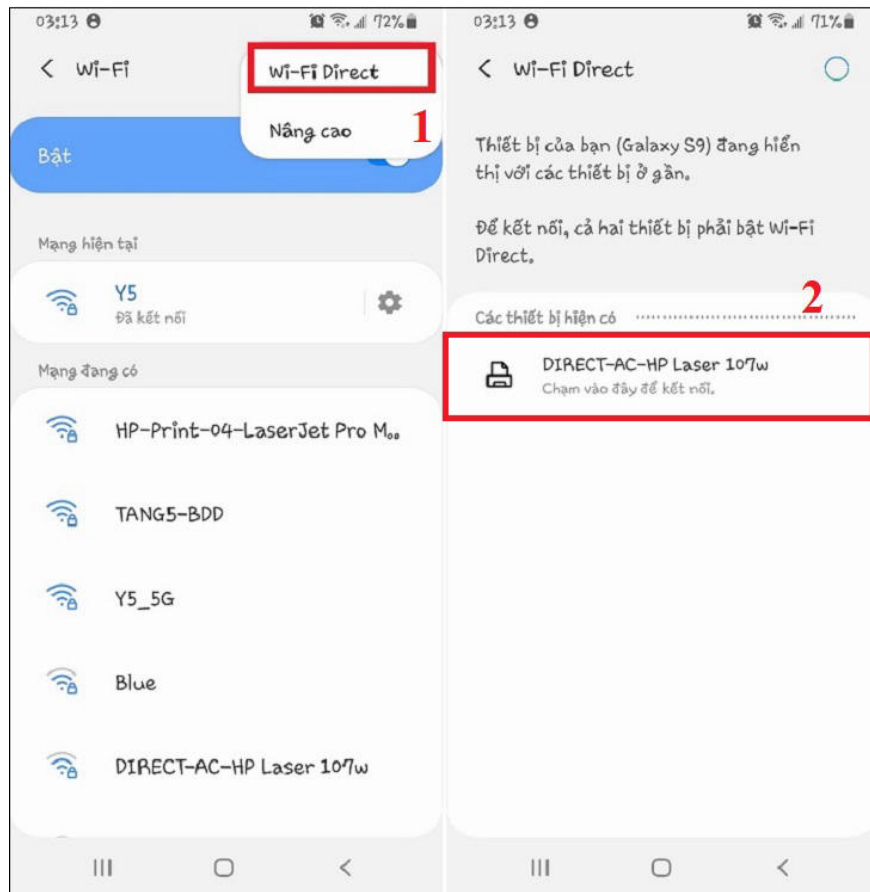

**Step 3 :** After successful connection, you can enjoy the great features that Wi-Fi Direct brings.



So, with Wi-Fi Direct, you can easily connect your TV and laptop without using the Internet.



## Connect laptop to TV wirelessly using Bluetooth

When you want to connect your laptop to your TV wirelessly, using Bluetooth is a traditional method but still very effective and never outdated. Bluetooth can be used on any device that supports Bluetooth. Here are the steps to quickly transfer data from your computer to your TV using Bluetooth:

### Step 1: Turn on Bluetooth on each device in turn

1. Open the search menu on your computer taskbar and type "Bluetooth". Select 'Bluetooth and other devices settings' and turn Bluetooth on.
2. Go to the "Settings" menu on your TV, select "Bluetooth" and turn Bluetooth on. Then, select "Add device".

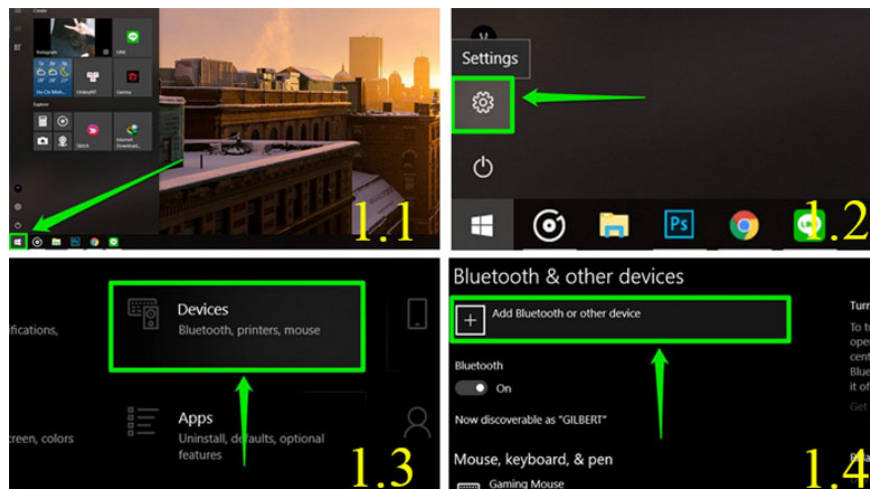

### Step 2: Connect the device

On the TV, find your laptop device and select pairing. You will immediately receive a successful connection notification. Bluetooth connection is a convenient way to wirelessly connect your laptop to your TV to transfer data without using a cable or network.



## Connect laptop to TV using USB port

Using a **USB** port is one of the simple ways **to connect a laptop and TV** , specifically:

### Step 1: Check the device

Make sure your TV has a USB port and your laptop supports USB ports.

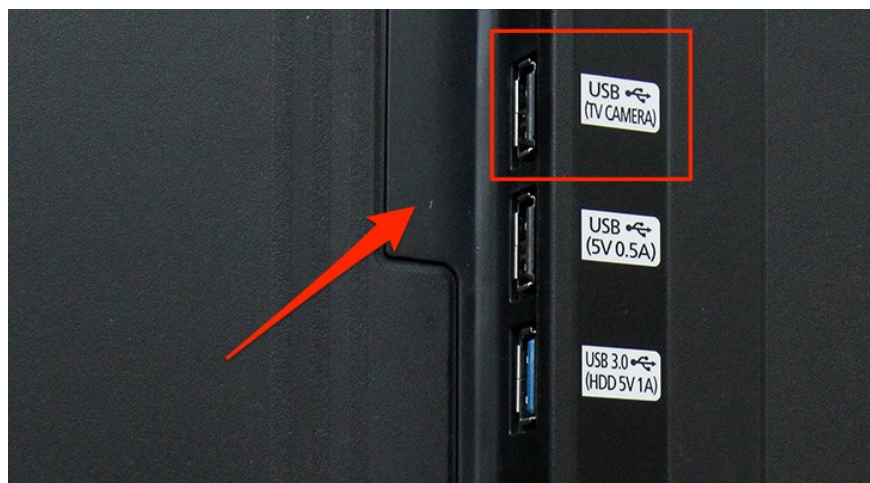

### Step 2: Select compatible files

Check your TV's user manual to determine the file types supported via the USB port and compatible file formats.

### Step 3: Identify the USB port on the TV

Find the location of the USB port on the TV.

Use a USB adapter with the appropriate plug to connect between the USB port on the TV and the laptop.



#### **Step 4: Connect the USB port**

Plug one end of the USB cable into the corresponding port on your laptop and the other end into the USB port on your TV. On your TV, use the remote or panel to select the input source that matches the USB port you connected.

#### **Step 5: Finish**

Once connected successfully, you can project content from your laptop to your TV.



Note that while many TVs have USB ports, not all support direct connection to a laptop. Some TVs only use the USB port for various services, while others may only read from USB flash drives with some limitations on supported file types. Be careful when using third-party USB adapters to avoid damaging your hardware.

Be aware that using a USB port to connect your TV to your laptop may have limitations on compatible file types and file formats. This also depends on the features of your TV and the USB adapter you use.

**Connecting your laptop to your TV** is one of the fun ways to expand your entertainment experience. Through connection methods such as HDMI, Wi-Fi Direct, Bluetooth, or USB port, you can easily share images, videos, and sounds from your computer to the big screen of your TV. With the development of technology, connecting your TV to your laptop becomes simpler, giving you flexibility and unlimited enjoyment in the digital world. Don't forget to follow **TipsMake** to update useful things every day!

You finished reading the article "**Top most popular ways to connect laptop to TV today**" edited by the [TipsMake](#) team. We hope this article has provided you with many useful tech tips and tricks. You can search for similar articles on tips and guides. Thank you for reading and for following us regularly.