

# These 15 popular Android apps can leak your mobile data

Using mobile data is very convenient in places where Wi-Fi is not available but if you are not careful you will use the data level for a month, leading to slow speed and additional costs.

Using mobile data is very convenient in places where Wi-Fi is not available but if you are not careful you will use the data level for a month, leading to slow speed and additional costs. Thankfully, many popular Android applications offer settings that help you restrict mobile data usage. This article will guide you to find mobile data savings on the popular Android applications below.

## 1. YouTube

There are a number of settings you can change in the YouTube app that make data use a minimum:

1. Go to **Settings**> **Background & downloads** . If watching videos with mobile data, in **Download** , you can change the video quality to **Low** (or **Medium** if you like, but the difference is not significant on smaller screens).
2. Go to **Settings**> **Autoplay** . To stop automatically playing new videos after watching the video, turn off **Autoplay next video** . You can also disable auto play without audio in the homepage feed. Touch **Autoplay next video** and select **Wi-Fi only** (or you can turn it off completely if it is annoying).

## ← Background & downloads

### Background play

Playback  
Off

### Download

Video quality  
Medium - 360p

Download over Wi-Fi only

Downloading help  
Find answers to your questions about downloading videos

Delete all downloads

### Available storage



## Background & downloads

### Background play

Playback  
Always on

### Download

Video quality  
Medium

Downl

Downl

Find an

Delete

Availab

142 MB

leos

SB free

### Video quality

- Ask each time
- Low - 144p
- Medium - 360p
- HD - 720p

CANCEL

69°

83% 11:15

## Background & downloads

### Background play

Playback  
Off

### Download

Video quality  
Medium - 360p

Downl

Downl  
Find an

Delete

Availab

### Playback

- Always on
- Headphones or external speakers
- Off

CANCEL

142 MB used

24.56 GB free

 **Quantrimang**

1. With YouTube Red, you can also download videos for offline viewing. If so, make sure to turn on the **Download over Wi-Fi only option** . If you are more careful, you can also turn off the **Background play** to prevent YouTube from continuing to play the video after closing the application.

See also: 11 ways to download videos on Youtube quickly and simply

## **2. Facebook**



Nearby Friends

Games

See More

Help & Support

Settings & Privacy

Settings

Privacy Shortcuts

Language

Data Saver

Code Generator

Edit Shortcuts

Log Out

Quantineng

82°

📶 🔋 65% 2:55

## ← Data Saver

Turning this on will reduce image size and stop videos from playing automatically to help use less data.

**Data Saver**



**Always turn off Data Saver on Wi-Fi**

Data Saver will turn back on automatically when you switch to using cellular data.



 Quantimeng



 Autoplay

Autoplay videos begin automatically as you scroll.

Videos use more data than other stories on Facebook, so choose when your videos autoplay here.

**CHOOSE WHEN VIDEOS AUTOPLAY**

On Mobile Data and Wi-Fi Connections

On Wi-Fi Connections Only

Never Autoplay Videos

If your battery is low we turn autoplay off.



Facebook offers one-touch options to reduce mobile data usage. You can also research application settings to control more:

1. Go to **Settings & Privacy**> **Data Saver** and turn it on. You can also choose to automatically turn off **Data Saver** when using Wifi. Enabling **Data Saver** will reduce the image size and prevent videos from automatically playing in your feed.
2. If you don't want to reduce the image size, you can choose to stop automatically playing the video by going to **Settings & Privacy**> **Settings**> **Media and Contacts**> **Autoplay** . There are two options for you to choose to play automatically when Wifi is available or turn off this feature completely.
3. Facebook is one of many applications on this list that provides a "lite" version that uses less data (and takes up less space on the phone). If you see that Facebook is still a 'pig' eating data, you can choose Facebook Lite or try a Facebook replacement application.

### 3. Twitter

## ← Settings and privacy

@nfm

Account

Privacy and safety

Notifications

Content preferences

**General**

Display and sound

**Data usage**

Accessibility

Proxy

About Twitter

These settings affect all of your Twitter accounts on this device.



← Data usage

Video

High-quality video

Wi-Fi only

Select when the highest quality available should play.

Video autoplay

Wi-Fi only

Select when videos should play automatically.

Data sync

Sync data



Sync interval

Daily

Allow Twitter to sync data in the background to enhance your experience.



Here are some of Twitter's limited mobile data usage settings:

1. Go to **Settings and privacy**> **Data Usage** to control how Twitter uses mobile data. There are a few options related to video and synchronization. In **Video** , click **High-quality video** and select **Wi-Fi only** to prevent Twitter from downloading large videos while using data. Click **Video autoplay** and select **Wi-Fi only** (or you can turn it off completely if you don't like to play the video automatically).
2. In **Data Sync**, uncheck **Sync data** so that Twitter only gets new information while you actually use the application.
3. Twitter also offers a browser-based mobile version that uses less data than the app. To use it, just visit [mobile.twitter.com](https://mobile.twitter.com) in Chrome or another browser. Twitter said the lite version is ideal for people with expensive connectivity or data usage issues.

## 4. Instagram

← Settings

Invite Friends

Follow People

 Facebook Friends

 Contacts

---

Account

Password

Saved

Payments

Posts You've Liked

Original Photos

Search History

**Cellular Data Use**

Language



## ← Cellular Data Use

Default

Use Less Data



Using less cellular data may affect your experience on Instagram (ex: photos and videos may take longer to load).



Instagram has a vague data saving feature. Unlike other applications that tell you exactly what their options do, Instagram's options are simply to use less data.

1. Go to **Settings** and scroll down to **Account > Cellular Data Use** and click **Use Less Data** to select the setting. Instagram warns that enabling this setting will cause photos and videos to take longer to download.

## **5. Netflix**



Profile

Profile

Profile

Profile

Add Profile

Manage Profiles

Notifications

**THE STAIRCASE**  
New Arrival  
The Staircase  
Jun 8

**set:it:up**  
Coming June 15th  
Play the Trailer  
Jun 7

My List

App Settings

Account

Help

Sign Out



Home

Search

Downloads

More

69°

80% 11:32



## App Settings

### Video Playback



Cellular Data Usage  
Wi-Fi Only

### Notifications



Allow Notifications



### Downloads



Wi-Fi Only



Download Video Quality  
Standard



Download Location  
Internal Storage

Internal Storage

Default



Used • 29 GB

Netflix • 86 B

Free • 27 GB

About



# uantrimang

Device

Version: 6.4.0 (code 28132), OS API: 27

Model: Pixel 2 XL

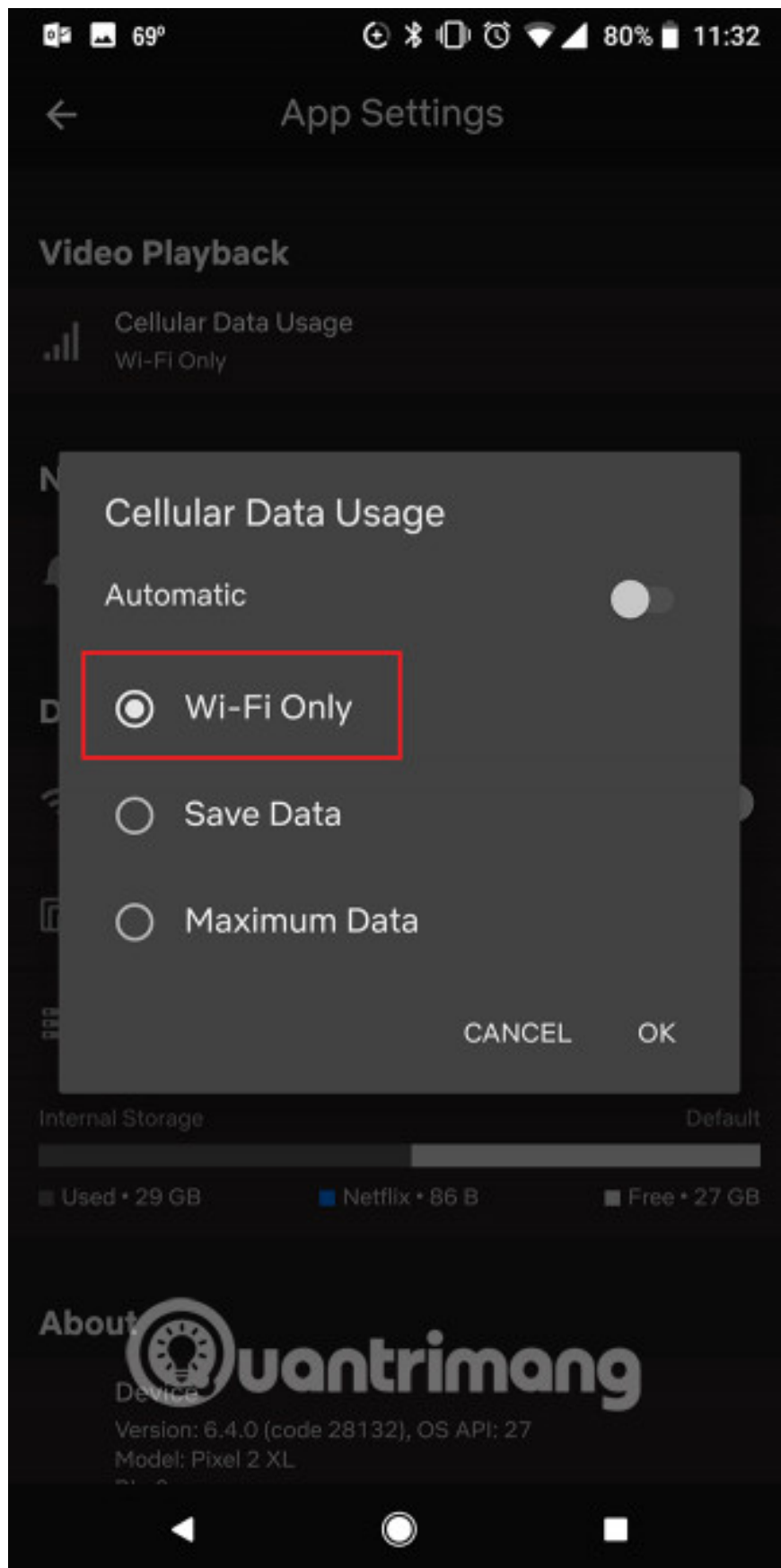

Netflix users can completely limit the use of mobile data:

1. Click **More> App Settings** and in **Video Playback** , touch the **Cellular Data Usage**. You will find it in **Automatic** mode, turn off this feature to have access to user-selected settings. You can select the **Wi-Fi option only** to restrict video playback. (If you still want to view with mobile data, you can select the **Save Data** option to use less data.)
2. If you plan to download videos for offline viewing, you can choose to install **Wi-Fi only** in **Downloads** to download videos using Wifi. (This feature is enabled by default.)

See also: How to watch movies on Netflix anywhere?

## 6. Spotify

69°

79% 11:40



# Your Library



Your Daily Mix

Playlists

Stations

Songs

Albums

Artists

Podcasts

Videos

## Recently Played



Release Radar  
Playlist • by Spotify



Discover Weekly  
Playlist • by Spotify



Heavy • Birdtalker  
Devices Available



Home



Browse



Search



Radio



Your Library



# Settings

## Data Saver

**On**   
Sets your music quality to low.

## Playback

**Offline mode**   
When you go offline, you'll only be able to play the music and podcasts you've downloaded.

**Crossfade**  
Allows you to crossfade between songs

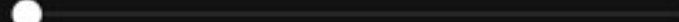
Off  12 s



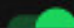

**Gapless**   
Allows gapless playback

**Allow Explicit Content**   
Allow playback of explicit-rated content

**Show unplayable songs**   
Show songs that are unplayable.

**Normalize volume** 

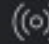
^  **Quantrimang** Heavy • Birdtalker   
Devices Available

-  Home
-  Browse
-  Search
-  Radio
-  Your Library





# Settings

## Music Quality

### Streaming

Higher quality uses more data.

Automatic

### Download

Higher quality uses more disk space.

Normal quality

### Download using cellular

Recommended Setting: Off



## Equalizer

Open the equalizer control panel.

## Notifications

### Notifications

Choose which notifications to receive.

## Advertisements

### Spotify Ad Partner Preferences

Control how ads are targeted to me based on information gathered from advertising partners.



Heavy • Birdtalker

Devices Available



Home



Browse



Search



Radio



Your Library



Whether you use Spotify or another popular streaming music service, these services often offer settings to adjust streaming quality and use offline lists to prevent excessive use of data. mobile.

1. Go to **Settings** and scroll down to **Music Quality** . For stream quality, by default it is set to **Automatic** , you can select **Low** to use the data to a minimum. If this is not good enough, you can choose **Normal** .
2. You can also adjust this setting by enabling **Data Saver** at the top of the installation screen. (Enabling **Data Saver** will automatically set **Music Quality** settings for you.)
3. Also, make sure that **Download using cellular** is disabled, by default this option is usually turned off.
4. To download a list of offline listeners, navigate to that list and turn on the **Download** slider at the top of the screen, but you can only do this when using Spotify Premium.

See also: [How to download mp3s on Spotify](#)

## 7. Gmail

Not set

**Smart Reply**   
Show suggested replies when available

**Vacation responder**  
Off

**Nudges**

**Reply and follow up**

**Inbox Tips**

**Inbox Tips settings**

**Data usage**  
**Sync Gmail**

**Days of mail to sync**  
30 days

**Download attachments**   
Auto-download attachments to recent messages via Wi-Fi

**Images**  
Ask before showing



69°

77% 1:04



@gmail.com



Not set

Smart Reply

Show suggested replies when available



Vacation responder

Off

Nudges

R Images

Always show

Ask before showing

CANCEL

Sync Gmail



Days of mail to sync

30 days

Download attachments

Auto-download attachments to recent messages via Wi-Fi



Images

Ask before showing

Quantrimang



If Gmail is the email application of your choice, there are a few settings related to data that need to be changed. Depending on your email activity, they may affect data usage:

1. Click on the menu button, go to **Settings** and touch your account name. If you have multiple accounts, you will have to change the settings for each individual account.
2. In **Data Usage** , you can uncheck the **Sync Gmail** . This means that new emails will not automatically download and you will not receive any notifications unless you open the application and refresh it manually.
3. You can also prevent automatic downloading of images in Gmail on a data connection by clicking **Images** and selecting **Ask before displaying** .
4. If you find that Gmail still uses a lot of mobile data after changing those settings, you can use Gmail Go, an alternative to older phones and slow connections.

## 8. Google Chrome

69°

🔋 76% 1:09



# Settings



[Blurred text]

## Basics

Search engine  
Google

Autofill and payments

Passwords

Notifications

## Advanced

Privacy

Accessibility

Site settings

Languages

**Data Saver**  
5% data savings



# Data Saver



On



23.90 MB data saved

483 MB data used

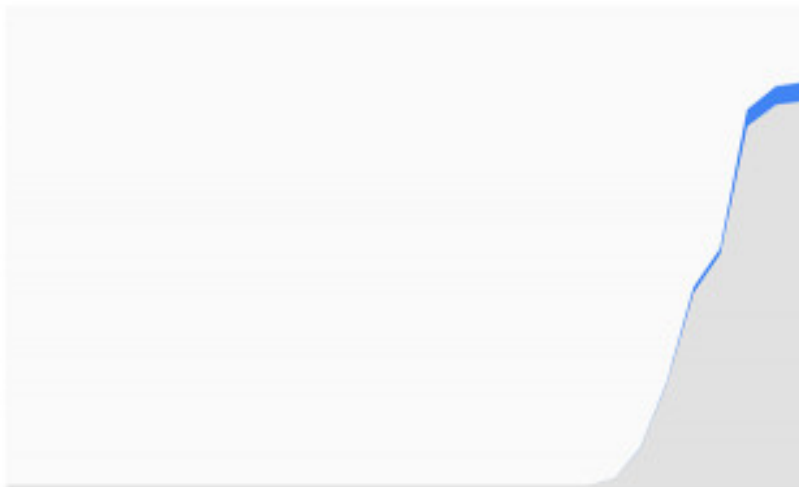

May 14

Jun 13

## Details

Site	Used	↓ Saved
[Blurred]	3.68 MB	10.08 MB
[Blurred]	7.80 MB	2.57 MB
[Blurred]	1.19 MB	2.30 MB
[Blurred]	1.07 MB	1.35 MB
[Blurred]	8.48 MB	1.29 MB



Google Chrome application is famous in Vietnamese mobile data consumption. There is a key feature of Chrome that you can turn on to minimize data usage:

1. Go to **Settings> Data Saver** and turn it on. This is Google's solution for slow connection and reduced data usage. With **Data Saver**, Google's servers compress data from the websites you visit, downloading less data for your device. In fact, this means the image may not be clear and your location will not be easily discovered by websites.
2. Chrome will also tell you exactly the amount of data saved from each site visited.
3. Chrome's Data Saver has limitations: it doesn't work on secure websites and restricted sites (like a company internal site) won't load. If you don't know what a secure site is, look at the URL, if it starts with https (not http), it's a secure page.

If you are looking for a mobile browser that matches slow connections, you might consider Opera Mini.

## **9. Messages (SMS)**

69°

⊕ 🔗 📶 ⌚ 📶 75% 🔋 1:16

← Settings

Default SMS app  
Messages

Notifications

Hear outgoing message sounds



Your current country  
Automatically detected (United States)

Smart Reply  
Show suggestions when available

Automatic link previews  
Show previews in messages

Advanced



## Automatic link previews

Show previews in messages



Only download previews on Wi-Fi



Google gets preview content from linked sites. Only links from known senders include previews. [Learn more](#)



You wouldn't think that Android's original SMS application provides a way to save data right? Here are some settings you can change.

1. You can turn off link preview while using data by clicking the menu button (three dots). Click **Settings> Automatic link previews** and make sure to select **Only download previews on Wi-Fi** .
2. If you don't want to preview the link, you can turn it off completely by turning off the **Show previews in messages option**.

## **10. Firefox**

← Settings



Firefox Account

xxxxxx@xxxxxx.com

General

Home, language, tab queue

Search

Add, set default, show suggestions

Privacy

Tracking, logins, data choices

Accessibility

Text size, zoom, voice input

Notifications

New features, website updates

Advanced

Restore tabs, data saver, developer tools

Clear private data

Make default browser

Mozilla Firefox

About Firefox, FAQs, feedback



# Settings

**Restore tabs**  
Always restore

**Character encoding**  
Don't show menu

## Data saver

**Show images**  
Only over Wi-Fi

**Show web fonts**   
Download remote fonts when loading a page

## Media

**Allow autoplay**   
Control if websites can autoplay videos and other media content

## Developer tools

**Remote debugging via USB**

**Remote debugging via Wi-Fi**   
Wi-Fi debugging requires your device to have a QR code reader app installed.

[Learn more](#) >



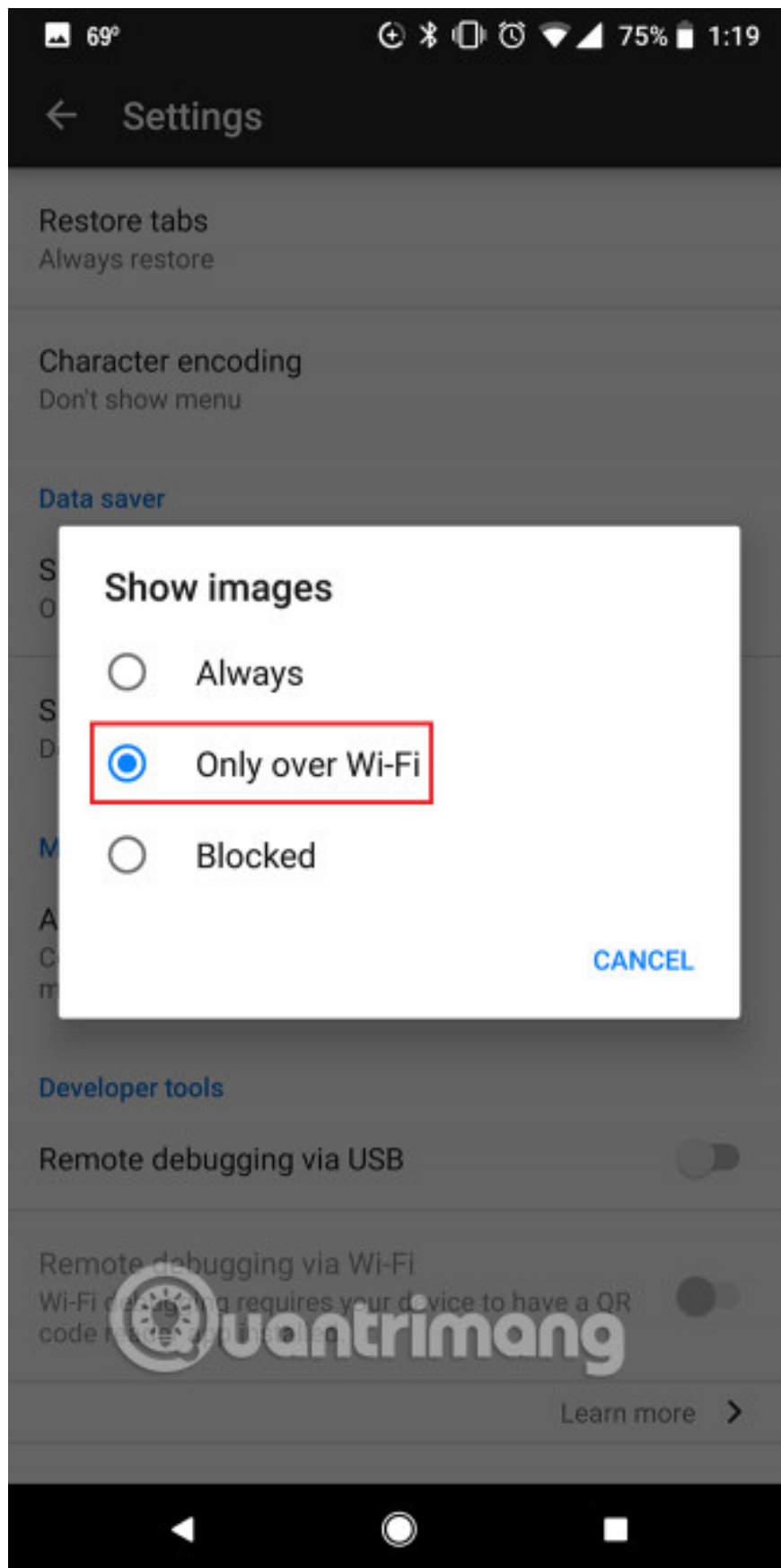

Firefox is also another Android web browser, offering a few options to restrict mobile data usage.

1. Click the menu button (three dots) and go to **Settings** . Click **Advanced** and in **Data Saver** , tap **Show Images** and select **Only over Wi-Fi**.
2. You can also disable **Show web fonts** , to prevent Firefox from downloading fonts remotely when loading pages. Although this option does not eat a lot of mobile data, but if you want to use the data at a minimum, changing this setting will not affect your viewing quality.
3. In **Allow autoplay Media** off. This prevents annoying auto-play videos on websites.

## 11. Google Photos

← **Settings**

**Back up & sync**

Backing up to [redacted]@gmail.com

**Free up device storage**

Remove original photos & videos from your device that are already backed up

**Notifications**

Manage preferences for notifications

**Group similar faces**

Manage preferences for face grouping

**Assistant cards**

Choose the types of cards to show

**Sharing**

**Shared libraries**

Automatically share photos with a partner

**Remove video from motion photos**

Share only the still photos when sharing by link & in albums



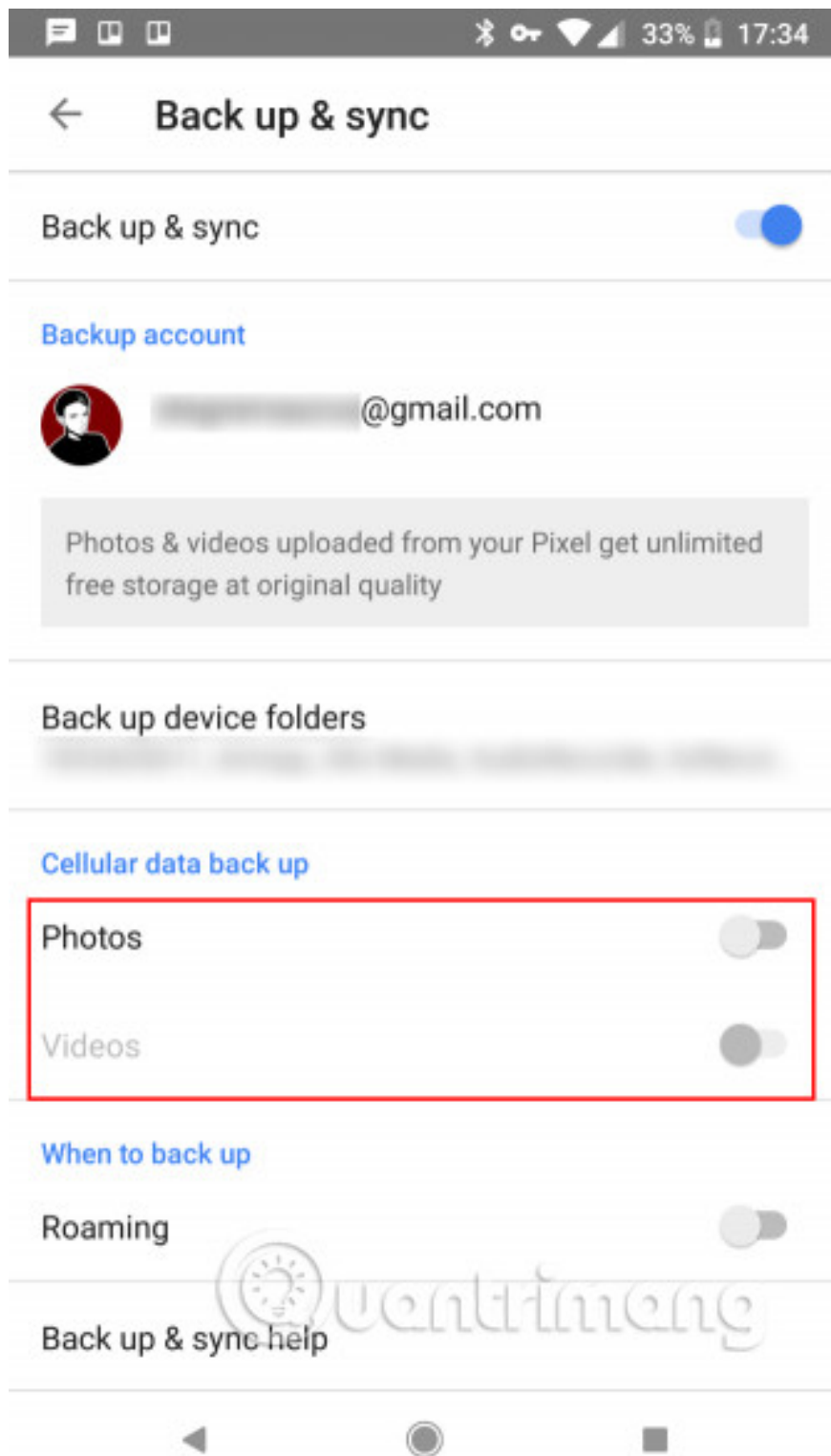

If you use a Google phone, you can take advantage of unlimited backup capabilities for your photos with the Google Photos app. But you need to make sure backup only happens when connecting to Wifi:

1. Go to **Settings**> **Back up & Sync** . Scroll down to **Cellular data back up** and make sure to uncheck **Photos** . (If Photos option is not selected, the **Video** option will be disabled by default.)

2. If traveling, you can also ensure that **Roaming** is turned off in **Backup** .

See also: 18 tips to help you master Google Photos

## **12. Pocket**

← Settings

Offline Downloading

Download best view

Pocket will decide the best view (Article or Web View) to download



Always fetch Article View

Unavailable when automatically downloading the best view



Always fetch Web View

Unavailable when automatically downloading the best view



Download only on Wi-Fi



Mobile user-agent

Download mobile versions when available



Offline Storage Location

Internal

Set offline storage limits

Clear downloaded files

Syncing



69°

⊕ \* 📶 🔔 71% 1:37

## ← Settings

### Syncing

Sync when app opens



Background syncing

Never

### List

Sort

Newest First

Start in Untagged

Default tag filter to "Untagged"



Manage site logins

Log in to sites that require an account to access content

### Sharing

Logout of Services

### Notifications

Push Notification Settings

Choose which types of notifications you'd like to receive

Device Notification Settings



Settings

Syncing

Sync when app opens



Background syncing

Background syncing

- Instantly (Push)
- Every Hour
- Twice a day
- Once a day

Never

CANCEL

Logout of Services

Notifications

Push Notification Settings

Choose which types of notifications you'd like to receive

Device Notification Settings



If you save articles to read on the way to work, you should remember to start the Pocket application before leaving the Wifi signal range.

1. To make sure that you didn't accidentally download all that content while using mobile data, go to **Settings** and scroll down to **Offline Downloading** , select **Download only on Wi-Fi**.
2. In **Syncing** , you can also press the **Background Syncing** and select **Never** .

## 13. Snapchat



Add Bitmoji

Trophies

Share

Add Friends

Help secure your account!  
Tap to verify your phone

My Story  
Tap to add a Snap!

uantrimang



← Settings

Snap Store

Snapcash

Memories

Shazam

ADDITIONAL SERVICES

Manage

WHO CAN...

Contact Me

My Friends

View My Story

My Friends

See My Location

Only Me (Ghost Mode)

See Me in Quick Add



## < Additional Services

### Travel Mode

Reduces Snapchat's mobile data usage.  
Just tap to load content like Snaps and Stories when you're on the go.



### Friend Emojis

### Emoji Skin Tone

### Permissions

### Ad Preferences

### Lifestyle & Interests

### Maps

### Contacts



Snapchat is another application that has a one-touch solution to save data. Its **Travel Mode** prevents the application from using too much data by stopping content that is automatically loaded in the background when there is no use of Wifi. But that setting is hidden and therefore easily overlooked.

1. To turn on **Travel Mode** , go to **Settings** and in **Additional Services** , click **Manage** . Make sure **Travel Mode** is selected.

## 14. WhatsApp

Settings



Nancy Messieh

Available



Account



Chats



Notifications



Data and storage usage



Invite a friend



Help



## Data and storage usage

Network usage

Storage usage

### Media auto-download

When using mobile data

No media

When connected on Wi-Fi

All media

When roaming

No media

NOTE: Voice messages are always automatically downloaded for the best communication experience

### Call settings

Low data usage

Lower the amount of data used during a WhatsApp call when using mobile data



### Media visibility

Show media in gallery

Show all downloaded WhatsApp media in gallery



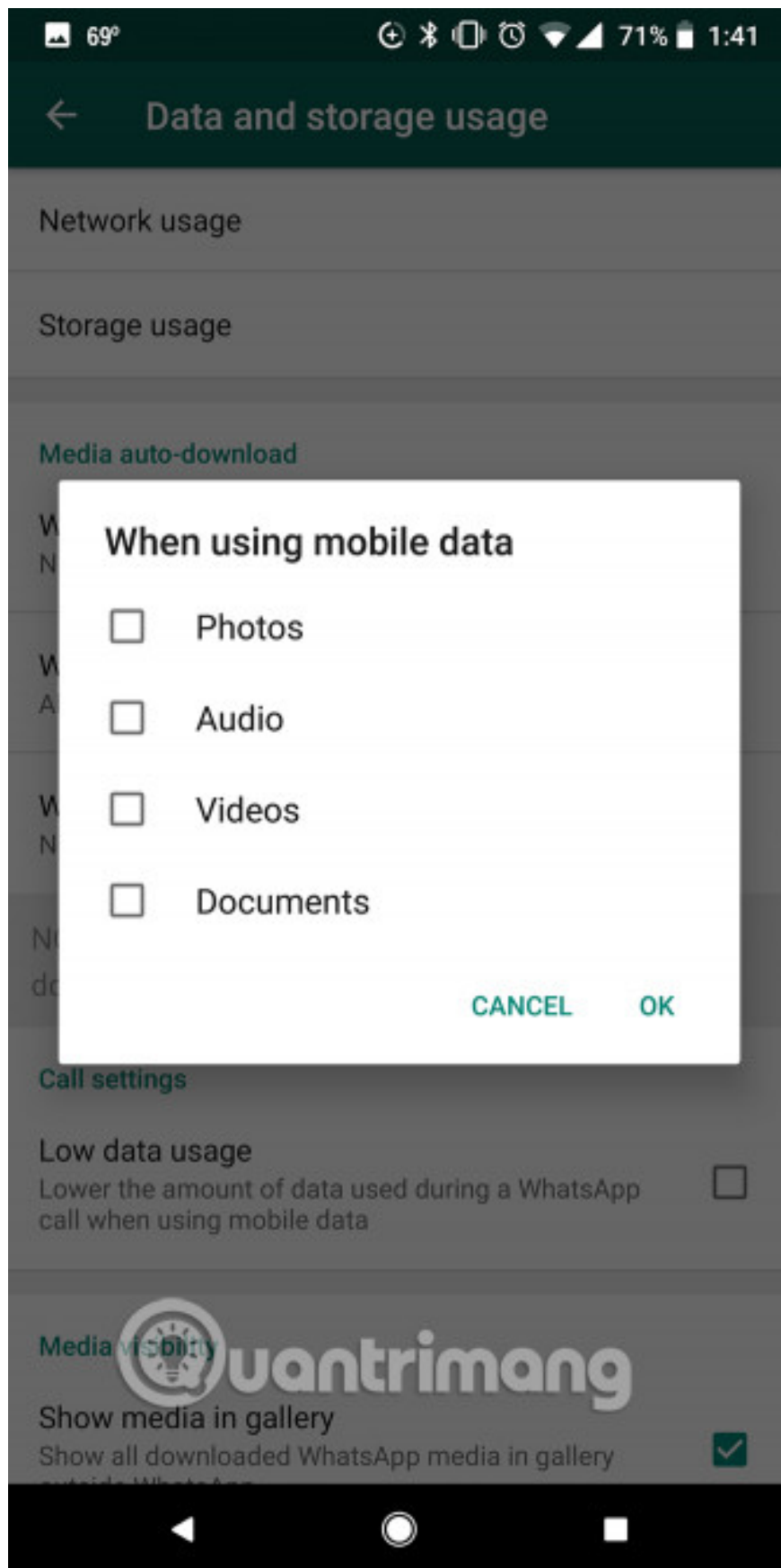

WhatsApp has some data usage settings that you can turn on:

1. Go to **Settings> Data and storage use** and in the **Media auto-download** , click **When using mobile data** and make sure to remove the four options. By default **Photos** are selected, but you can turn it off and turn off both **Audio** , **Videos** and **Documents** . This way, none of these file types will download when you are using mobile data.
2. Click **When roaming** and make sure all four options are turned off. (They are usually disabled by default).
3. You can also choose to reduce data usage during a call. In **Call Settings** , choose to turn on **Low data usage** although this option will obviously reduce call quality.
4. WhatsApp also allows you to view specific data usage (total MB sent and received) by going to **Settings> Data and storage use> Network usage**.

Other messaging applications like Telegram have similar settings.

See also: Free messaging application without Internet

## 15. Google Maps

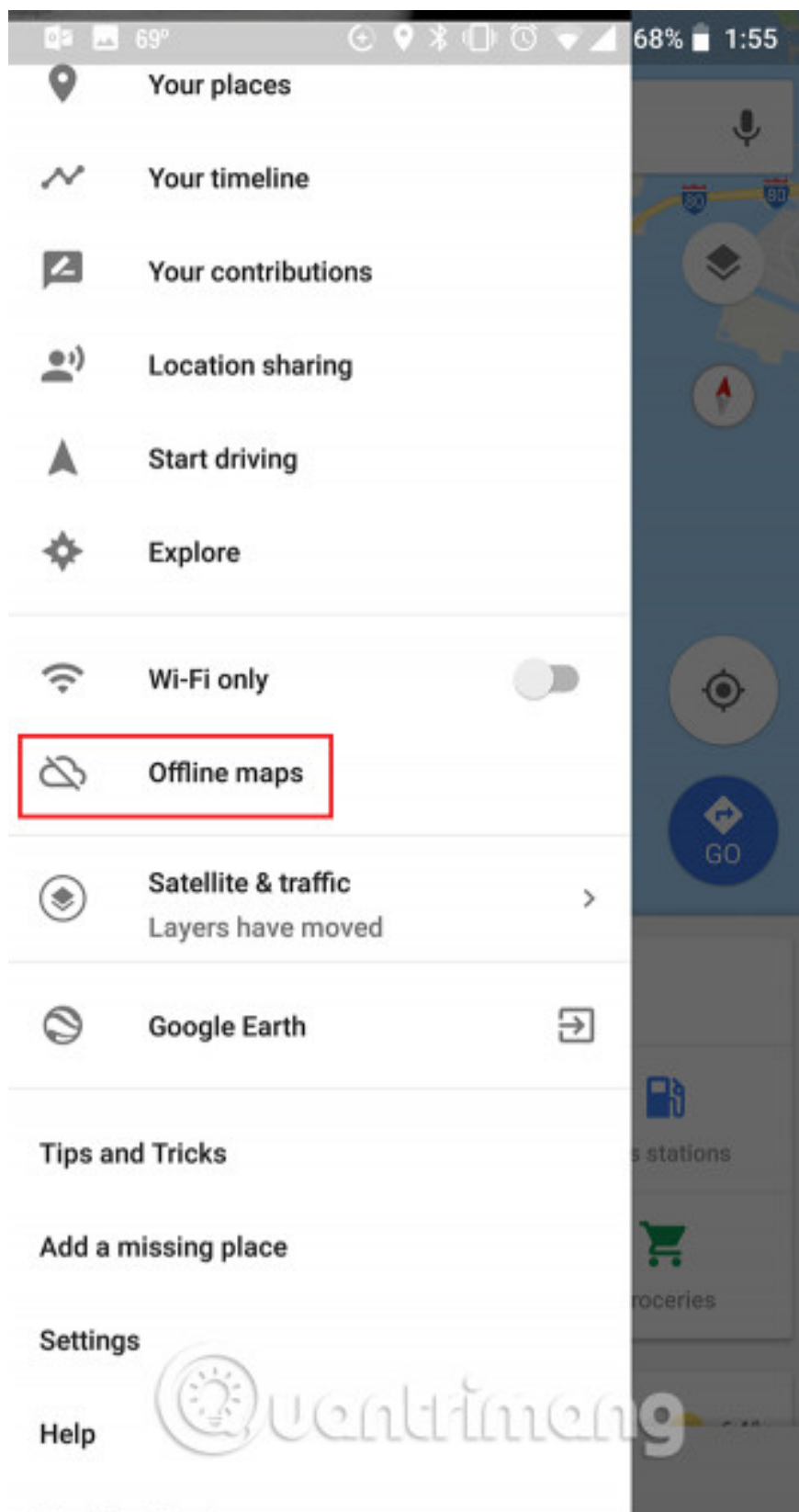

# Offline maps



**SELECT YOUR OWN MAP**

## Downloaded maps

*From your home and work addresses*



**HOME**

97 MB • Expires Jul 3 unless updated



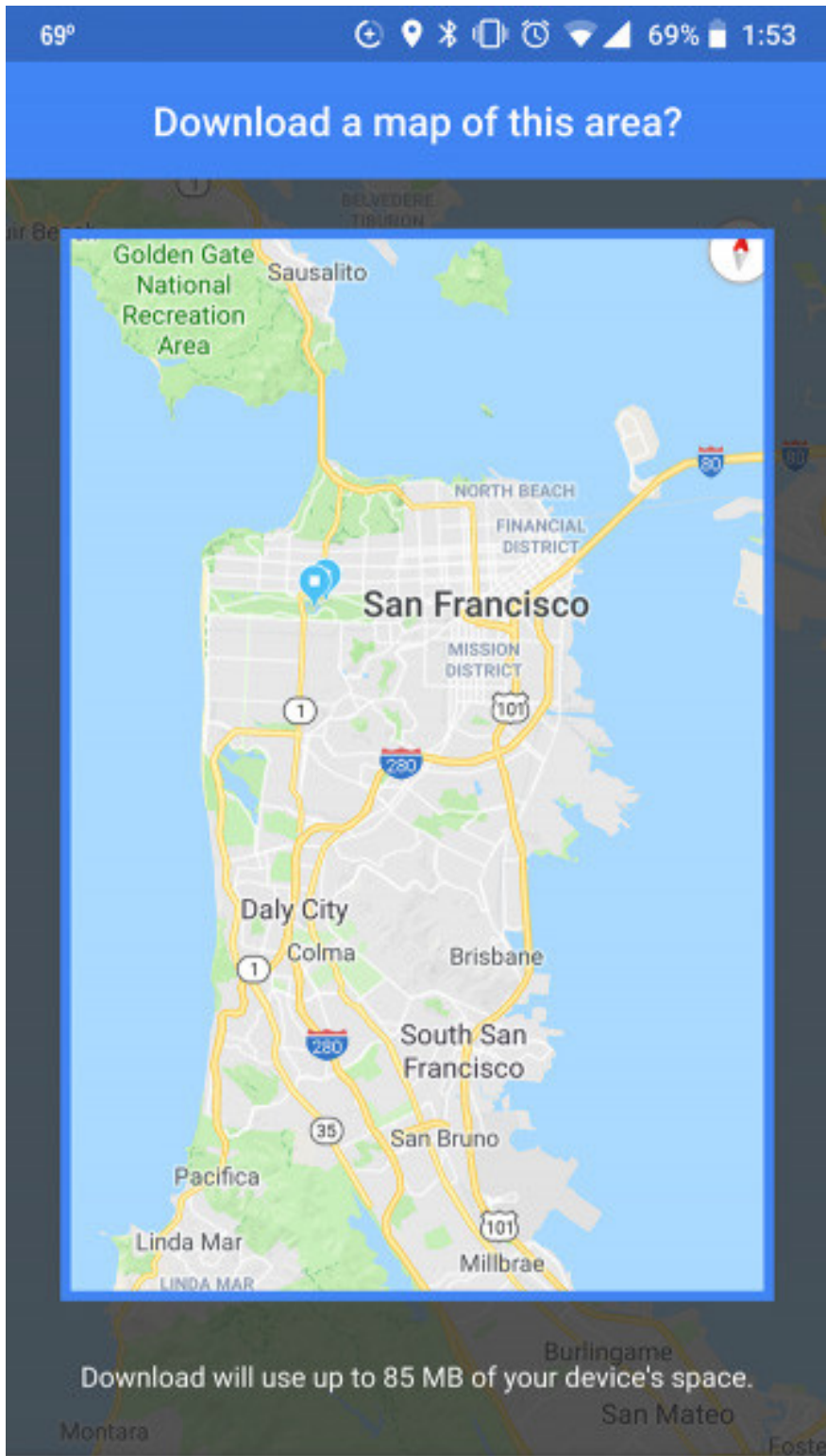

There are several ways you can save data when using Google Maps:

1. To download parts of Google Maps for offline use, go to **Settings> Offline maps> Select your own map** . Google Maps will tell you how much space you need to save offline maps. When you've made your selection, press **Download** to save the map to your device.
2. Convert **Wi-Fi** sliders **only** on the left menu to force Google Maps to use offline maps. Note that with offline maps, you will not receive walking or cycling directions, alternative routes or traffic information in real time.
3. You can also choose the lite version of Google Maps as Google Maps Go.

See more:

1. Instructions for using Google Maps offline on Android
2. These GPS applications do not need the best Internet connection for Android

## Save more data with Android system tips

Android OS itself also provides many ways to control data usage.

You can check which applications are using the data and adjust the general settings by going to **Settings> Network & internet> Data Usage** . Click **Data Saver** and enable this feature. This will prevent applications from sending or receiving data in the background.

You can also click on **Mobile Data Usage** to see the **data usage** analysis by application. Click on each application and turn off **Background data** to prevent them from using mobile data when not open.

Google also released **Datally** application, claiming it could help users save up to 30% when using data.

I wish you all success!

See more:

1. 10 ways to save mobile data on Android
2. 5 mobile data management applications on iOS, Android
3. What to do when mobile data does not work on the Android device?

You finished reading the article "**These 15 popular Android apps can leak your mobile data**" edited by the [TipsMake](#) team. We hope this article has provided you with many useful tech tips and tricks. You can search for similar articles on tips and guides. Thank you for reading and for following us regularly.