

Summary of some ways to fix black screen of Windows 10

Windows 10 has proven to be a reliable operating system, but however like other versions, in the process of using Windows 10, users may face many problems. One of the 'worst' problems that users often encounter is a black screen error.

Windows 10 has proven to be a reliable operating system, but however like other versions, in the process of using Windows 10, users may face many problems. One of the "worst" problems that users often encounter is a black screen error.

Black screen error may occur in some situations on Windows 10, stemming from graphics card problems, connection errors between your computer and your monitor, an error occurs during installation operating system, updating new versions . or simply can happen randomly at any time.

In the following article, Network Administrator will guide you to some solutions to fix black screen error of Windows 10.

In addition, if you encounter a black screen error on your Windows 7, 8 and Windows 8.1 computers, the reader can refer to the steps to guide errors here.

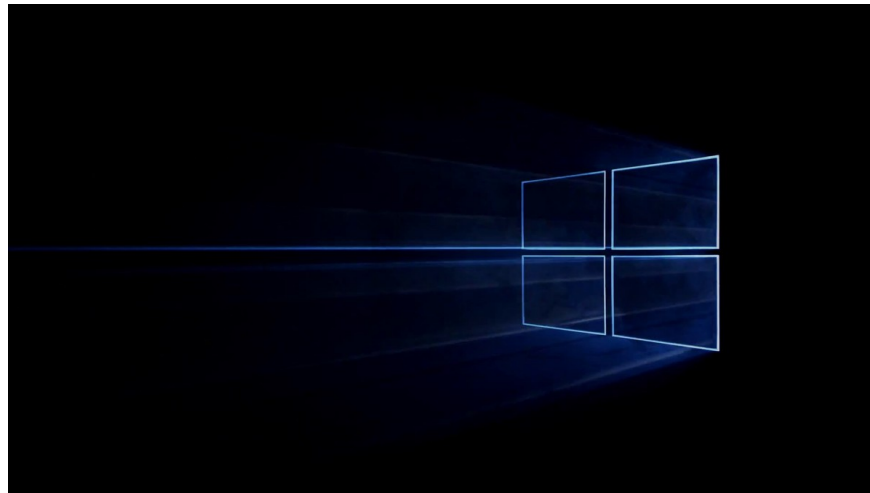

Fix the error of the Windows 10 computer screen

1. During the installation process

If you encounter a black screen error during the installation process, depending on the hardware and data on your device, the operating system may still be running in the background. In some cases it may take several hours to complete the process.

The best solution in this case you can apply is wait, but if the process lasts about 3 to 6 hours, it is very likely that the installation process has been suspended.

And if the installation process crashes, you should try turning off your device completely. You can force your computer to turn off by pressing and holding the Power button for about 10 seconds or waiting until the computer is completely powered off, then unplug the charger cord.

In case if you're using a laptop, the ideal solution is to remove the laptop battery if possible.

Make sure that unnecessary external devices such as external hard drives, phones, printers, USB cables, game controllers and secondary monitors are disconnected.

If possible, you should also turn off the Wifi card and Bluetooth card. Leave only the necessary connections with your computer such as keyboard, mouse and screen.

Wait for about 60 seconds, then insert the battery and power cord, but do not connect any external devices and turn on your computer.

If it is just a small problem, a little trouble, the installation process will continue and complete. After displaying Windows 10 Desktop screen you can reconnect external devices and other devices.

If the installation fails and returns to the old state, proceed to disconnect all external devices and try installing Windows 10 update again. Or you can use USB Bootable drive to install the operating system.

2. Check carefully the video connections

If your computer displays a black screen error before logging into Windows 10, the most likely cause is a connection problem between your computer and the monitor.

In this case, if you are using a Windows computer, make sure that the monitor connection is properly connected to the power outlet.

Also another ideal solution is that you can convert to another Video Output port. In many cases, a video driver can be changed and there is no specific reason it can send Video Signal to other Output ports (such as: DVI, HDMI, DisplayPort, Thunderbolt, VGA).

If you install a discrete graphics card, but your computer also has a built-in video processor, then you can convert the video connection to the integrated graphics card in case the graphics card is disconnected. error.

You can also try connecting another monitor to your computer or laptop to check and confirm that the home screen doesn't have any errors.

If the computer does not detect the screen, then you can try pressing the Windows + P key combination, then press P again and press Enter. Repeat the same step to pass all screen options.

If you are connecting the computer to the TV, double-check that the TV is turned on and make sure you have set the Input correctly to connect to the device.

3. Try "wake up" the screen

In many cases Windows 10 failed to detect the screen. You can use the **Windows + Ctrl + Shift + B** key combination to "wake up" the screen in this case.

4. Disconnect unnecessary devices

External connected devices may cause black computer screen errors. In this case, try disconnecting the entire external device and check if the error is still there.

If everything returns to its original normal state and no black screen error appears, then you can try reconnecting each external device to your computer. If the computer has a black screen error again, then you can determine which device is causing the error.

Disconnect your device, then restart the computer and if the device continues to have a black screen error, contact the manufacturer for assistance.

5. Boot your computer in Safe Mode to fix the black screen error

If the above solutions are applied and the error persists, you can boot the computer into Safe Mode and try to fix the error.

To boot the computer into Safe Mode, there are many ways. You can follow the steps below:

1. Start your computer.
2. Right on the sign-in screen, press and hold **the Shift key** , then click **the Power** button in the bottom right corner of the screen, and select **Restart** .

If you don't see anything because the screen has a black error, then you start your computer, see the blue Windows logo appear, press the Power button and start the computer again. Repeat the same steps 3 times until Windows 10 Automatic repair is activated. Follow the instructions on the screen and open the Advanced options menu.

3. On the Advanced Startup Menu window, click **Troubleshoot** .

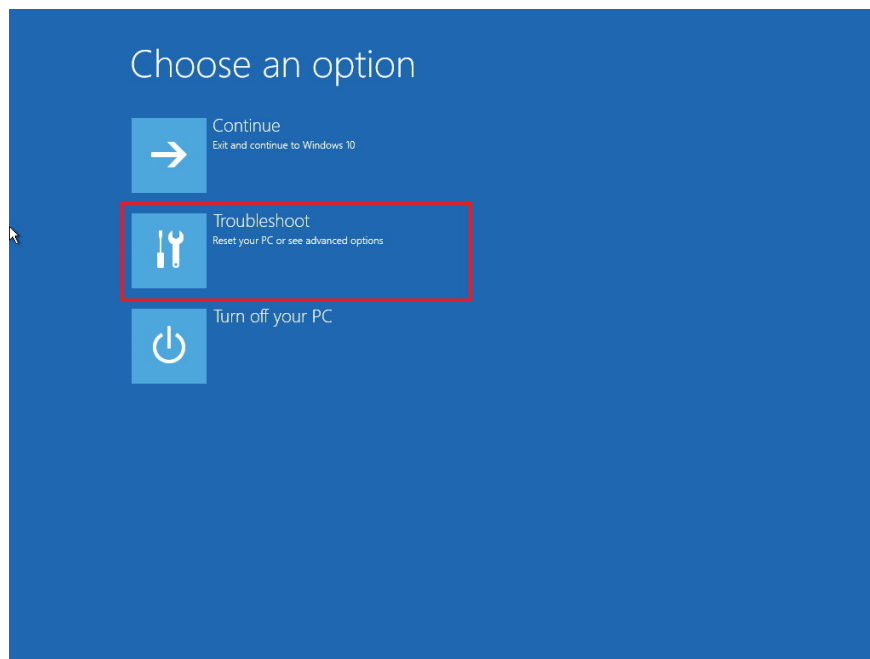

4. Click **Advanced options** .

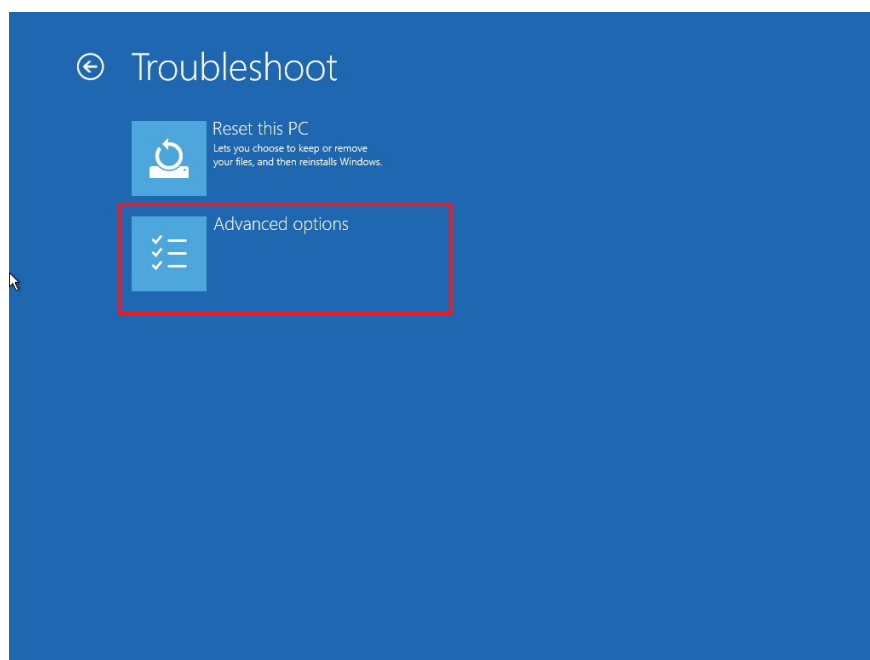

5. Click to select **Startup Settings** .

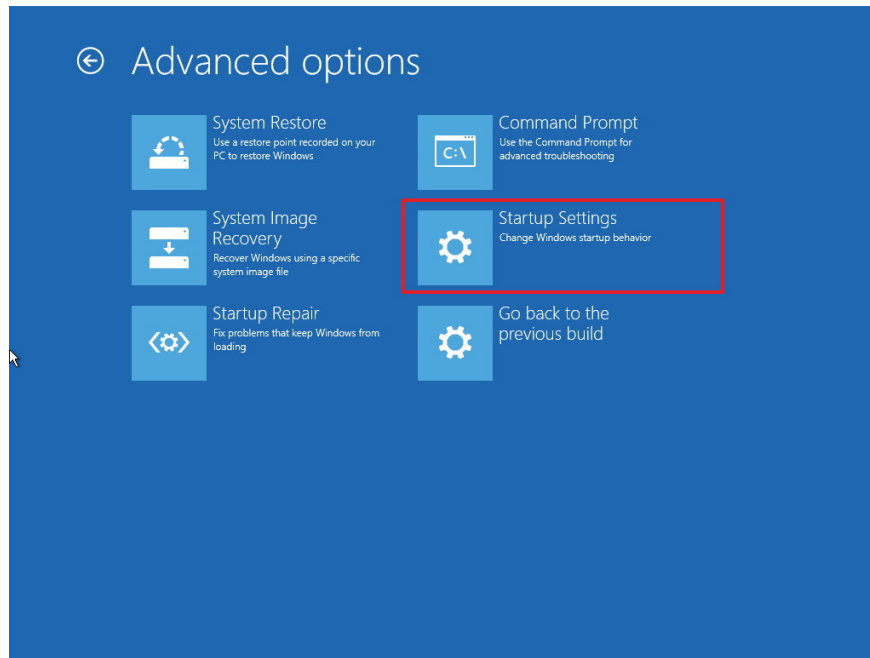

6. Click **Restart** .

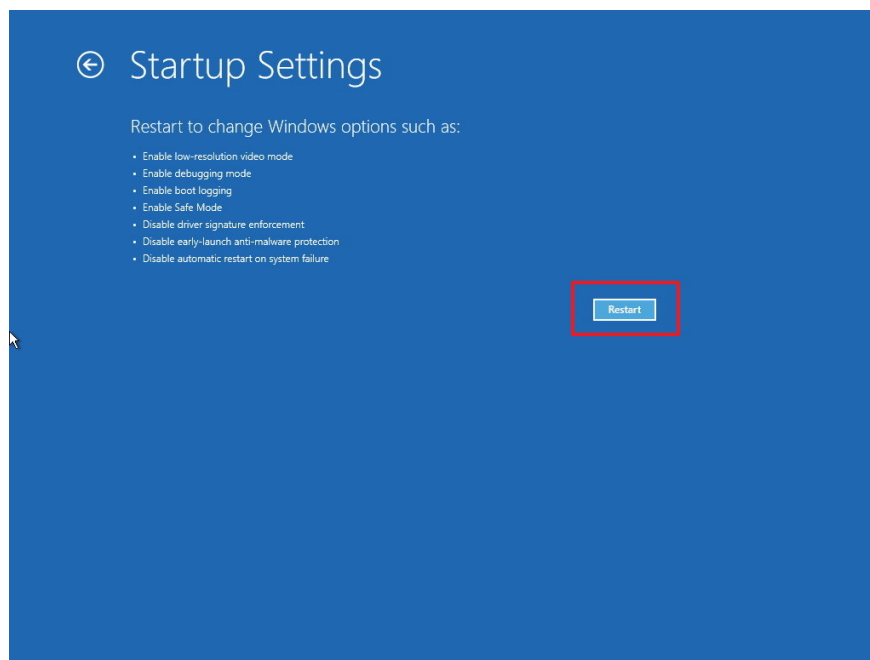

7. On the Startup settings window, press **F5** or **5** to access **Safe Mode with Networking** .

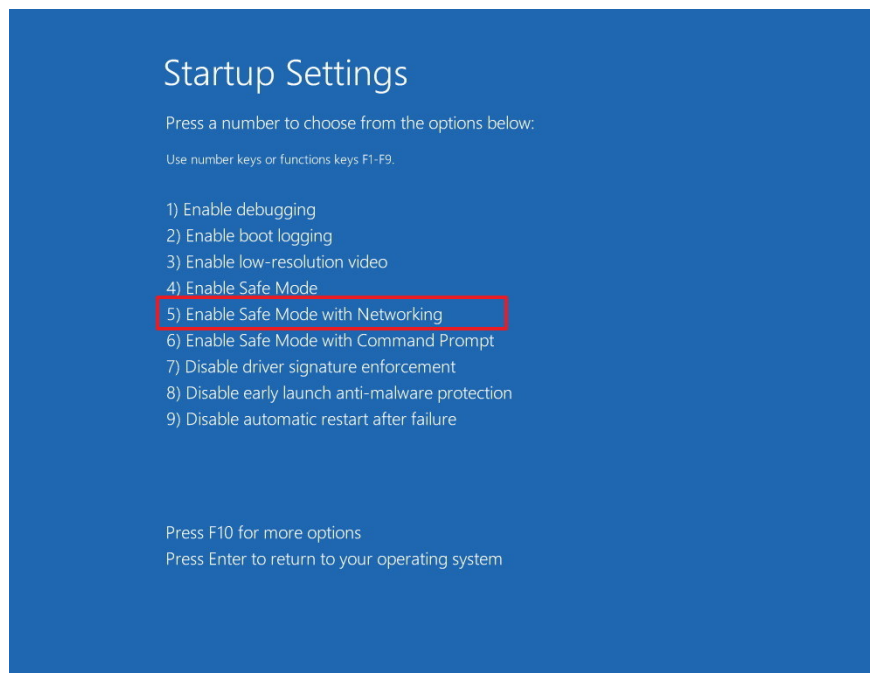

After your computer has booted into Safe Mode, follow the steps below:

Reinstall the video driver

Another cause of a black screen error is an update of the graphics card driver (update). Often an update error (update) of a graphics card driver occurs during the update (update) of Windows 10.

In other cases, the problem is not an update error (update), the video driver may cause the error and display the black screen.

If the video driver does not work properly, you can uninstall the video driver in Safe Mode, then allow the operating system to automatically reinstall the driver after it has finished booting.

1. Press **Windows + X** key combination to open **Power User Menu** and select **Device Manager** .
2. Expanding **Display Adapters** .
3. Right-click the network card and select **Uninstall** .

Tip : You can also select the option to **Delete the driver software for this device** to remove drivers from the computer. In some cases this option is recommended, but if the operating system cannot find the driver online, you will have to download the correct driver for the video card on the computer manufacturer's home page.

4. Click **OK** to confirm.

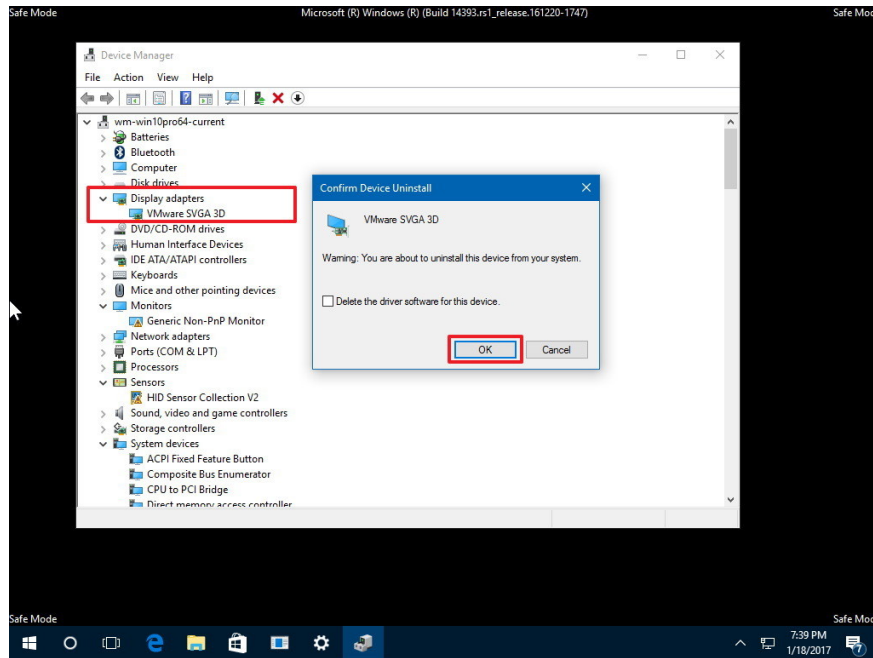

5. Start your computer to confirm.

After your computer has finished booting, Windows 10 will automatically reinstall the video card driver and the black screen error may not appear again.

Disable Fast Startup

Sometimes Fast Startup enabled on your computer is also one of the causes of black screen errors. When the computer boots into Safe Mode, follow the steps below to activate Fast Startup:

1. Open **Control Panel** .
2. On the Control Panel window, find and click **System and Security** .
3. Click **Power options** .
4. Select link **Choose what the power button does** in the left pane.
5. Click the **Change settings** link **that are currently unavailable** .

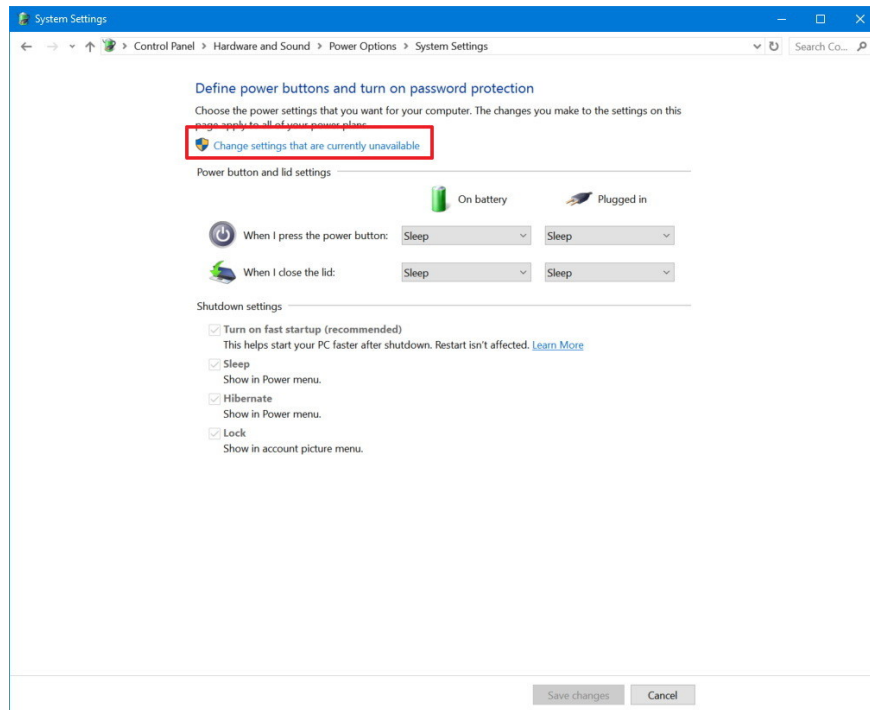

6. Leave the **Turn on fast startup option (recommended)** .

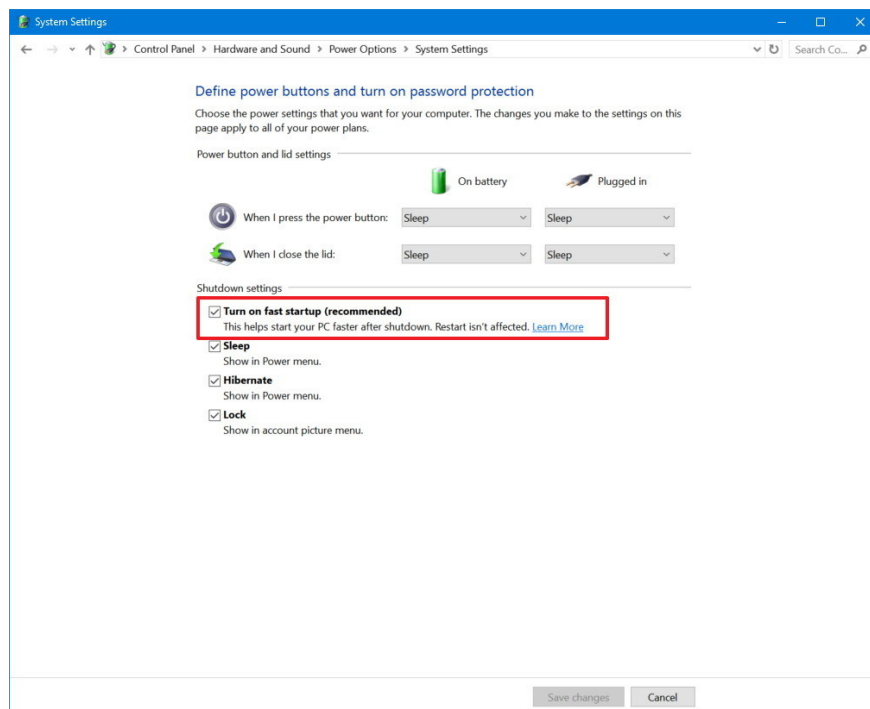

7. Click **Save changes** .

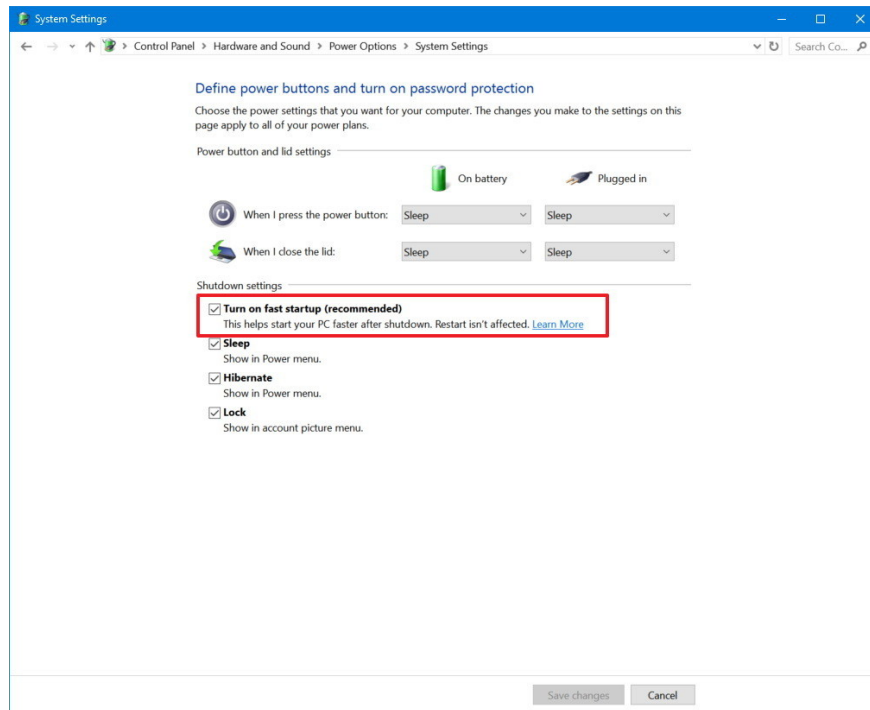

8. Restart your computer to complete the process.

Important note that depending on the hardware configuration, your computer may not support Fast Startup.

Disable High Contrast

If High Contrast is enabled on the computer, it may also cause a black screen error.

When in Safe Mode you can turn off High Contrast by following the steps below:

1. Open **Settings** .
2. On the Settings window, find and click to select **Ease of Access** .
3. Click **High contrast** .
4. Select **None** from the drop down menu to turn off High Contrast.

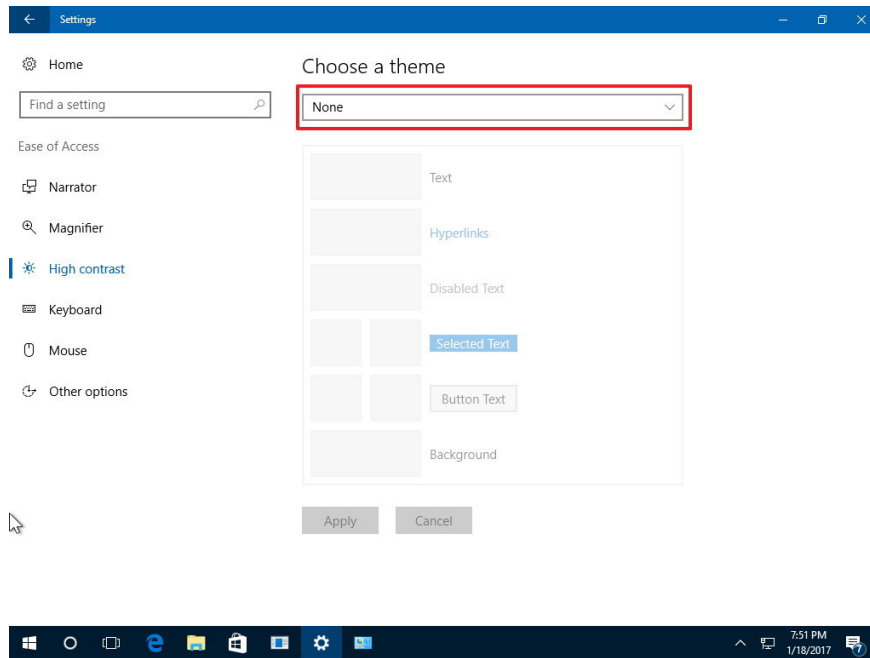

5. Restart your computer to complete the process.

Turn off the Run Once process

Process Run Once can also cause a black screen error after logging in to Windows 10.

To turn off the Run Once process on Windows 10, follow the steps below:

1. Press **Ctrl + Shift + Esc** to open the Task Manager window.
2. Check the **Processes tab** and the **Services tab** , then find any instances of **RunOnce.exe** and **RunOnce32.exe** .
3. If you find an instance in the **Processes tab** , select that instance and click **End task** . If you find an instance in the **Services tab** , right-click it and select **Stop** .
4. Click **File** .
5. Select **Run new task** .
6. Enter the following command to restart your computer:

```
shutdown -t00 -r
```

7. Click **OK** to execute the restart command.

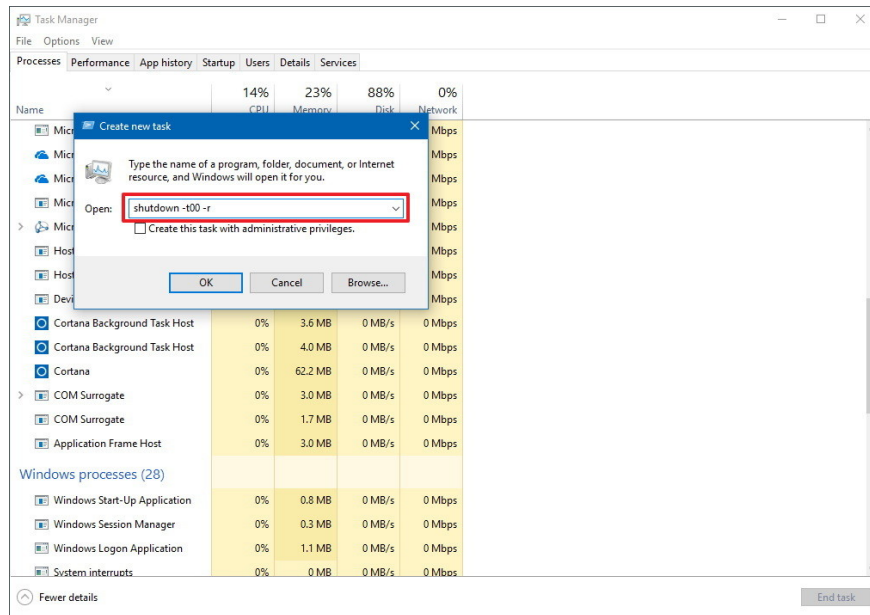

8. Restart your computer to complete the process.

Create a new user account

A faulty user account can also cause your computer to have a black screen error.

If your user account is faulty and this is the cause of a black screen error, then you can create a new account in Safe Mode.

To create a new user account in Safe Mode, follow the steps below:

1. Open **Start** .
2. Enter the **Comamnd Prompt** keyword in the Search box and press **Enter** .
3. On the search results list, right-click the **Command Prompt** and select **Run as an Administrator** .
4. Enter the following command into the Command Prompt window and press Enter:

```
net user tempuser / add
```

Note: In the above command, remember to change "tempuser" with the user account name you want to create.

5. Enter the following command to change the account type to Admin account and press Enter:

```
net localgroup administrators admin / add
```

```
Safe Mode Microsoft Windows (R) Windows (R) (Build 14393.rs1_release.161220-1747) Safe Mode
Administrator: Command Prompt
Microsoft Windows [Version 10.0.14393]
(c) 2016 Microsoft Corporation. All rights reserved.
C:\WINDOWS\system32>net user tempuser /add
The command completed successfully.

C:\WINDOWS\system32>net localgroup administrators tempuser /add
The command completed successfully.

C:\WINDOWS\system32>
```

Note:

Don't forget to change the "admin" in the above statement with your account name.

6. Restart your computer to complete the process.

Note that:

You are using Command Prompt to create an account instead of using the Settings app. This is because Windows 10 does not allow creating a new user account through Settings when in Safe Mode.

After your computer has finished booting, log in with the new account you just created. If the black screen error no longer appears, it can be confirmed that the cause of the error may be due to a problem with the old user account.

Refer to some of the following articles:

- 1. Automatically frees free space on Windows 10 after 30 days
- 1. Summary of several ways to open virtual keyboard on Windows XP / 7/8 / 8.1 / 10
- 1. How to enable the auto-lock feature when users leave - Dynamic Lock on Windows 10

Good luck!

You finished reading the article "**Summary of some ways to fix black screen of Windows 10**" edited by the [TipsMake](#) team. We hope this article has provided you with many useful tech tips and tricks. You can search for similar articles on tips and guides. Thank you for reading and for following us regularly.