

Steps to connect wifi for LG Smart TV

Connecting wifi for LG Smart TV is not too difficult, you just need to follow 4 steps as guided in our article to be successful. When the TV has a network, you will experience many interesting things and download any application in the application store for easy use.

Step 1: Select the **button with the picture of a house (Home button)** on the TV screen



Step 2: Select **the cog icon in the corner of the screen (Settings)** -> Select **Network**



Step 3: Select **Wifi connection** -> Select **the wifi name** you want to access and **enter the password**

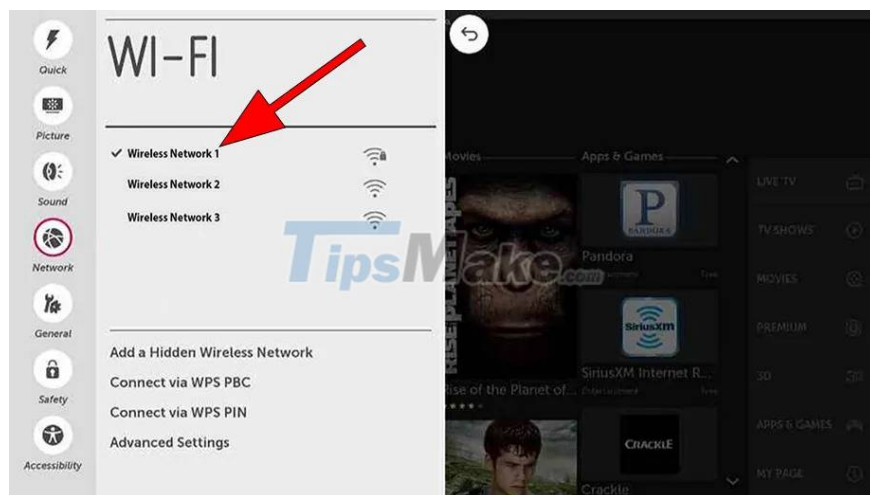
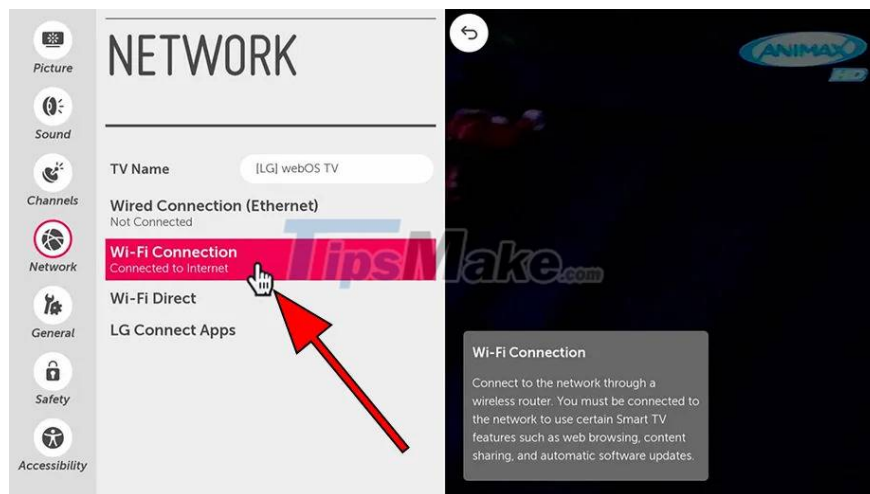

Step 4: Select any application on the TV to check if the TV is definitely connected to wifi.

Thus, with just 4 extremely simple steps, you can connect to wifi for your LG smart TV. Hopefully with this simple guide you will easily connect to wifi on your TV!

If you are looking to buy an LG TV, do not ignore the instructions to read the LG TV name, select the LG TV screen size.

In addition, there are some other good tips when using LG TVs such as: instructions to check the warranty period of LG TVs, download applications on LG TVs or use child lock mode on LG TVs.

You finished reading the article "**Steps to connect wifi for LG Smart TV**" edited by the [TipsMake](#) team. We hope this article has provided you with many useful tech tips and tricks. You can search for similar articles on tips and guides. Thank you for reading and for following us regularly.