

# Set a password for your Excel 2016 file, create a password to protect your Office 2016 Excel file.

Setting a password for your Excel 2016 file helps you maximize the security of your spreadsheets and statistics on your computer. Follow these instructions to set a password for your Excel 2016 file in the Office 2016 suite, preventing others from accessing your Excel file.

Office 2016 was released with an interface and features best suited for use on Windows 10. Using Excel 2016 on Windows 10, users can experience the smoothness and similarity in interface between these two Microsoft products.



However, there will be times when you can open an Excel file but cannot edit it. This isn't actually a bug; the main reason you **can't edit Excel 2016** when opened with Office 2016 is because a protection feature is enabled in the software. Simply disable this feature, and you'll be able to use Excel 2016 to edit files normally again.

Another trick to help you secure your important Excel files is to set a password for your Excel 2016 file. Check out the instructions below from TipsMake.

[Set a password for your Excel 2016 file.](#)

To set a password for a file in Excel 2016, you need to download the Office 2016 suite. This is a comprehensive suite of applications including Word, Excel, and PowerPoint 2016 versions.

Download Office 2016 here: Download **Office 2016**

*Step 1:* In the Excel 2016 interface, select **File** .

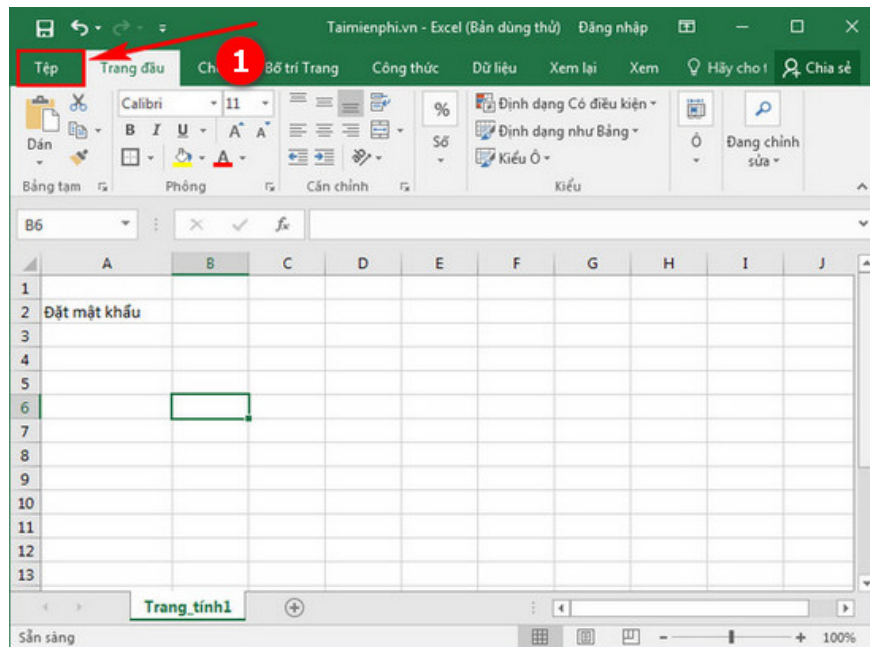

*Step 2:* Select Protect **workbook** .

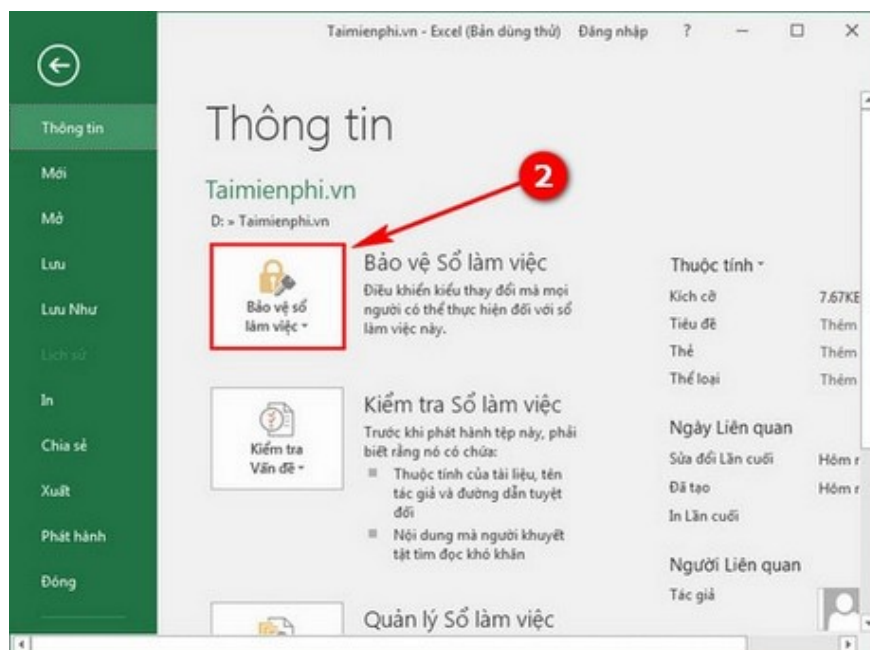

*Step 3:* Select **Password Encryption**.

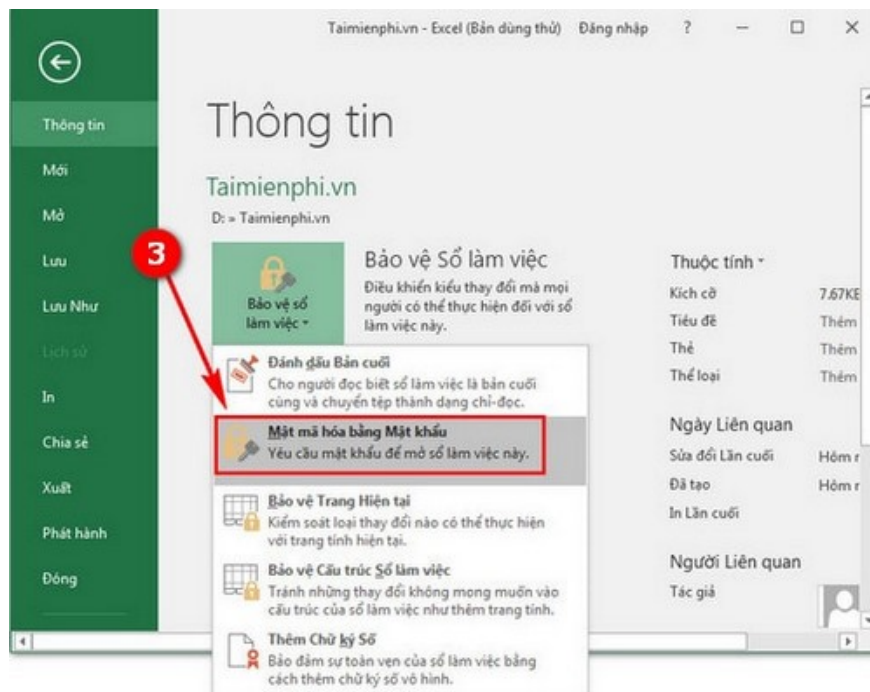

Step 4: Enter your initial password and press **OK** .



Confirm your password again and press **OK** to finish.

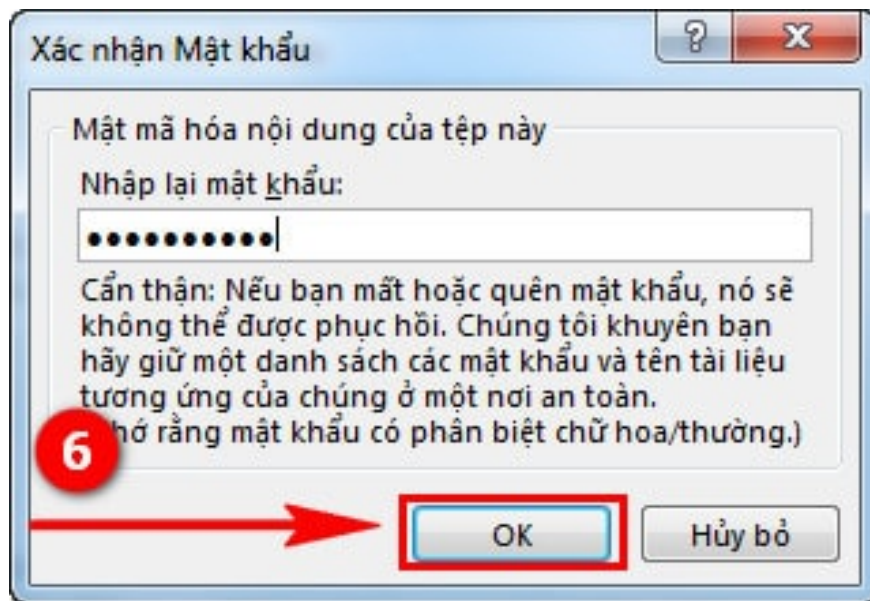

Your Excel file is now password protected. To reopen it, you need to enter the password and click **OK**.

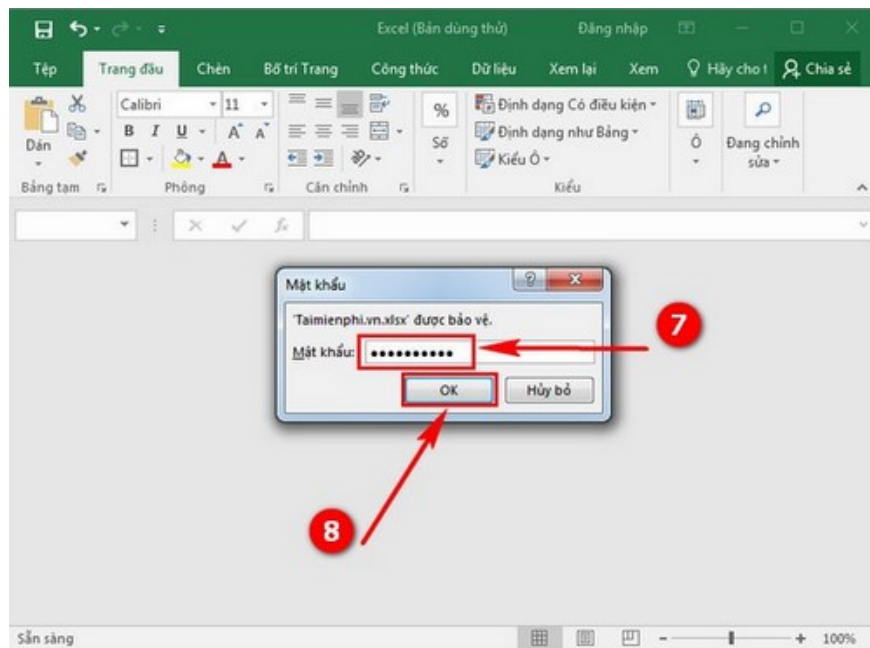

With the above technique for setting a password on Excel 2016 files, you have best protected your spreadsheets and documents.

Another useful way to read Excel files is to convert Excel to Word. This is a useful trick for particularly important situations and something you should know. Converting Excel to Word makes it easier to edit data and text within Excel.

You finished reading the article "**Set a password for your Excel 2016 file, create a password to protect your Office 2016 Excel file.**" edited by the [TipsMake](#) team. We hope this article has provided you with many useful tech tips and tricks. You can search for similar articles on tips and guides. Thank you for reading and for

following us regularly.

---