

# Now - Find Friends and Family - Real-time location sharing app

Now is a real-time location sharing social networking app! Invite your best friends to join the app, stay connected with them, and enjoy your life with close ties to everyone around you!

## What is Now?

Now is a real-time location sharing social networking app! Invite your best friends to join the app, stay connected with them, and enjoy your life with close ties to everyone around you!

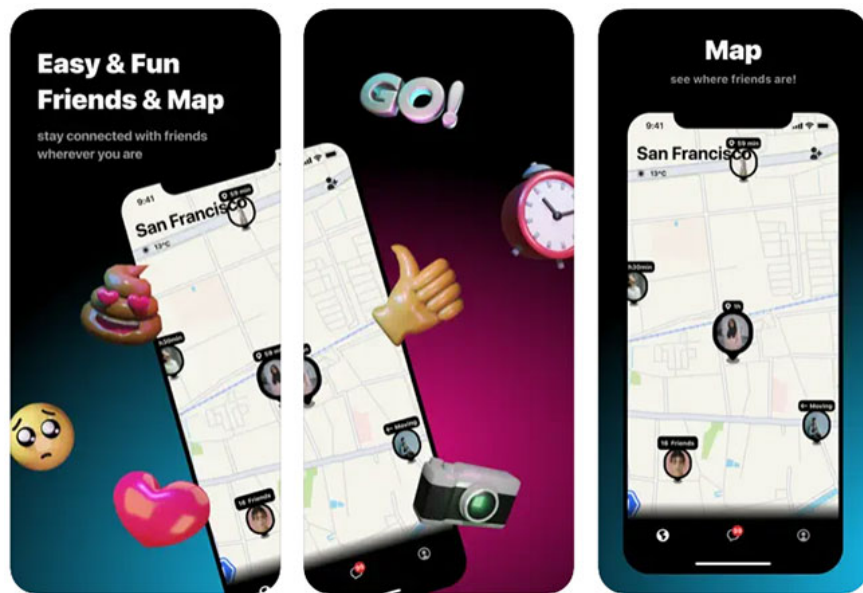

With the Now - Find Friends and Family app, you can:

1. See where your friends are hanging out right now!
2. See who your friends are with!
3. Send fun stamps to your friends!

Now is one of the good replacement apps for Zenly which has just been discontinued!

## Outstanding features of Now - Find Friends and Family

People use Now to:

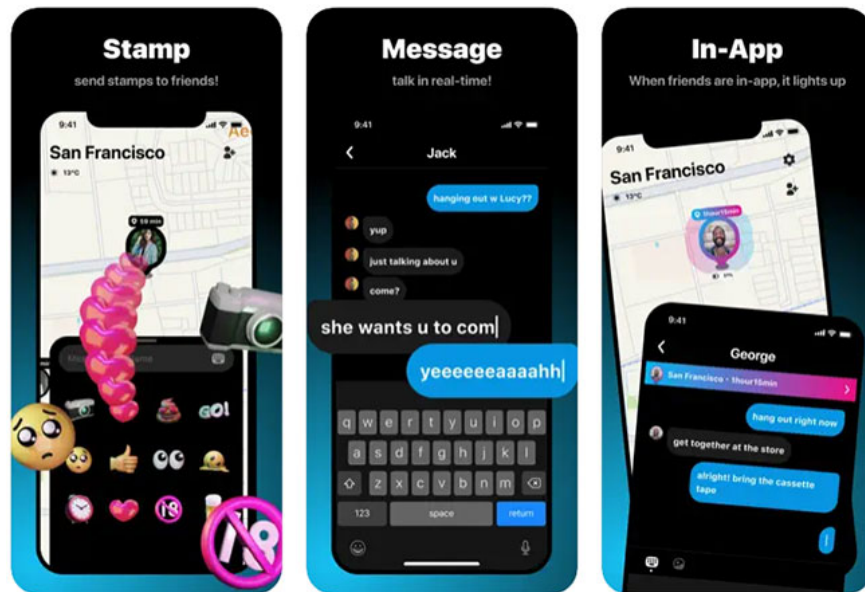

### **Know what your friends are up to**

See your friends' real-time locations, see if they're at home, work, or school, or how long they've been at a coffee shop. You can ask if they're using their phone while it's charging or if the battery is low.

### **See where your friends are visiting**

When you see your friends hanging out, send them a What's up Stamp. They'll send you their fun photos!

### **Find out who is free to hang out with**

You can buy and send Poop Stamps to your friends who are free. You and your friends can plan a party tonight!

### **Extremely useful in case you lose your phone**

Don't worry if you lose your phone on the train or bus you're riding. Your friend can open Now and help you find your phone. You'll quickly know where your device is and get it back.

## **How to use Now app?**

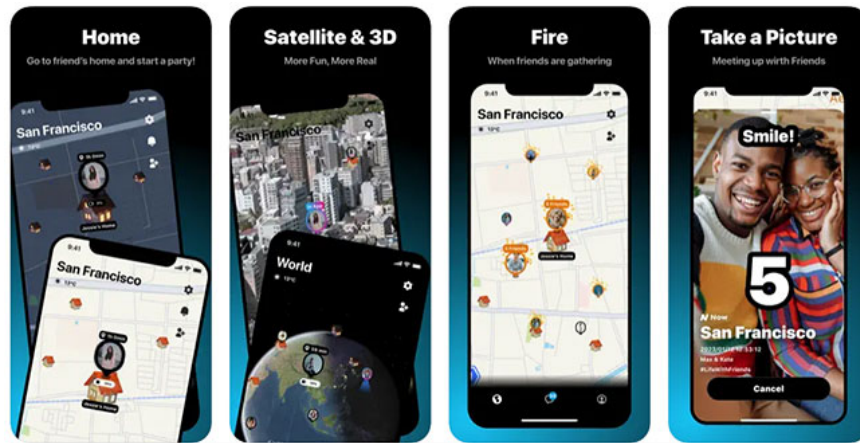

To use the Now app to share your location, you need to follow these steps.

- (1) Create an account with your phone number! The phone number is only used for verification. The app will never make any strange calls.
- (2) Create your profile. Fill in the Name, Username and Birthday sections. Feel free to choose any username you like!
- (3) Set a profile picture. The profile picture should be a picture of you with your friends, so they feel happy when using the app!
- (4) Connect your contacts. You can invite friends and find friends who are already using Now!
- (5) Allow notifications from friends. Don't freak out your friends just because you missed a message from them.
- (6) Allow location access! Only friends can see your location. It is essential to always allow location sharing with friends. Now does not drain your phone battery, so don't worry!
- (7) All that's left for you to do is invite your friends to join Now! Send them your QR code!

Hope you have a great experience with the app!

You finished reading the article "**Now - Find Friends and Family - Real-time location sharing app**" edited by the [TipsMake](#) team. We hope this article has provided you with many useful tech tips and tricks. You can search for similar articles on tips and guides. Thank you for reading and for following us regularly.