

Make app icons of the same size on the Apple Watch home screen

If Reduce Motion is enabled, the icons will be the same size, even if you move on grid view or scroll through a list.

The main screen on the Apple Watch shows all the applications installed on the watch. You can view applications in grid view or list view.

In grid view (on the left), application icons on the border may be difficult to see, because they are smaller than the icons in the middle. The apps at the top and bottom in the list view (on the right) will be a bit smaller than the rest of the options.

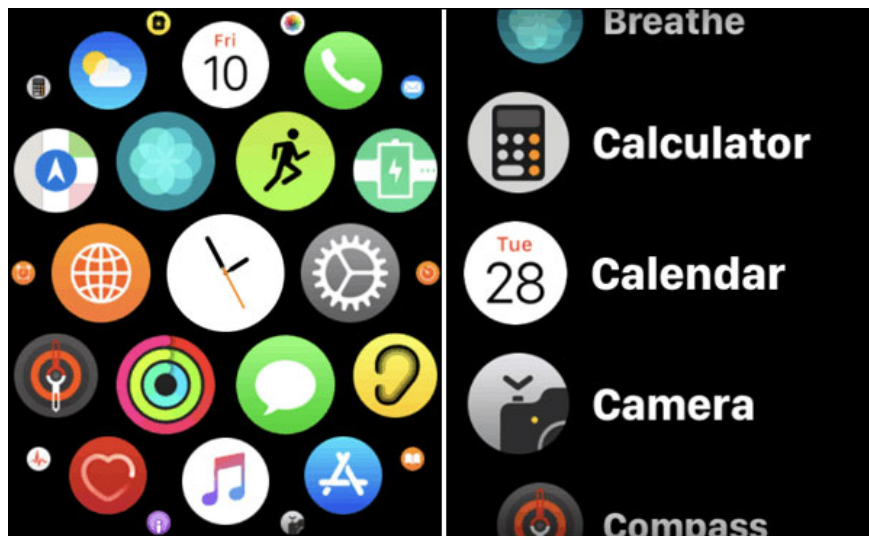

The icons are not the same size

If **Reduce Motion** is enabled, the icons will be the same size, even if you move on grid view or scroll through a list. Here's how to do it!

Activate Reduce Motion on Apple Watch

To change the settings on the watch, press the Digital Crown (the control button on the side of the watch) to access the Home screen.

Then press **Settings**.

Click **Accessibility** on the **Settings** screen .

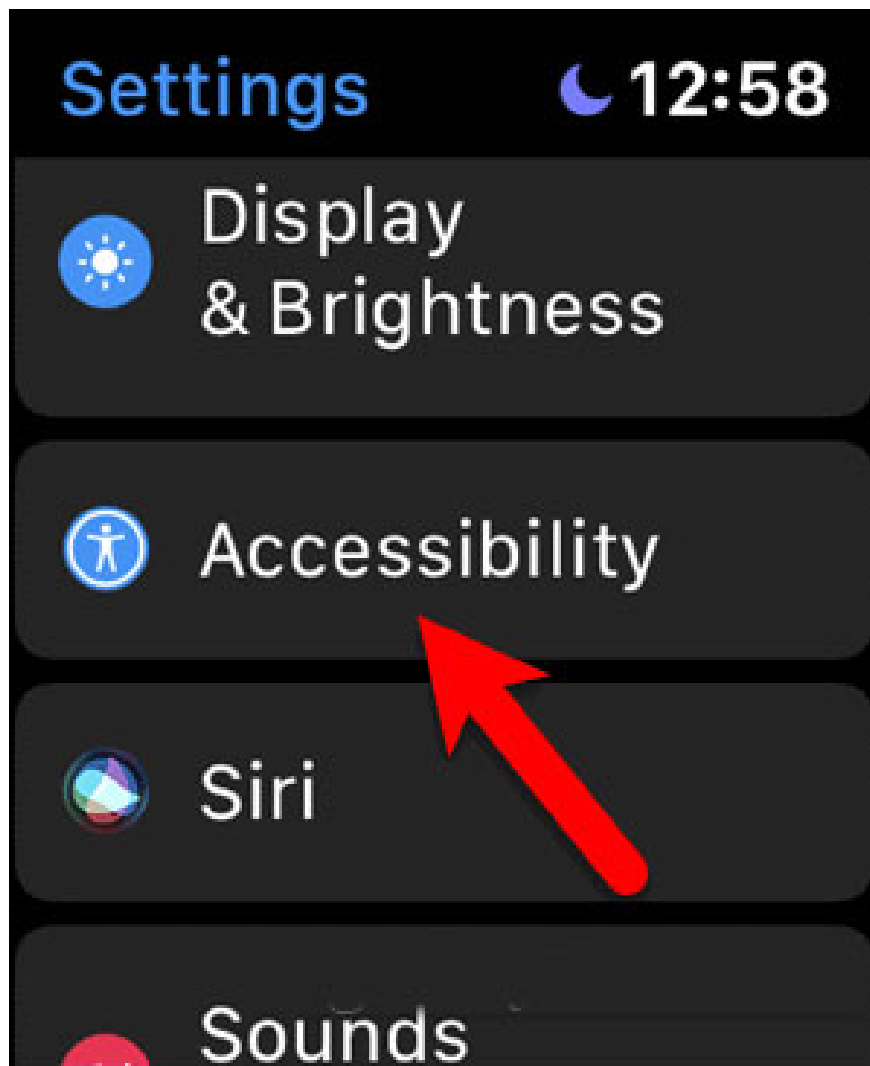

Click Accessibility on the Settings screen

On the **Accessibility** screen , click **Reduce Motion**.

Click the **Reduce Motion** switch to turn on the setting. The button turns green when **Reduce Motion** is enabled.



Click the Reduce Motion switch to turn on the setting

Click Digital Crown to return to the main screen. The icons are now all the same size, even when you move on grid view or scroll through a list.

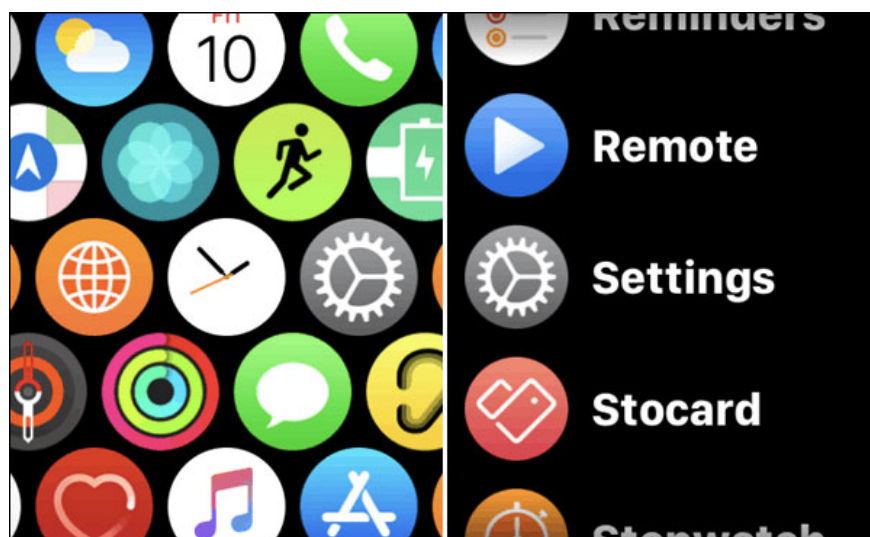

The icons are now all the same size, even when you move on grid view or scroll through a list

Activate Reduce Motion on iPhone

You can also turn off Reduce Motion setting on iPhone. Click the **Watch** icon on the Home screen.

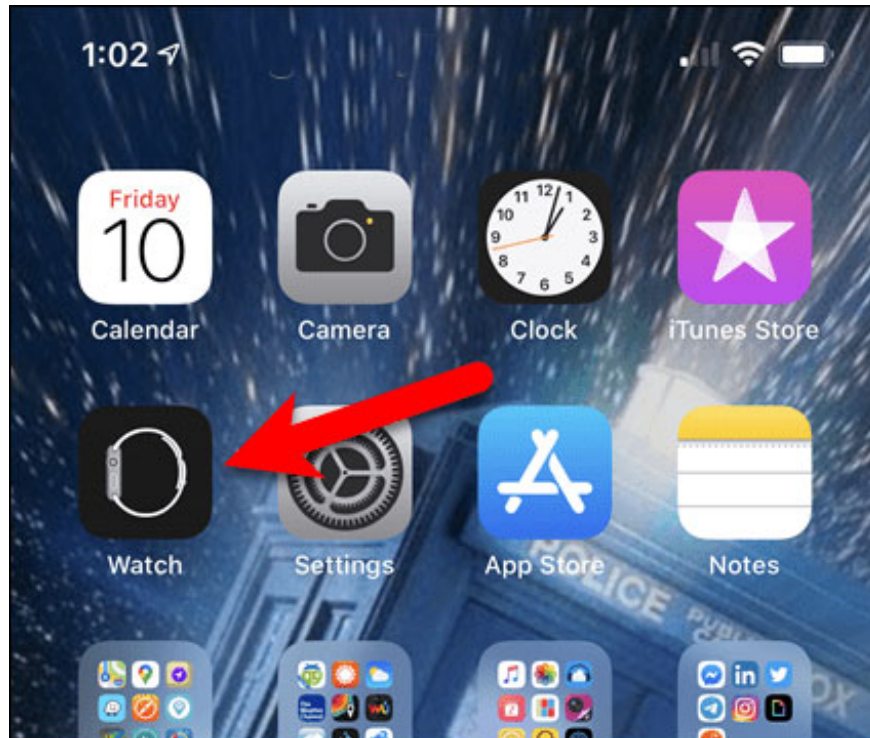

Click the **Watch** icon on the Home screen

If the **My Watch** screen is not working, tap **My Watch** at the bottom of the screen.

Then scroll down and click **Accessibility**.

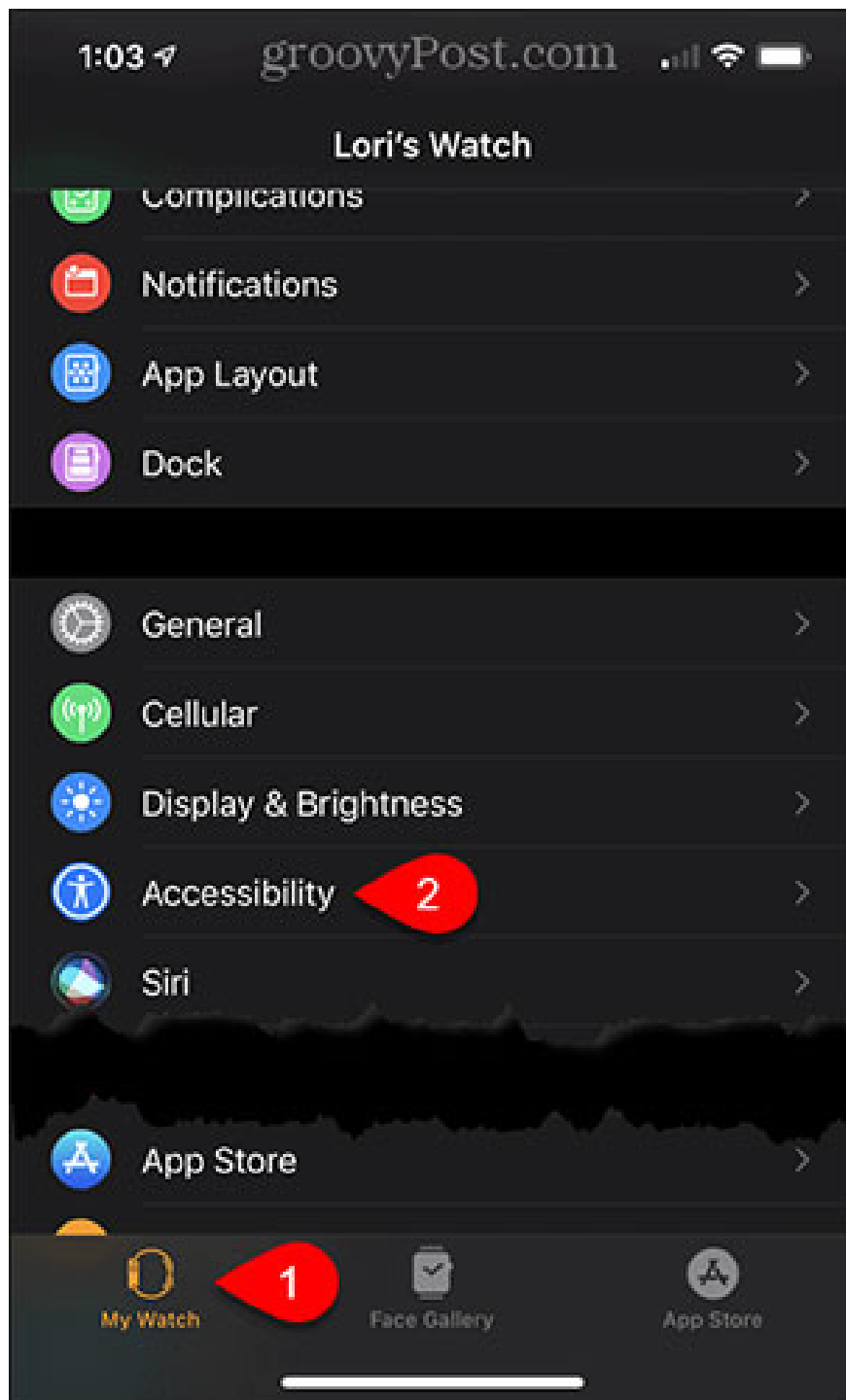

Click Accessibility

Click **Reduce Motion** on the **Accessibility** screen .

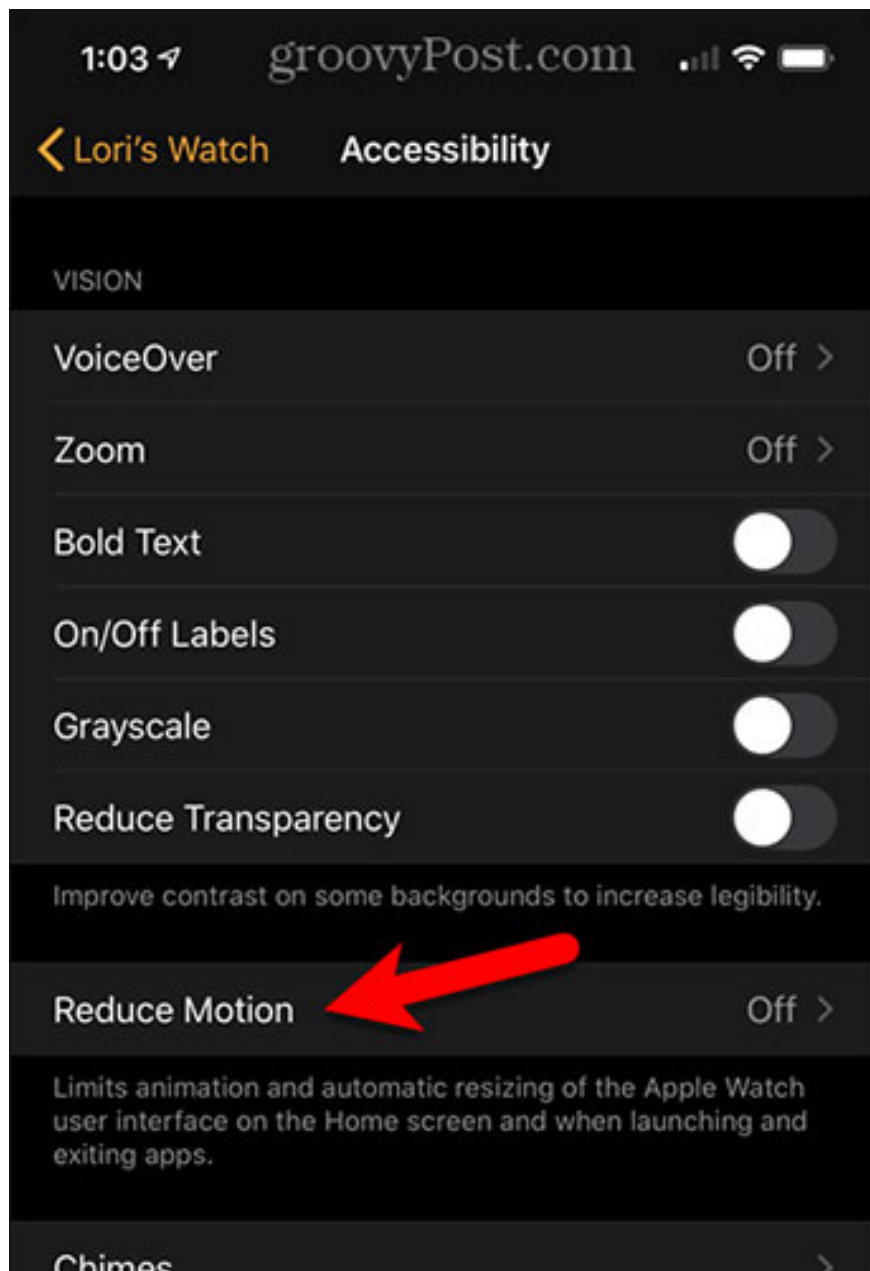

Click Reduce Motion on the Accessibility screen

Click the **Reduce Motion** switch to turn on the setting. This button turns green when **Reduce Motion** is enabled.

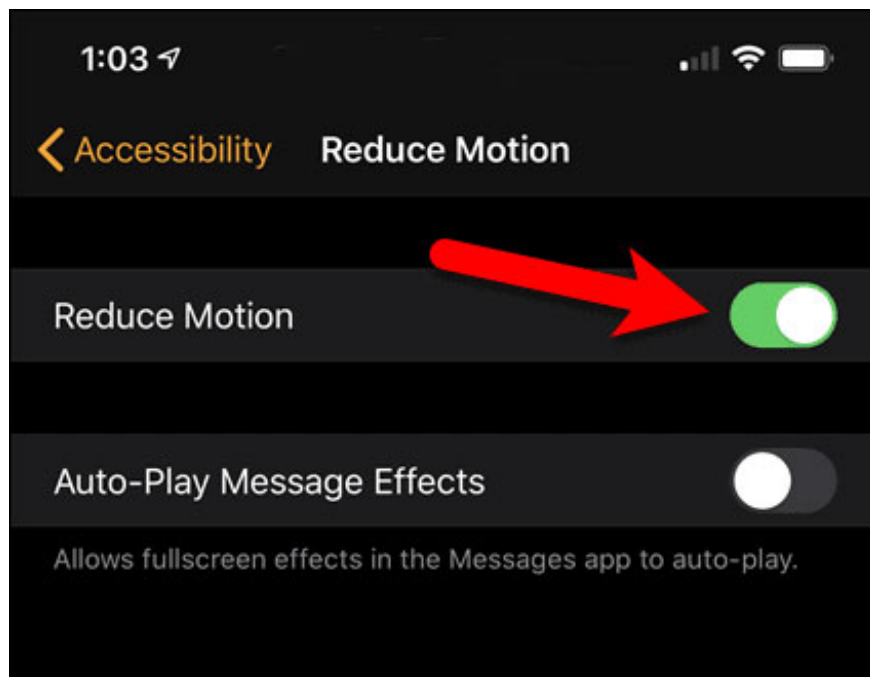

Activate Reduce Motion

Activating **Reduce Motion** setting on iPhone also enables this feature on Apple Watch and vice versa. Also, turning on the Reduce Motion setting will improve the watch's battery life a bit, as the watch won't have to use the battery to move icons on the home screen anymore.

You finished reading the article "**Make app icons of the same size on the Apple Watch home screen**" edited by the [TipsMake](#) team. We hope this article has provided you with many useful tech tips and tricks. You can search for similar articles on tips and guides. Thank you for reading and for following us regularly.