

Instructions to turn off Windows Defender completely on Windows 10

-- Windows Defender is a free antivirus that comes with Windows 10, completely turning off Windows Defender networking to an unexpected effect, helping weak computers using Win 10 to be smoother. Below Techz will show you how to turn off Windows Defender completely on Windows 10.

However, you need to pay attention to a few things before turning off Windows Defender:

If you have already installed or are about to install another anti-virus software, there is no need to do this, as the new antivirus will disable Windows Security automatically.

TipsMake also does not encourage you to disable Windows Defender (except for the unfortunate circumstances & fast machine experience on the weak computer configurations) because it will help the virus easily infect the computer easily. Easiest without any prevention & prevention system.

How to turn off Windows Defender completely

1. Disable Windows Defender with Local group policy

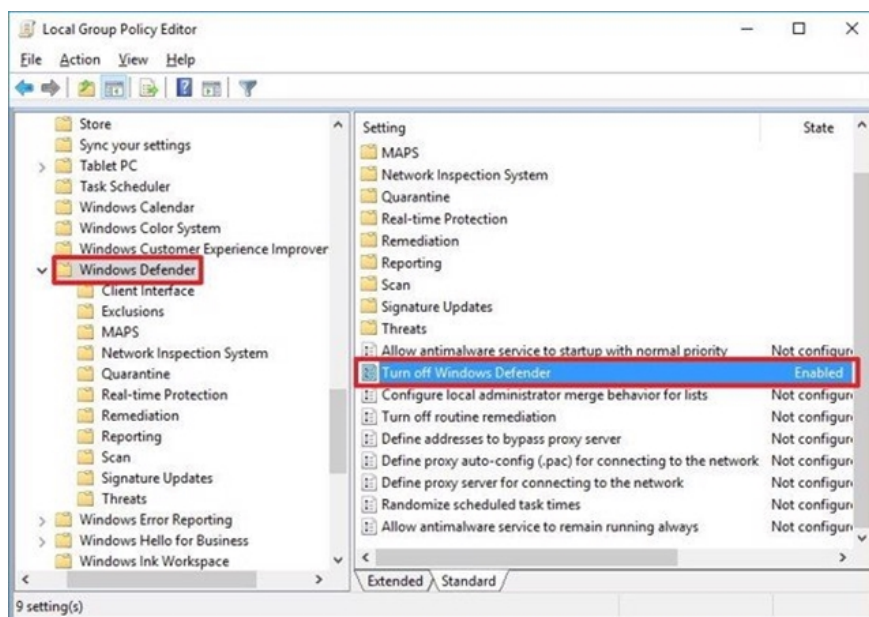

Step 1: You press Windows + R key combination to turn on the RUN command window

Step 2: Once the RUN window is open, type gpedit.msc> Enter

Step 3 : In this window, search in the following direction:

Computer Configuration> Administrative Templates> Windows Components => Windows Defender

Note: On Windows 10 version 1803 and above, the Windows Defender option is replaced by Windows Defender Antivirus, select this and do the same.

Step 4: Here, look in the right pane and look for Turn off Windows Defender

Step 5: Select Enable to apply to disable Windows Defender, select OK

Step 6: After completing the steps, you just need to proceed to restart your computer will be applicable.

2. Completely disable Windows Defender with the Registry

On Windows 10 HOME, you won't be able to access the Local Group Policy Editor. However, you will still be able to disable it by using the Registry

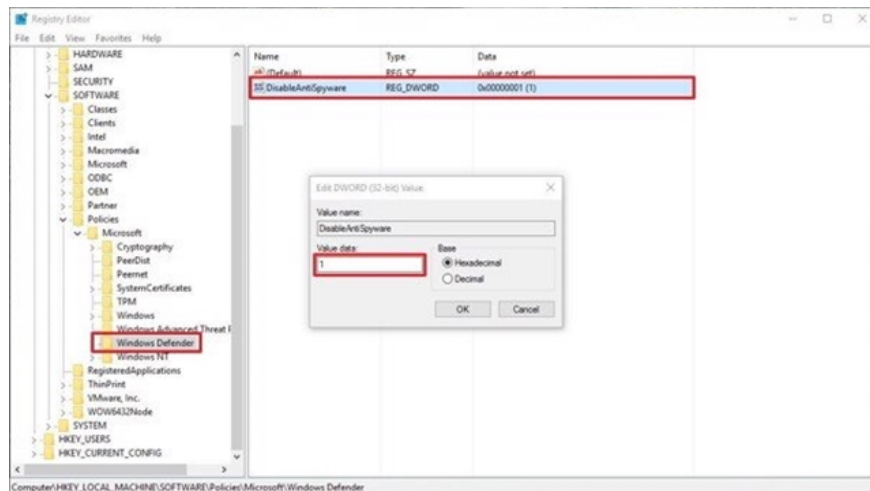

Step 1: You press Windows + R key combination to turn on the RUN command window

Step 2: Once the RUN window is open, type regedit> Enter.

Step 3: Find the following command line:

HKEY_LOCAL_MACHINESOFTWAREPoliciesMicrosoftWindows Defender

Step 4: If you don't find the DisableAntiSpyware line here, right-click in the blank and select New, then select DWORD (32-bit) Value

Step 5: Here, rename the file to DisableAntiSpyware and set its value to 1.

Step 6: Once completed. You restart your computer to be able to apply that setting.

You finished reading the article "**Instructions to turn off Windows Defender completely on Windows 10**" edited by the [TipsMake](#) team. We hope this article has provided you with many useful tech tips and tricks. You can search for similar articles on tips and guides. Thank you for reading and for following us regularly.
