

Instructions on how to enable the Battery Saver function on your laptop.

Let's explore how to enable the Battery Saver feature on your laptop to take advantage of this useful feature in Windows 10 and Windows 11, helping you use your computer more efficiently and save battery power.

Using battery-saving solutions for laptops is always important, ensuring the longest possible computer usage time while improving battery lifespan and preventing laptop batteries from becoming "worn out".



How to enable battery saver mode on your laptop.

Currently, the Windows 10 and Windows 11 interfaces have changed quite a bit in terms of settings, so setting up optimal battery settings can be somewhat difficult for some users. This article will help you set up and enable the laptop battery saving function to improve performance and battery life for your laptop.

How to enable Battery Saver mode on your laptop

1. Enable battery saver mode by quickly opening Action Center.

This is the quickest way to access the settings to enable battery saver mode on your laptop.

Step 1: To open the **Action Center**, tap the button that looks like a sticky note (as shown below) and select "**All settings**".

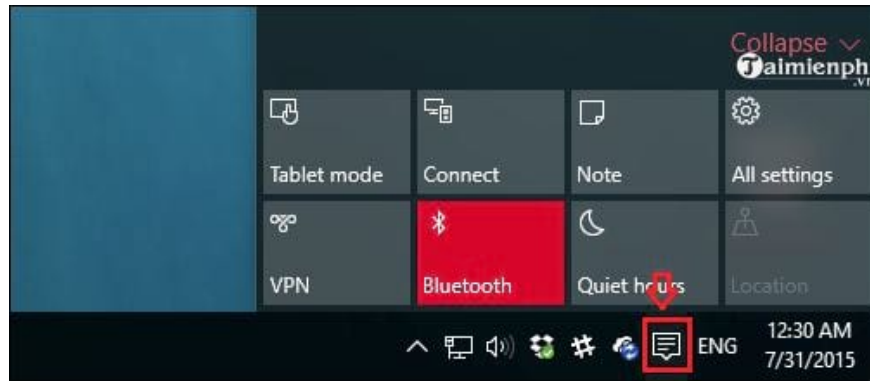

Step 2: On the screen that appears, select **System** .



Step 3: In the **System** section , you will see two settings related to optimizing battery life for your computer: **Battery saver** and **Power & Sleep** (sleep settings, screen off.).

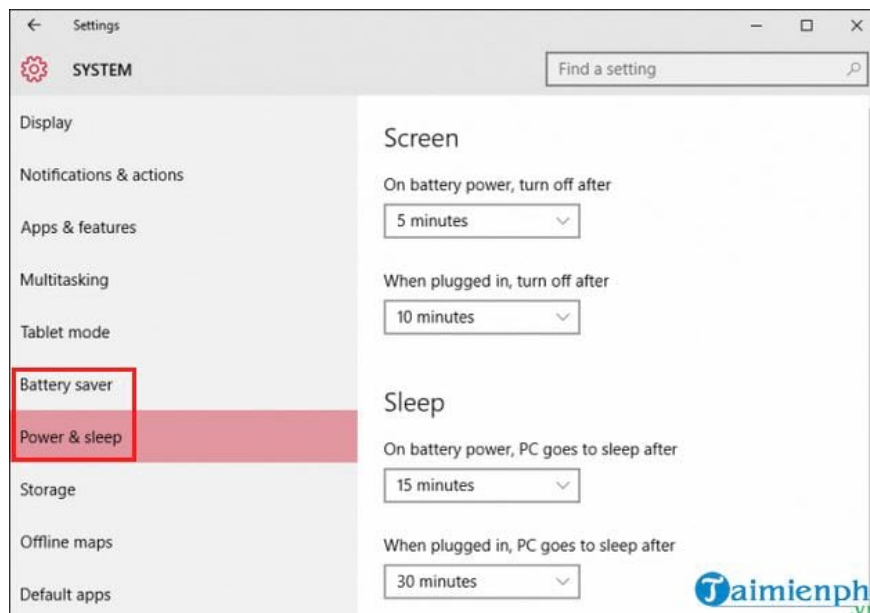

2. Configure the Power & Sleep settings to enable battery saving mode.

- **Screen** section : Set the time for the computer screen to turn off (when running on battery and when plugged in).

- **Sleep** section : Set the time for the computer to go into **sleep** mode (when running on battery and when plugged in).
- Both **the Screen** and **Sleep** sections will help you save a significant amount of battery power when not using the computer continuously.

Step 4: At the bottom of " **Power & sleep** ", there is an additional section called " **Related settings** ".

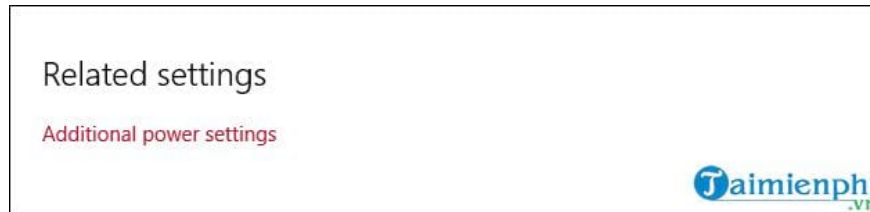

When you click on **Additional power settings**, you will be taken to the **Power Options** interface , which is the setting for saving battery power. The settings in this section are similar to the **laptop battery saving** settings on Windows 7.

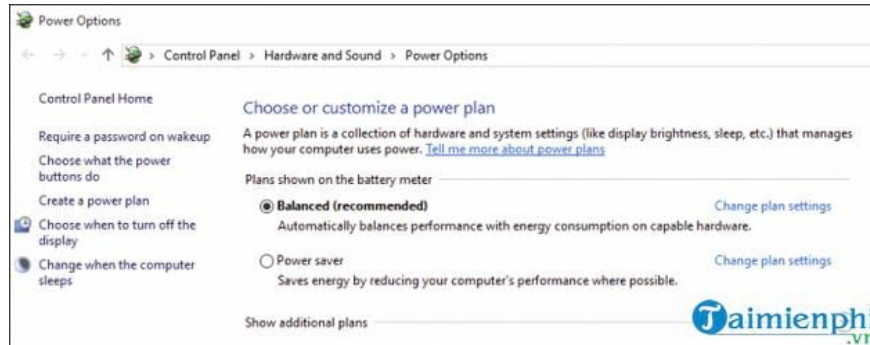

The next section is **Battery Saver**, which enables battery saving mode. When this mode is enabled, it helps the laptop close unnecessary software, reducing performance to save battery power.

3. Install Battery Saver to save laptop battery power.

Battery Saver will work similarly to how it works on mobile phones and tablets. When the battery level drops below a certain point (20% by default), it will automatically switch to power saving mode.

Battery saving mode includes reducing background processes and unnecessary features like Bluetooth, decreasing CPU performance, and offloading the graphics card load, thereby significantly saving battery power for laptops.

Note: If your laptop is plugged in and charging, battery saver mode will not be active.

Step 5: In the **Overview** section , you will see the current battery level and the estimated usage time.

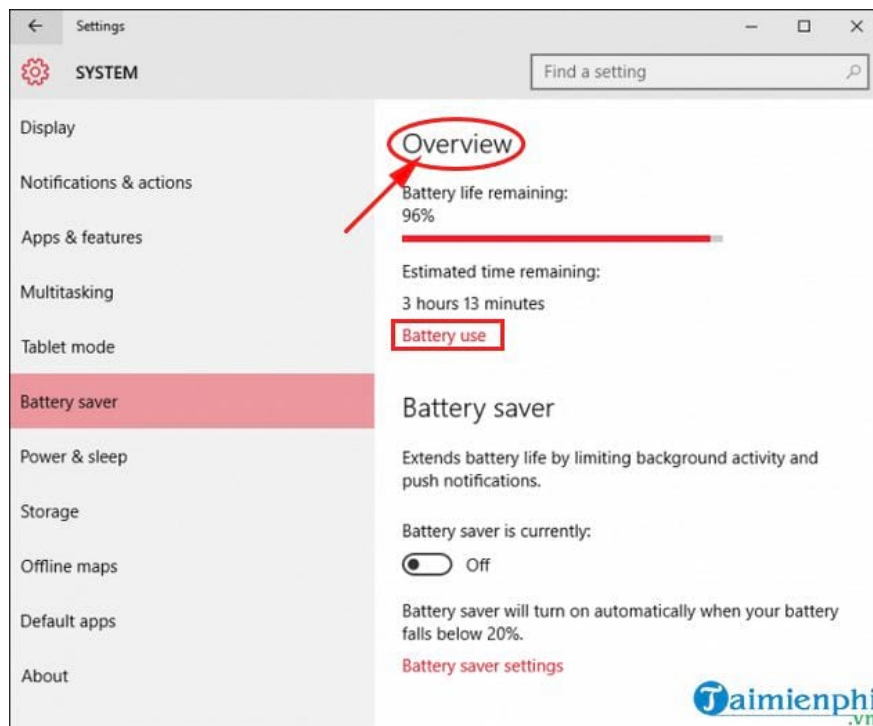

You select **Battery use** (the area circled in red in the image above) -> the software will list the applications that consume the most battery power.

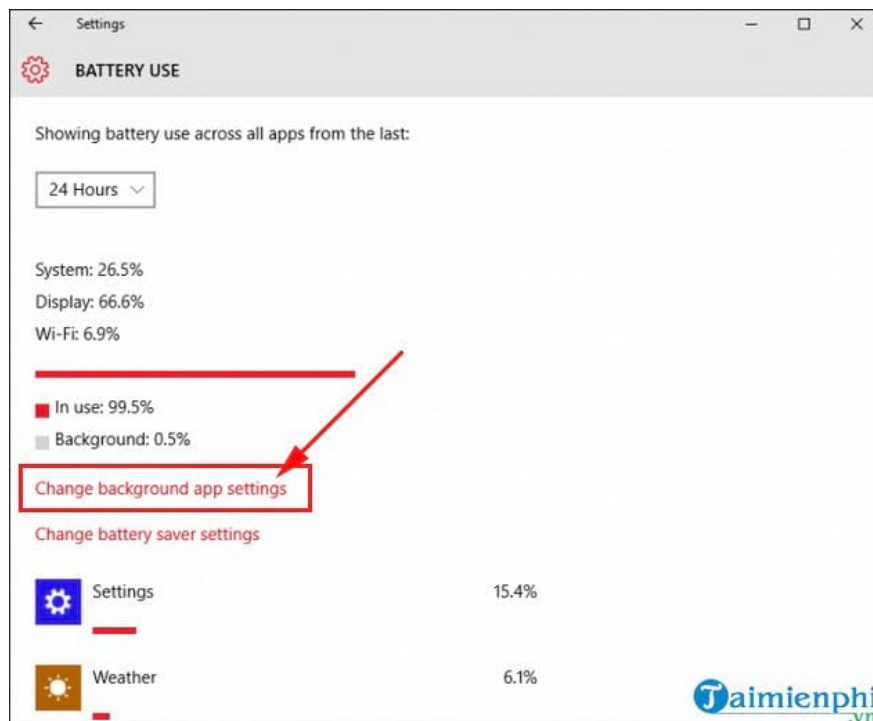

To set which apps are allowed to run in the background, tap on "**Change background app settings**" (the red circle in the image above). In the list of background apps, select the apps you don't use or rarely use and turn them **off** to reduce battery consumption.

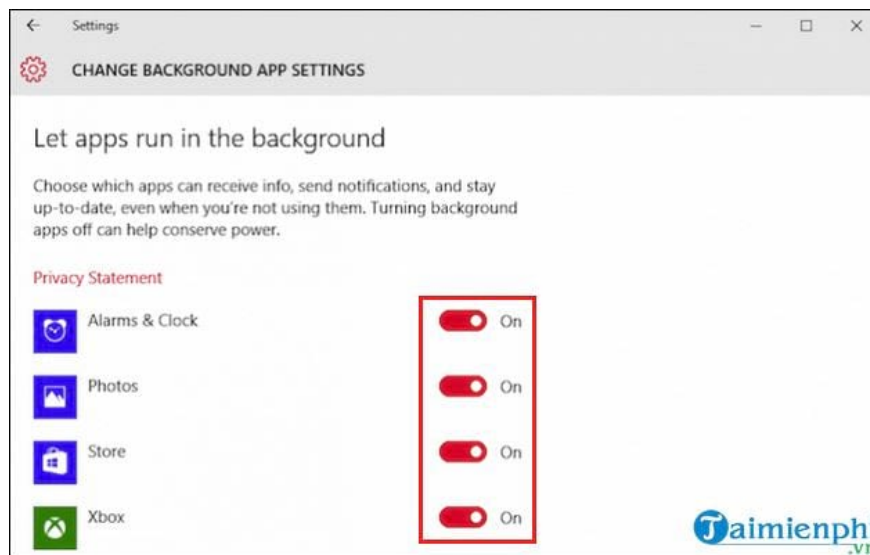

To configure battery saving settings, you can select **Battery saver settings** in the **Battery Saver** section , or you can select **Change battery saver settings** above.

By default, battery saver is configured to be enabled at 20%, but you can set this higher or lower if you want to change it.

You can enable lower screen brightness by checking the box next to " **Lower screen brightness while in battery saver**" .

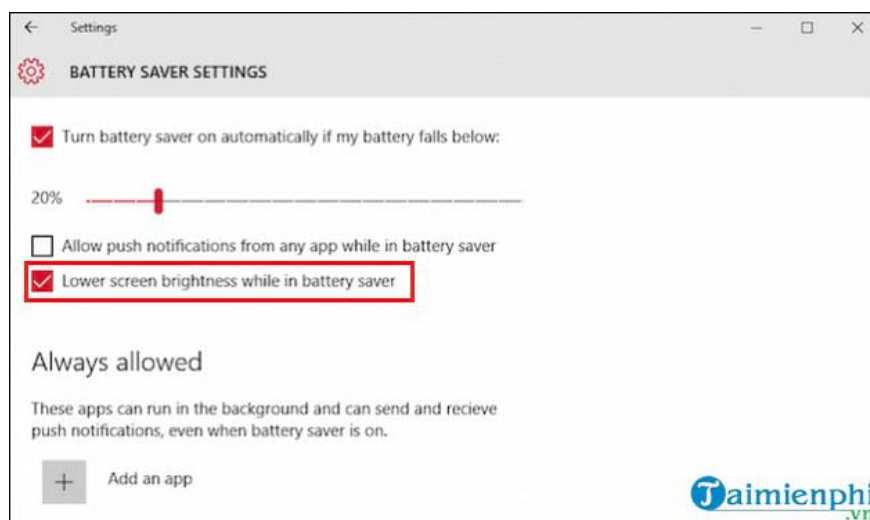

Therefore, to **enable battery saving features on your laptop** , you can use **Power & Sleep** and **Battery Saver**, which will definitely help you save battery power and improve battery life.

If you haven't upgraded to Windows 10 yet, you can download the Windows 10 installer here, and also refer to the Windows 10 installation guide that TipsMake has shared. Good luck!

For Windows 11, you can easily enable battery saver mode and activate God Mode. You can refer to the instructions on how to enable battery saver mode and activate God Mode here.

You finished reading the article "**Instructions on how to enable the Battery Saver function on your laptop.**" edited by the [TipsMake](#) team. We hope this article has provided you with many useful tech tips and tricks. You can search for similar articles on tips and guides. Thank you for reading and for following us regularly.
