

Instructions for installing QuillBot in Microsoft Word

QuillBot is a tool that anyone who is learning English should use. It helps to rewrite and enhance sentences, paragraphs or essays (essay, paragraph, ...) to become more professional thanks to modern AI.

Users only need to enter text and QuillBot's AI will build strange so that the English text still contains the original ideas but with a different, more academic style. In this article, let's learn how to install QuillBot in Microsoft Word to edit your English documents to become more perfect, avoid grammar, spelling errors,.

Instructions for installing QuillBot in Microsoft Word

Method 1: Download via Microsoft Apporrece

Step 1 : Visit the Microsoft Appsource page for the QuillBot app.

Step 2 : Click the **Get It Now** button near the top left of the page.

Step 3 : If you are not signed in to your Microsoft account, sign in to continue. Note that you sign in with a Microsoft account, not a QuillBot account. People need a Microsoft account to download extensions from the Appsource site.

Step 4 : A message as follows will appear, click **Continue** to continue.



Step 5 : This will direct people to a page like the following, click **Open in Word** .

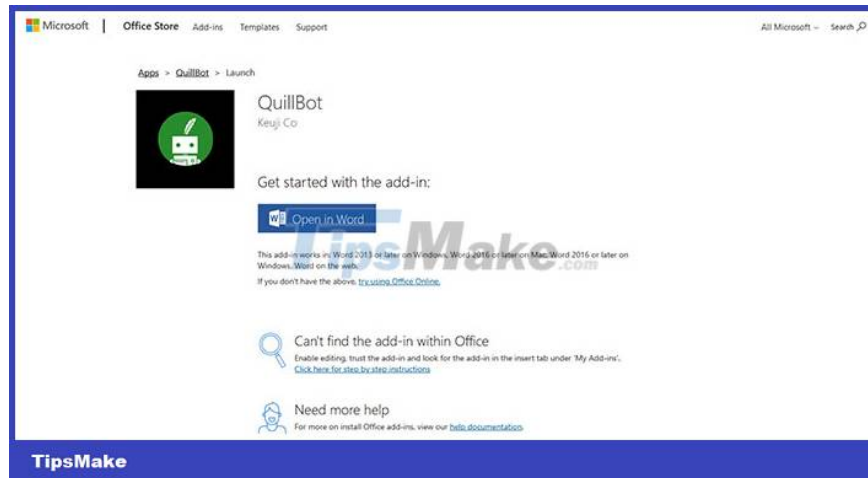

Step 6 : This will open a prompt, select **Word > Open Link** to open Word and install the extension.

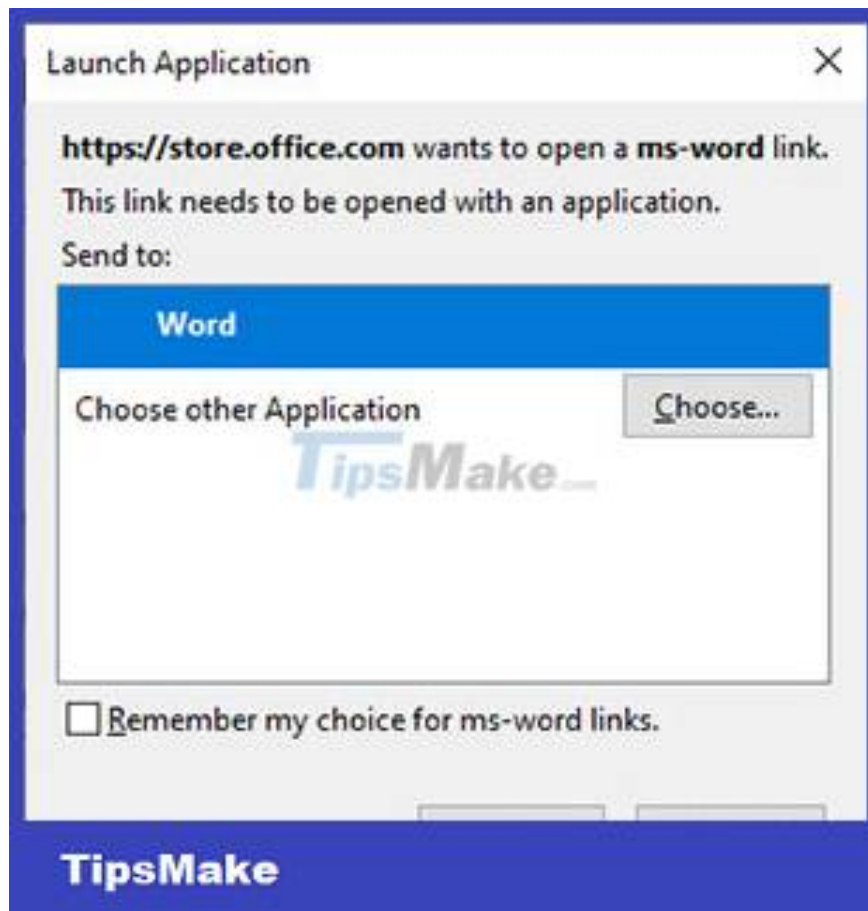

Microsoft Word opens and shows a page explaining how to find the extension, QuillBot will be on the right side. Select **Trust this Extension** to use the QuillBot extension.

Now log in to the QuillBot extension and use it. Note: sign in with a QuillBot account, not a Microsoft account.

Method 2: Install directly in Microsoft Word

Step 1 : Sign in to Word with your Microsoft account before installing the extension. Note that QuillBot is only compatible with Microsoft Word version 16.0.11629 and above and Word Online.



Step 2 : Select the **Insert** tab and click **Get Add-ins** . Now a new window in Word will appear.

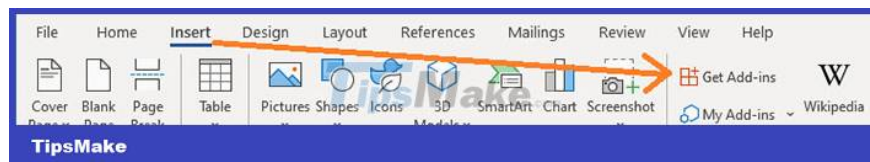

Step 3 : In the pop-up window, type **QuillBot** in the search bar on the left. Then, click the **Add** button when QuillBot appears.



Step 4 : Click **Continue** to accept the terms. QuillBot will be added to Word. It will appear to the right of the tabs, as shown in the following image.

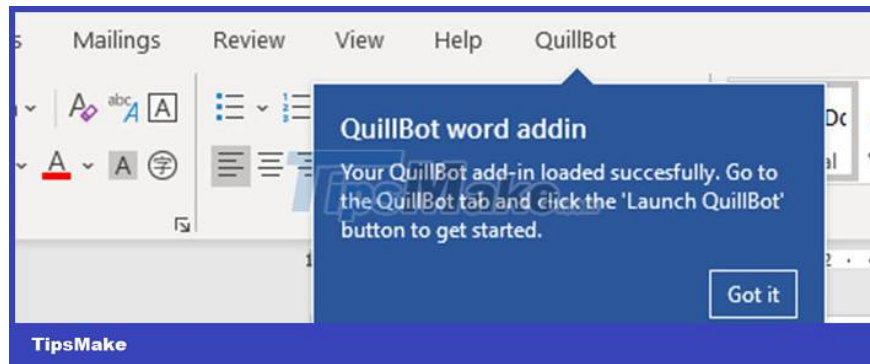

Users can click on that tab and select **Launch QuillBot** to open QuillBot on the right side of the screen.

Step 5 : Log in to the service with email and password to start using. QuillBot extension will look like this after successful installation and ready to use.



You finished reading the article "**Instructions for installing QuillBot in Microsoft Word**" edited by the [TipsMake](#) team. We hope this article has provided you with many useful tech tips and tricks. You can search for similar articles on tips and guides. Thank you for reading and for following us regularly.
