

# Instructions for inserting checkmarks in PowerPoint

To insert a checkmark in PowerPoint, users can use many different tools available in PowerPoint with a very simple implementation.

To insert a checkmark in PowerPoint, users can use many different tools available in PowerPoint with a very simple implementation. Checkmark is a v for you to mark the content that has been done, or which content is correct when we make a survey list, to-do list, etc. The following article will guide you to insert a checkmark in PowerPoint.

## How to insert a checkmark in PowerPoint with the font Wingdings

### Step 1:

At the interface in the PowerPoint slide, the user clicks on **the Insert item** , then clicks on **the Symbol** in the displayed list.

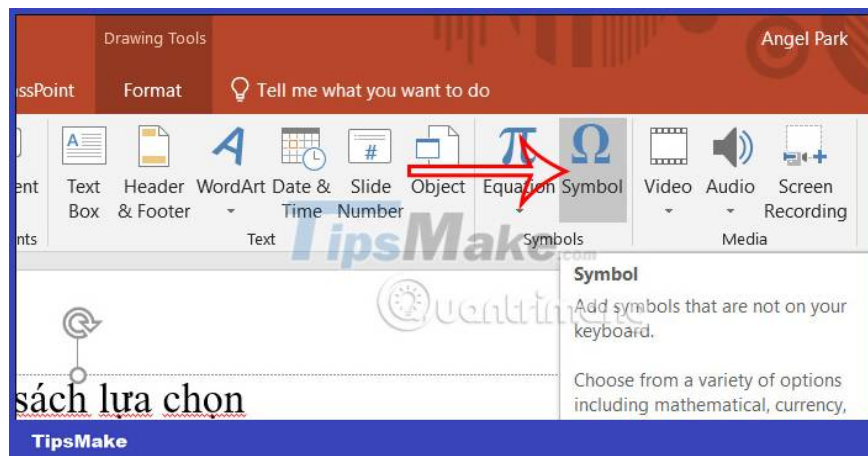

### Step 2:

Display the interface of the selection of icons to insert into PowerPoint slides. In **the Font section** , click on **the Wingdings font** .

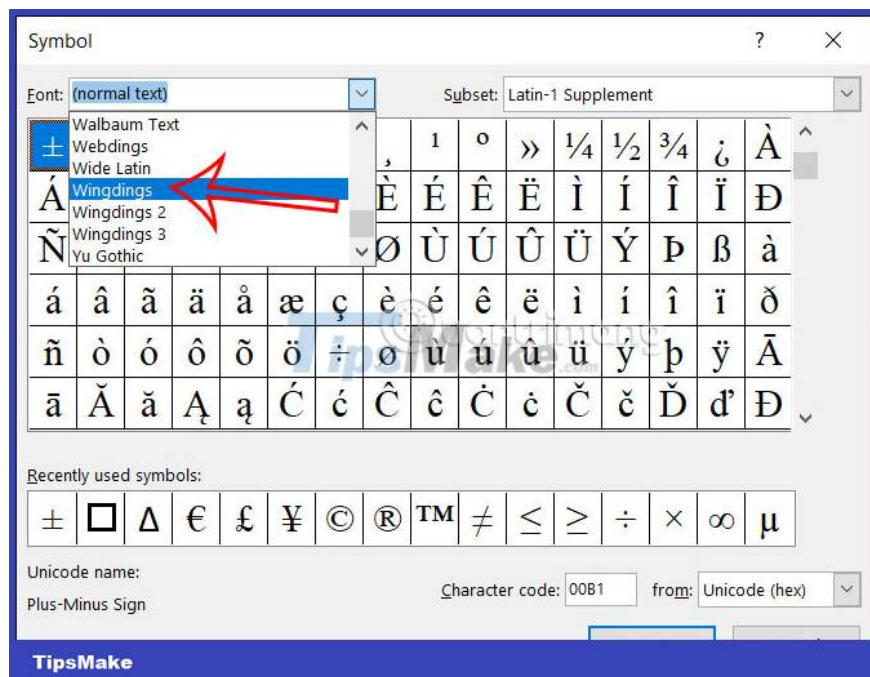

### Step 3:

Look for the icons in this font and you'll see a **checkmark icon** to use. We click on this icon and then **select Insert** to insert the content.

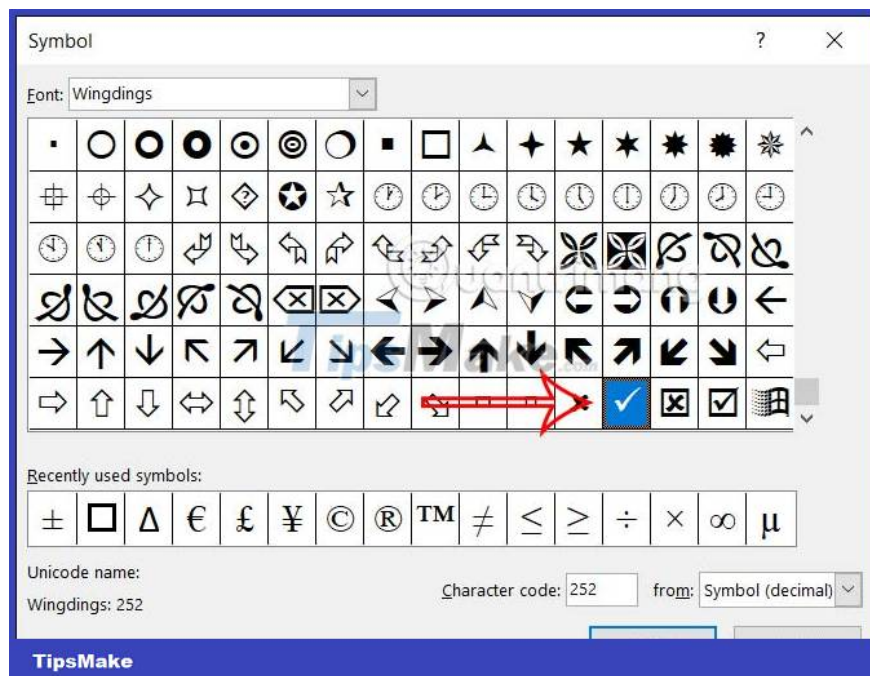

As a result we will see a checkmark displayed in the content interface of PowerPoint.

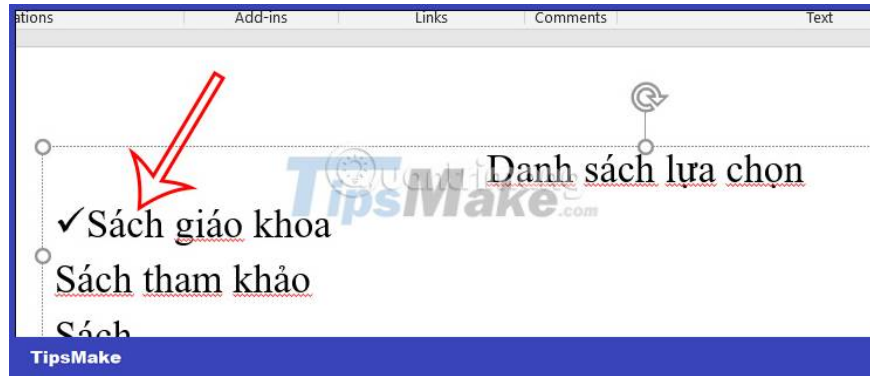

## Insert a checkmark in PowerPoint with Bullets

### Step 1:

First, the user enters the data content into the slide. Next we **highlight the content** that the user wants to have a checkmark.

### Step 2:

Next in the Paragraph group, we click on **the Bullets tool** . Now you will see that there are many different types of list creation, we will click on **the checkmark type** .

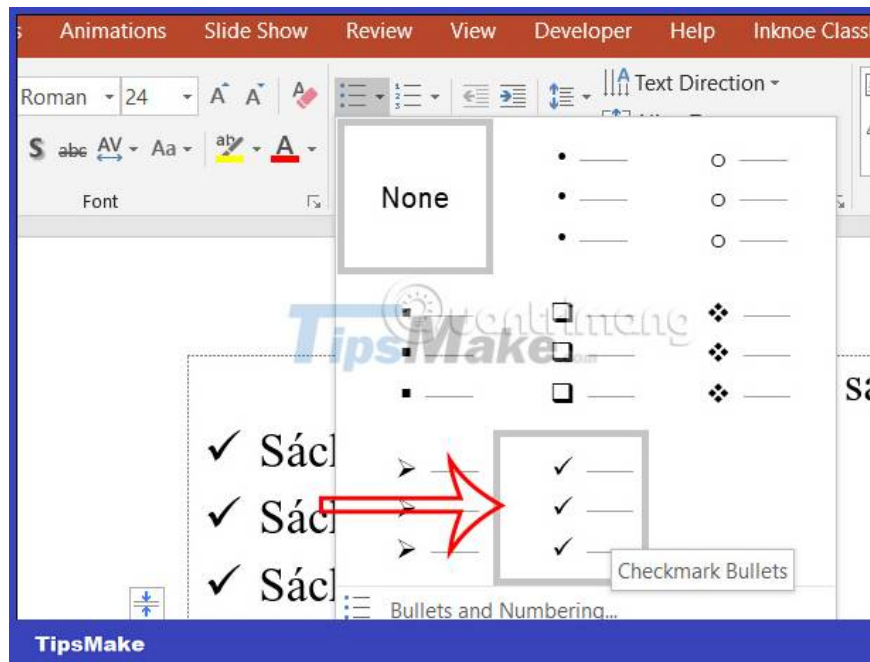

## Insert checkmark in PowerPoint with Icon

### Step 1:

First you need to select the location where you want to insert the checkmark in the slide. Next we click on **the Insert tab** and then look down at the Illustrations group, the user **clicks on Icons** .

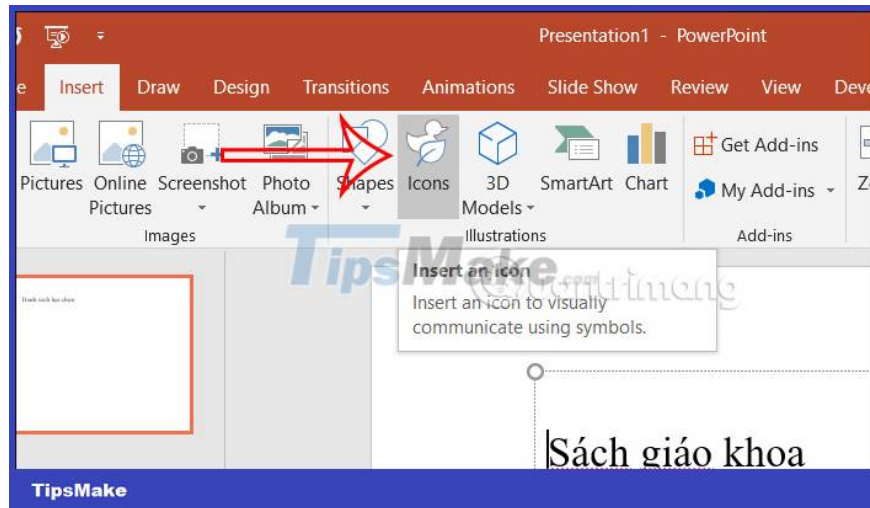

### Step 2:

Displaying the new interface, we **enter the keyword checkmark** in the search bar and will immediately see the results next to it. Click **the checkmark icon** and then click **Insert** to use in the slide.

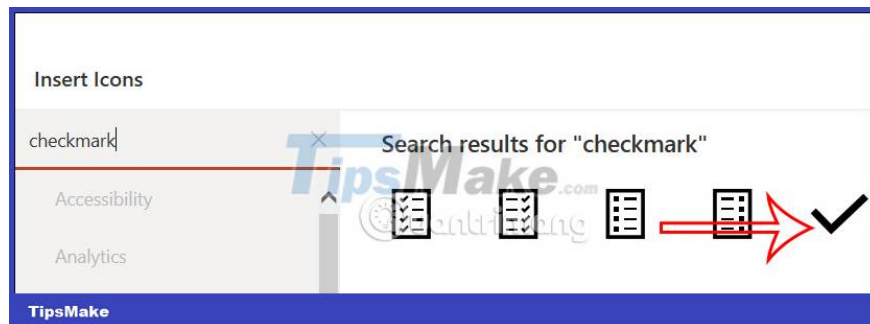

### Step 3:

Next you can adjust the icon like shrinking the size, changing the color if needed.

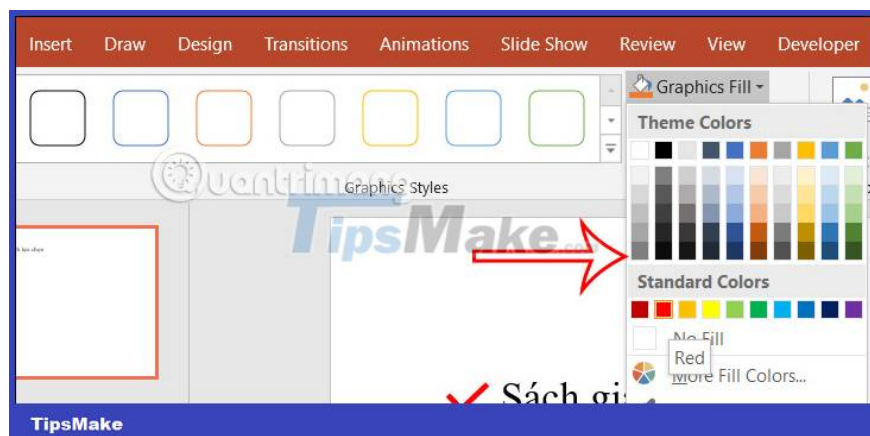

You finished reading the article "**Instructions for inserting checkmarks in PowerPoint**" edited by the [TipsMake](#) team. We hope this article has provided you with many useful tech tips and tricks. You can search for similar articles on tips and guides. Thank you for reading and for following us regularly.

---