

How to use the Ping command on a computer

You can easily check your internet connection without using any software by using the Ping command. TipsMake will guide you through the detailed steps of checking your network using the Ping command in the content below.

An unstable connection is a warning sign that your network might be malfunctioning. You might decide to download software to check, but this isn't necessary. On Windows, you can use two readily available and completely free tools to perform a network check using **the ping command** .



Instructions on how to use the Ping command to test your network.

Ping - Packet Internet Grouper is a command used to test the stability of your internet connection. When you type the Ping command to test your network, the system will send four 32-bit files to the website address. Based on the response time, the system will provide a specific statistical value for your reference.

The Ping command works with both **Cmd (Command Prompt)** and **Windows PowerShell** . To open the tool, follow the instructions.

+ **Open the Command Prompt (Cmd) : Press the Windows + R** key combination . The **Run** dialog box will appear; type **cmd** in the box and press **OK** .

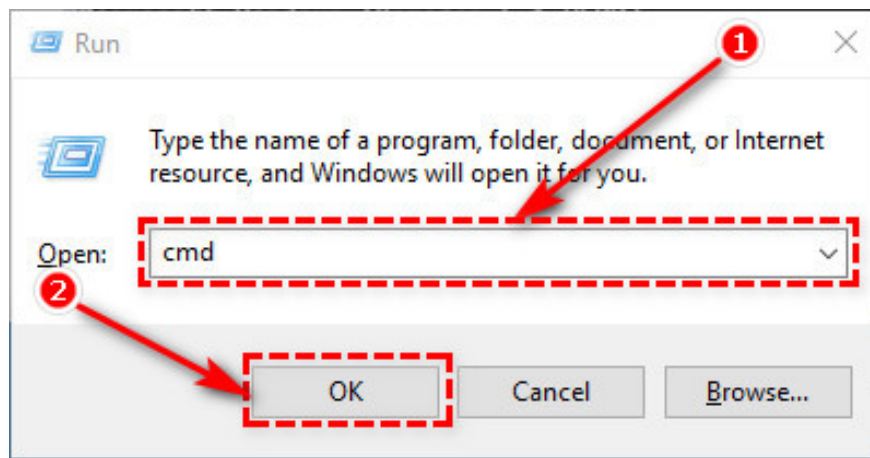

To **open Windows PowerShell**: Press the **Windows + X** key combination . A menu will appear in the bottom left corner of the screen. Click on **Windows PowerShell (Admin)** to open the tool.

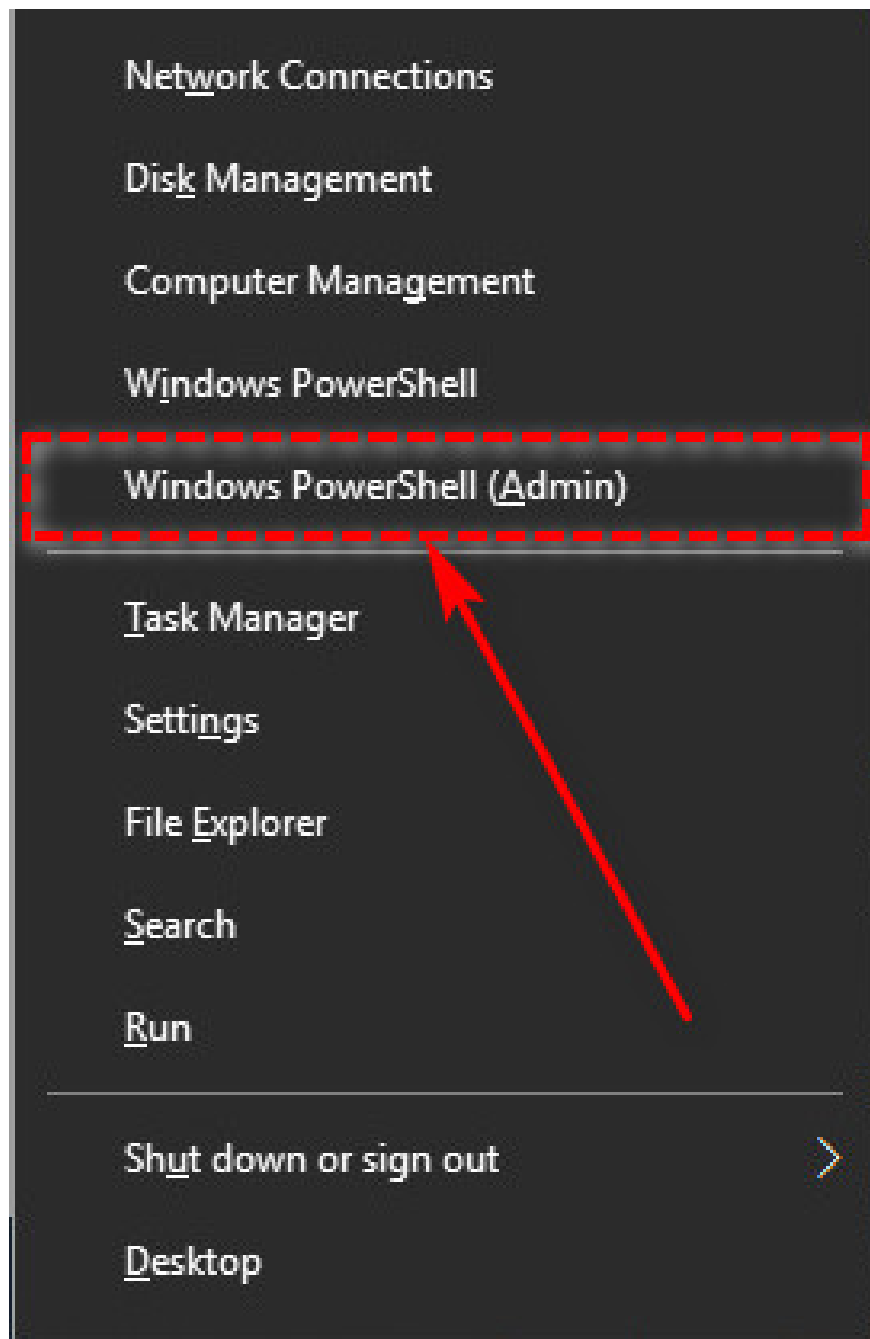

The interfaces of the Cmd tool and Windows PowerShell are relatively similar, and the operations are also no different. Taimienphi will use **Cmd** to illustrate the process in the content below.

To use the Ping command to test your LAN (local area network): In the **Command Prompt** window , type: ping [network address] and **press Enter** . The default local network address is usually **ping 192.168.1.1**.

To check your internet connection with your network provider using the Ping command : Similar to the previous method, enter the following commands into the **Cmd** command prompt .

Viettel : ping 203.113.131.1

FPT : ping 210.245.31.130

VNPT : ping 203.162.4.190

Ping a specific website address: To check the connection from your computer to a website address, we usually use the phrase "ping network" . You can do this using the syntax: **ping (website address)** . For example: ping taimienphi.v

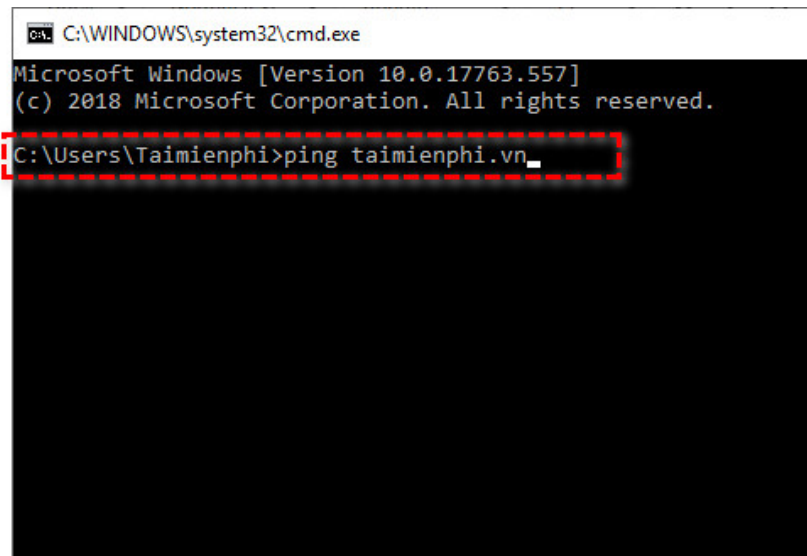

```
C:\WINDOWS\system32\cmd.exe
Microsoft Windows [Version 10.0.17763.557]
(c) 2018 Microsoft Corporation. All rights reserved.
C:\Users\taimienphi>ping taimienphi.vn_
```

When you enter the test command, the system will notify you of the results. If your network is stable, the **Cmd** command will display the following:

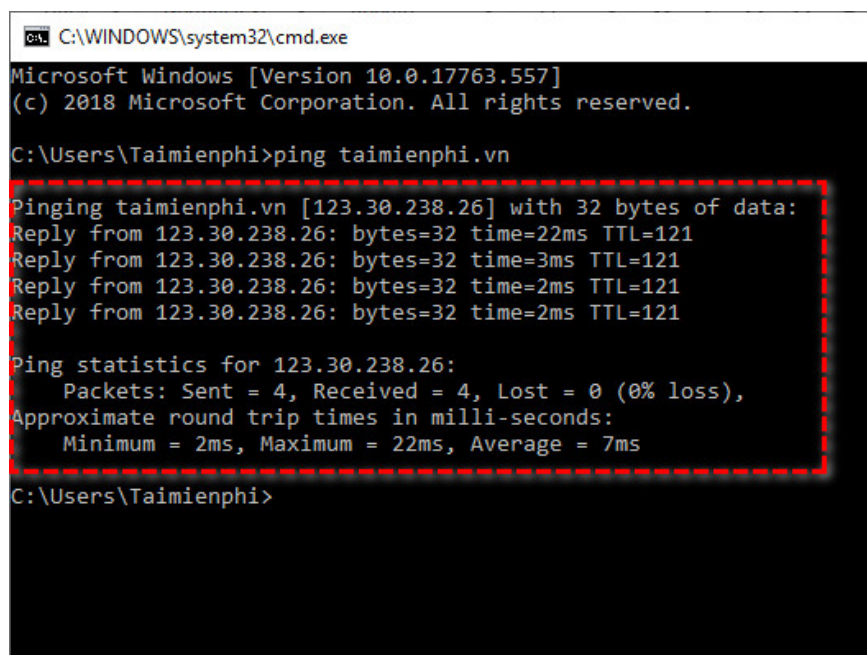

```
C:\WINDOWS\system32\cmd.exe
Microsoft Windows [Version 10.0.17763.557]
(c) 2018 Microsoft Corporation. All rights reserved.
C:\Users\taimienphi>ping taimienphi.vn
Pinging taimienphi.vn [123.30.238.26] with 32 bytes of data:
Reply from 123.30.238.26: bytes=32 time=22ms TTL=121
Reply from 123.30.238.26: bytes=32 time=3ms TTL=121
Reply from 123.30.238.26: bytes=32 time=2ms TTL=121
Reply from 123.30.238.26: bytes=32 time=2ms TTL=121

Ping statistics for 123.30.238.26:
    Packets: Sent = 4, Received = 4, Lost = 0 (0% loss),
    Approximate round trip times in milli-seconds:
        Minimum = 2ms, Maximum = 22ms, Average = 7ms
C:\Users\taimienphi>
```

The typical message **Reply from 123.30.238.26: bytes=32 time=2ms TTL=121** would mean:

Reply from [Address] : Address of the machine sending the response;

Bytes : Size of the test file sent;

Time : Time the system received the response;

TTL : Lifetime of the test file.

In case of network errors, the system will notify you with the following error commands:

Request time out when pinging: This error frequently occurs due to router issues, incorrect IP address, or ping blocking.

Destination host unreachable : This error is caused by a broken connection to the destination machine;

So, TipsMake has provided you with detailed instructions on **how to use the Ping command** . Hopefully, through this article, you have gained a better understanding of how to use the Ping command, so that you can quickly identify the cause of network errors and take timely corrective action. If you are using a Mac, you can refer to the 3 ways to ping a network on a Mac here.

You finished reading the article "**How to use the Ping command on a computer**" edited by the [TipsMake](#) team. We hope this article has provided you with many useful tech tips and tricks. You can search for similar articles on tips and guides. Thank you for reading and for following us regularly.