

How to use Face Animation to convert still portraits to GIFs

The Face Animation website relies on Nero AI's artificial intelligence technology to process images and convert static portraits into animated images. The image processing process on Face Animation is also very fast.

The portrait image changes from static to dynamic, accompanied by a change in the moving face. This helps your images come to life. The following article will guide you to use Face Animation to convert still portrait images to GIF.

Instructions for using Face Animation to convert still images to GIF

Step 1:

First, click on the link below to access the Face Animation page.

<https://ai.nero.com/face-animation>

Step 2:

At the website interface, **click Upload** to upload your still image.

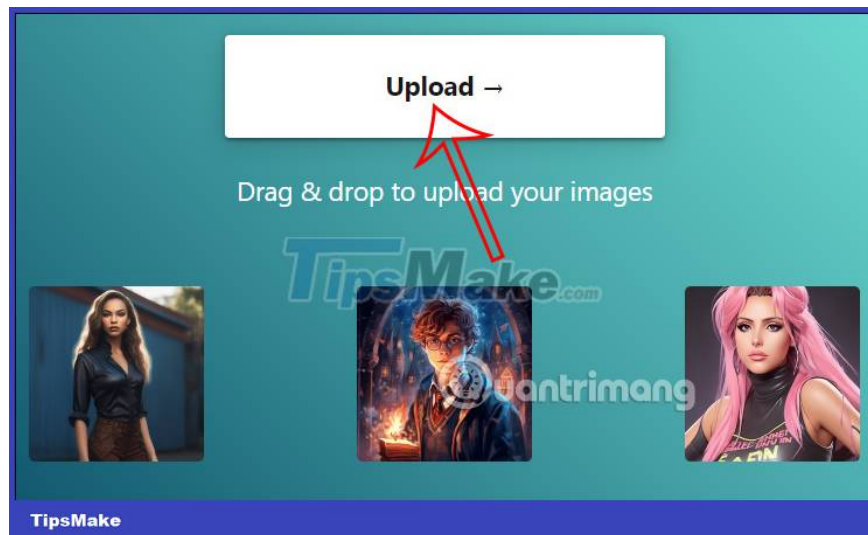

After uploading a portrait photo, the website will ask which face you want to convert in the uploaded photo. In case you upload a portrait with many people, the website will ask you which face to choose.

SPECIAL OFFER



Select the face you want to animate

TipsMake

Step 3:

Once we have selected the face, we **click on Start** on the right edge of the interface to proceed to convert the still image to an animated image.

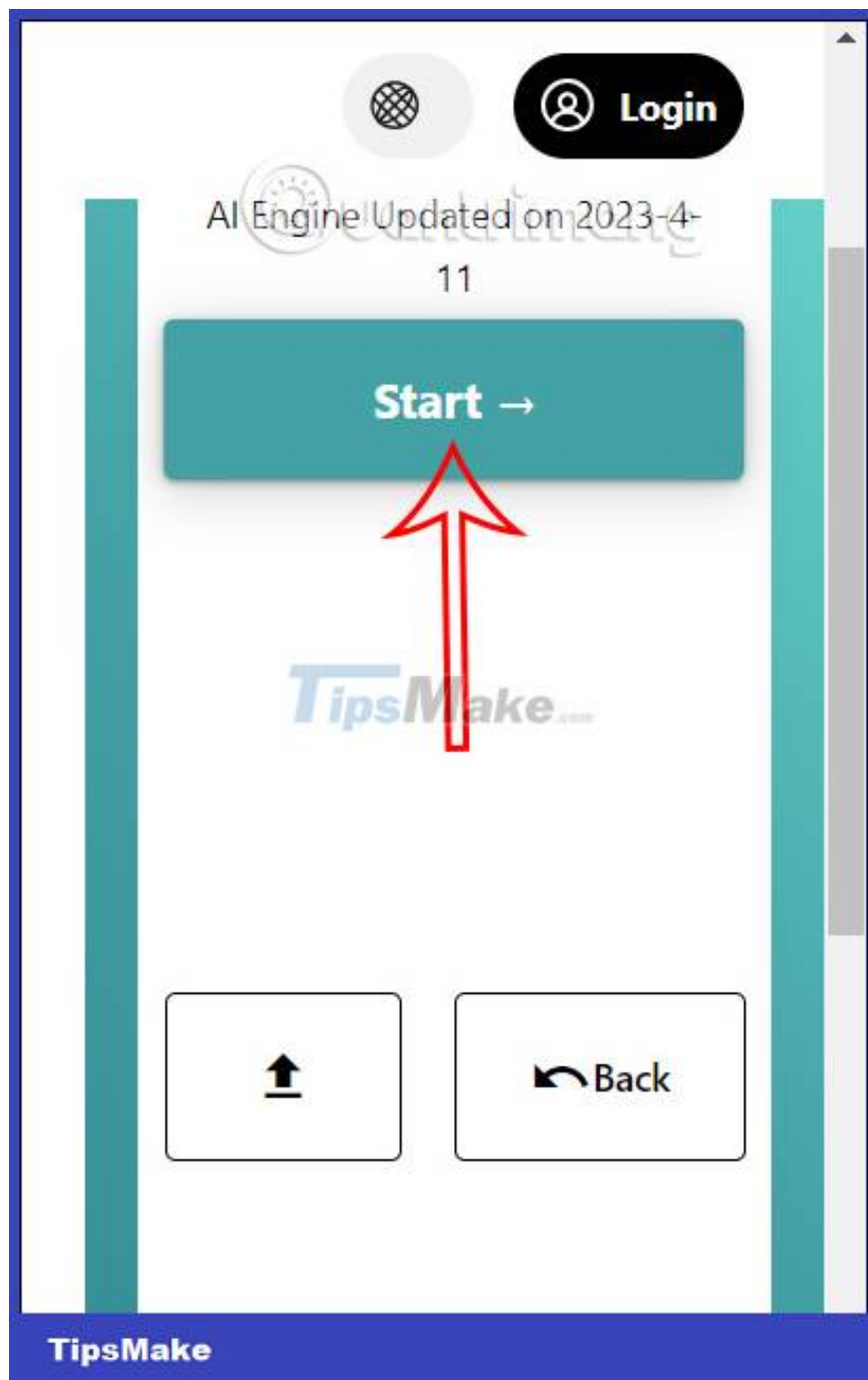

Step 4:

You wait a few seconds for the website to recognize and analyze the face, then switch to a moving face with facial expressions.

Soon you will see an animation with a smile on your face. If you are satisfied with this converted image, then we **click Download** to download the image in GIF format.

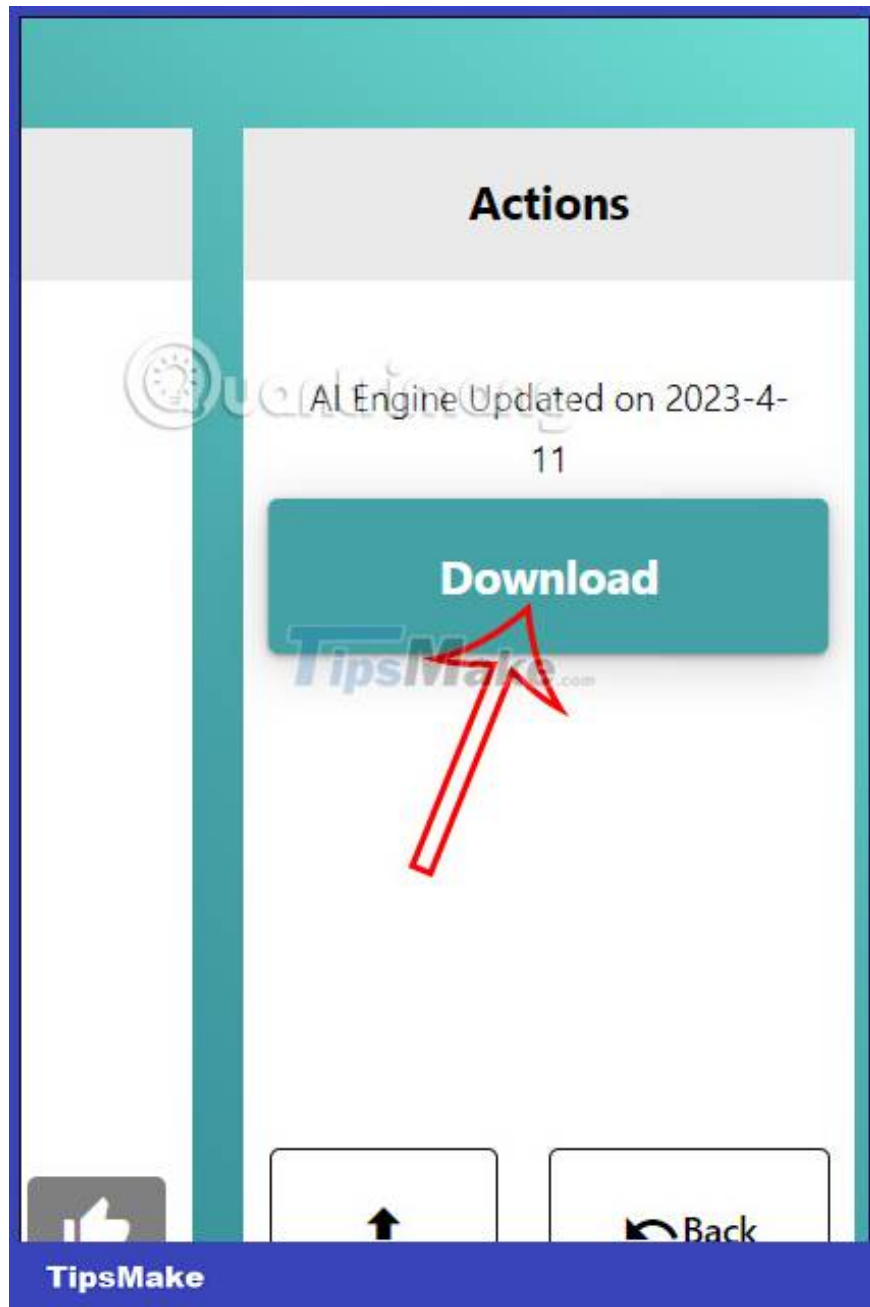

You finished reading the article "**How to use Face Animation to convert still portraits to GIFs**" edited by the [TipsMake](#) team. We hope this article has provided you with many useful tech tips and tricks. You can search for similar articles on tips and guides. Thank you for reading and for following us regularly.