

How to update software for Internet TV Sony W650D

Regularly updating software for Internet TV Sony will help TV overcome some errors related to system, application, memory. Performance is also more stable, ...

Have you updated the software for your Sony TV Internet home? Software updates will bring many benefits to the TV, not only fix errors related to the system, but also help the TV work more smoothly. Besides new applications, new features will also be updated promptly to meet the needs of users.

In this article, we will show you how to update the software for Sony W650D Internet TV with 2 models: Sony 40W650D and Sony 48W650D with USB.

Step 1:

Visit the link below to download the control software for the W650D TV. Scroll down under the software download, click the **Download application** box and check the box **I have agreed with the Terms & Conditions** to download the software.

1. Download software for Internet TV Sony W650D

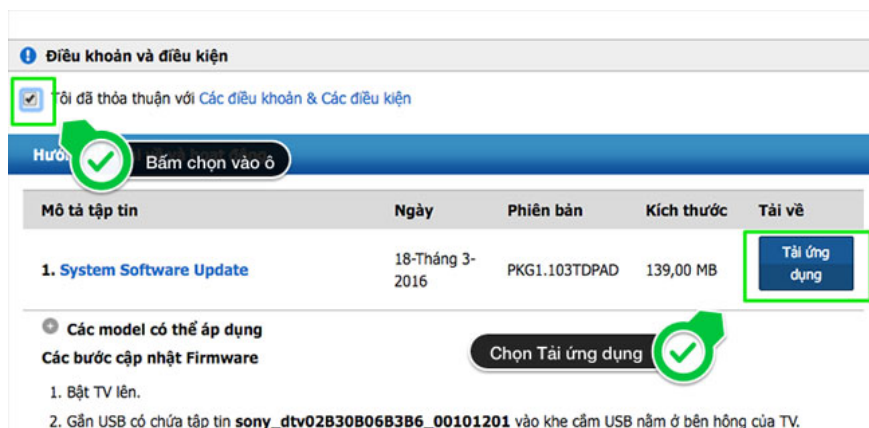

Step 2:

Extract and copy the extracted update file to USB.

Please note that USB should not contain any data other than this software update file.

Step 3: Update software for TV

Note that in order to successfully update the software, do not turn off the TV or disconnect the power, which will cause the TV to fail.

Step 1:

Plug the USB into the TV, the screen will display a notification about the update, select **Update now** .

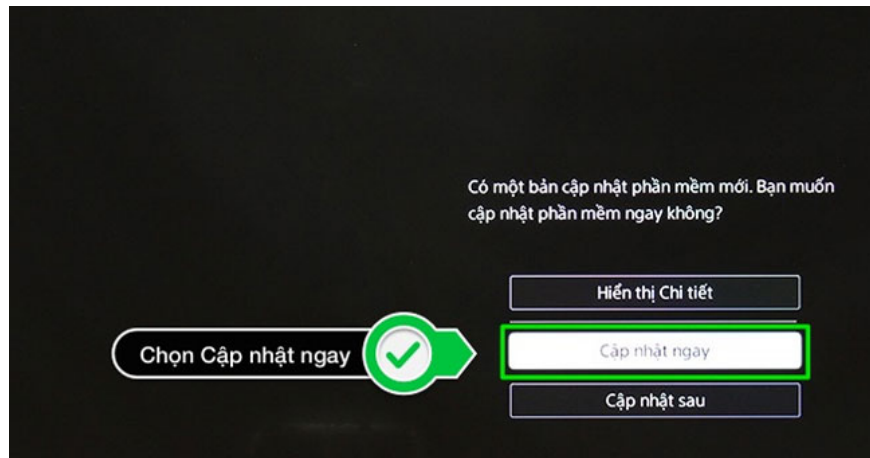

Or press the **Home** button on the control. Then choose **Support** under **Settings> Software update> USB** .

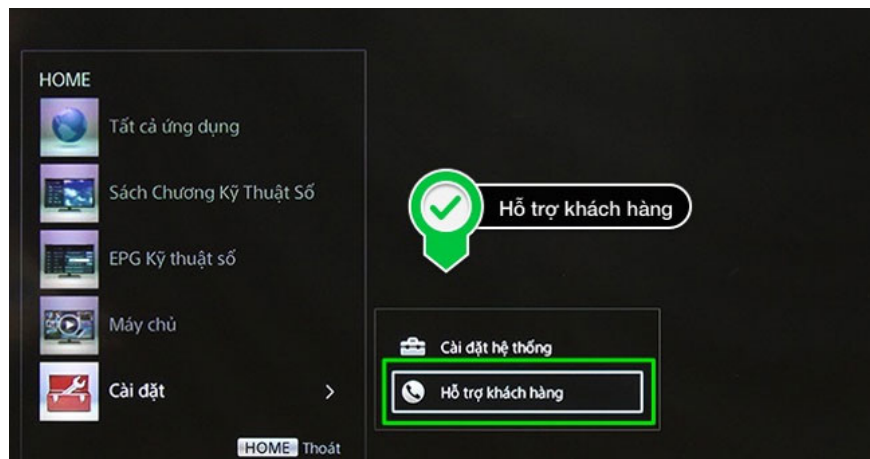

Choose Customer Support

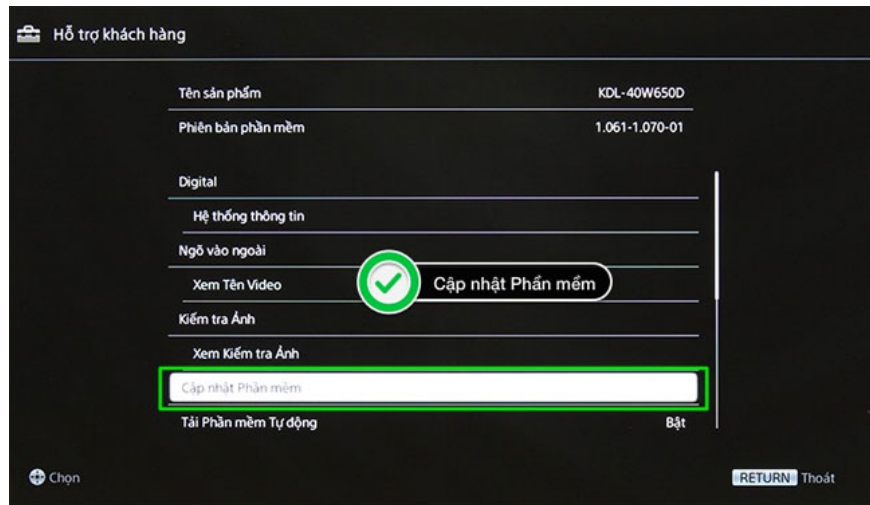

Select Software update

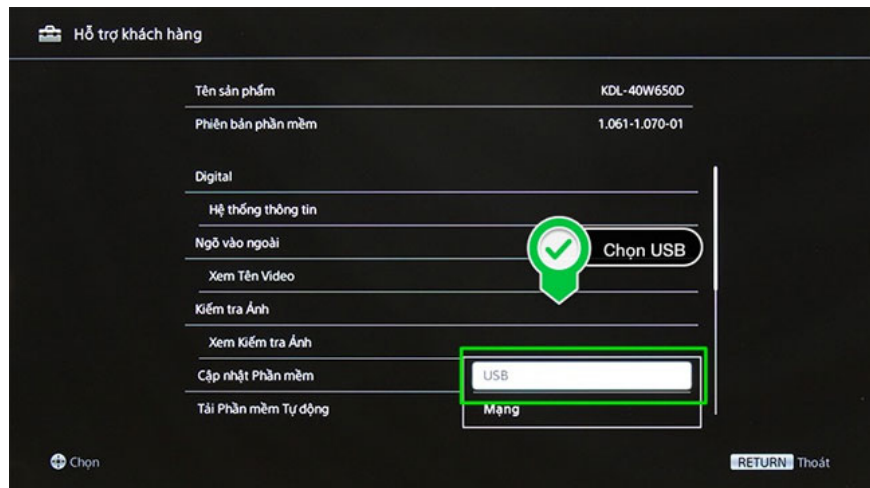

Select Update with USB

Step 2:

Select **Accept** to start the update.

Note , if the TV appears a message **No new version of the TV software is found - No more version of the TV software was found** means your TV is in the latest software version.

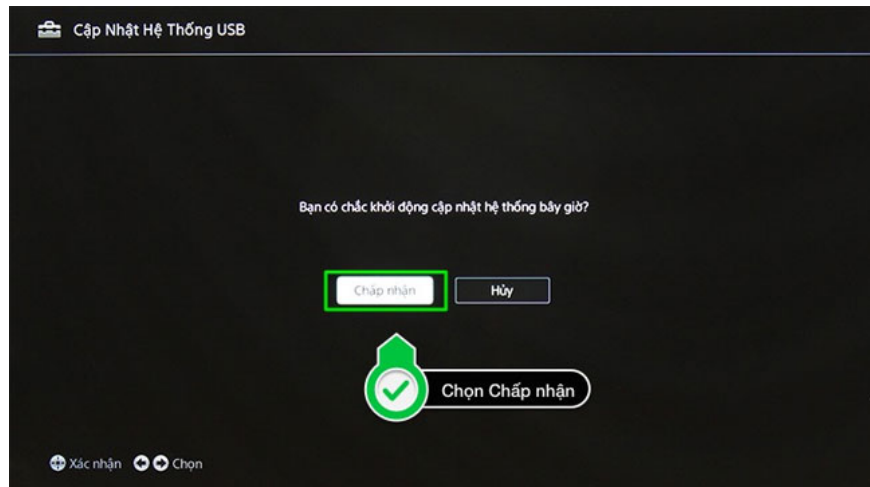

Step 3:

Wait for the update process to complete, we will conduct a TV check.

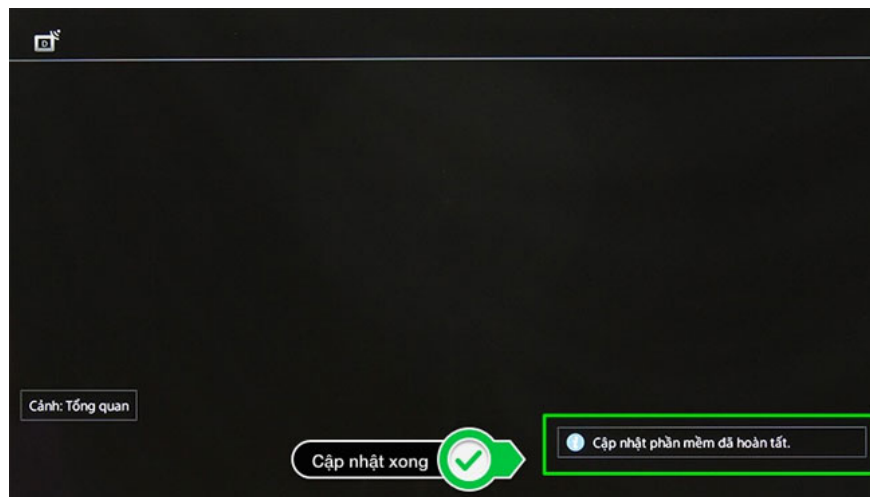

At the home page interface, select **Settings**> **Customer Support** .

You will see the TV showing the new software version of the TV. If the TV is in **version 10310-180-01** , it means we have completed the process of updating the new version to the TV.

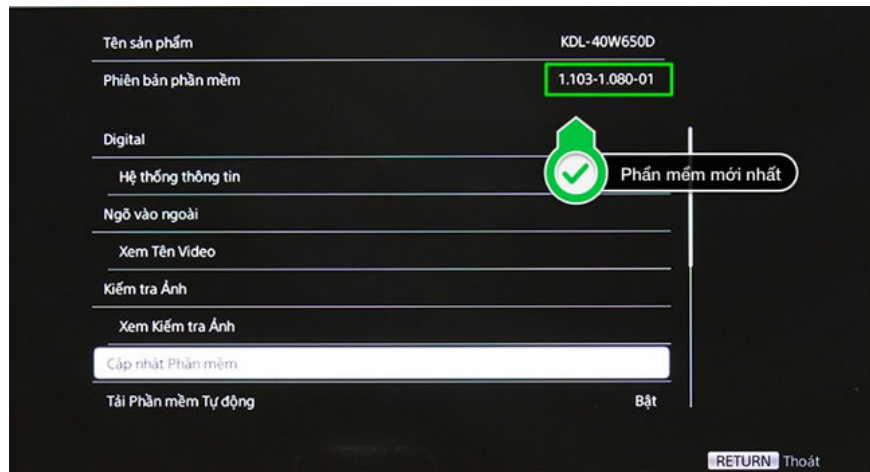

Step 4:

After successful update, you can freely use the features and access many Web sites right on the TV.

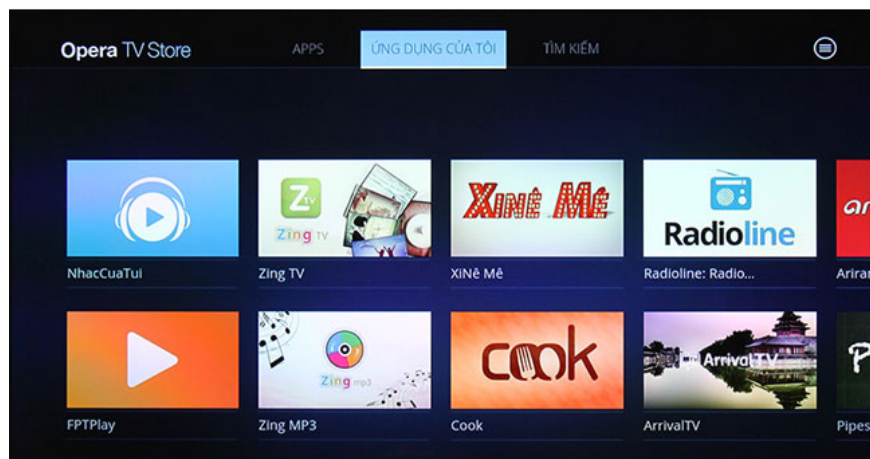

Refer to the following articles:

1. What are the connection ways to watch videos on TV?
1. Learn the current popular resolution on TV
1. Dehumidifier - an effective weapon against humid weather in Vietnam

I wish you all success!

You finished reading the article "**How to update software for Internet TV Sony W650D**" edited by the [TipsMake](#) team. We hope this article has provided you with many useful tech tips and tricks. You can search for similar articles on tips and guides. Thank you for reading and for following us regularly.