

How to underline the broken word on Word

Instead of the underlined style under regular text, users can underline the broken character on Word.

To highlight the paragraph or word in the sentence, we will use the underlined style under the word. The U icon is available in Word's toolbar to underline the text. But that underlined style is just a solid stroke, so what if you want to create a dashed underline style? On Word, there are also many different underline styles to choose from, including the dashed style. In addition, users can create colors for those underlines. The following article will guide you how to underline the broken word on Word.

1. How to remove the underline, delete the red brick, blue brick under the word in Word
2. How to create and delete horizontal lines on Word
3. Create a quick dot (.....) line in Microsoft Word
4. Guide font formatting, change stretch and create artistic text in Word

Instructions for creating underline strokes on Word

Step 1:

First of all, we also need to highlight the words, or the text you want to underline. Then click the **arrow next to the U symbol** .

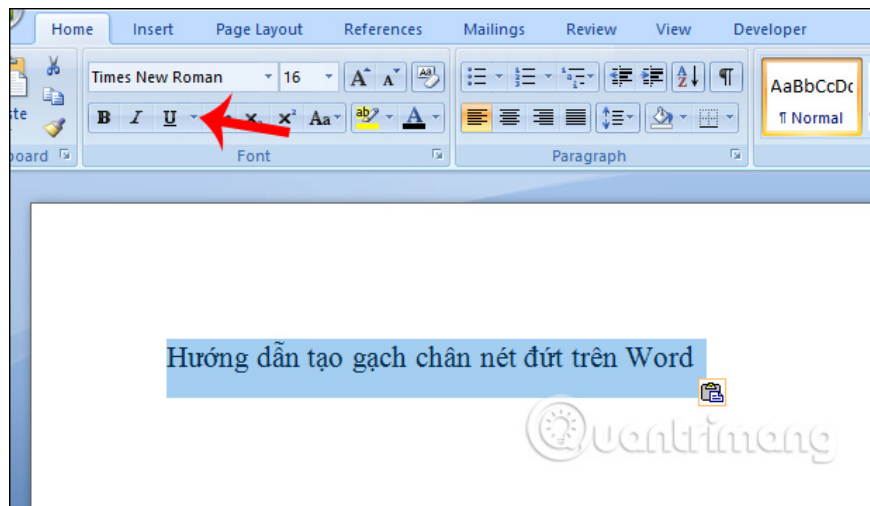

Step 2:

Immediately afterwards display some dashed style strokes for us to use for the document content.

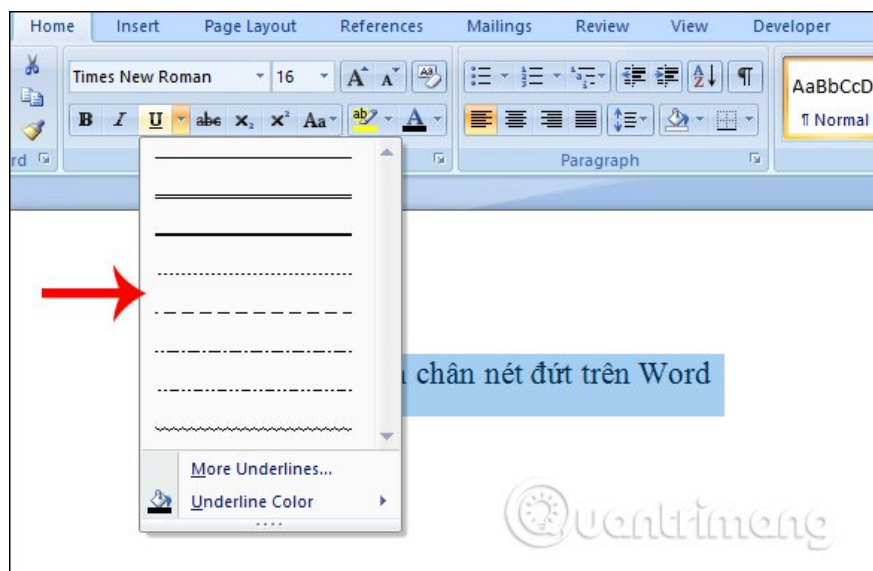

The text result will be underlined under the dashed line as shown below.

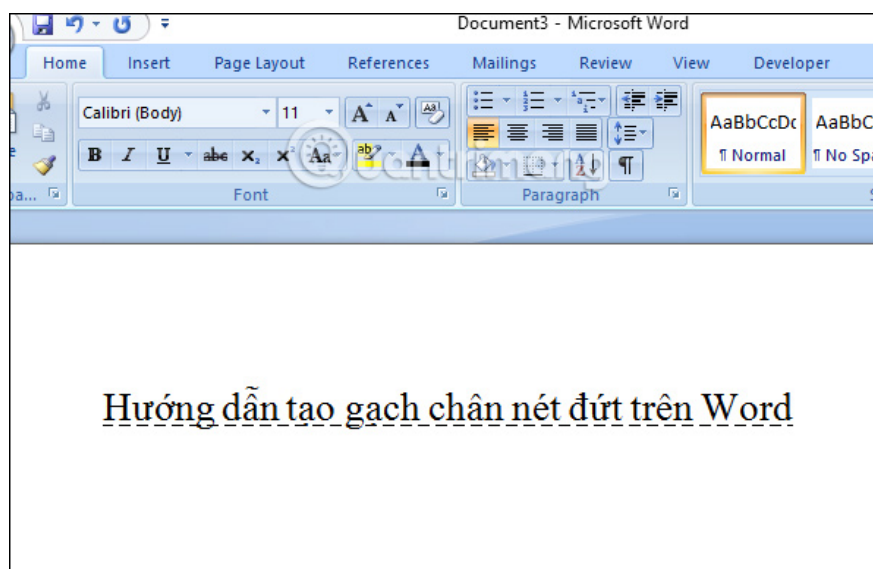

Step 3:

To open more types of dashed strokes, users click **More Underlines** on the U icon list. Then display the Font interface so that we can change the new underline style for the content.

At the Underline styles section, click on the drop-down arrow icon to display other underline styles. Click on the underlined type you want to use.

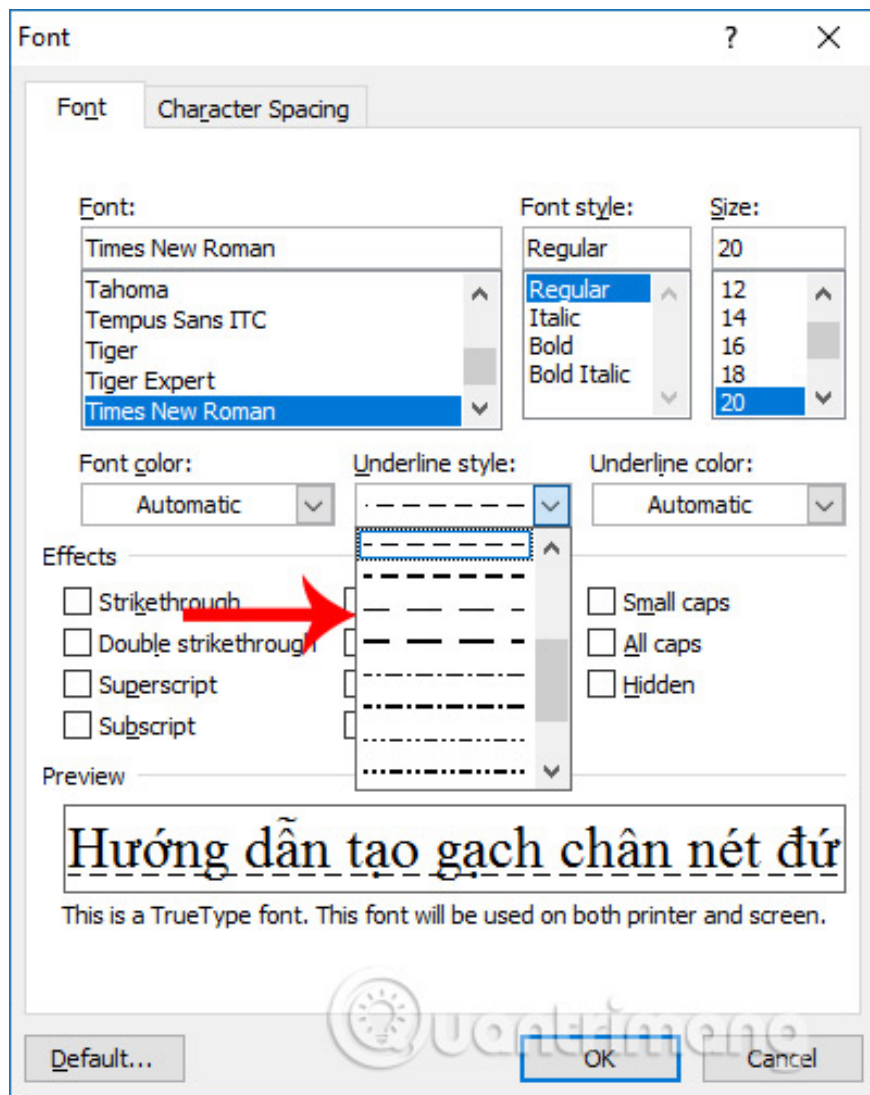

Immediately content on Word will be changed to a new underlined style.

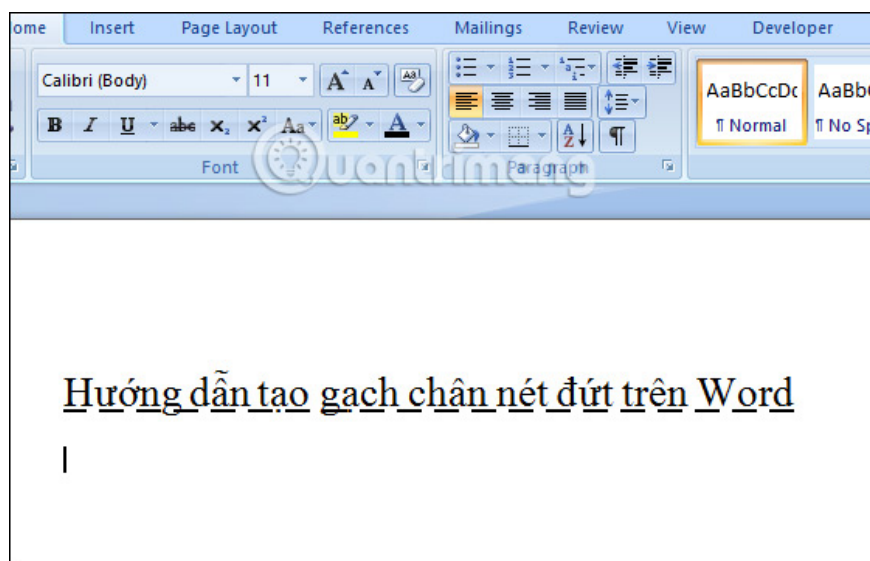

In case you just want the underlined words in each word, choose Word only in the list of tiles under the letters.

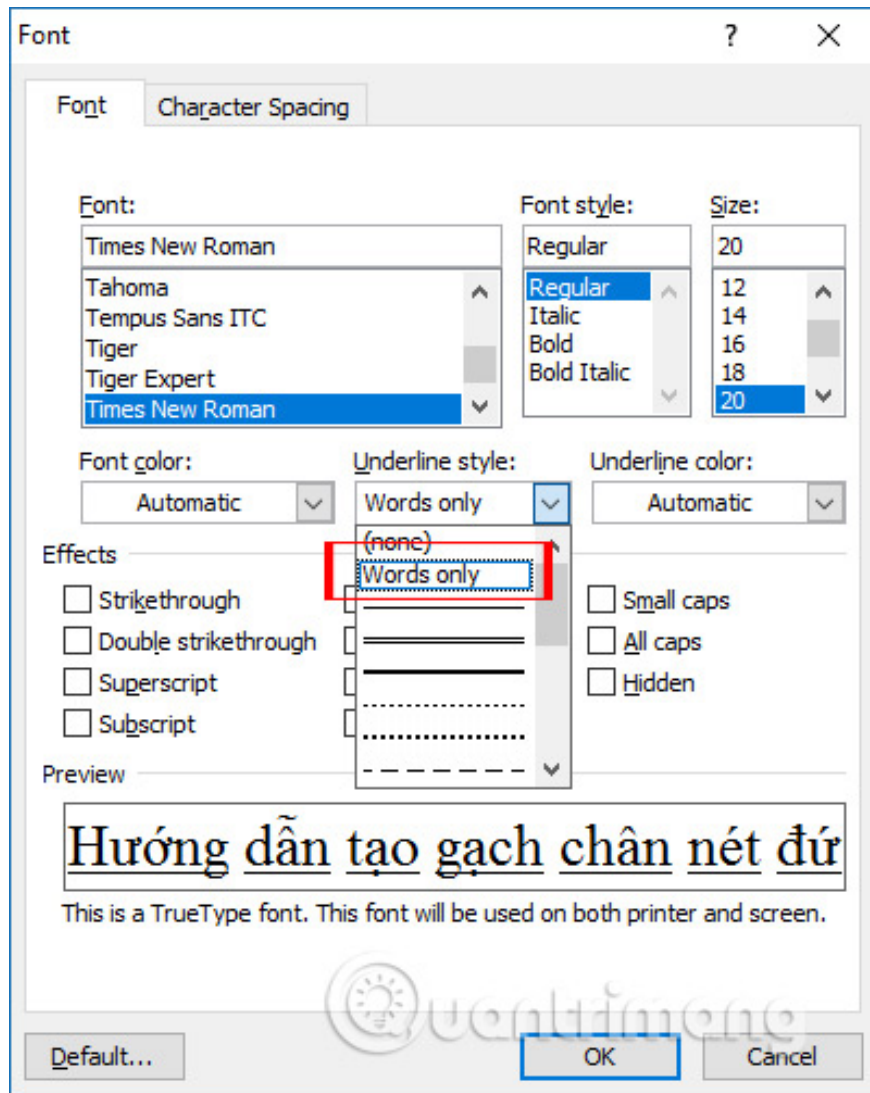

The underline will only show up in each word and manually adjust the length of the underlined stroke corresponding to the length of the letter.

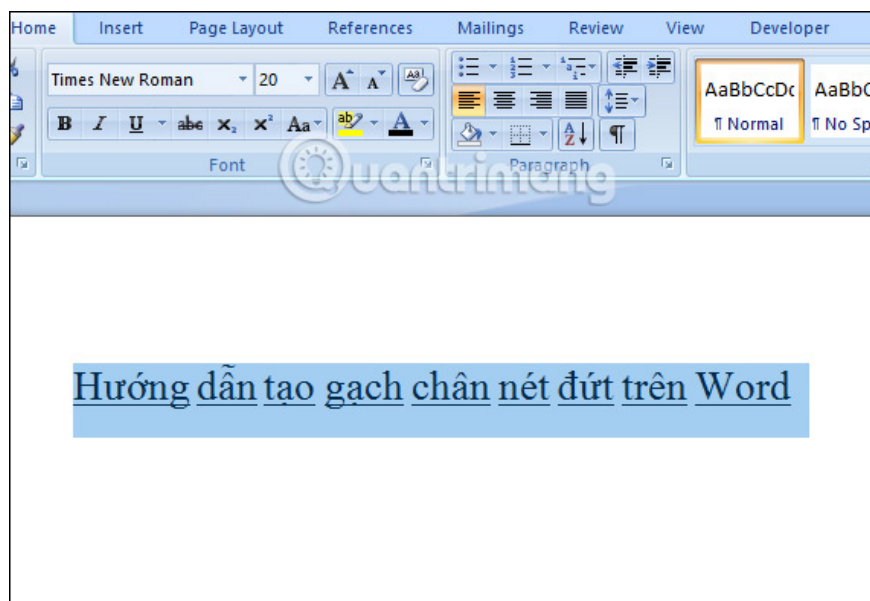

Step 4:

In addition, users can create colors for those underlines. Click **Underline Color** and then select the color for the dashed stroke. If you want to open more colors, click **More Colors**.

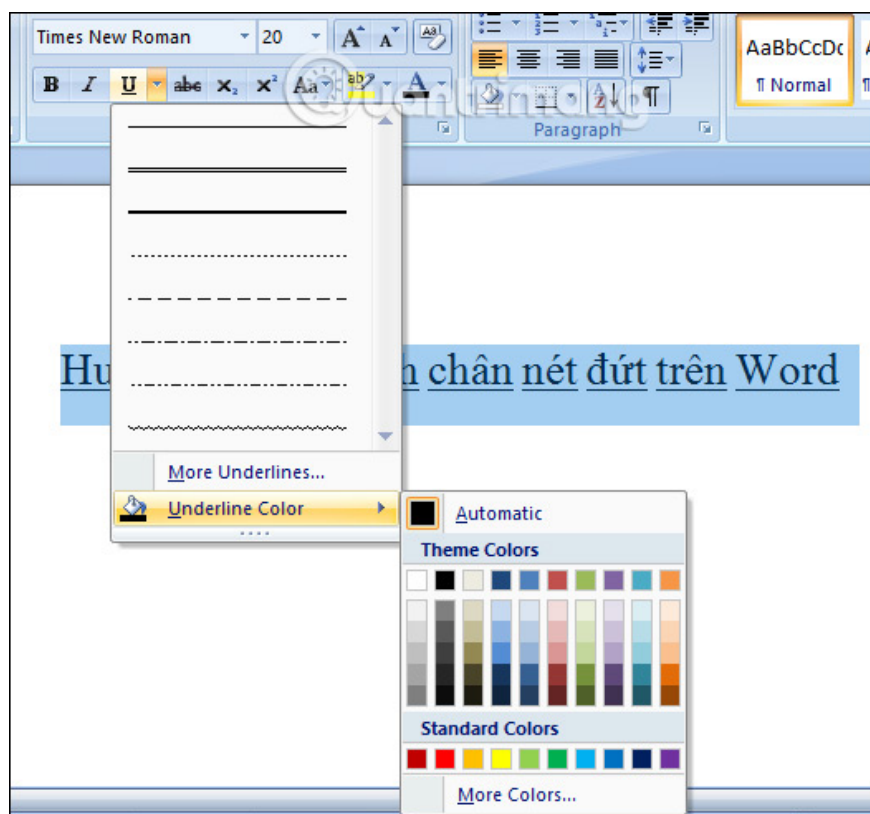

The text will be more prominent with the broken lines of colors as shown below.

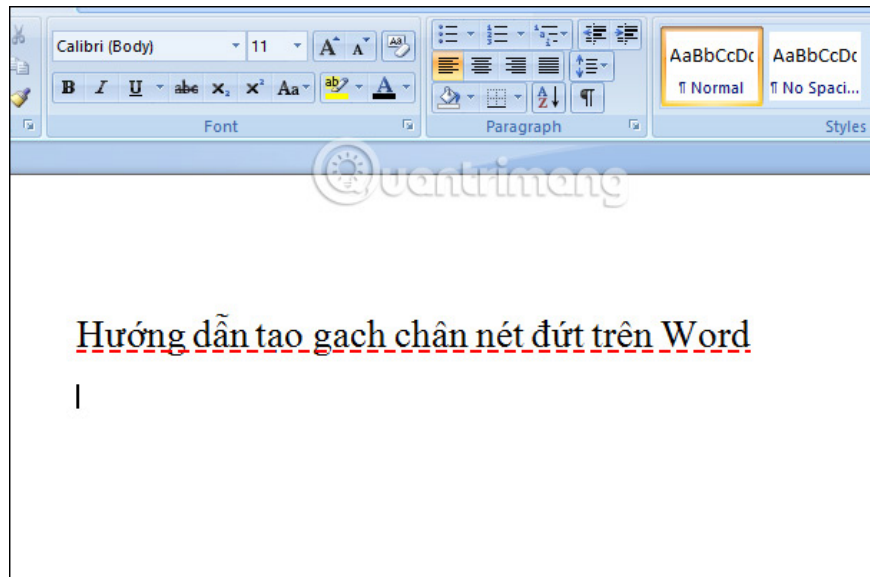

So besides the straight underline stroke type, we also have some kind of break or even wavy strokes. The underlined content on Word will be much more prominent, giving more attention to viewers.

I wish you all success!

You finished reading the article "**How to underline the broken word on Word**" edited by the [TipsMake](#) team. We hope this article has provided you with many useful tech tips and tricks. You can search for similar articles on tips and guides. Thank you for reading and for following us regularly.