

How to turn on the 120Hz screen on Samsung Galaxy S20

The Samsung Galaxy S20 series is complemented with a unique 120Hz screen. And here is how to turn on the 120Hz screen on the Galaxy S20.

For the first time, Samsung's new smartphones, the Samsung Galaxy S20, S20 +, and S20 Ultra, add 120Hz displays with fast screen refresh rates, more than double that of other smartphones of the same level. This brings impressive processing speed, super smooth when users experience the device. However, by default, this 120Hz screen is not enabled on the Galaxy S20 series, which users need to manually turn on. The following article will guide you how to turn on the 120Hz screen on Galaxy S20 manually.

How to activate 120Hz screen on Galaxy S20

Step 1:

We **swipe the screen from top to bottom** and then click **the gear icon** to access the settings interface on the device.

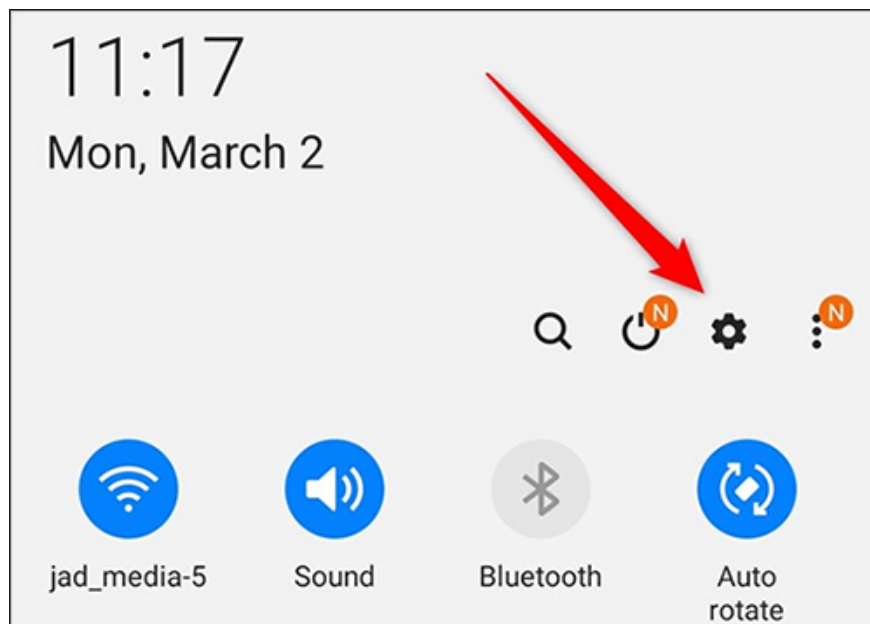

Next in the user settings group interface, click **the Display group** . This Display setting group manages the display interface such as Dark mode, turns on the blue light filter, changes the font size, etc.

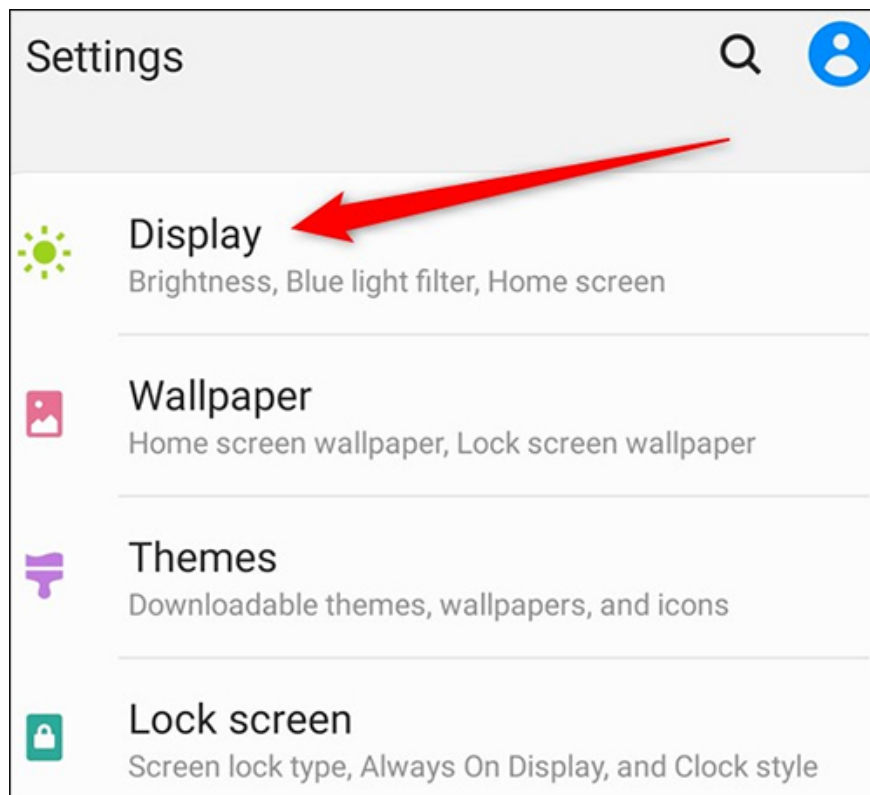

Step 2:

We scroll down and then click on **Motion smoothness** to adjust the screen.

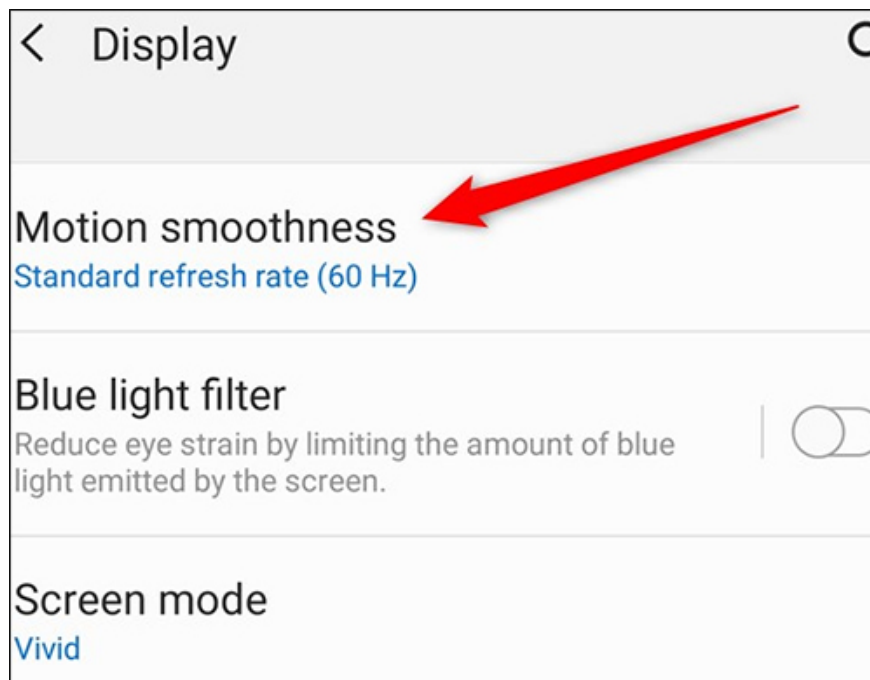

Step 3:

In this new interface you will see the difference between 120Hz screen and 60Hz screen. **However, users should pay attention** to using the 120Hz screen on this Samsung S20 will also consume 20-30% battery power compared to the 60Hz screen. The screen resolution is also automatically lowered to 1080p (FHD +) instead of 1440p (WQHD +) when using a 60Hz screen. If you want to use it, just **tick High Refresh Rate (120Hz)** and **click Apply** to use it.

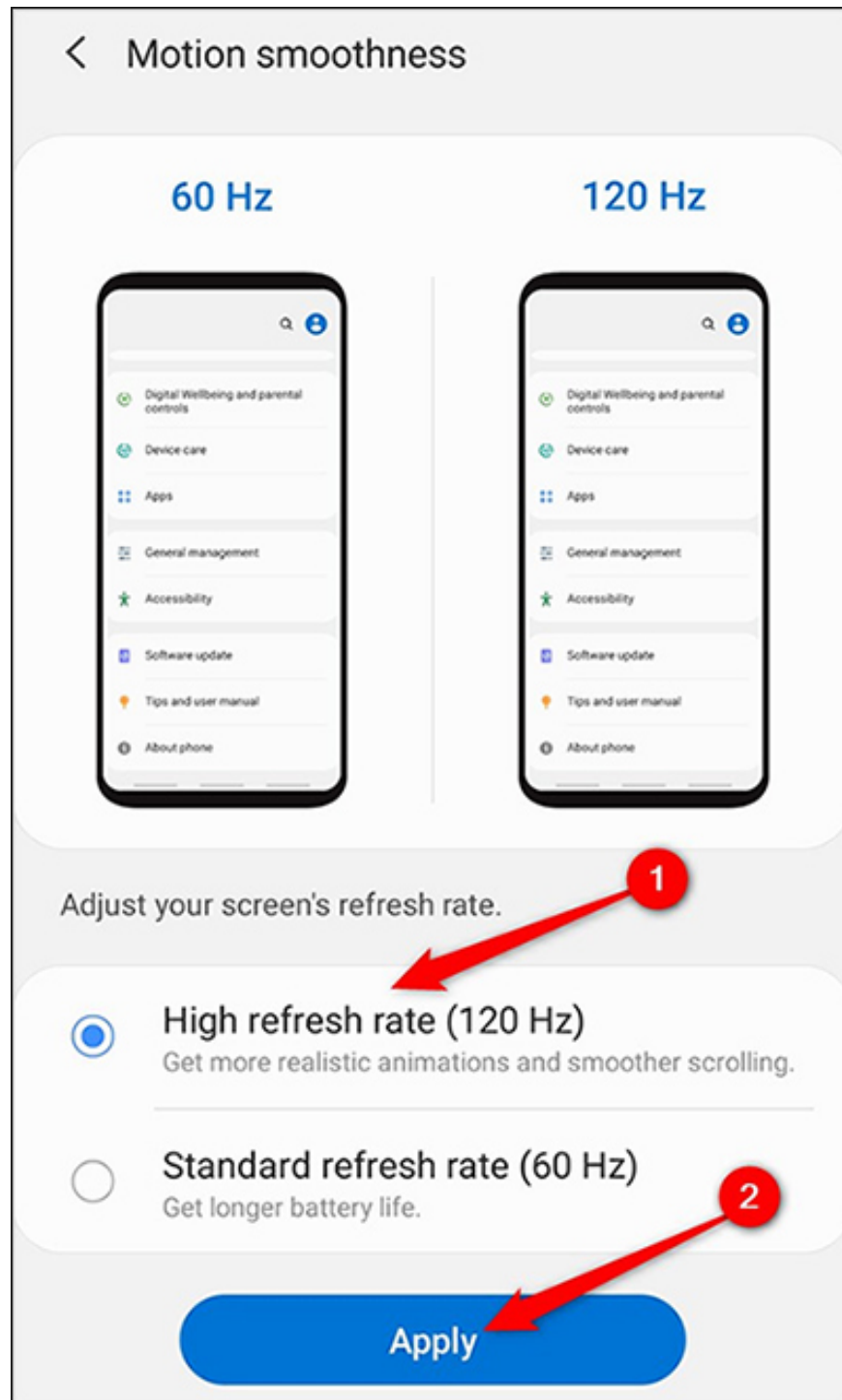

You finished reading the article "**How to turn on the 120Hz screen on Samsung Galaxy S20**" edited by the [TipsMake](#) team. We hope this article has provided you with many useful tech tips and tricks. You can search for similar articles on tips and guides. Thank you for reading and for following us regularly.

