

How to turn on super bright screen mode (Super Brightness) on Samsung Galaxy S22 phones

The screen has always been a strong point on high-end Samsung smartphones. In addition to sharp display quality and vibrant colors, brightness is also an aspect that Samsung panels do very well.

On the Galaxy S22 series, Samsung has focused heavily on promoting the screen's brightness through a feature called Super Brightness. So what is this feature and how to activate it? Let's find out right here.

Enable Super Brightness on Galaxy S22

Before you start working, there is one important thing you need to note, that is, Super Brightness mode will cause the screen to consume more power, which in turn leads to significantly affected battery life. In return, you get a sharper and more vivid display panel, especially in strong ambient lighting conditions.

If you're okay with that, follow the steps below to enable Super Brightness.

Step 1: On the Galaxy S22, tap the gear icon on the home screen to open the **Settings** menu .



Step 2: In the Settings menu that opens, click on **Display** .

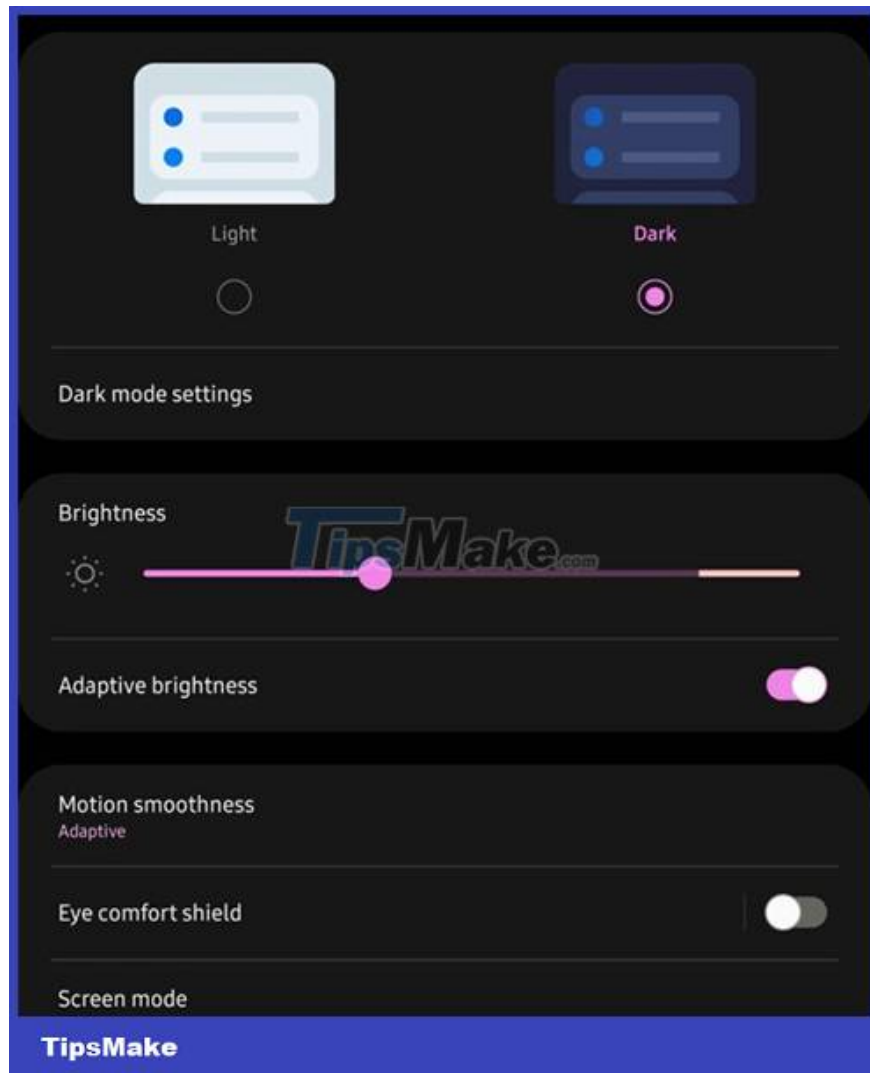

Step 3: Next, you have to turn off **Adaptive brightness** mode if it is enabled.

Step 4: After turning off **Adaptive brightness** , you will get another switch just below it called **Extra brightness** . Turn this switch to on and the job is done.

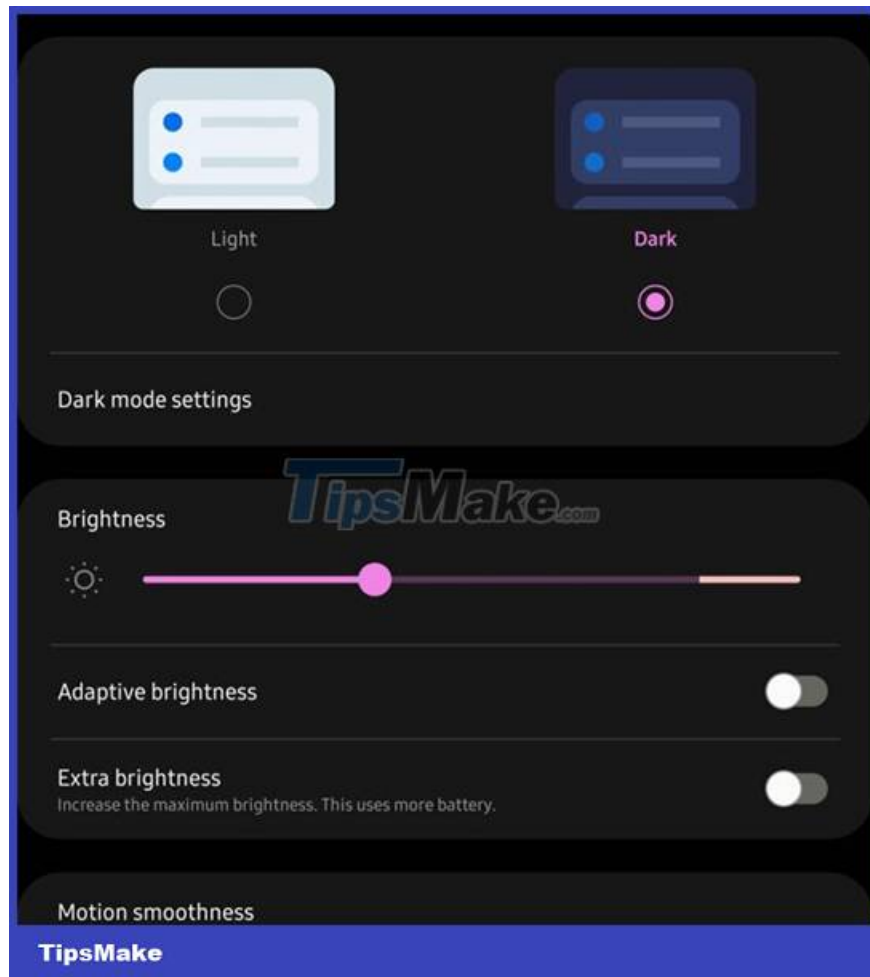

Super Brightness mode has now been successfully activated on your Galaxy S22. After activating this feature, you will no longer be able to use adaptive brightness and the battery consumption will also increase. But in return, you get a much brighter display.

You finished reading the article "**How to turn on super bright screen mode (Super Brightness) on Samsung Galaxy S22 phones**" edited by the [TipsMake](#) team. We hope this article has provided you with many useful tech tips and tricks. You can search for similar articles on tips and guides. Thank you for reading and for following us regularly.