

How to turn on Picture in Picture on Edge is extremely simple

In the latest version of Edge browser, users do not need to install any other supporting utilities and can still watch Picture in Picture mode videos on any website,

Previously, to enable Picture in Picture mode on Edge, you could only watch Picture in Picture videos on YouTube, or install additional support utilities on the browser. However, in the latest version of Edge browser, users do not need to install any other supporting utilities and can still watch Picture in Picture mode videos on any website, including YouTube. The article below will guide you to turn on Picture in Picture on Edge.

Instructions for turning on Picture in Picture on Edge

Step 1:

In Microsoft Edge browser, users click on **the 3-dot icon and then select Settings** in the displayed list.

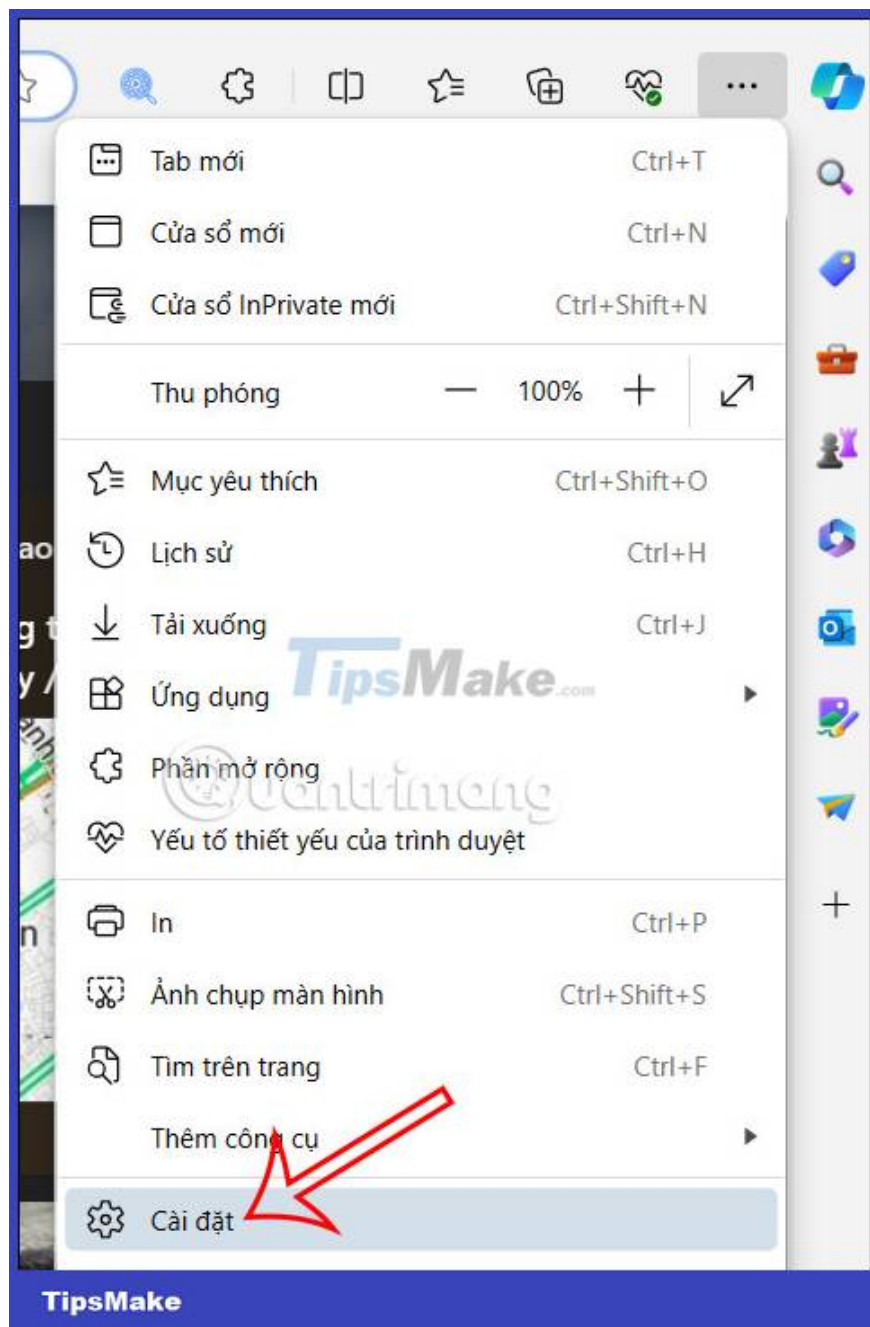

Step 2:

Switching to the new interface, users click on **Cookies and site access** to adjust the browser.

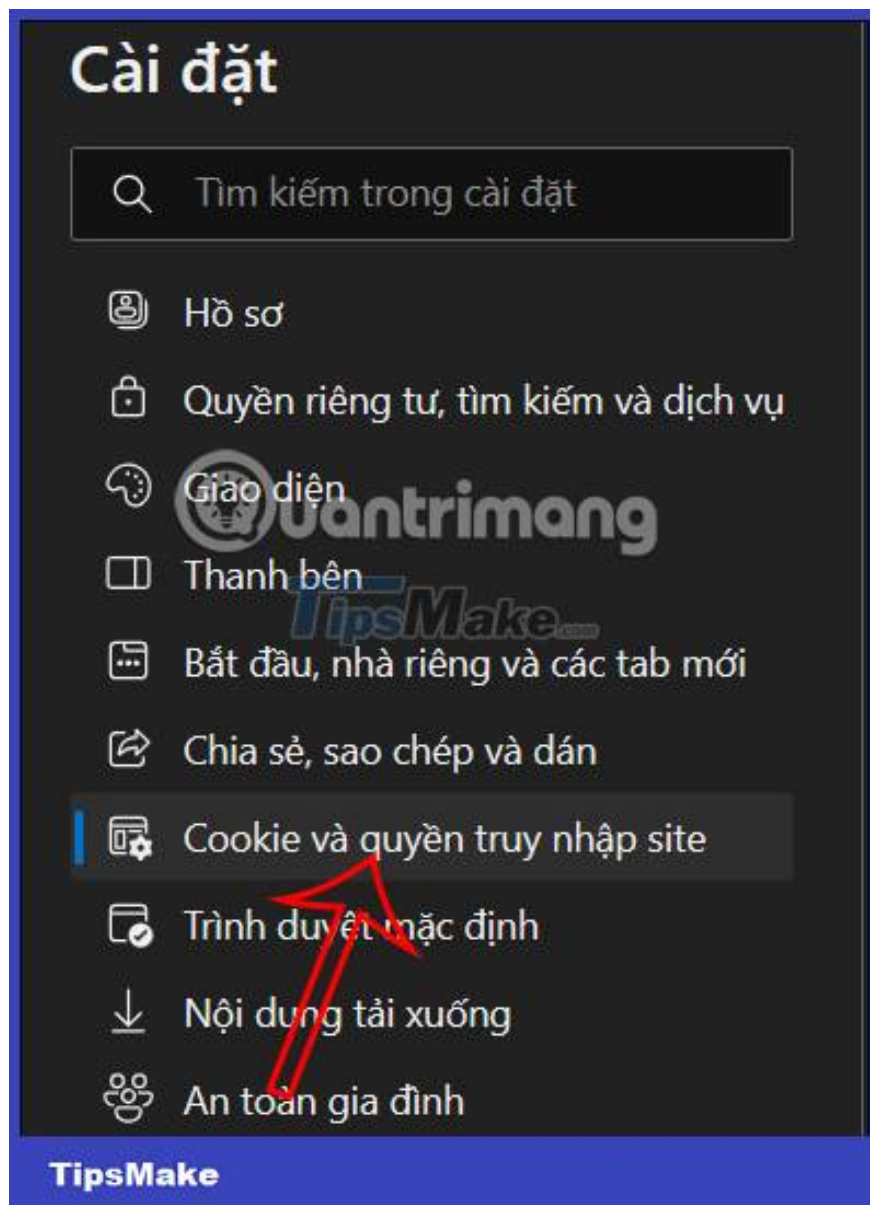

Step 3:

Now switch to the next interface, scroll down below the interface and click on the **Image** setting in the image control to click to use.

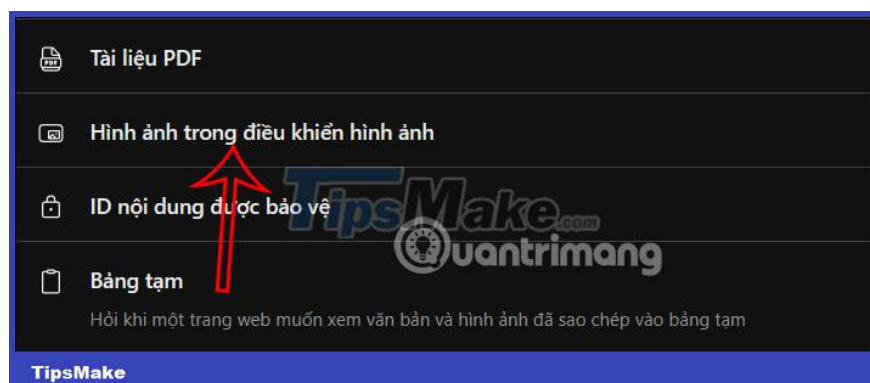

Now users will need to **activate the Picture setting in the picture control** to use Picture in Picture mode on Edge to watch videos.

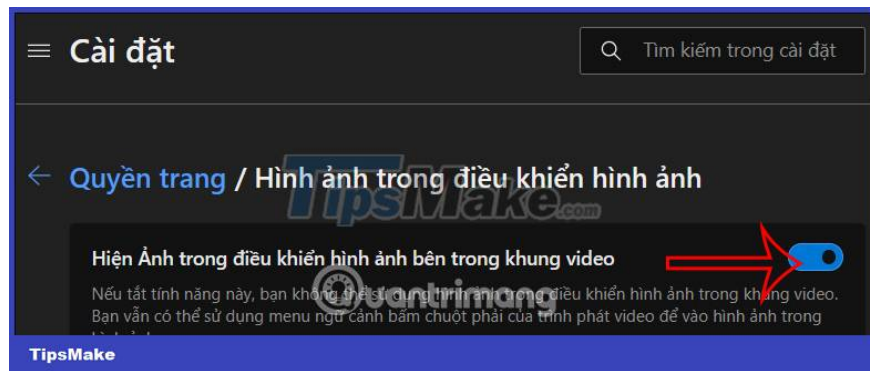

Step 4:

Now go back to the web browser interface and visit the video viewing website as usual. You **hover over the video playback screen** and then you will see **the Picture in Picture mode icon** to use to watch videos.



The video is immediately displayed in a floating window on the browser interface for you to watch the video and can move to any location, or zoom in and out according to your video viewing needs. When you want to return to the video viewing interface on the website, just click Return tab.



In addition, you can also do it quickly by just right-clicking on the tab on the browser, then selecting **Import image into image** . Immediately the video on that website is also played in Picture in Picture mode.

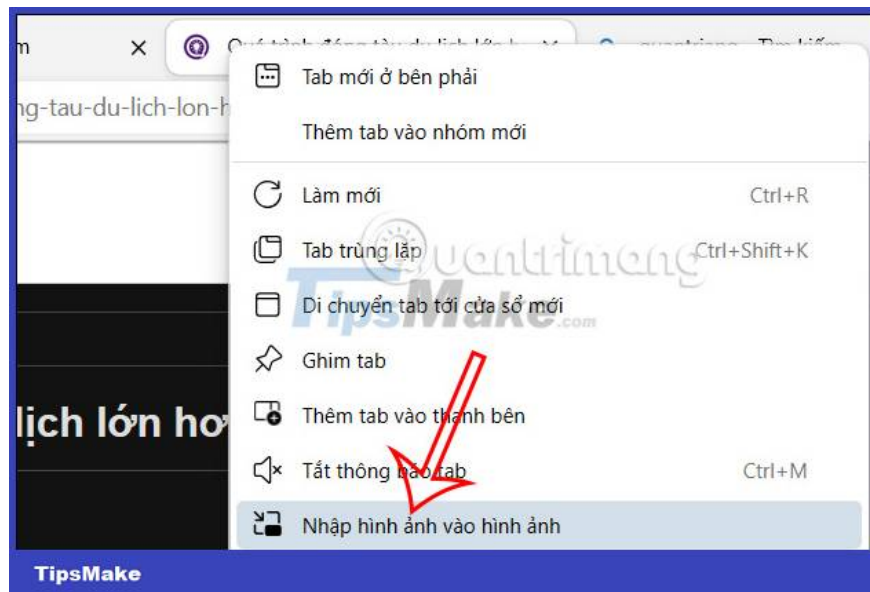

Turn on Picture in Picture mode on Edge using the utility

If you want a faster method that works on more sites, use the 'Picture-in-Picture Everywhere' extension for Microsoft Edge. Once the extension is installed, all you have to do is go to the page with the video and click on the extension icon from the toolbar to enter Picture-in-Picture mode.

To get started, open the Picture-in-Picture Everywhere add-ons page. Here, click on the 'Get' button.

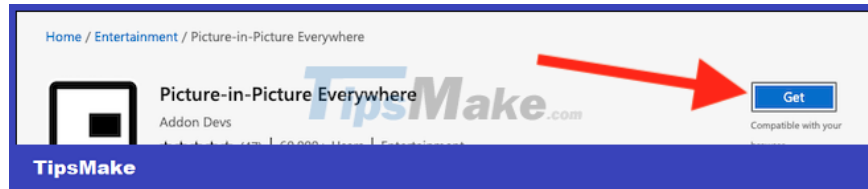

From the pop-up window, click on the 'Add Extension' option to install the extension.

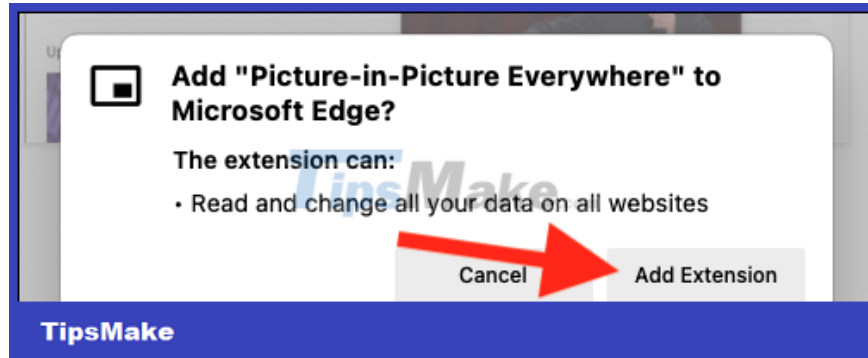

You will now find the Picture-in-Picture icon appearing in the extensions bar.

Next, simply open the website that contains the video you want to watch. This extension supports popular sites like YouTube, Netflix, Vimeo, and Twitch. Then, click the Picture-in-Picture extension icon from the toolbar.



The currently playing video will appear immediately in a floating window in the corner of the screen. Click the extension icon again to close the Picture-in-Picture player.

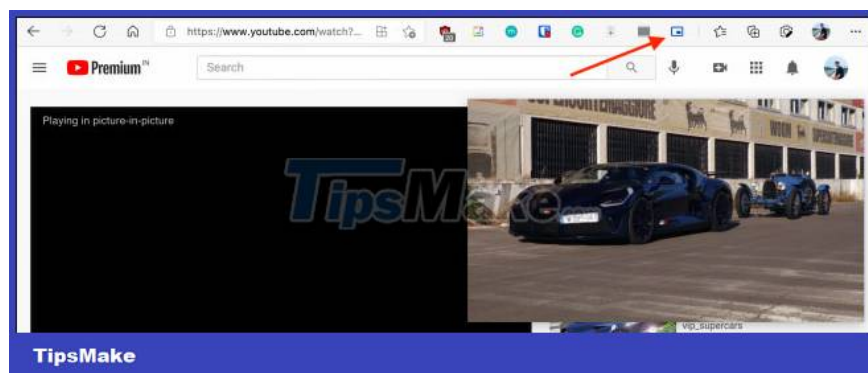

You finished reading the article "**How to turn on Picture in Picture on Edge is extremely simple**" edited by the [TipsMake](#) team. We hope this article has provided you with many useful tech tips and tricks. You can search for similar articles on tips and guides. Thank you for reading and for following us regularly.

