

# How to transfer applications from internal memory to a memory card

When we use Android devices, it is difficult to avoid the internal memory is full, full load due to too many applications being downloaded. However, the advantage of Android phones is that it supports memory cards, so you can easily move apps to the memory card to free up your internal memory.

## 1. How to move apps from internal memory to memory card on Android 8/9/10/11 and higher.

For Android operating systems 9/9/10/11 and higher we perform the following operations:

**Step 1:** You proceed to open **Settings (Settings)** on the device and select the **App (Application)** .

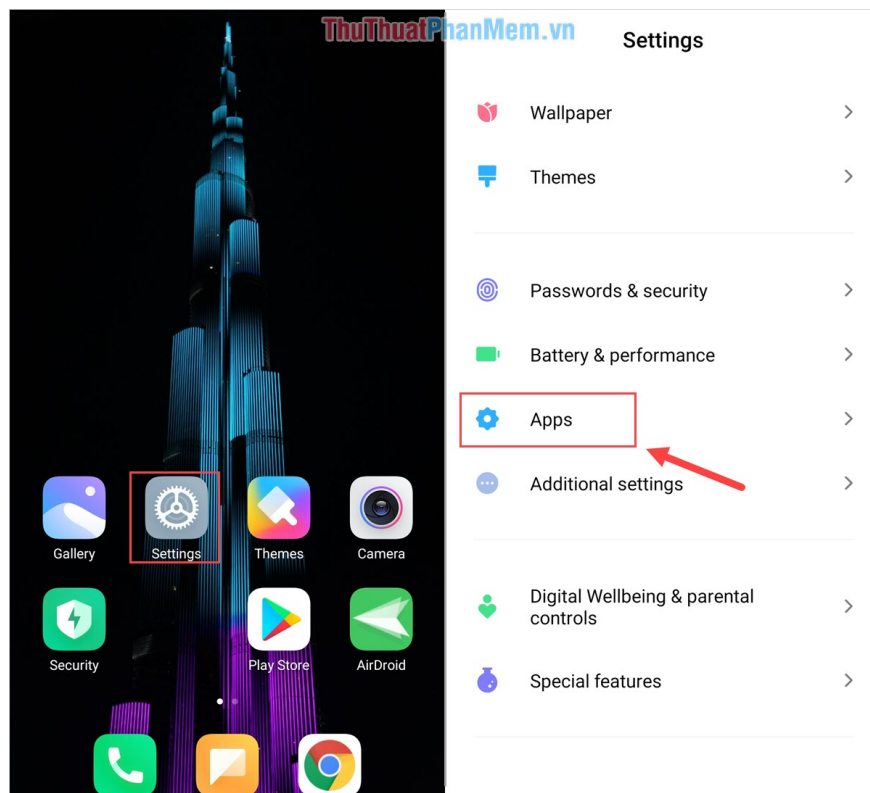

**Step 2:** Then, you select **Manager Apps (Application Management)** and select the application you want to transfer to SD memory card.

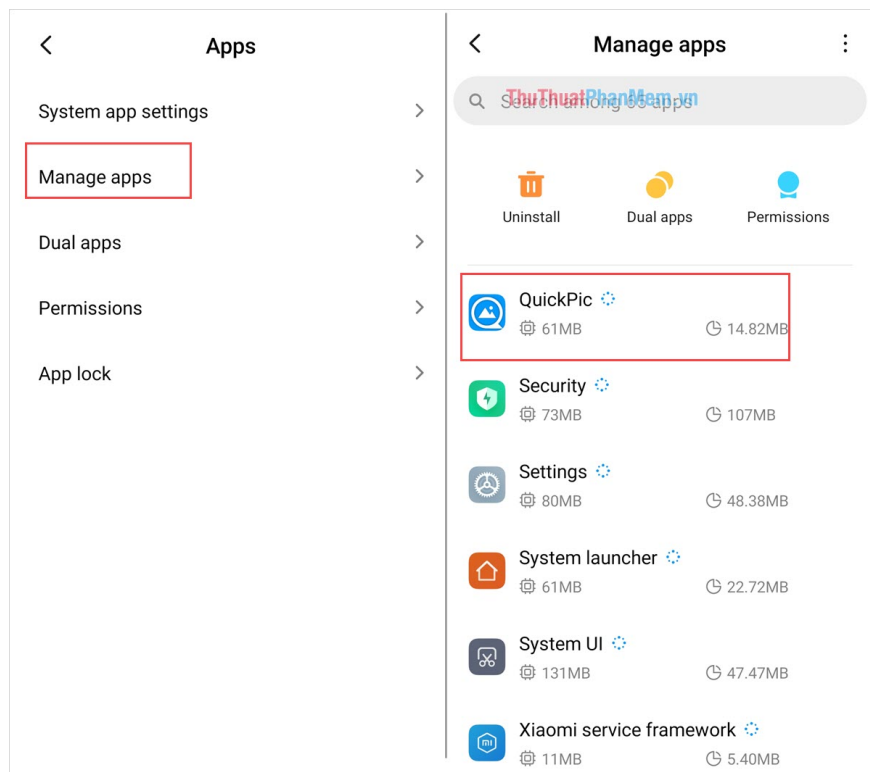

**Step 3:** When the application is opened, select **Storage** to adjust the application's storage location. Next, select **Change** and set the storage location to **Virtual SD Card** and you're done.

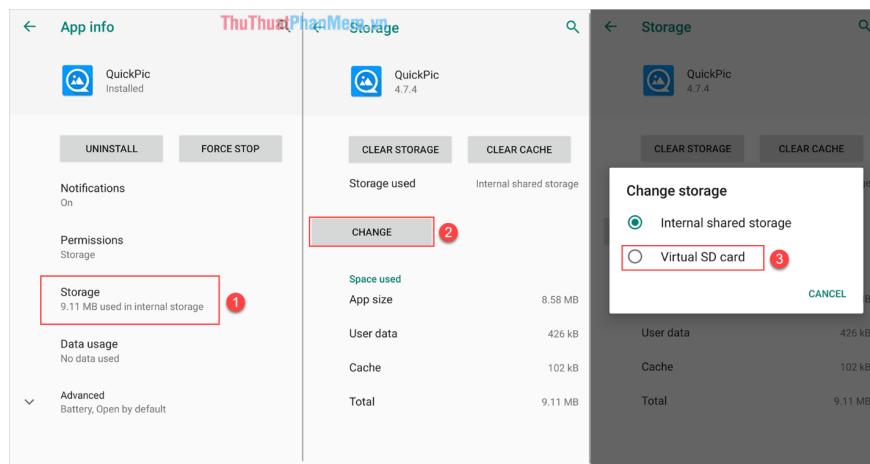

Now, all you need to do is wait for the system to copy the data and automatically switch to the SD card for you. You have completed the transfer of the application from the internal memory to the memory card.

## 2. How to move apps from internal memory to a memory card on Android 6/7

Most pure Android operating systems have the same application conversion operations from internal memory to the memory card, for Android 6/7 the interface is a bit different but basically still works like that:

**Step 1:** You proceed to open **Settings** and then navigate to the **App** section .

**Step 2:** Then, you select the **App (Application)** that you want to switch to SD memory card.

**Step 3:** You proceed to select **Storage** to see the data, next you select **Change** and select **Virtual SD Card** to transfer applications to SD memory card.

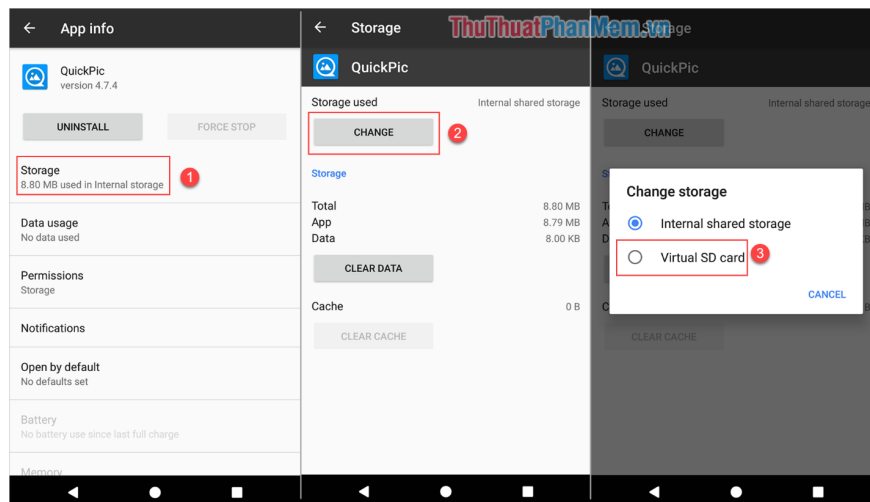

The application transfer from the internal memory to the external memory card will be completely automatic, you just need to wait a while is finished.

### 3. How to move apps from internal memory to a memory card on Android 4/5

Android 4/5 operating system has the ability to move applications from internal memory to an external memory card other than the more advanced operating system.

**Step 1:** You proceed to open **Settings** and then navigate to the **App** section .

**Step 2:** Then, you select the **App (Application)** that you want to switch to SD memory card.

**Step 3:** Finally, select **Move to SD Card** as the system will automatically transfer the application to an external SD card for you.

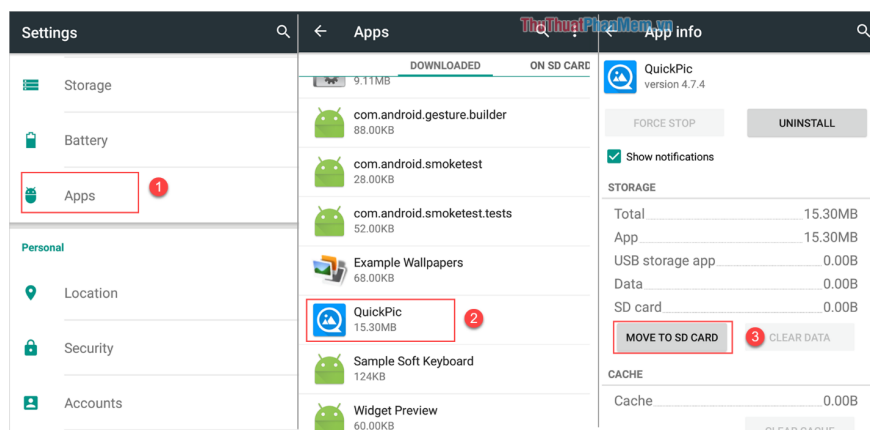

## 4. How to transfer applications from internal memory to a memory card with Link2SD software

Link2SD is a great solution to transfer applications from internal memory to external memory card quickly and efficiently.

**Homepage:** <https://play.google.com/store/apps/details?id=com.buak.Link2SD&hl=en>

Actions: You proceed to launch the application, then **press and hold on the application** to move to an external memory card to display the options panel.

When the options panel appears, select **Move to SD Card** to complete.

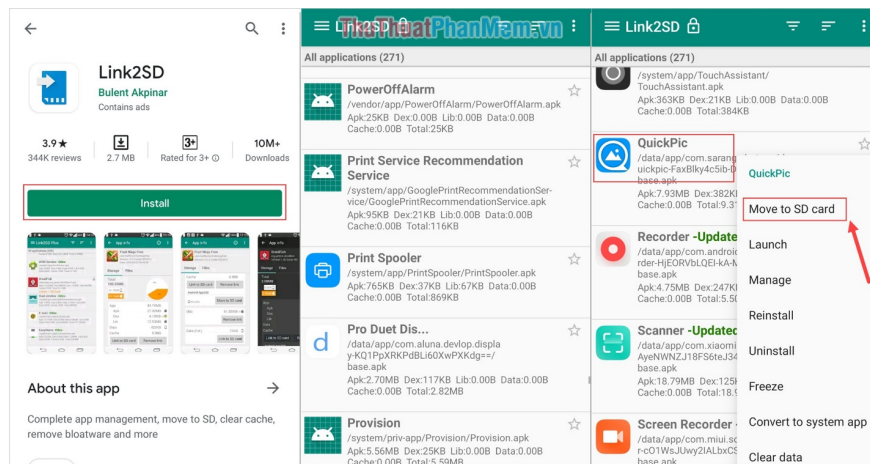

You finished reading the article "**How to transfer applications from internal memory to a memory card**" edited by the [TipsMake](#) team. We hope this article has provided you with many useful tech tips and tricks. You can search for similar articles on tips and guides. Thank you for reading and for following us regularly.