

How to split columns in Word - Instructions on dividing columns in Word 2007, 2010, 2013, 2016

How to divide a column in Word - Instructions on how to divide a column in Word 2007, 2010, 2013, 2016. In order for your text content to be presented scientifically beautifully and visually, dividing columns in the text is also a layout. Popular version. The article below helps these

In order for your text to be scientifically presented and visually pleasing, splitting columns in the text is also a preferred text layout. The following article helps you divide columns in Word 2007, 2010, 2013, 2016.



Divide columns in the text ie you will divide the text content into multiple columns, the text will automatically write column 1 and then the next column. For example, divide the following text into 2 columns:

Select the text to divide the column -> on the **Layout** tab -> **Columns** -> select the value to split the column, for example, here should divide the column, select **Two**:

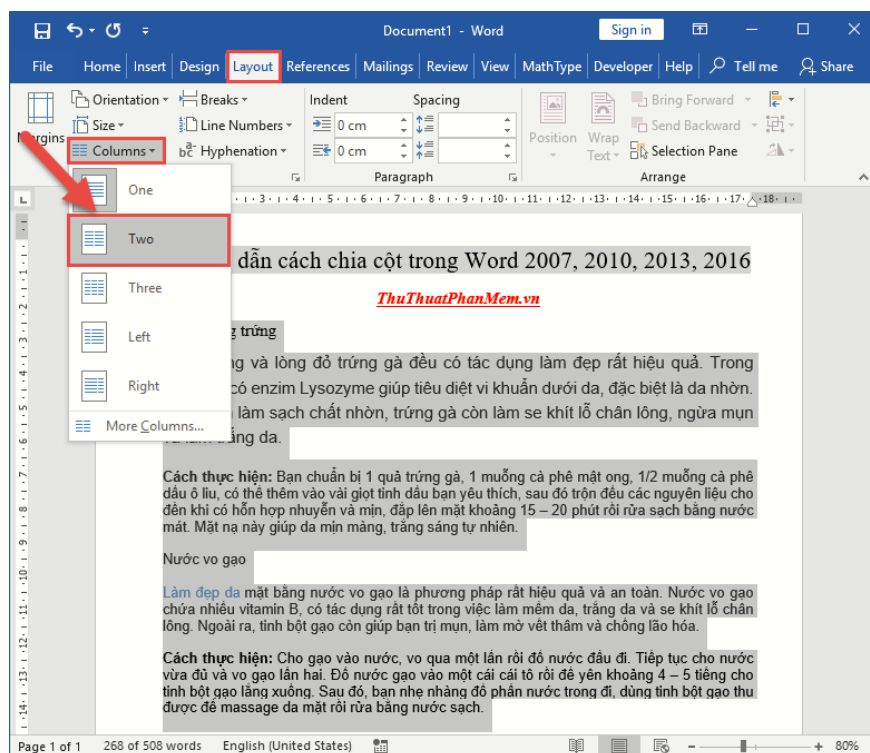

After selecting the number of columns, the text content is divided into 2 columns of equal width:

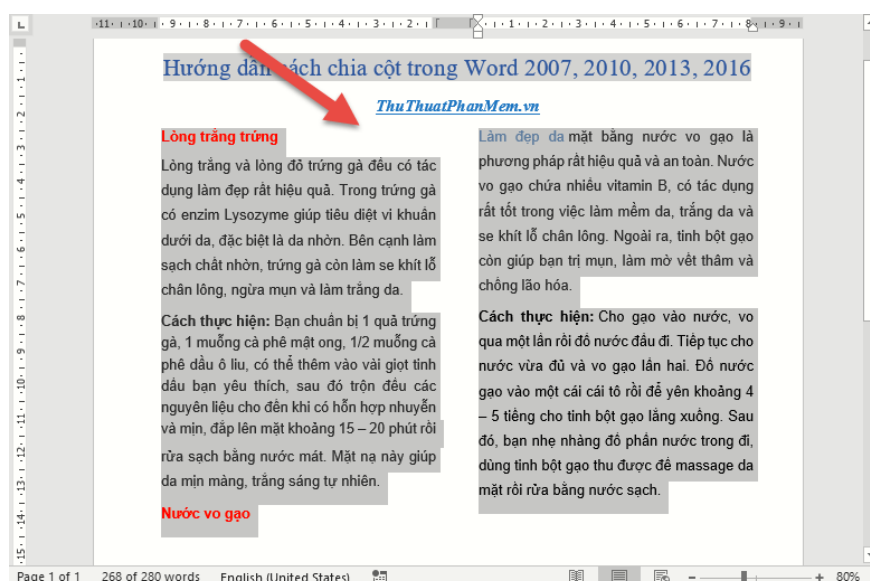

But Word shows the default dividing 3 columns (to the value of Three) if you want to split into more columns and split columns of different widths, with lines below as follows:

Step 1: Select the text to divide the column -> on the **Layout** tab -> **Columns** -> **More Columns** .

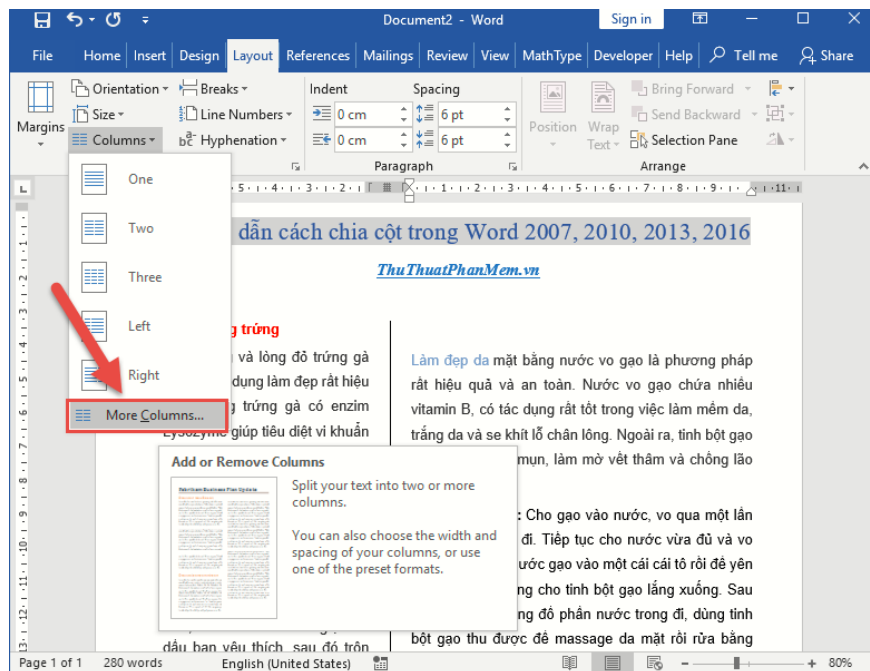

Step 2: A dialog box appears to select the number of columns to divide, change the value in the **Number of Columns** section:

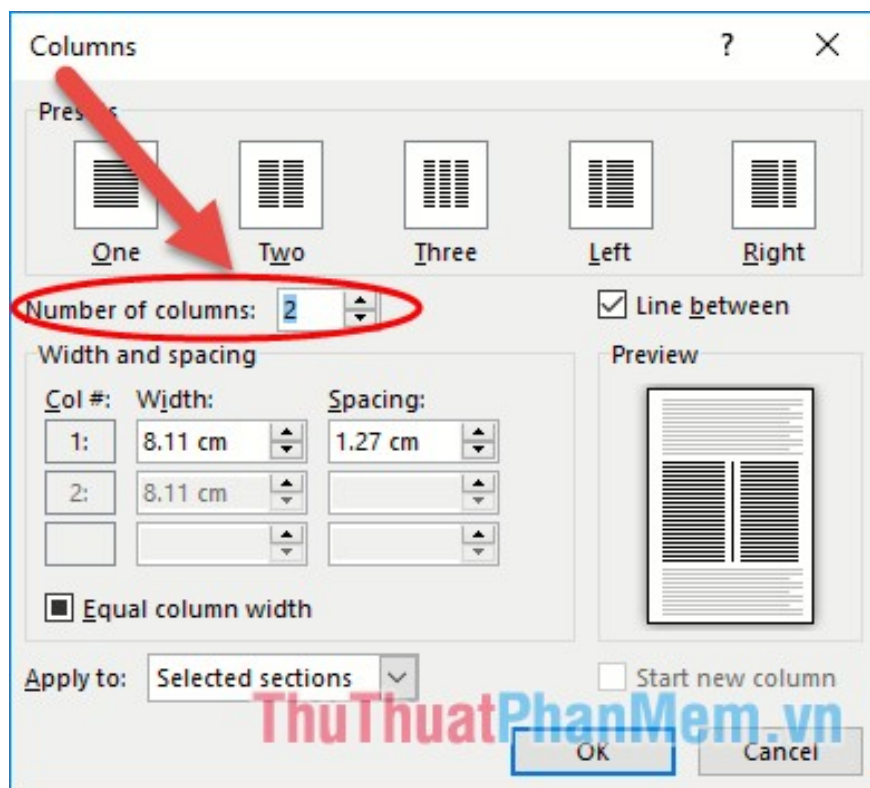

Step 3: To create a line between divided columns, select **Line between**:

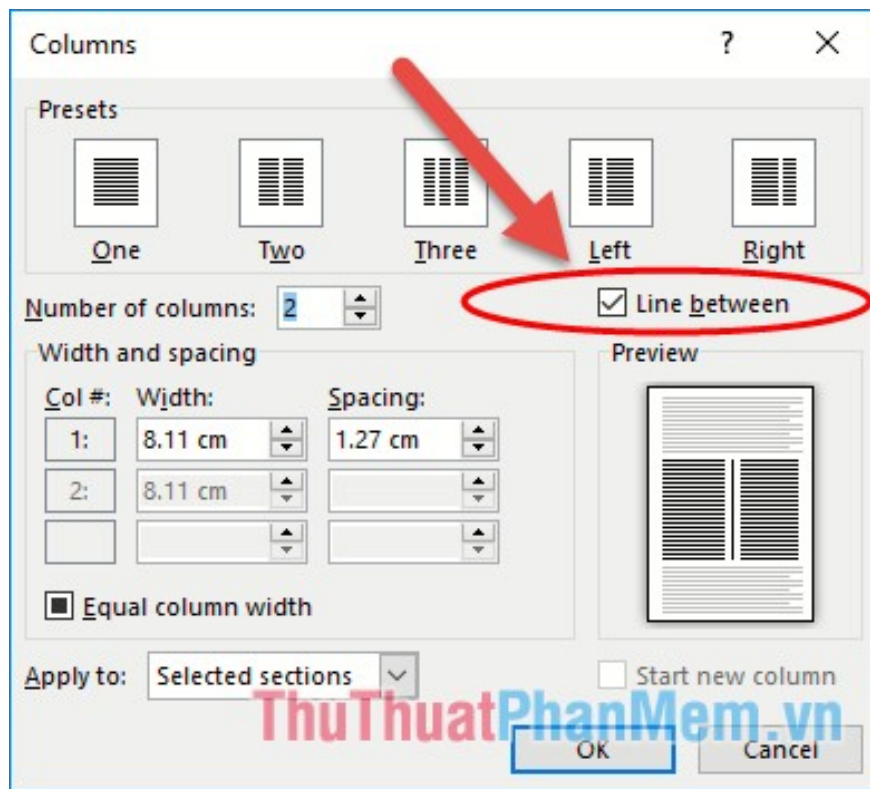

Step 4: To adjust the width of columns you deselect in **Equal column width** -> change the width of columns in **Width** , the distance between columns in **Spacing** -> click **OK**:

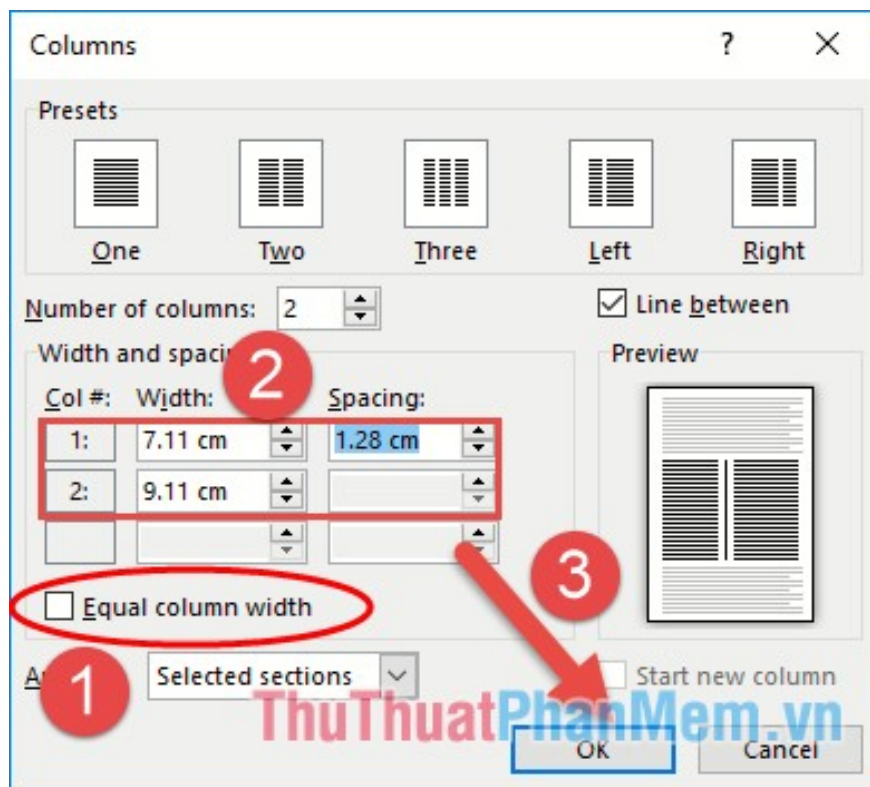

The results you have format the column display type and the width of the columns:

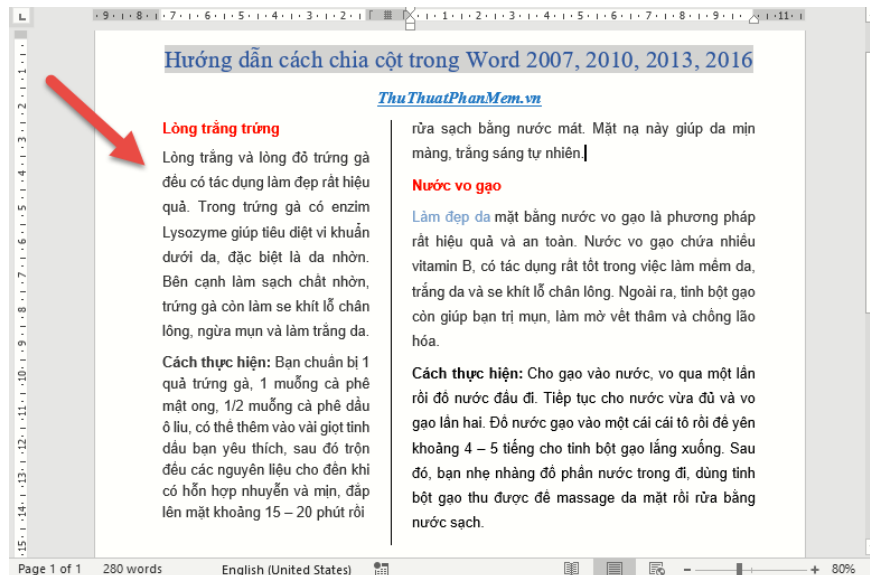

In case you want to convert the first 2 rows of column 2 to column 1 to divide 2 contents into 2 corresponding columns as shown:

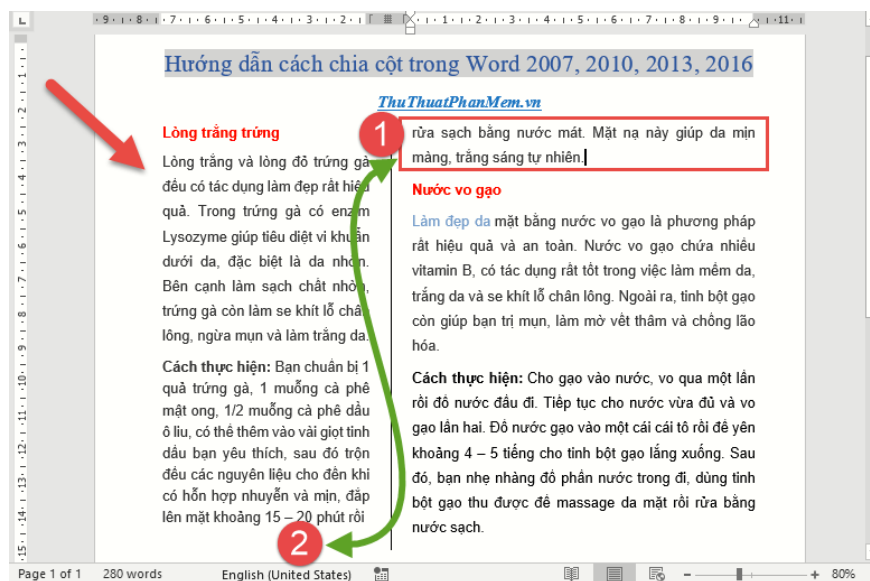

You just need to put the mouse cursor at the last position of the line 2 to move -> click the **Layout** tab -> **Breaks** -> **Columns**:

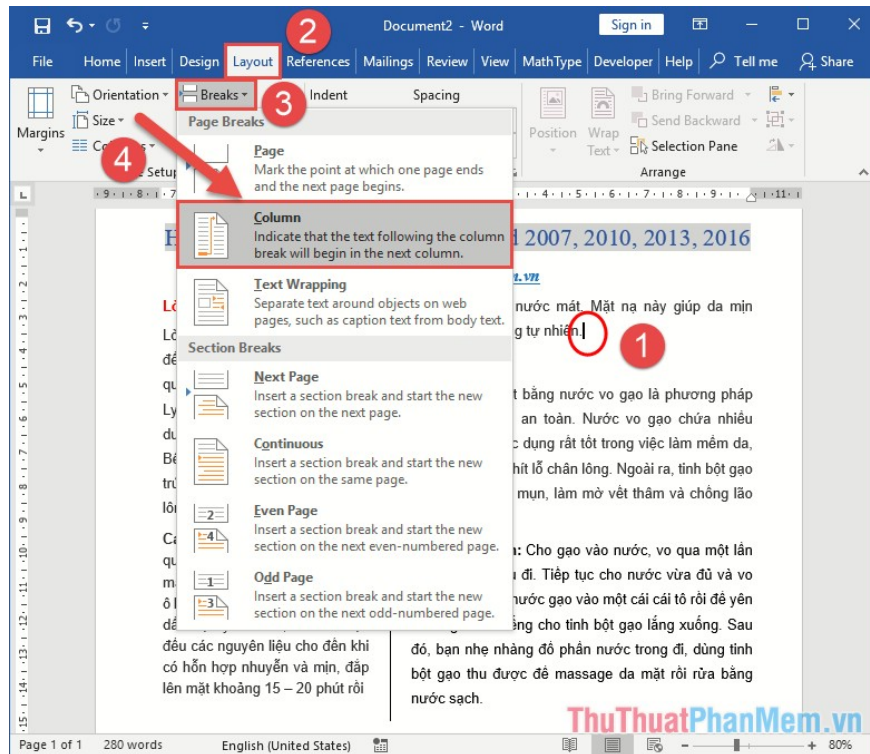

As a result, you have moved the content to break into column 1, you just need to delete the blank line on the same column 2 to complete the transfer process:



In case you want to create large letters at the beginning of paragraphs to increase the aesthetics of the text, simply highlight the letters to be created on the **Insert** tab -> click the **Drop Cap** icon -> select the type of **Drop Cap** to create -> As a result, you created the first capital letter:

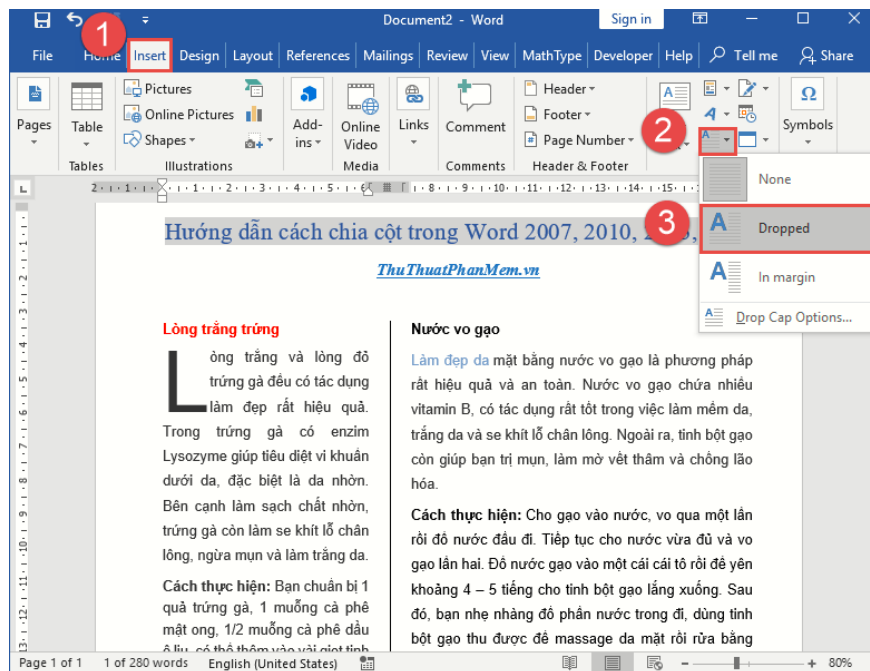

Also, if you want to leave multi-column mode, want to return to the original state with only 1 column, you just need to go to **Layout** -> **Columns** -> choose **One**:

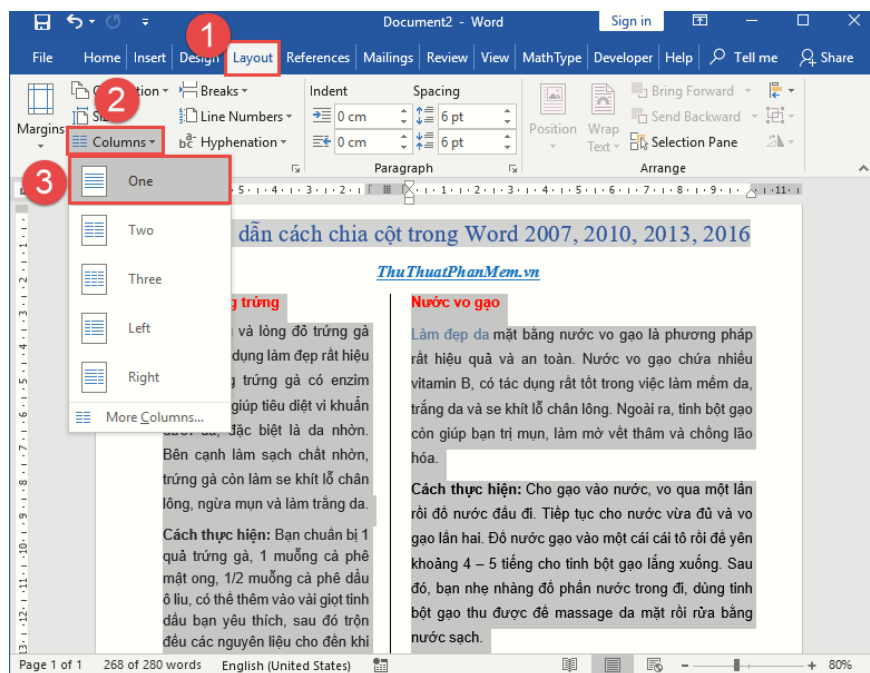

So with some manipulations you can divide columns in versions of Word 2007, 2010, 2013 as well as word 2016. Wish you success!

You finished reading the article "**How to split columns in Word - Instructions on dividing columns in Word 2007, 2010, 2013, 2016**" edited by the [TipsMake](#) team. We hope this article has provided you with many useful tech tips and tricks. You can search for similar articles on tips and guides. Thank you for reading and for following us regularly.

