

# How to set up Netflix to watch high quality movies

To always watch high quality Netflix movies, we just need to set it right in the app or right on Netflix for a computer.

To always watch high quality Netflix movies, we just need to set it right in the app or via Netflix on the web. When there is a problem or slow network, surfing the web, watching YouTube videos is definitely affected, the video automatically chooses at the lowest resolution mode. However, on Netflix there are some settings for you to choose the sharpest movie resolution without having to worry about slow network anymore. The following article will guide you how to set the quality of watching movies on Netflix.

## Instructions to set quality for watching Netflix movies

### Netflix on Android, iOS

On this Netflix app, users go to the **More tab > App Settings** . Then click on the **Download Video Quality** section , select **High** to download and stream the video in the highest format (at least fullHD) according to the purchased package.

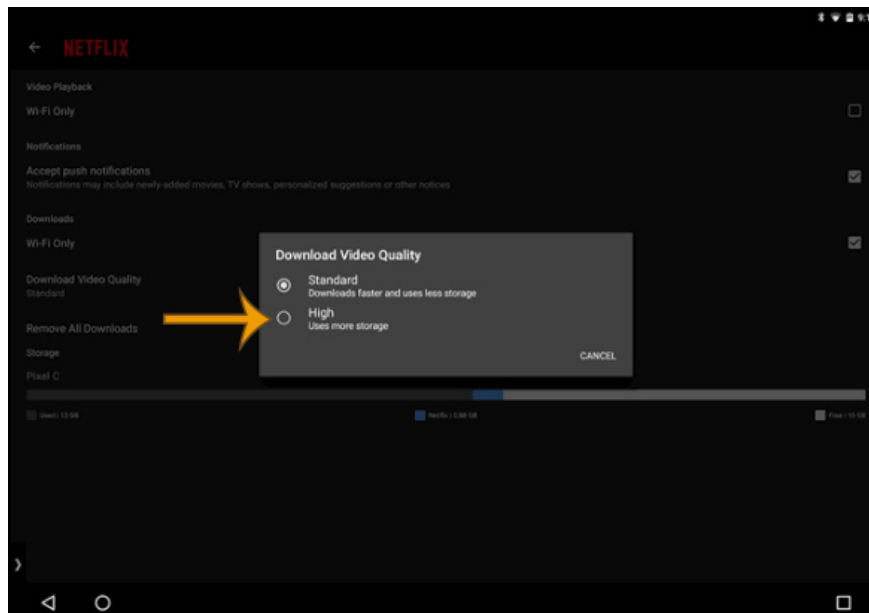

**On Netflix Windows** , press the menu button on the right corner of the screen and select Settings, then also convert the video to high quality.

**On Netflix web browser** , users click on the account avatar, select Accounts, then switch to the new interface, click Account & Parental Controls. Then click on your Netflix profile and select Playback Settings and select High at Data usage per screen.

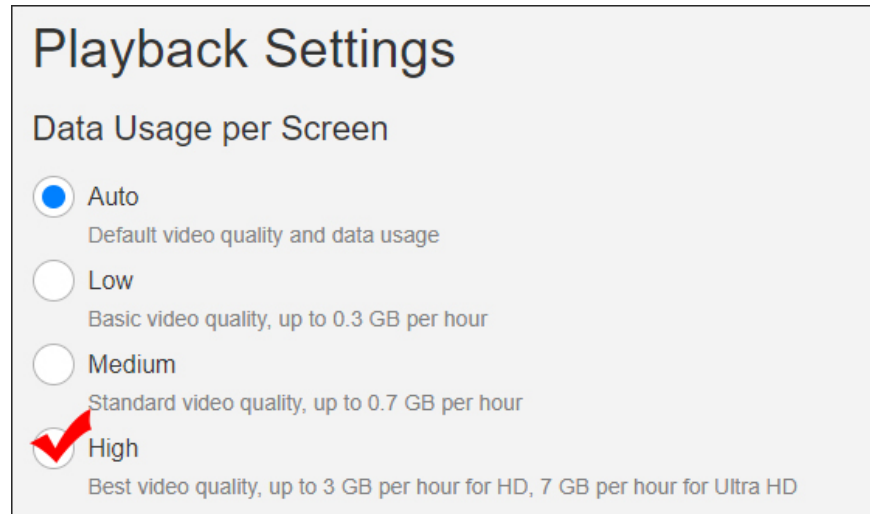

### **Step 2:**

So we have set high quality for Netflix video. Now you just need to download the video to enjoy. To download movies on Netflix, please refer to [How to download movies on Netflix to your phone](#).

### **Note watching high-resolution videos on Netflix**

1. During the process of downloading videos that you watch movies, the video quality will be affected by the transmission line. If you access Netflix on macOS or smart TVs, you need to ensure a strong network connection speed to stream videos at the highest resolution.
2. Mobile devices need a Widevine L1 certificate to watch fullHD video or above, if the L3 certificate then the video only reaches SD 480p. Go to Settings> Playback Specification to check the model number, the maximum video quality to watch on Netflix and whether HDR support.
3. If the device is Widevine L1 certified and watching videos is still in normal quality, then remove the Netflix app and reinstall from the beginning.

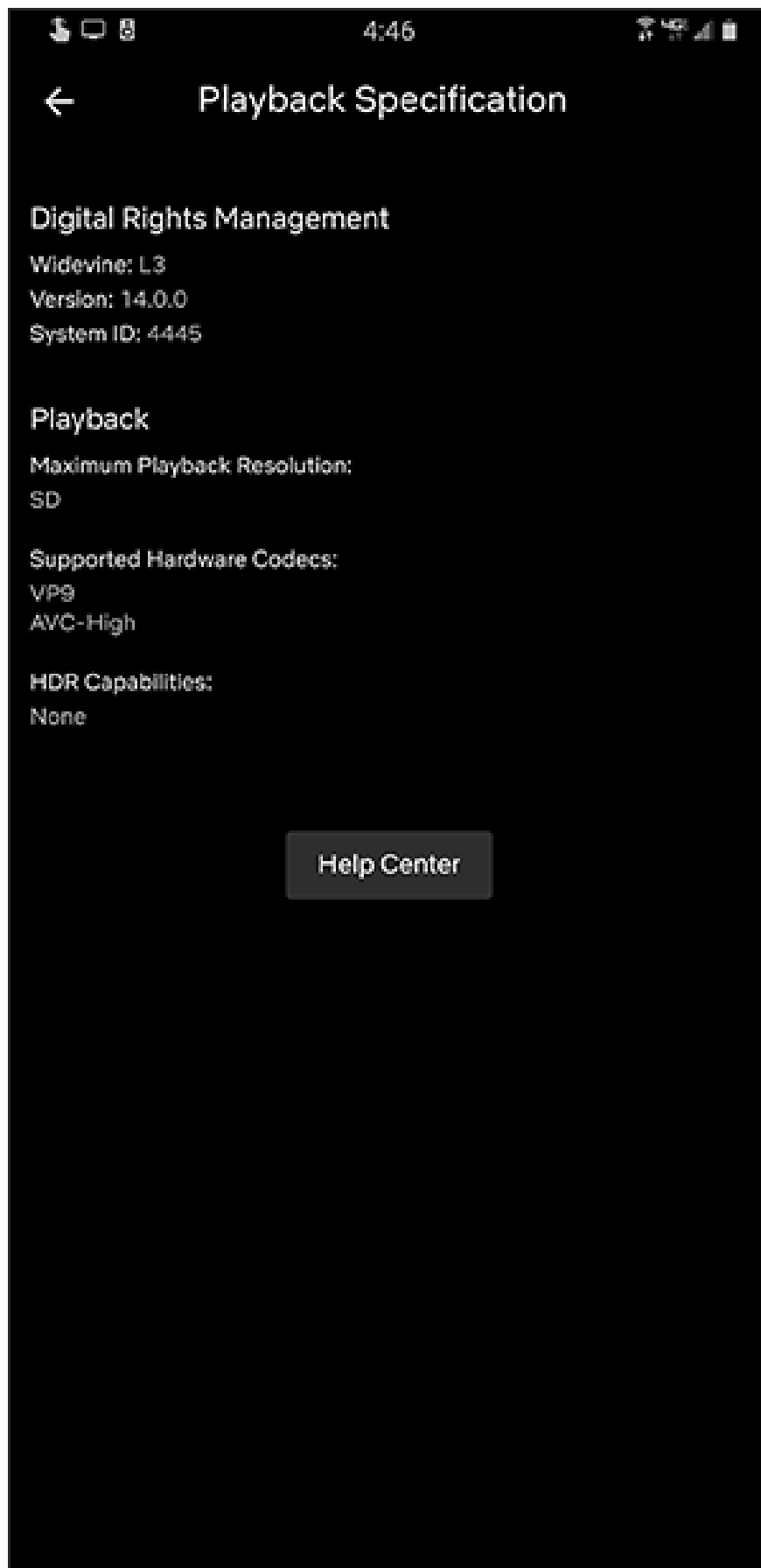

You finished reading the article "**How to set up Netflix to watch high quality movies**" edited by the [TipsMake](#) team. We hope this article has provided you with many useful tech tips and tricks. You can search for similar

articles on tips and guides. Thank you for reading and for following us regularly.

---