

How to set a password for Google Chrome

The Set password for your browser utility will block Google Chrome browser with the password set by the user. And others are required to enter the correct password to access the Chrome browser.

To lock Chrome browser, prevent others from accessing it without permission, we can install the Set password for your browser. This utility will set a password for users to secure Chrome browser, not for anyone to use unless it has a password.

This is similar to setting a Win 7 password , or setting a Win 10 password . We also need to set the password range to prevent unauthorized access to the browser, thereby securing the data on Chrome such as passwords, accounts, etc. It can be considered as the second security layer. After they set the password for the computer. The following article will guide you how to set a password for Chrome, with the utility Set password for your browser.

1. How to view and delete saved passwords in Chrome browser
2. How to lock Google Chrome profile with a password

Step 1:

You access the link below to access the utility settings page Set password for your browser.

1. <https://chrome.google.com/webstore/detail/set-password-for-your-bro/cjmjgijhpagicbhmniemjkjeadanank>

Step 2:

Click the **Add and Chrome** buttons to install the add-on browser.

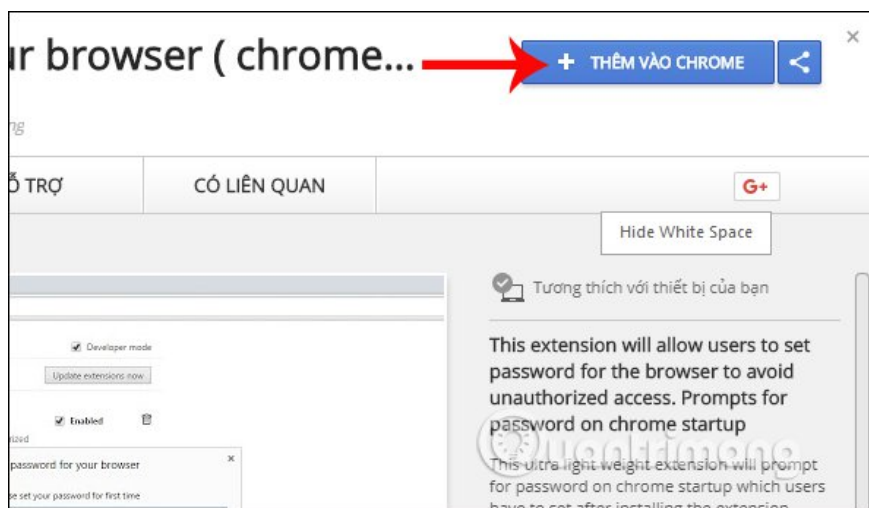

After that, click on the **Add add** button to install.



Step 3:

When the utility installation is completed, the user will see **the Set password for your browser icon** at the end of the browser address bar.

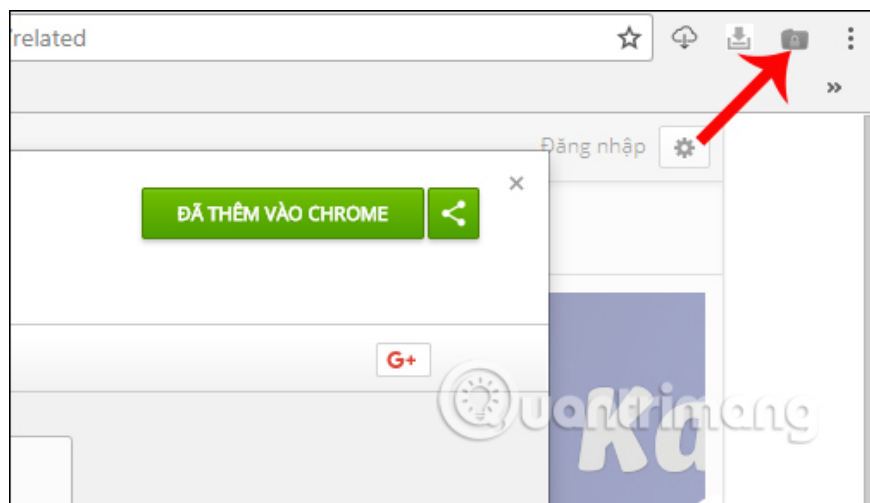

Also on the browser interface will appear the **frame Set password for your browser (chrome lock)** for users to enter the password for the browser. The utility will not limit the length of the password as well as which characters to use in the password.

However, you should set the Chrome security password with the addition of alphanumeric characters, or special characters next to numeric characters to increase the unpredictability of the Google Chrome password range.

Finally **click OK** to save.

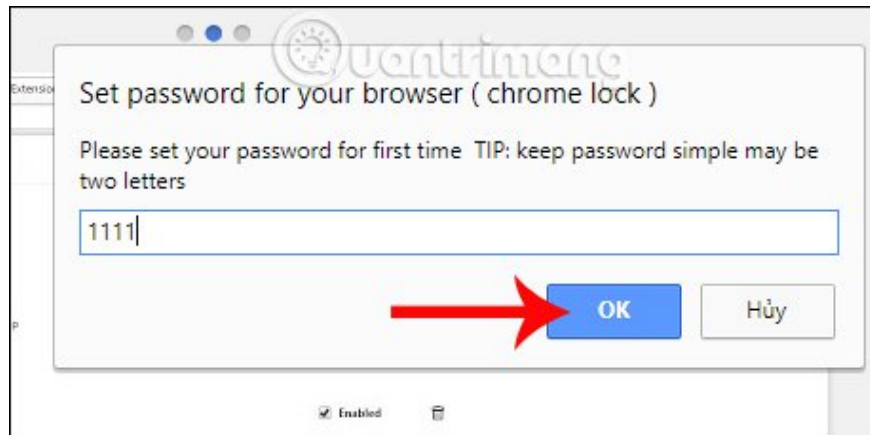

Step 4:

After that, the **password saved . interface** appears that means you have successfully set the password for Google Chrome. Click **OK** to exit.

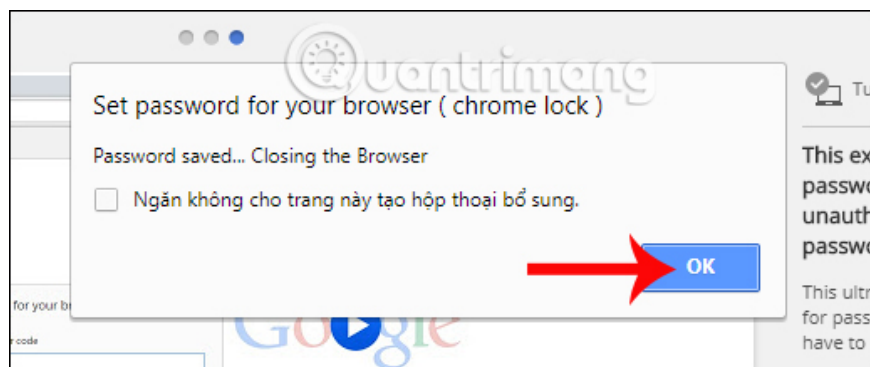

Step 5:

Exit the browser and reboot so that password generation for Chrome is applied. When opening Chrome browser, the dialog box asks you to enter the password that appears. Enter the correct password and click OK to open the Chrome browser. Thus, only those who know the password created for Chrome can use this browser.

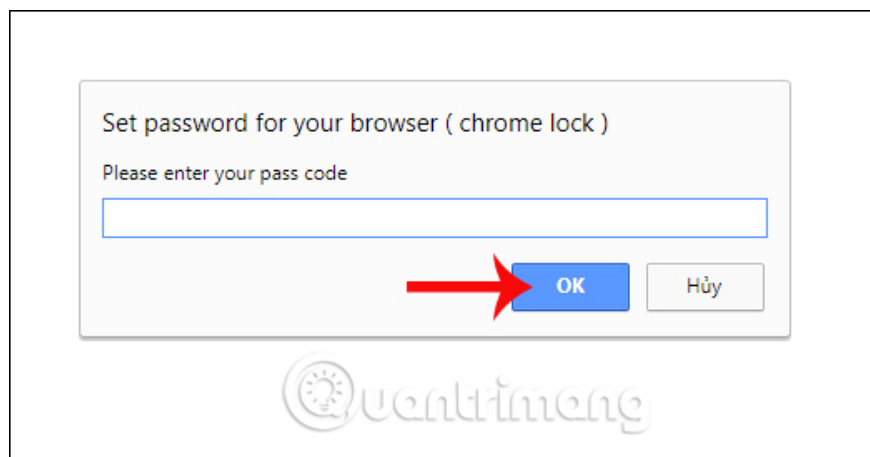

Step 6:

In case you want to **change the Google Chrome security pass** , click on the **Set password utility icon for your browser** at the end of the address bar on the browser and then click on **Options** .

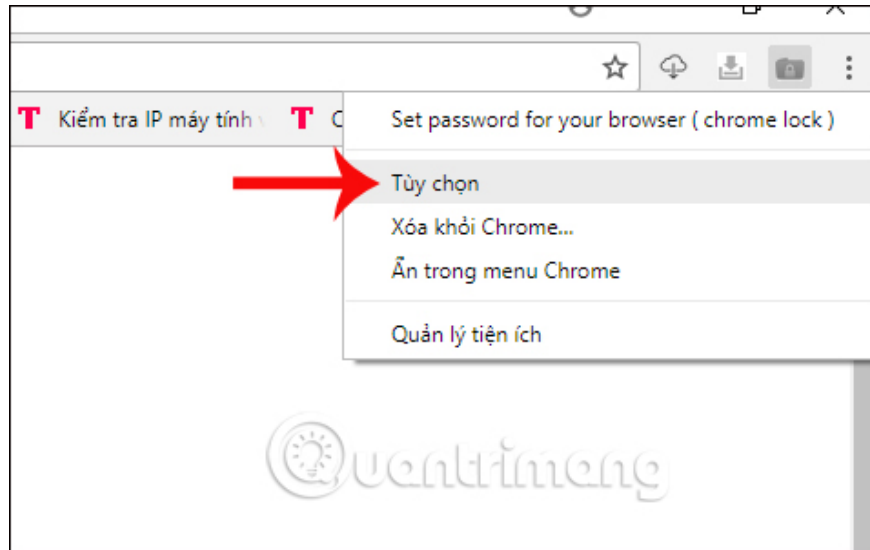

You will then be transferred to the **Change Password** interface. Enter the current password in the Enter old password box and then **enter the new password in the Enter new password** . Finally **click Save** at the bottom to save the new changes.

The Dynamic Password section will install the more complex password, with the security type in question. Users need to read carefully when setting up security type for Chrome this type of question.

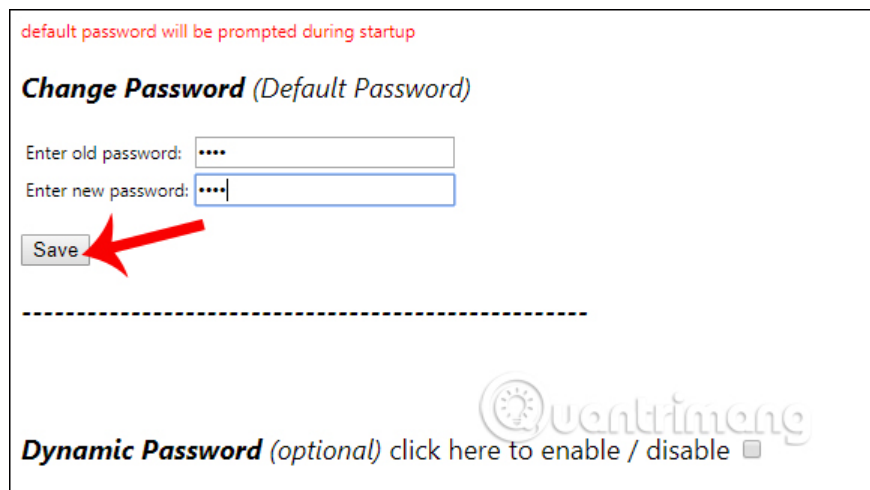

The above is a security method for Chrome browser, with a very familiar password setting, by installing the Set password for your browser utility on the browser. For families with small children who do not want their children to access Google, this utility will definitely be an effective solution.

I wish you all success!

You finished reading the article "**How to set a password for Google Chrome**" edited by the [TipsMake](#) team. We hope this article has provided you with many useful tech tips and tricks. You can search for similar articles

on tips and guides. Thank you for reading and for following us regularly.
