

How to set a password for a Windows 8 / 8.1 computer

Setting a password for Windows 8 computers helps users to protect personal data in the computer, from unauthorized access by others.

Setting up a Windows computer security password is a basic and necessary operation to protect personal computers, important information and data from unauthorized access. On Windows 8, the option to create a password is built into the system setup with a very simple way to do it. You will have the option to create a regular password, use additional PIN codes or log in with Windows 8 images like when creating a password on Windows 10. However, how to create a common password is used by many people because of the way made more simple. How to create a password for Windows 8 detailed in the article below.

1. Instructions for creating Password Reset Disk on Windows 8

Step 1:

First, move your mouse to the right corner of the screen so that the Charm appears, then click **the Settings icon** .

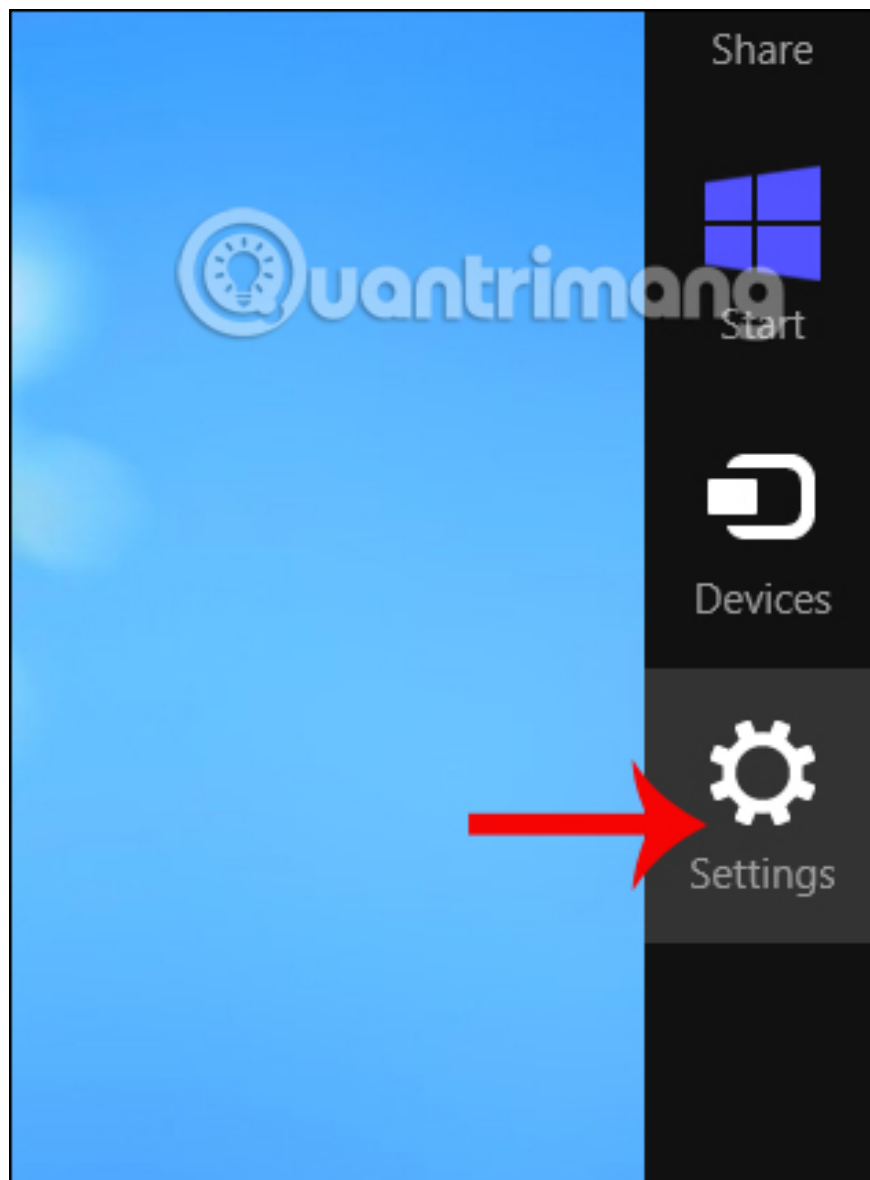

Step 2:

Next, click on **Change PC Settings** at the bottom of the interface.

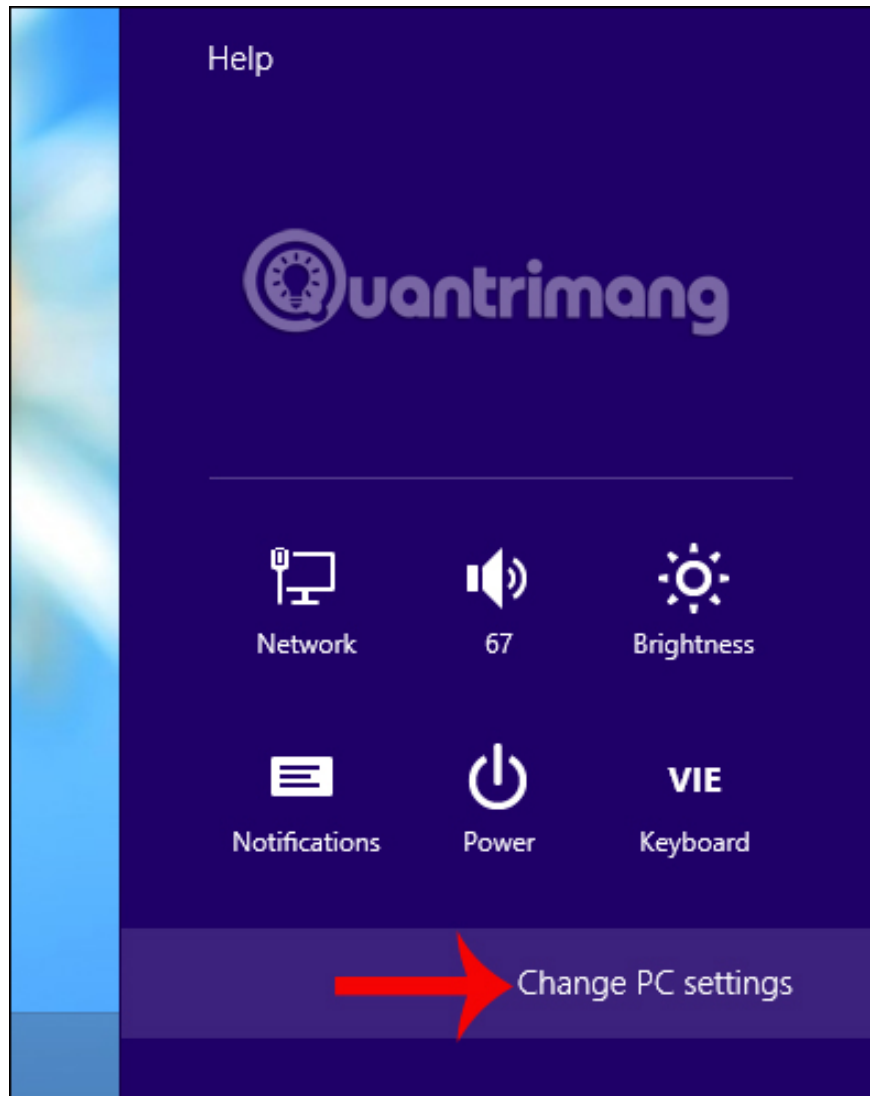

Step 3:

Switch to the PC Settings interface, click the **Users setup** item. You then look to the right to see the **Sign-in options** section to set up a computer login, click **Create a password**.

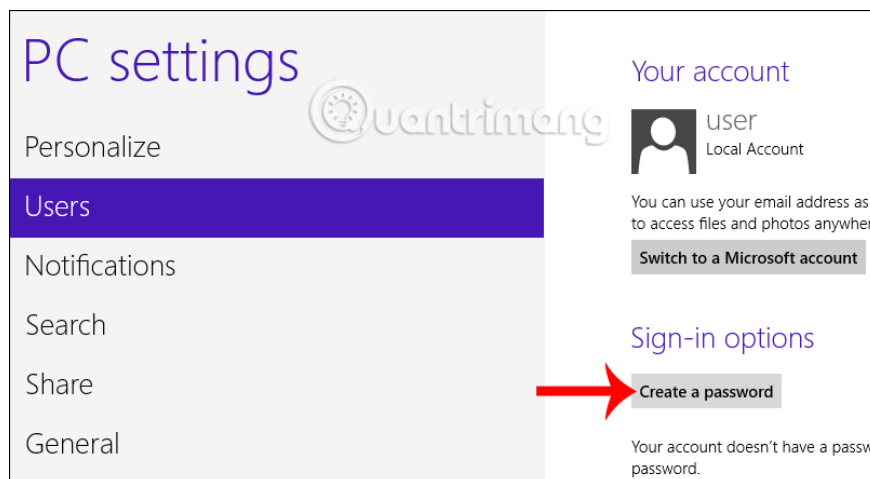

Step 4:

The **Create a password** dialog box appears. Here you **enter** your computer **login password** at New Password, enter the correct password at Reenter password, and suggest a password at Password hint if you forget the Windows 8 login password, you can skip the suggestions section. password.

Then **click Next** to complete creating a Windows login pass.

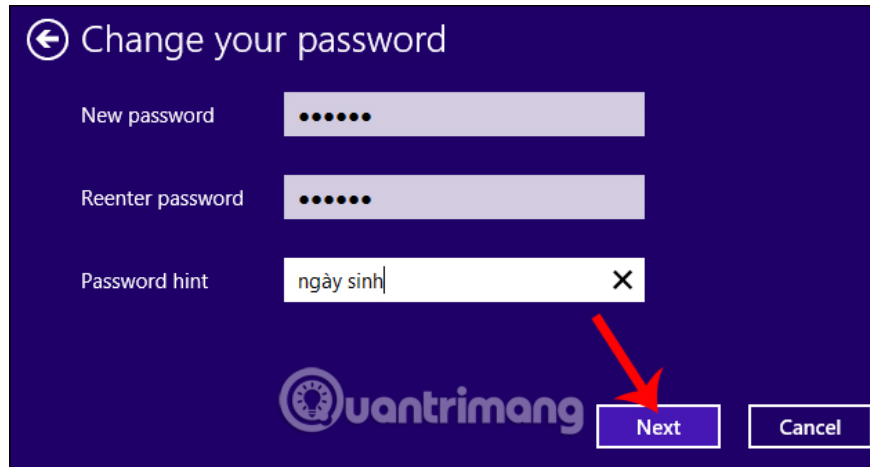

Step 5:

Finally **click Finish** to close the interface to create Windows 8 password again.

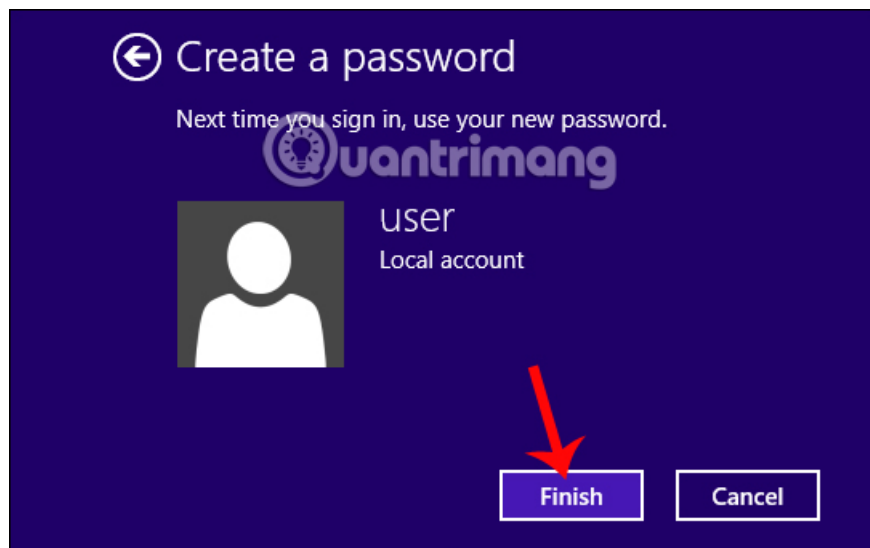

So we have finished setting up the Windows 8 computer password. When you open the computer, enter the correct password to log in to the computer.

Step 6:

In case you want **to change the Windows 8 password**, we also access the PC Settings interface and click on set Users. In the Sign-in options section click **Change your password** to change the password.

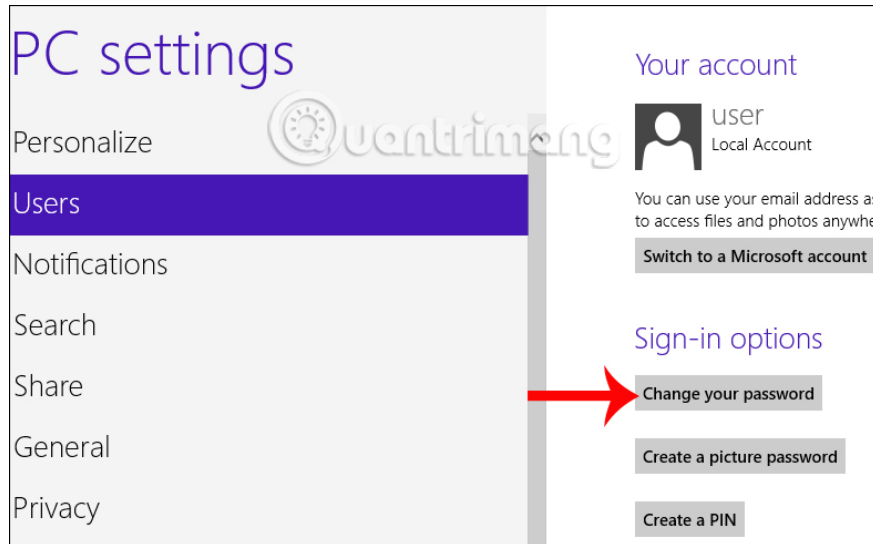

Step 7:

The Change your password window appears, enter the password you are using in **Current password** and then **click Next** to continue.

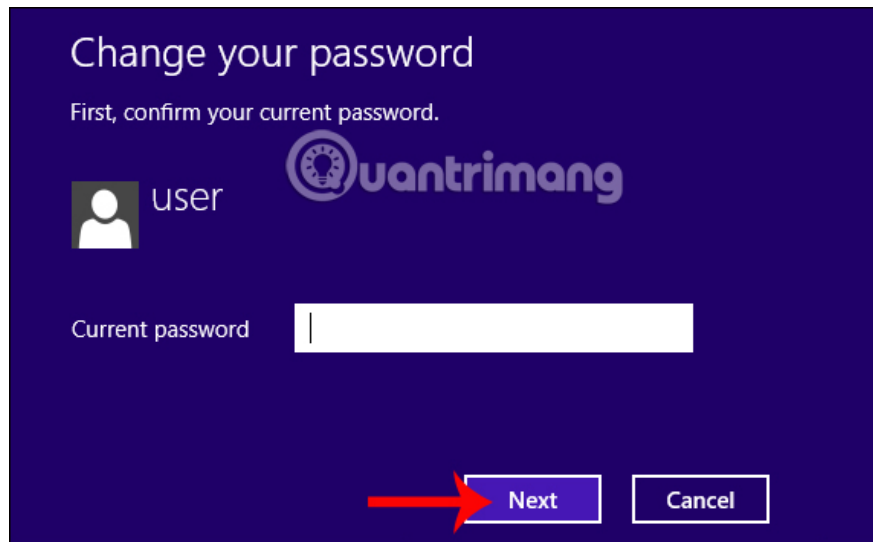

Step 8:

Then we also **enter the new password for Windows 8** into this interface and then **click Next** below.

So you have already changed the password for the Windows 8 computer.

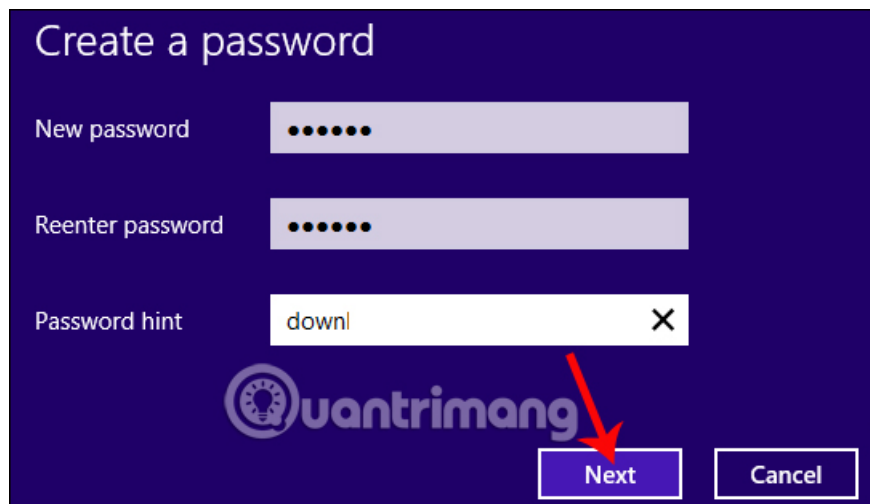

Above is a tutorial on how to set Windows 8 password and how to change a new password for the computer. Don't forget to set a password for your computer so you can secure the personal information in your computer.

I wish you all success!

You finished reading the article "**How to set a password for a Windows 8 / 8.1 computer**" edited by the [TipsMake](#) team. We hope this article has provided you with many useful tech tips and tricks. You can search for similar articles on tips and guides. Thank you for reading and for following us regularly.