

How to round the corners of a selection in Photoshop is simple and easy

With the Rectangular Marquee Tool, you can easily select the area you want to edit in Photoshop, round the corners of the selected area in Photoshop to make the photo look softer, more beautiful and more attractive, then this article is for you. .

Photoshop tools allow you to be flexible in using tools to make your working process easier and more convenient. Among them, **rounding selection corners in Photoshop** is a good tip that many people will probably use. pay no attention.

1. How to round the 4 corners of an image in Photoshop

Step 1: Open the image with **Photoshop** .

- Note: If the image is layer locked, you need to unlock it by clicking on the lock image in the Layer menu.

Step 2: Press the key combination **Ctrl + A** to select the entire image.

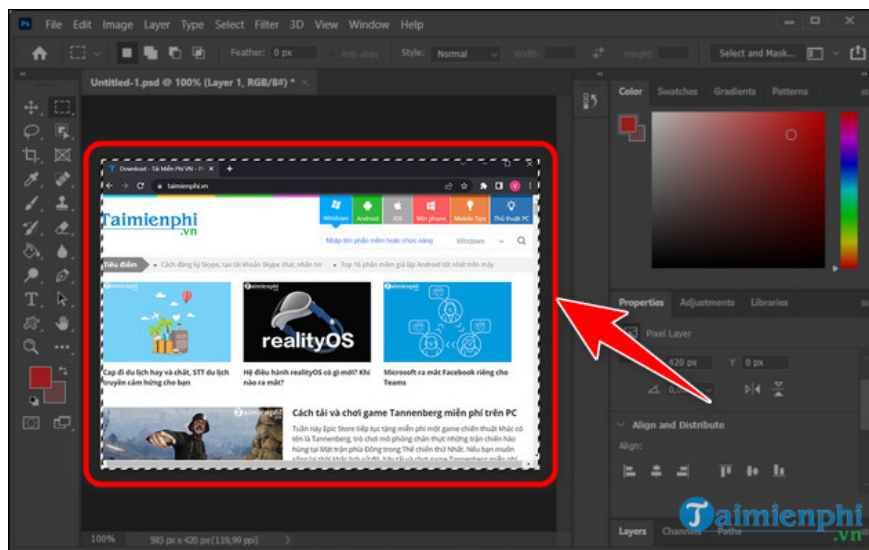

Step 3: Go to **Select** , select **Modify => Border** .

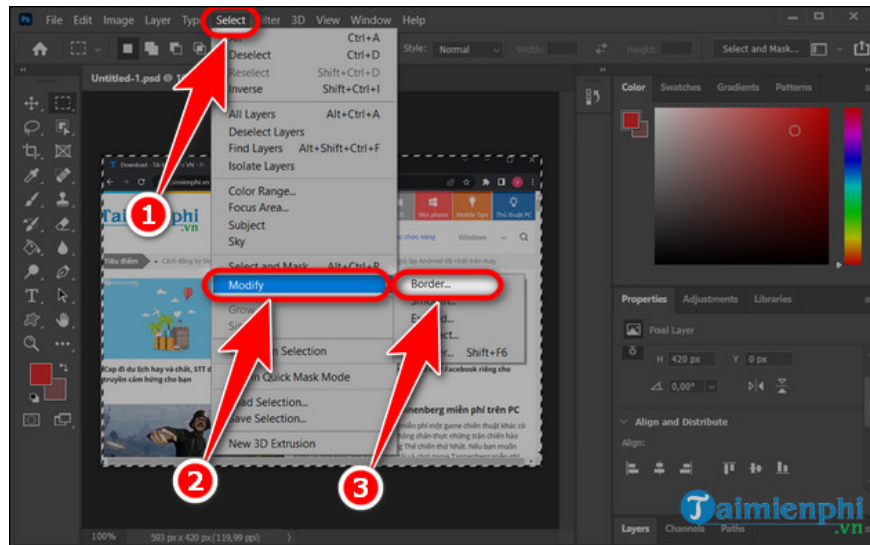

Step 4: Adjust **Pixels** , can default to 1.

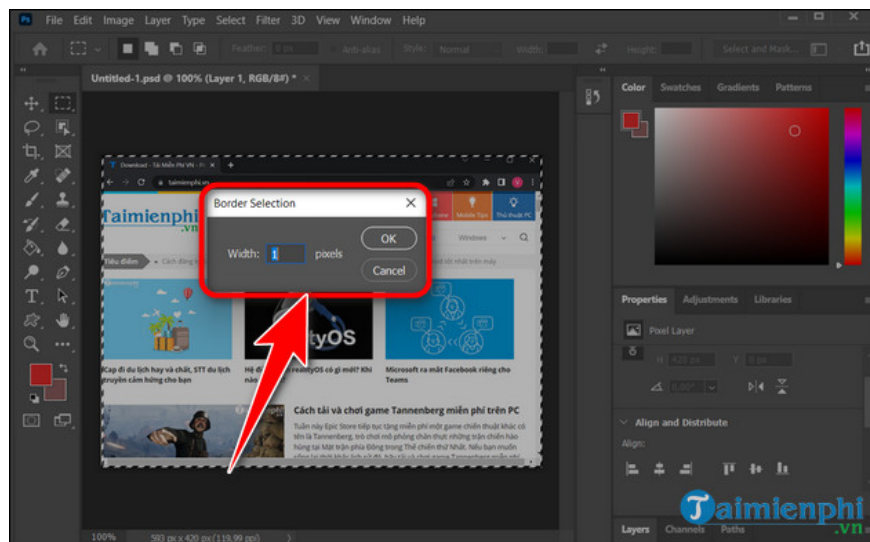

Step 5: Go back to **Select** => **Modify** => **Smooth** to start rounding the selected area.

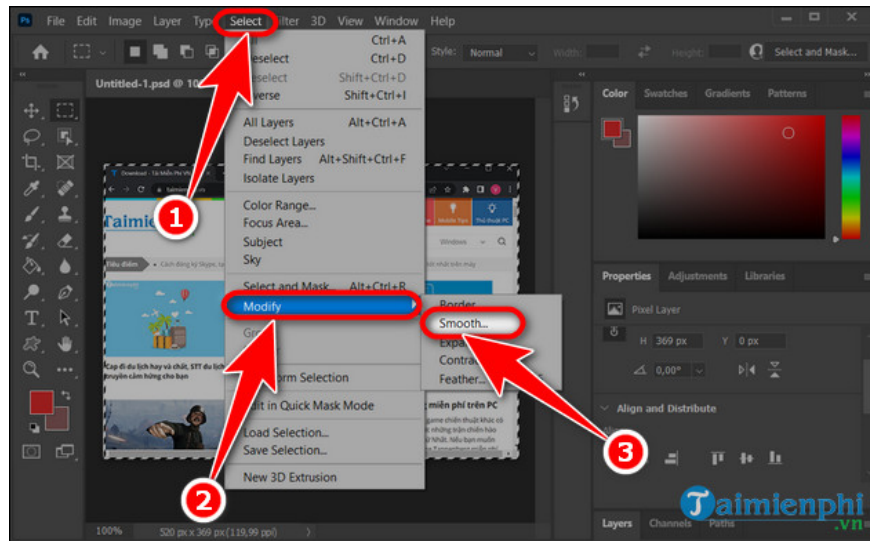

Step 6: Adjust the **Pixels** corresponding to the rounded corners you want and click **OK** .

- **Note:** The larger the pixels, the higher the rounded corners, you should adjust accordingly to have a beautiful photo.

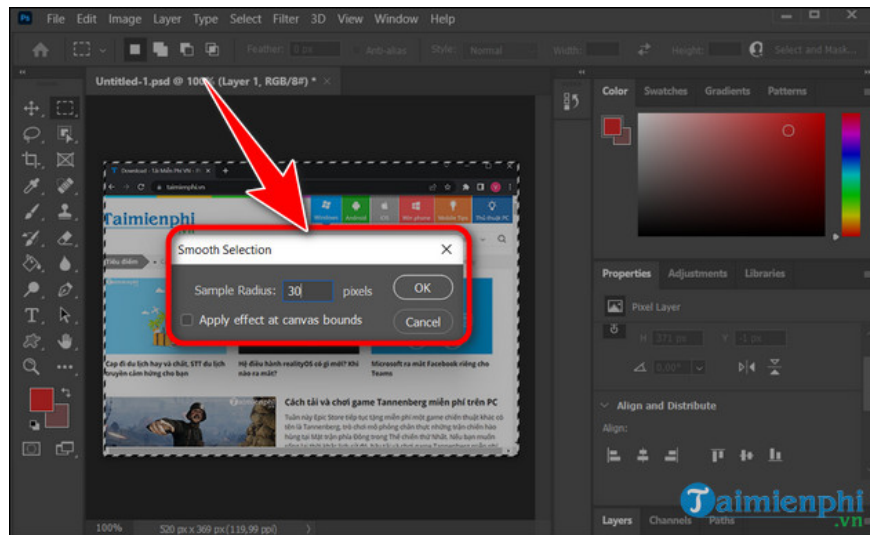

Step 7: Press the **Delete** key to delete the excess outside the rounded corner. You will get the following result.

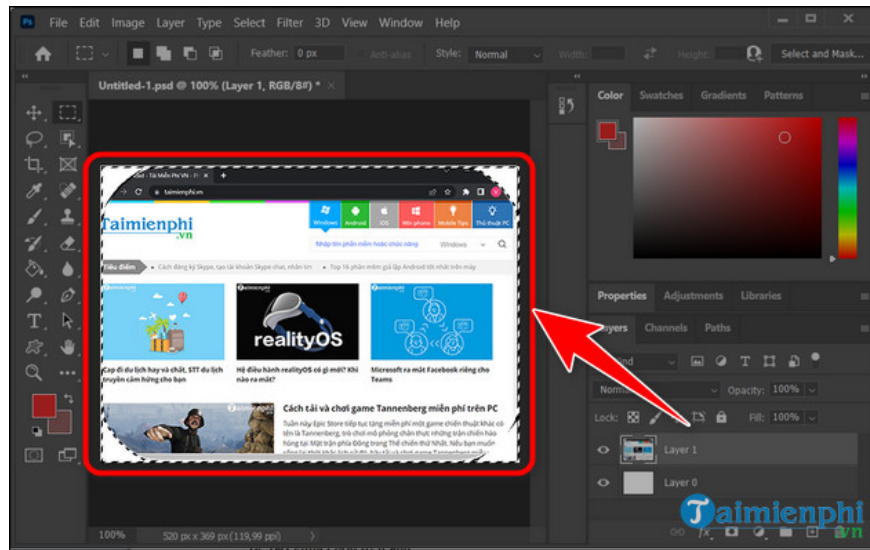

II. How to create rounded image areas in Photoshop

Step 1: Open the image in **Photoshop** .

Step 2: Click on the **Rectangular Marquee Tool** (shortcut key M), then use the mouse to create a selection on the image.

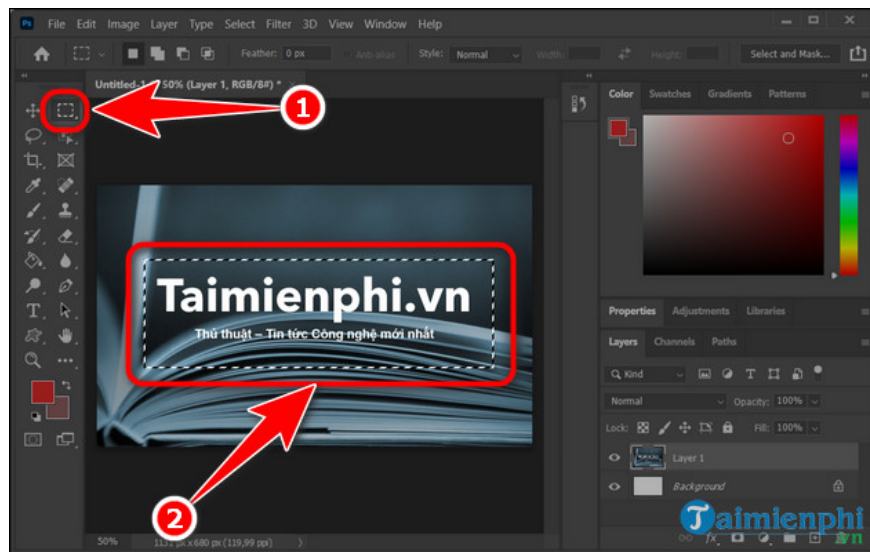

Step 3: Go to **Select => Modify => Smooth** . .

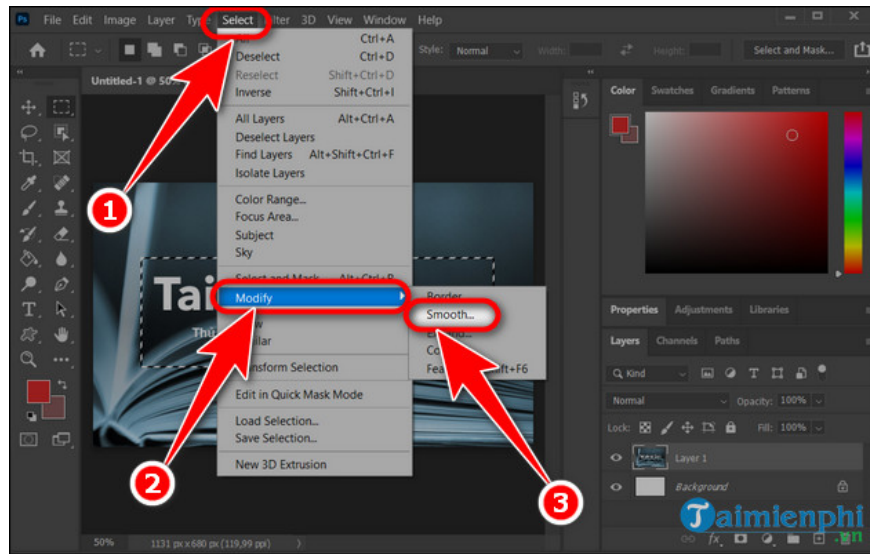

Step 4: Adjust **Pixels** => **OK** .

- Note: The higher the pixels, the larger the rounded corners.

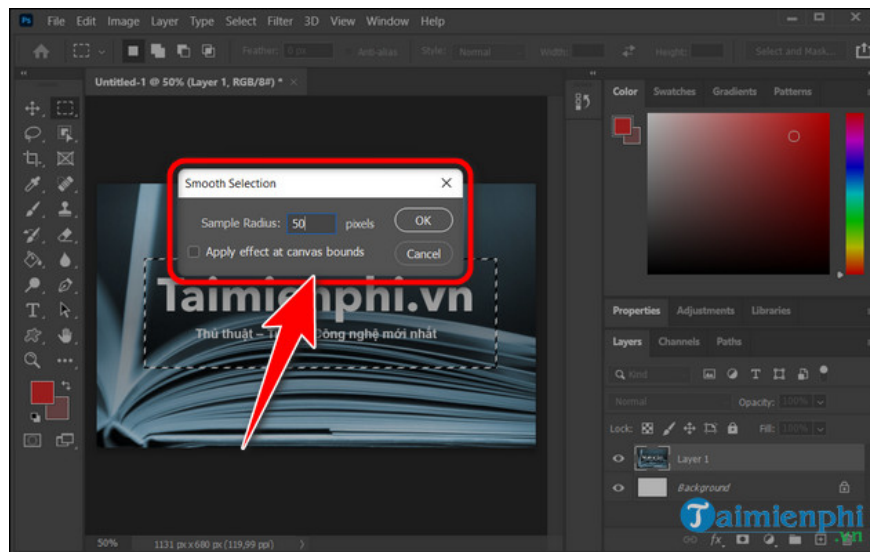

Step 5: Press the key combination **Ctrl + Shift + I** to select the entire image .

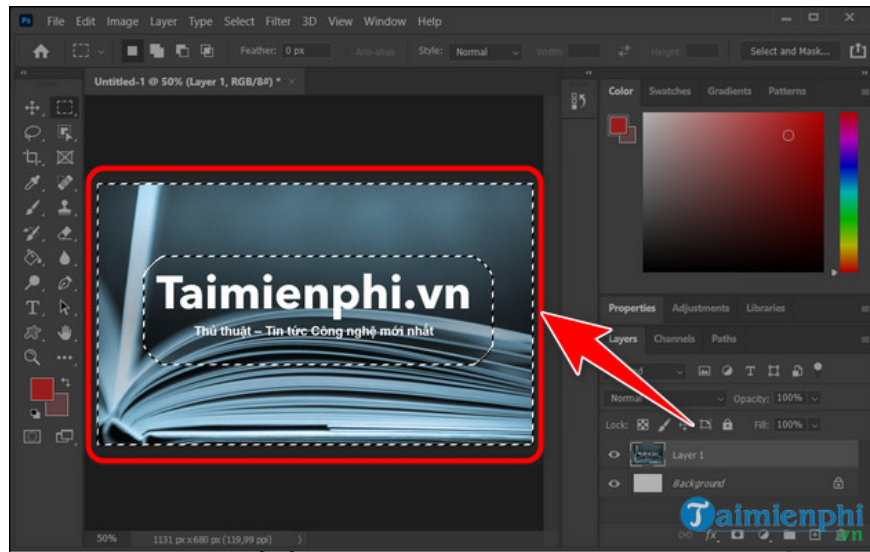

Step 6: Press **Delete** on the keyboard and select the **Paint Bucket Tool** (Shortcut G) and fill the outside with color to highlight the rounded part.

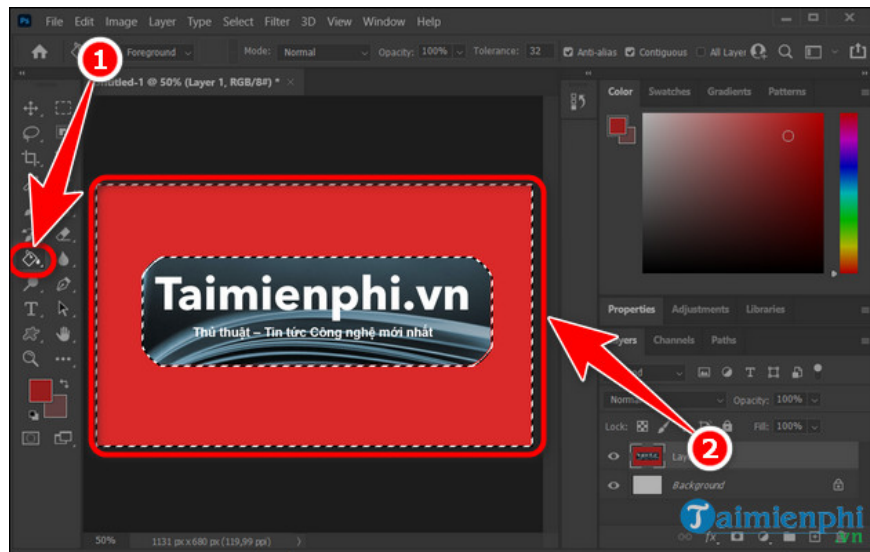

Once completed, the corner area of your door will be rounded as shown in the following image:

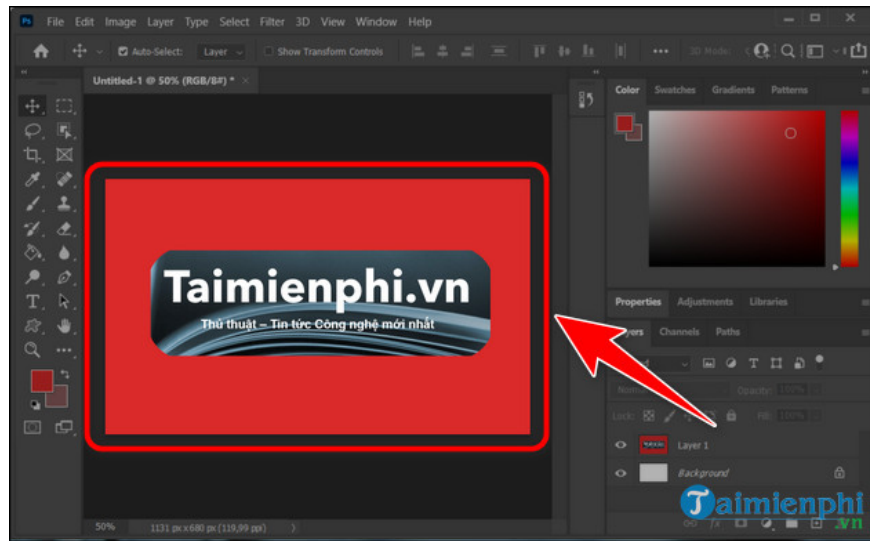

Rounding will make your round area less rough, you can flexibly change the pixel density accordingly for more flexibility during use. Also, if you want to **insert Symbols in Photoshop**, please refer here.

You finished reading the article "**How to round the corners of a selection in Photoshop is simple and easy**" edited by the [TipsMake](#) team. We hope this article has provided you with many useful tech tips and tricks. You can search for similar articles on tips and guides. Thank you for reading and for following us regularly.