

How to Remove the White Background in Microsoft Paint

This wikiHow teaches you how to make a white background transparent using Microsoft Paint. If you're using Windows 10, your computer comes with an updated version of MS Paint (called Paint 3D) that allows you to remove backgrounds with...

Method 1 of 2:

Using Paint 3D

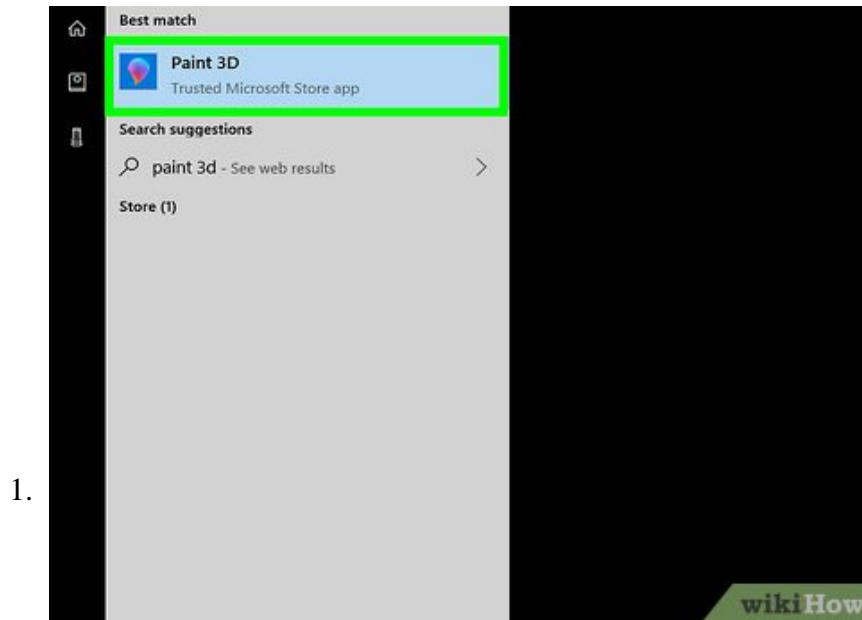

Open Paint 3D. Windows 10 comes with an updated version of MS Paint called MS Paint 3D. You'll find it in the Start menu, or by typing "Paint 3D" into the Windows search bar.

1. You can use this method with any solid-color background.

2.

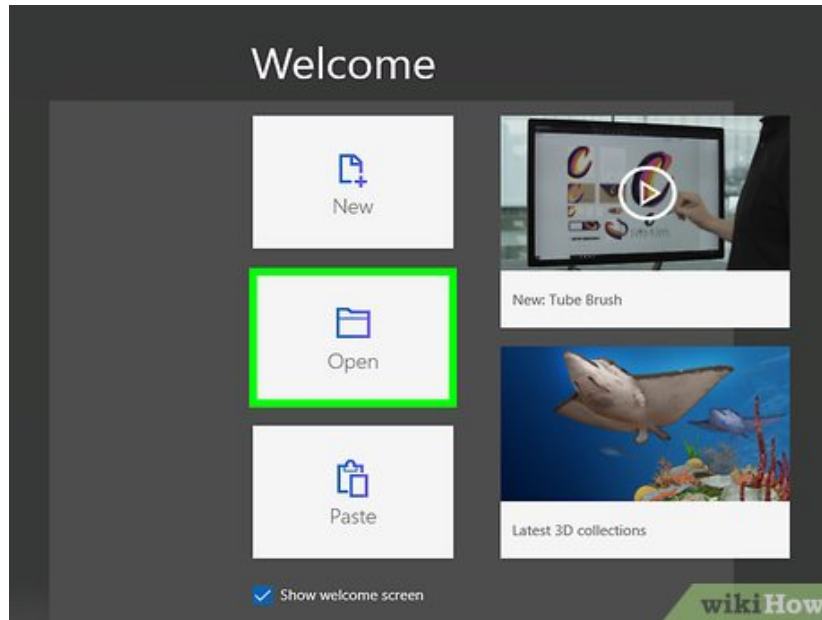

Click **Open**. It's the second box on the left side of the Welcome screen.

3.

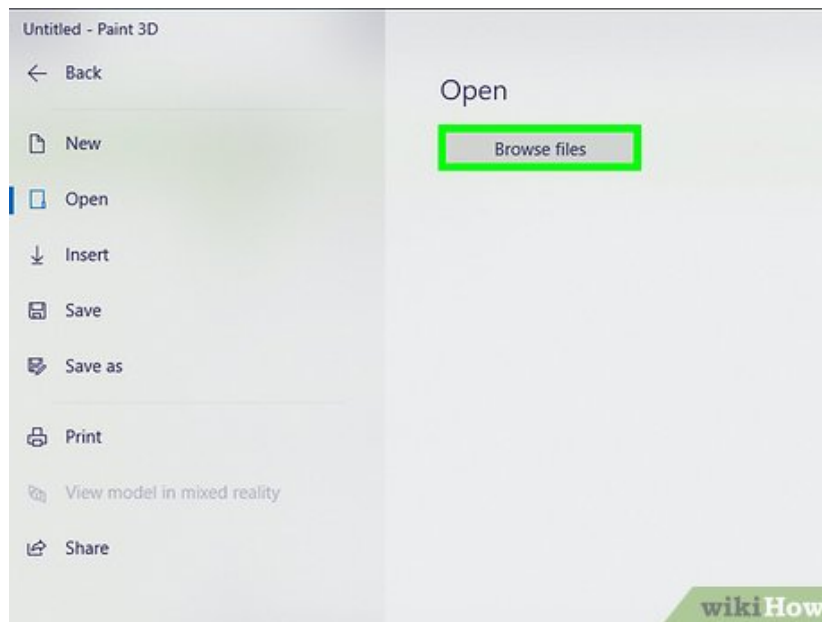

Click **Browse files**. It's at the top of the right panel.

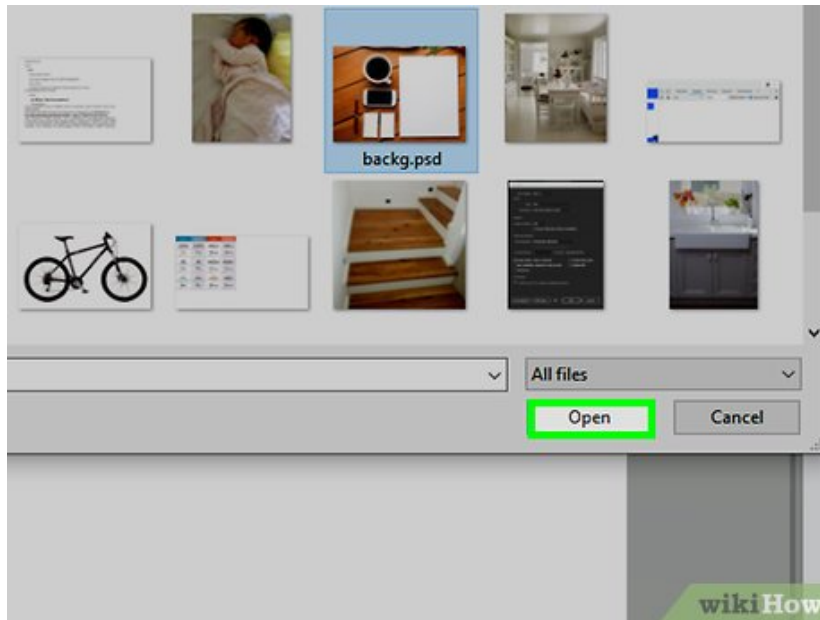

4.

Select your file and click **Open**. This opens your image for editing.

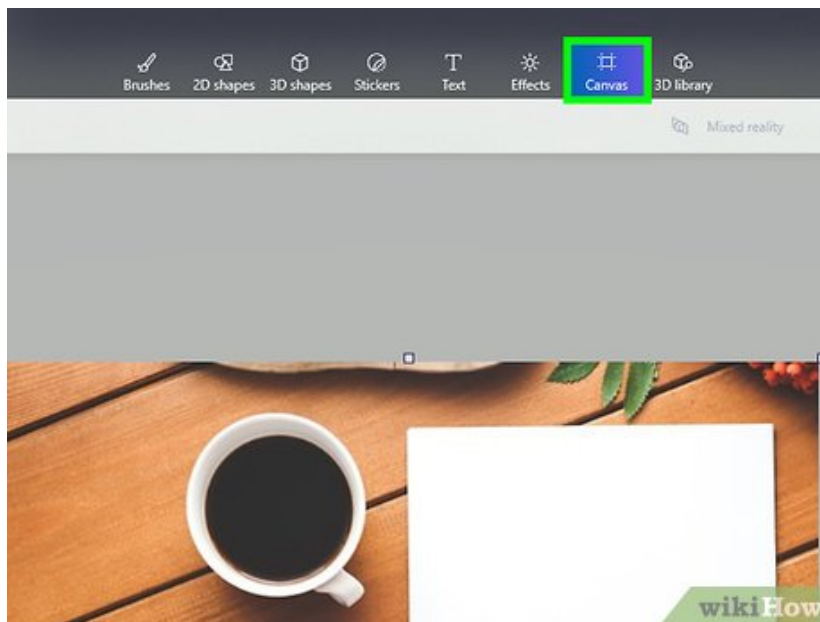

5.

Click the **Canvas** tab. It's the hash/pound icon in the toolbar that runs along the top of the app.

6.

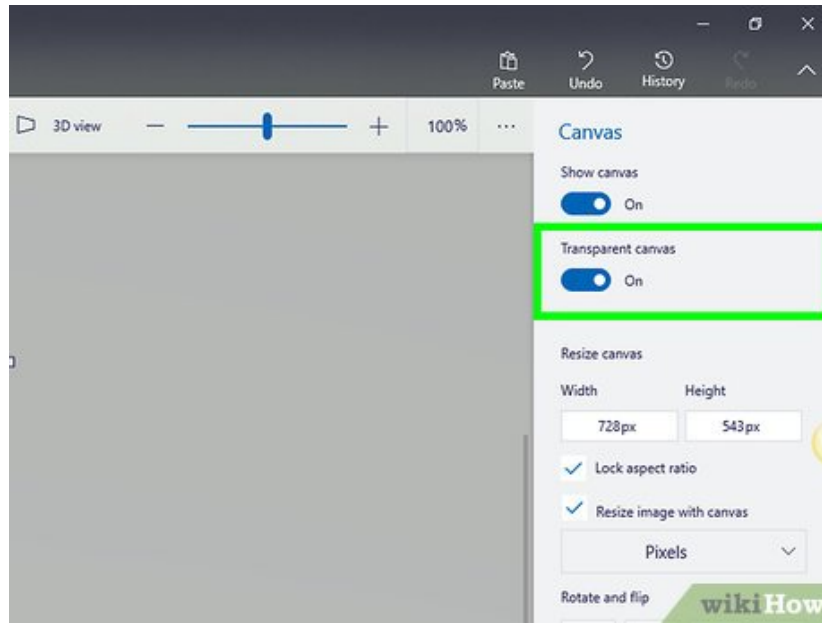

Slide the "Transparent canvas" switch On



. It's in the right panel under "Canvas." This turns off the background color, though you won't notice quite yet.

7.

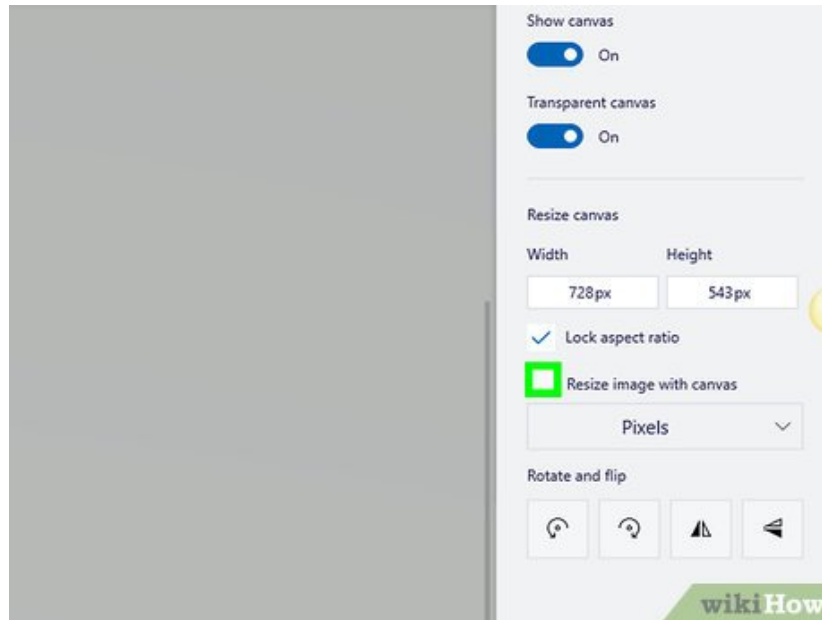

Remove the check mark from "Resize image with canvas." It's near the middle of the right panel.

8.



Drag the canvas edges so the image fits inside. You can do this by dragging the small boxes at each corner inward until it's close to the part of the image you want to keep.

9.

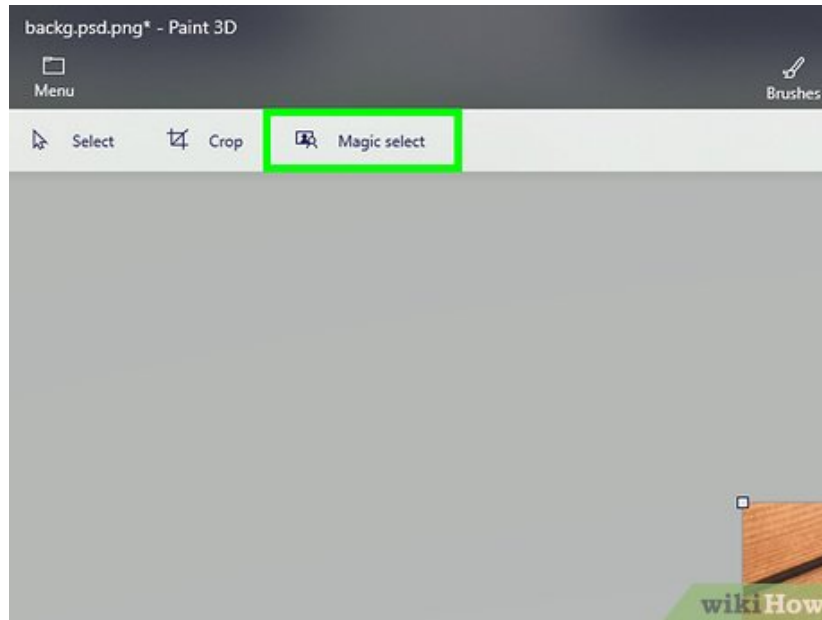

Click **Magic select**. It's on the lighter gray part of the toolbar at the top of the screen, toward the left. Its icon looks like an outline of a person looking into its reflection. The "Magic select" panel will expand on the right.

10.

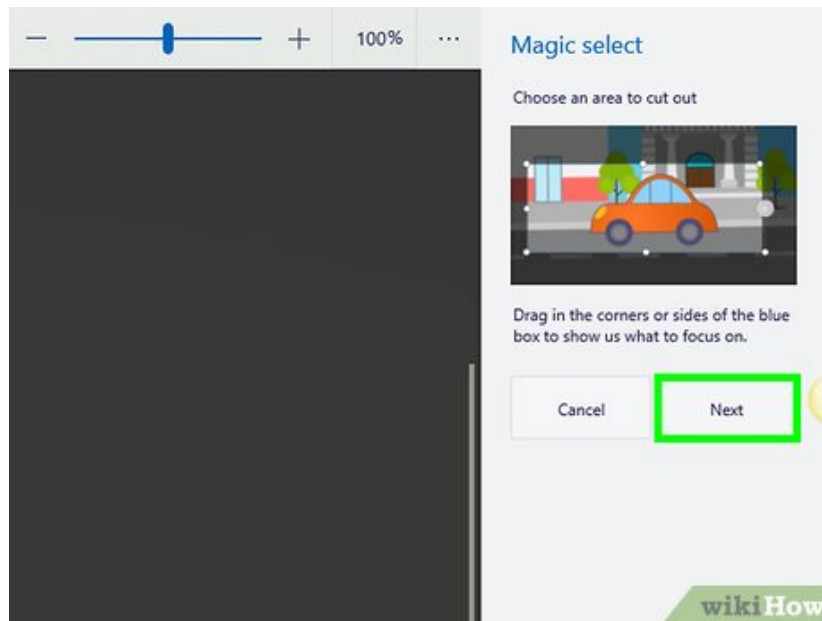

Click **Next**. It's in the right panel.

11.

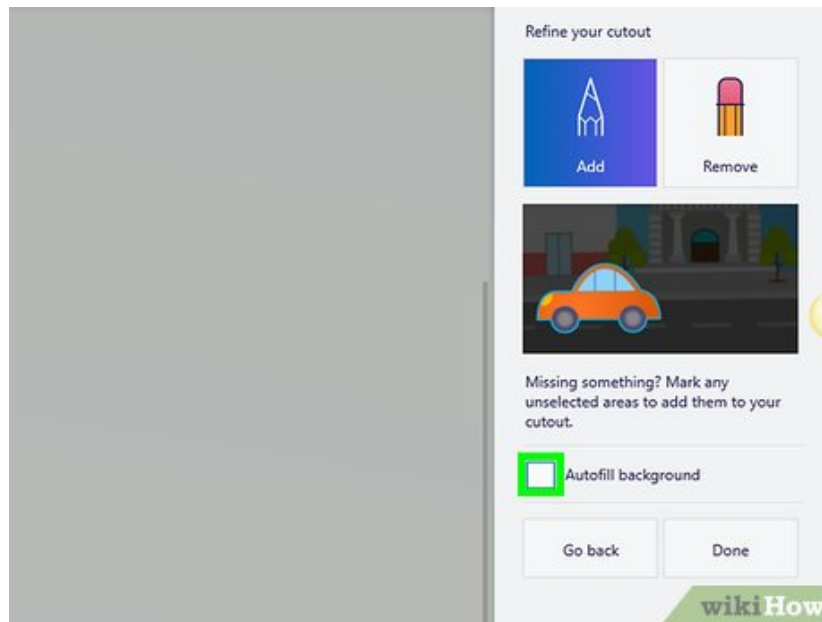

Remove the check mark from "Autofill background." It's in the right panel.

12.

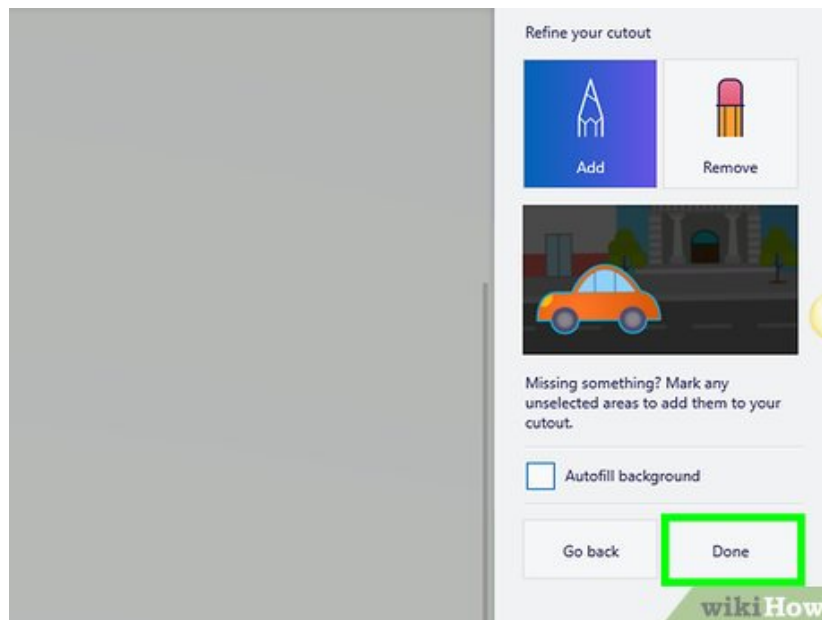

Click . This removes just the selected part of the image from what remains of the background and places it onto a new placeholder background (which is also white).

13.

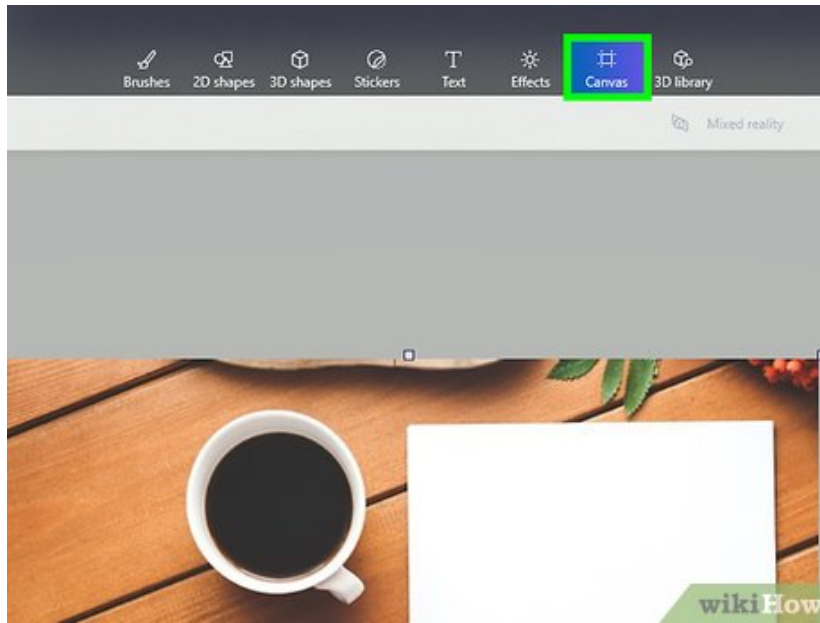

Click the **Canvas** tab again. It's the hash/pound symbol in bar that runs along the top of the app.

14.

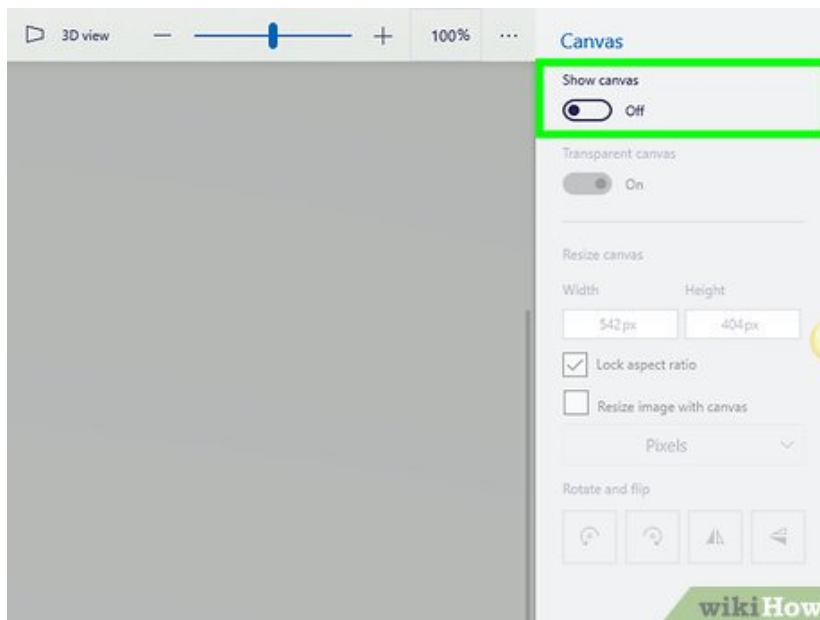

Slide the "Show canvas" switch to Off

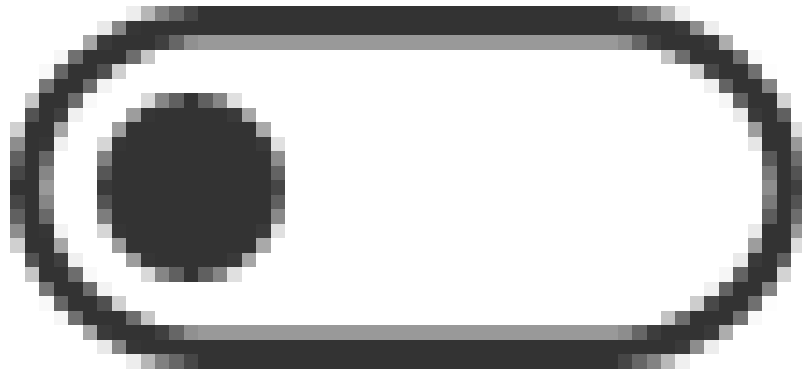

. It's at the top of the right panel. Now you'll just see the selected part of the image on a gray background.

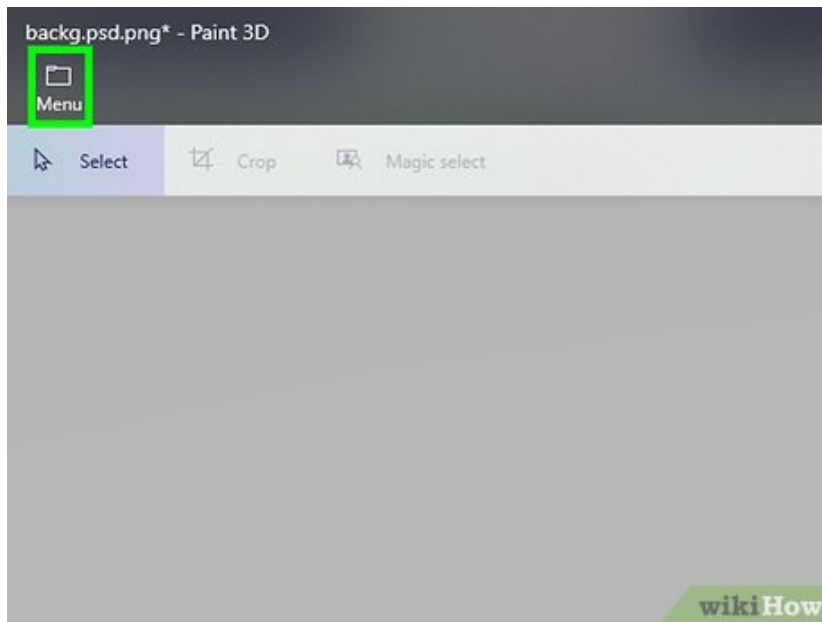

15.

Click the **Menu** button. It's the folder at the top-left corner of Paint 3D.

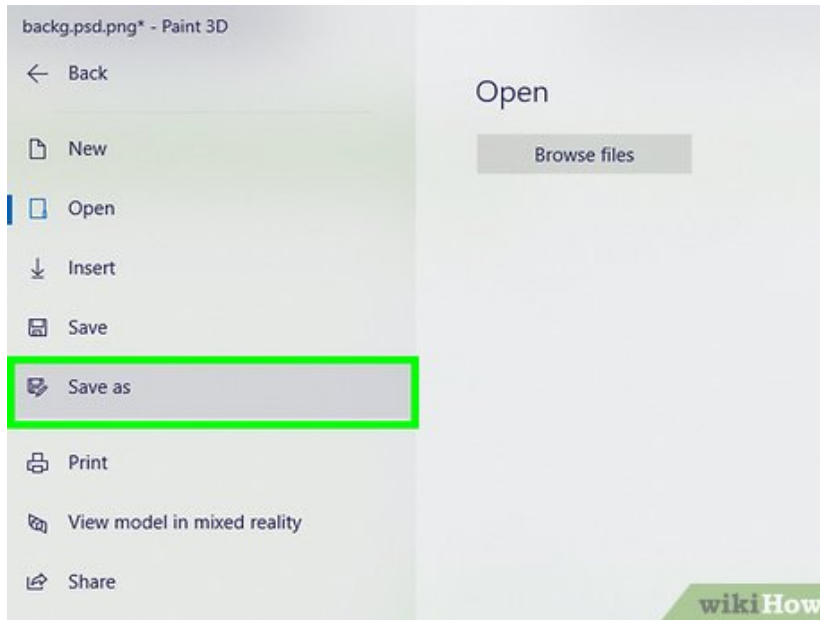

16.

Click **Save As**. It's near the middle of the menu.

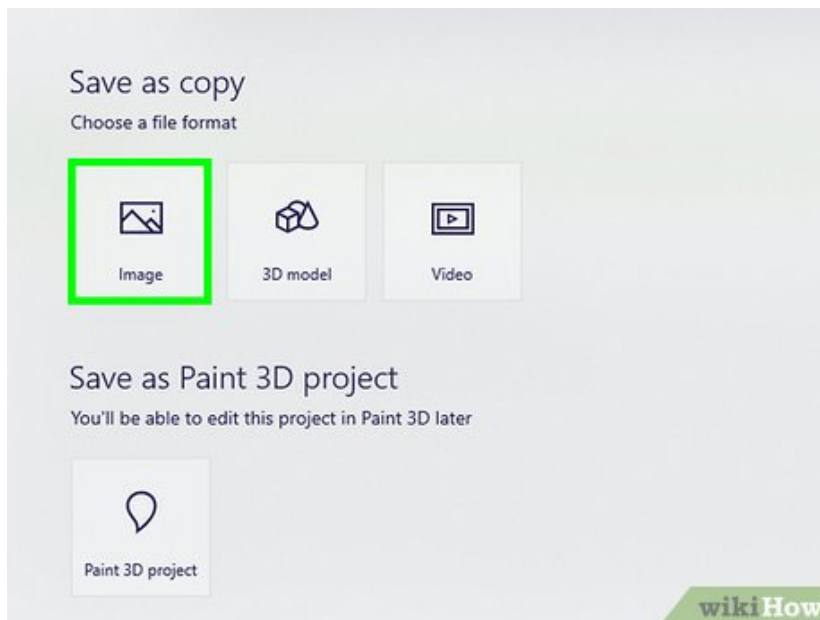

17.

Click **Image**. It's the box that has an icon that resembles a photo of mountains.

18.

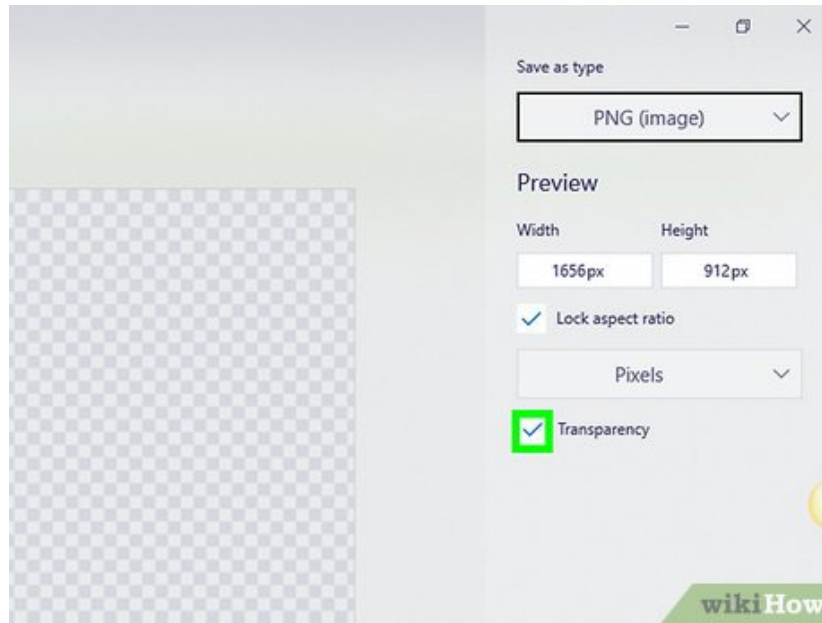

Check the box next to "Transparency." It's in the right panel. The background will appear checkered, which means it's transparent. The checker pattern will not be saved along with your subject.

19.

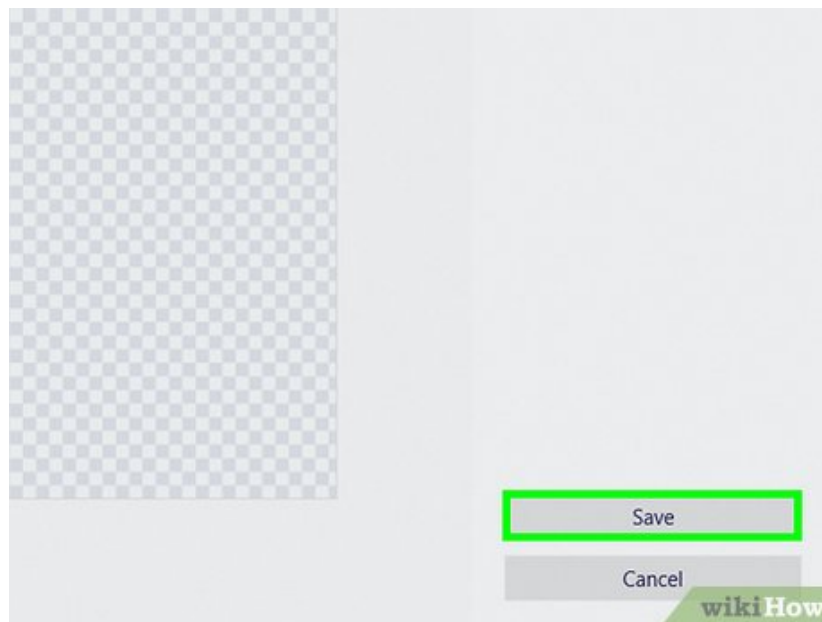

Click **Save**. It's at the bottom-right corner.

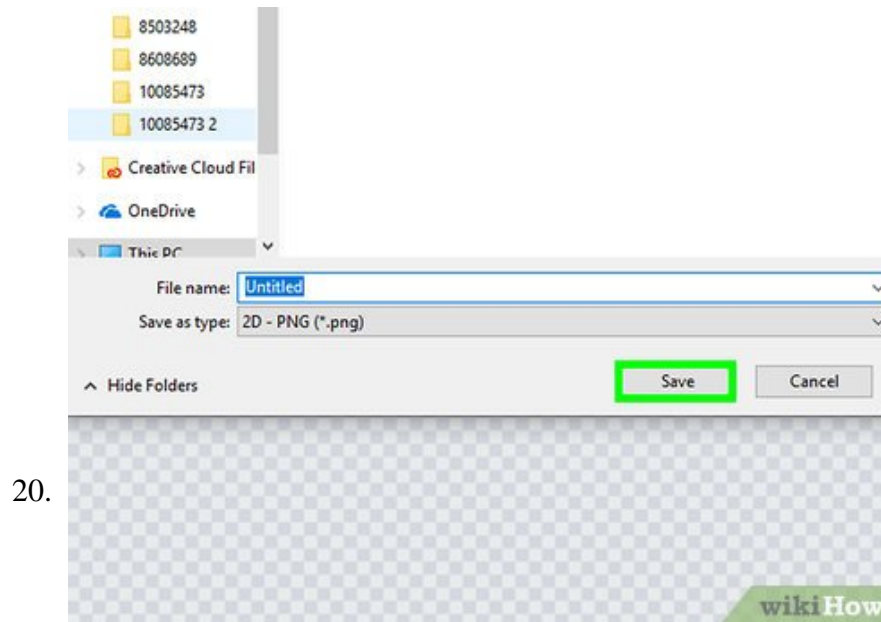

Enter a file name and click **Save**. This saves your image with a completely transparent background.

Method 2 of 2:

Using MS Paint

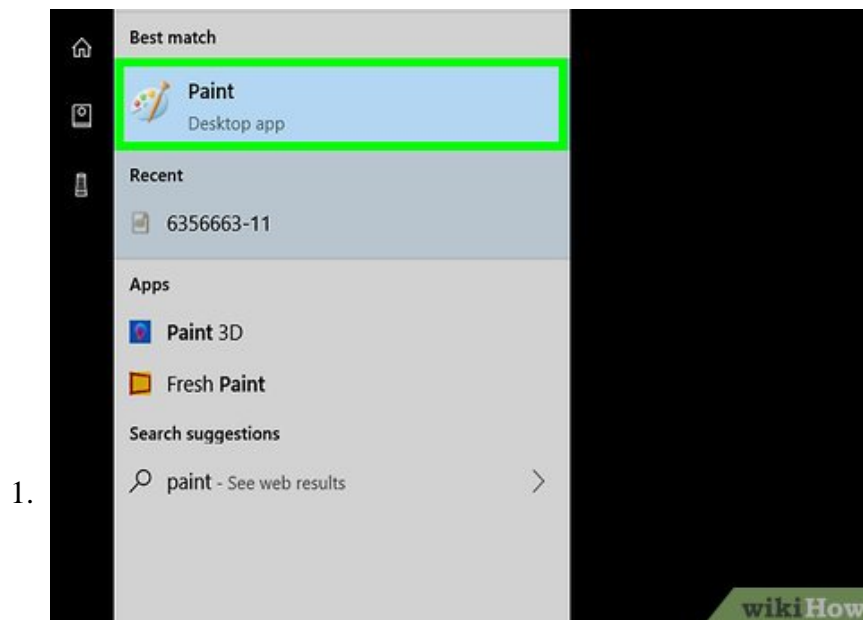

Open Paint. You can do this quickly by typing "paint" into the Windows search bar and clicking **Paint** in the search results.

1. If you have Windows 10, use the "Using Paint 3D" method instead.
2. It's not possible to make the white background transparent in MS Paint. This method will teach you how to cut out the part of the image you want to keep and paste it onto a different background.

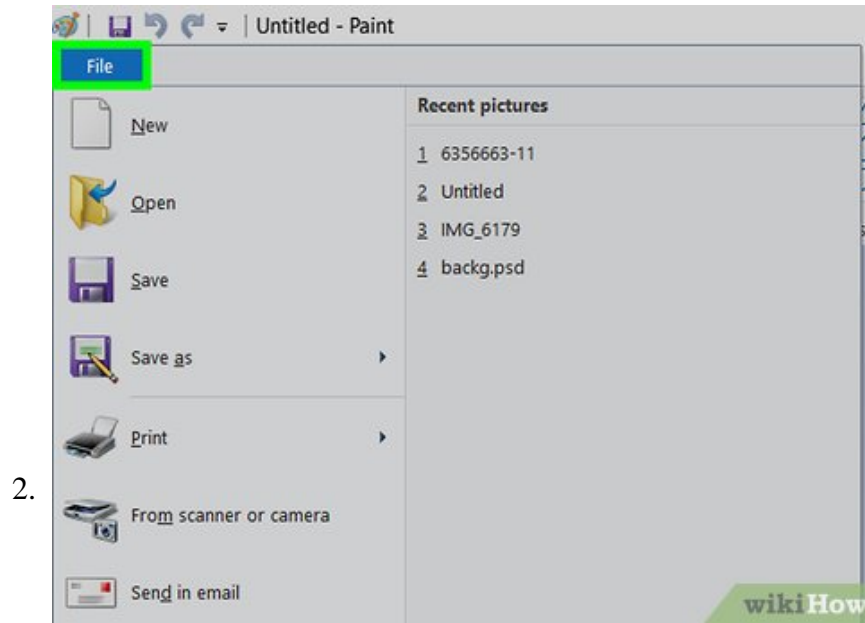

Click the **File** menu. It's at the top-left corner of Paint.

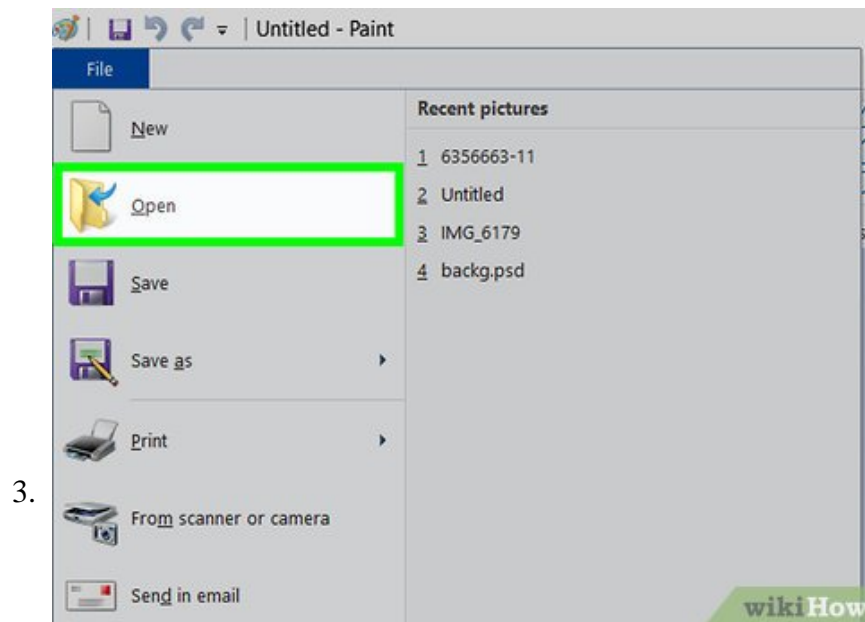

Click **Open**.

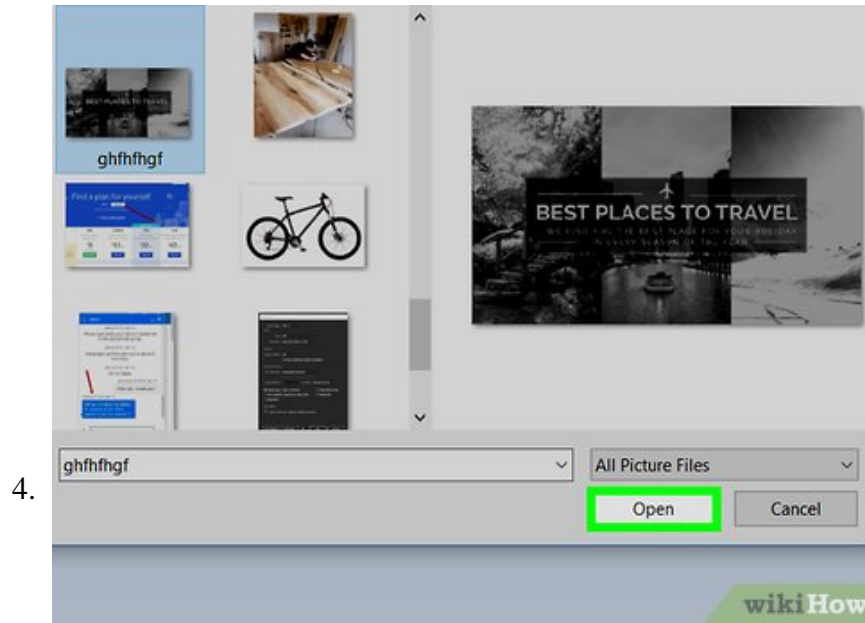

Select an image and click **Open**. Be sure to select the image with a white background.

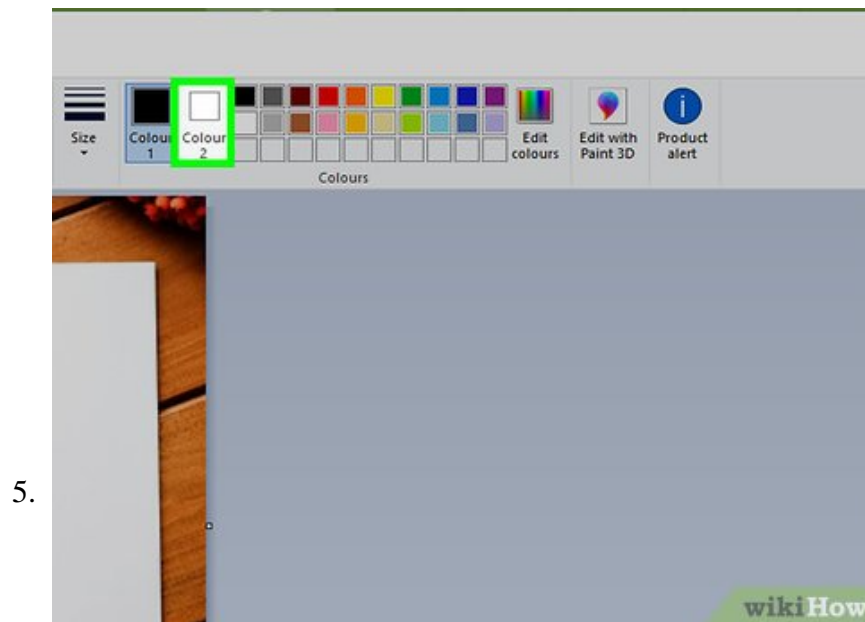

Click **Color 2**. It's in the toolbar at the top of the screen, to the right of the color palette.



Click the eyedropper icon. It's in the toolbar at the top of the screen (in the "Tools" panel).

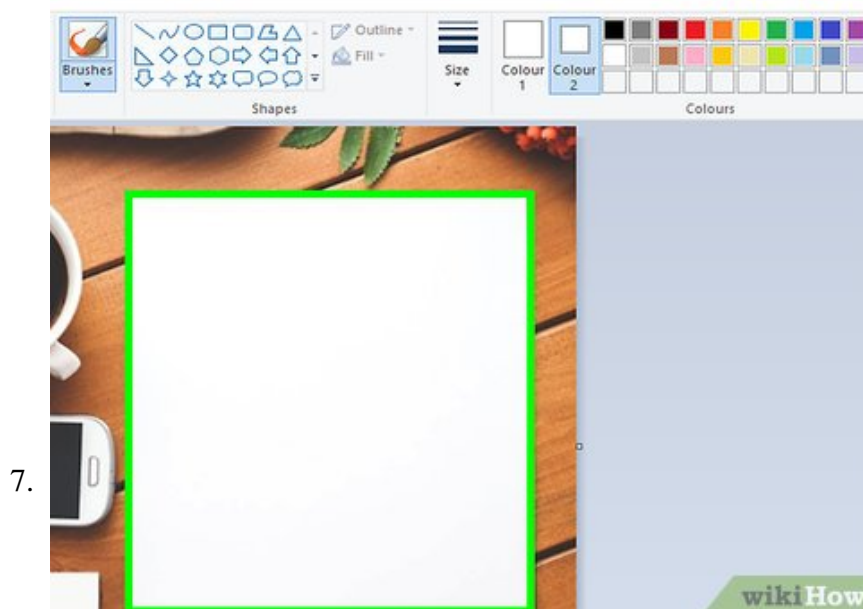

Click a blank area of the white background. The background color will now appear in the "Color 2" box.

1. Even if the color of the box was already white, this is just an extra precaution to take in case image's background has any gray or other tints to it.

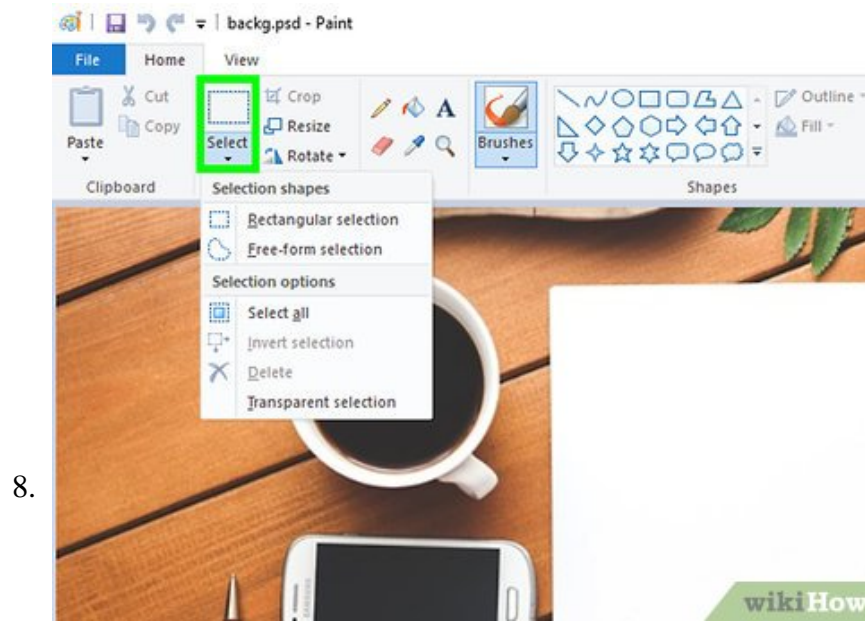

Click the down-arrow

under ?Select.? It's in the toolbar that runs along the top of Paint. This displays a drop-down menu.

9.

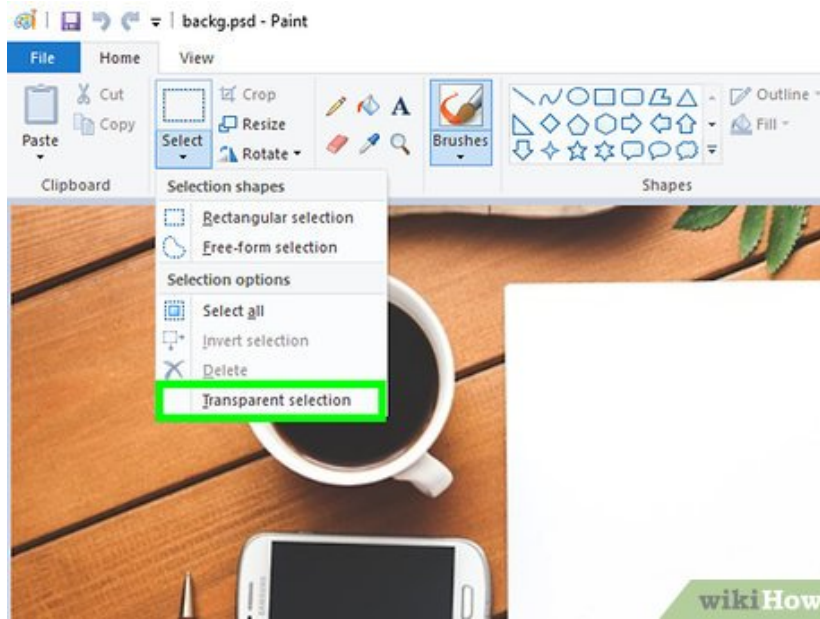

Click **Transparent selection**. It's at the bottom of the menu. A check mark will appear next to the option to show that it's selected. The Transparent Select tool ignores the white background when you copy images in Paint and paste them into another image.

1. The Transparent Select tool ignores the white background when you copy images in Paint and paste them into another image.

10.

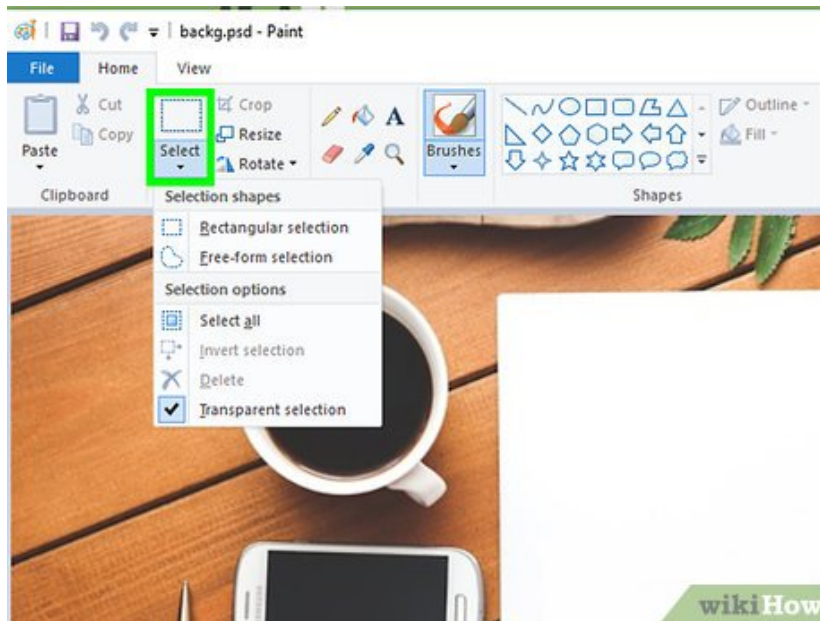

Click the down-arrow

under ?Select? again. This re-opens the menu.

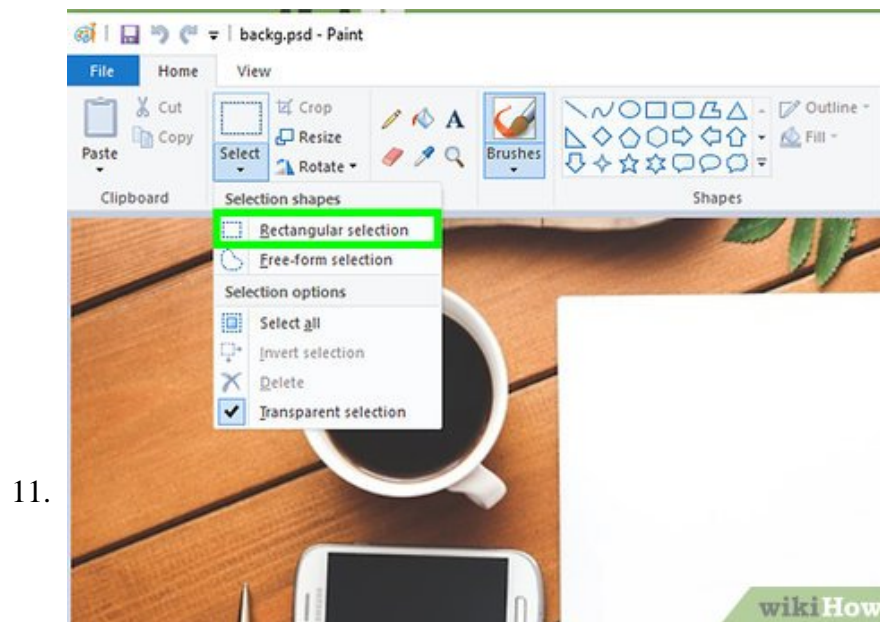

Click **Rectangular selection**. It's at the top of the menu. This tool lets you draw a box around the subject to select it.

12.



Select the part of the image you want to keep. Click and drag the mouse until you've surrounded the entire subject, then lift your finger from the button. A dotted rectangular selection box will appear around the selected area.

1. Everything within your selection that doesn't match the color in "Color 2" will be preserved. If the background isn't completely white (such as if there are shadows or objects in the background you don't want to keep), choose **Freeform selection** instead so you can trace around just the part of the image you want to keep.

13.

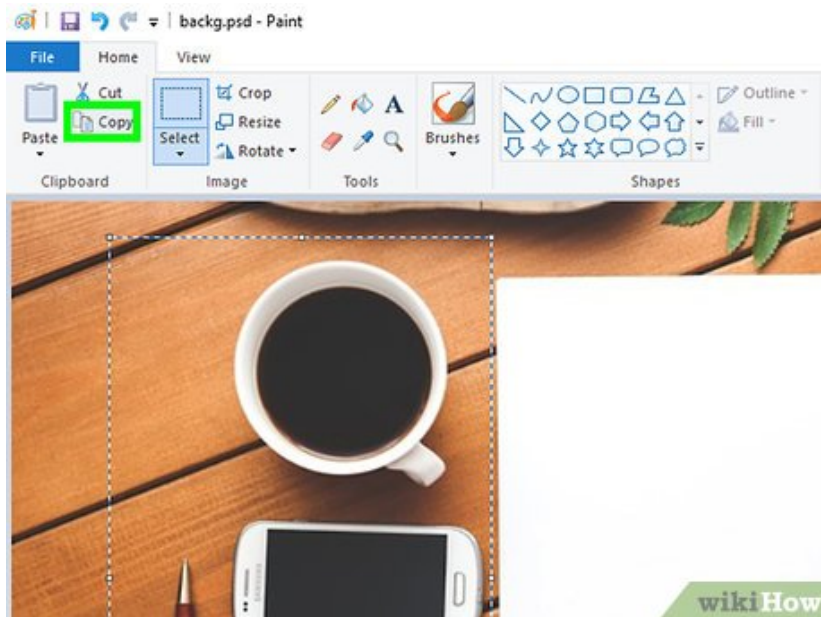

Click **Copy**. It's near the top-left corner of Paint in the "Clipboard" panel. This copies your selection.

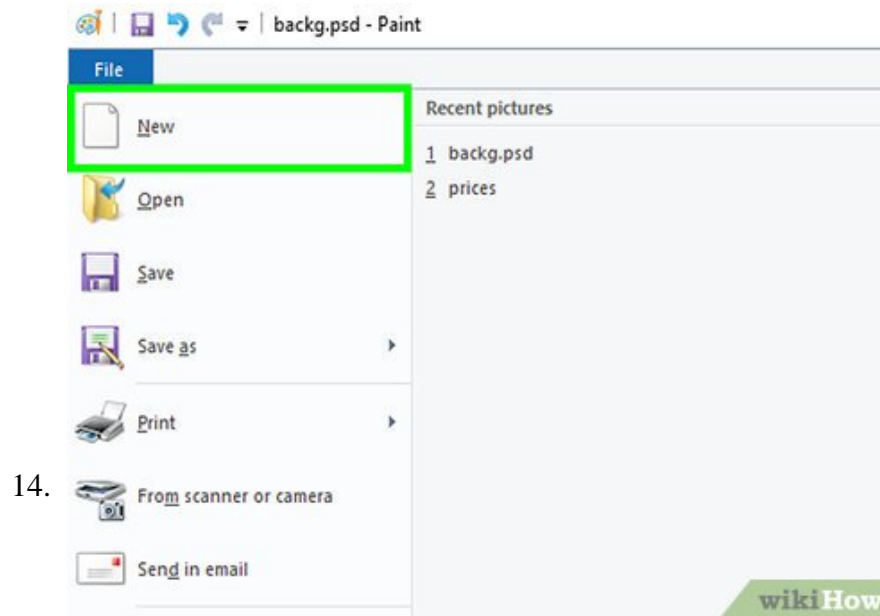

Create or open a new file. Now that your selection is copied, you can open the image you want to paste it on. You'll be prompted to save or discard the changes to the image you're working on before the new one will open.

1. Click **File** in the upper-right corner.
2. Click **New** to create a new file, or click **Open** to open a different image.

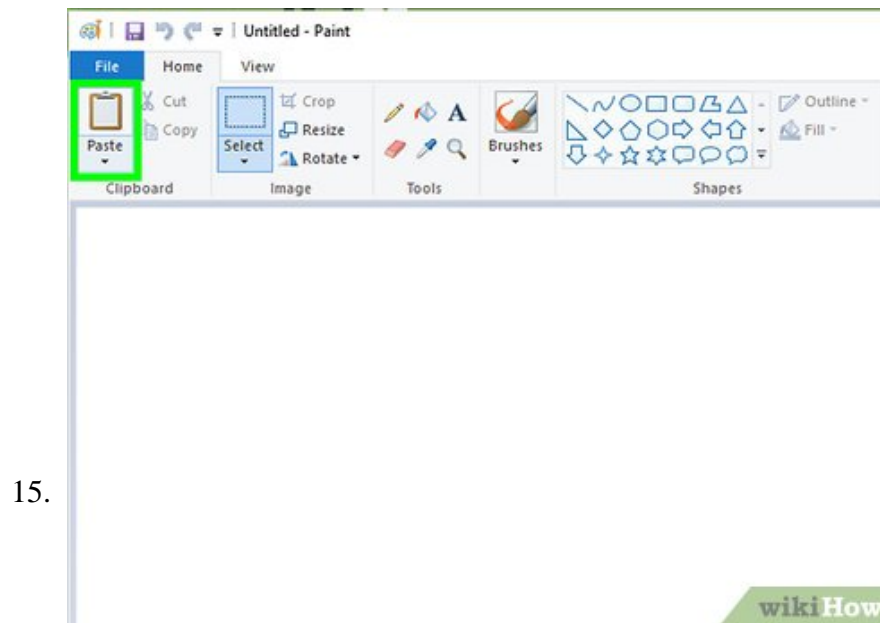

Click **Paste**. It's near the top-left corner of Paint. This pastes the selected part of the previous image onto the new image.

1. Click and drag the pasted selection to move it.
2. There may still be some white around the edges of the image you pasted. Keep reading to learn how to fix this.

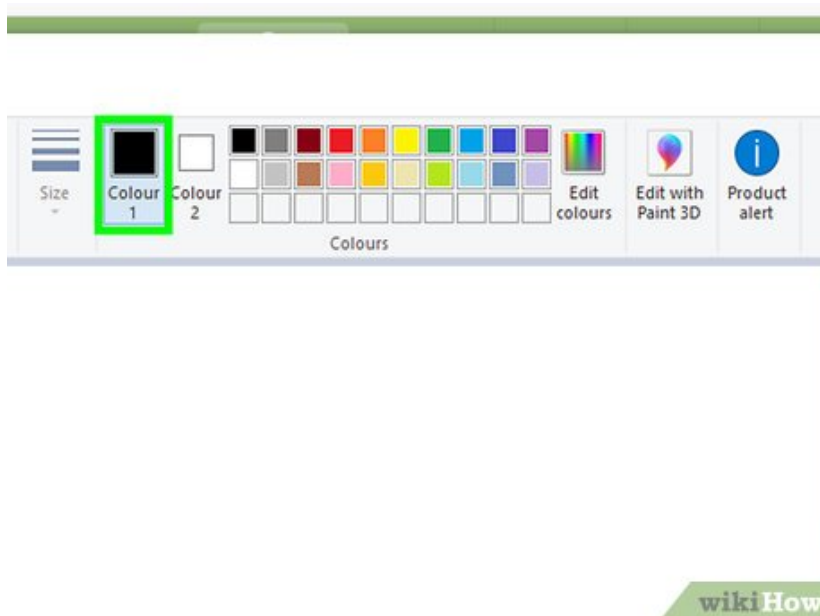

16.

Click **Color 1**. It's next to the palette at the top of the screen.



17.

Click the eyedropper tool in the toolbar.

18.



Click the background next to the white edges. If there is any white around the edges of the image you pasted, click the background right next to the white edge to select the color directly behind the white edge. This will allow you to paint the white areas to match the selected color.

19.

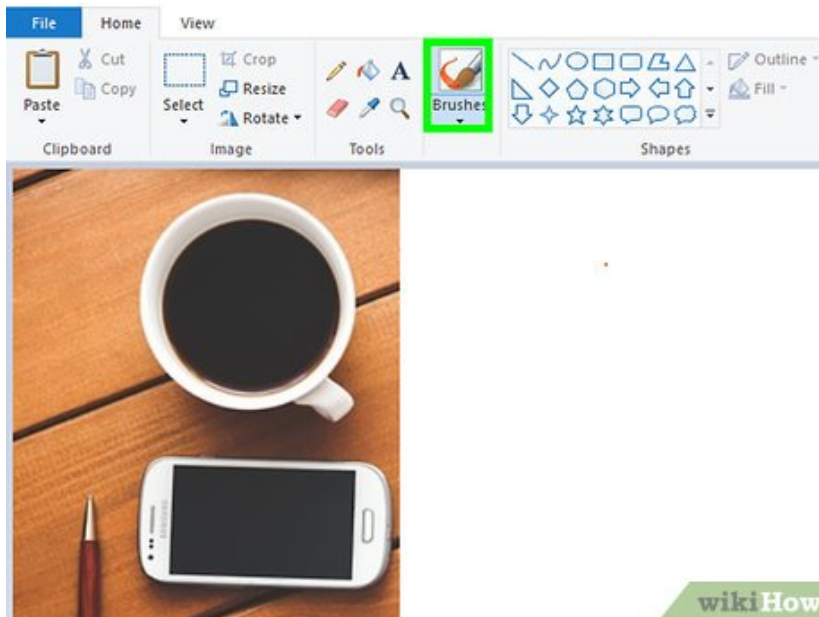

Click the paintbrush tool. It's the paintbrush icon to the right of the "Tools" panel at the top of Paint.

1. You can click the arrow pointing down below the brush to select different brush types.

20.



Paint over the white edges. Use the brush tool to color over any white edges that may remain around the object you pasted.

1. Zoom in and try not to color within the image.
2. If the background is not a solid color, you may need to use the eyedropper tool more than once.
3. Click the drop-down menu below **Size** to change brush sizes. Use a larger brush size to color over the bulk of the remaining white edge, then zoom in and switch to a smaller brush for precision.
4. Look for any white parts of the image that the Transparent Select tool didn't copy. Use the brush tool to color them back in.
5. If you accidentally color over a part of the image you don't want to, press **Ctrl + Z** to undo the mark.

You finished reading the article "**How to Remove the White Background in Microsoft Paint**" edited by the [TipsMake](#) team. We hope this article has provided you with many useful tech tips and tricks. You can search for similar articles on tips and guides. Thank you for reading and for following us regularly.