

How to play Sky: Children of the Light with friends

Guide to play Sky: Children of the Light with friends, Guide to play Sky: Children of the Light with friends to have great relaxing moments

Sky: Children of the Light (SCOTL) is a critically acclaimed indie game. This is a social game so players can explore the game world with their friends.

Entering the Sky wonderland, gamers will be immersed in a beautiful kingdom with lots to explore and countless adorable characters ready to interact. What could be better than having a great experience with your friends while adventuring and solving the mysteries of SCOTL.

In this article, let's learn how to play Sky: Children of the Light with friends for great relaxing moments in beautiful graphics.

Make sure to make friends with each other

The first step to playing Sky: Children of the Light with your friends is to add them as friends on Switch.

If they're playing on Switch, make sure they're friends on a Nintendo account. If they're playing on mobile, move on to the next step.

SCOTL has a cross-play feature so gamers can play on Switch or mobile devices comfortably. Players of all devices can participate in co-op play together.

Guide to add friends

People can add someone as a friend in Sky: Children of the Light once they've added that person to their Nintendo account's friends list.

To do this, open the pause menu by pressing the Plus button on the JoyCon or Pro controller. Navigate to Invite and everyone will be taken to a menu asking to invite a Nintendo or mobile friend.



Click any of the appropriate options, and as long as the person has played Sky: Children of the Light, they can be added as a friend by submitting a friend request.

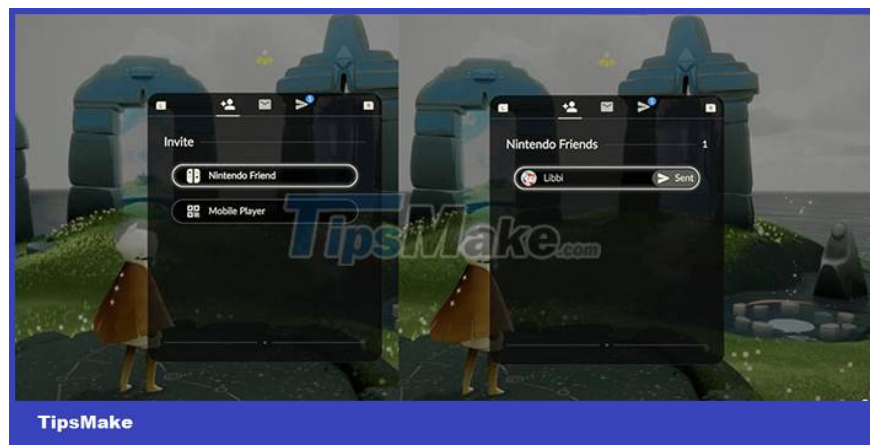

If that person doesn't play Sky: Children of the Light, people won't be able to see them. If that friend plays on mobile, look up their nickname.

How to play Sky: Children of the Light with friends

Now comes the most complicated part of this whole process: actually playing SCOTL together. This section will be divided into smaller steps for players to follow.

Restart Sky: Children of the Light

If the player and friend have just added each other, everyone may have to restart the game in case the 2 players don't show up together.

Go to Home Island and stand on Stone Circle

On your Home Island, stand on the floor-mounted Stone Circle, which will be directly across from the archway. Press the Y button on it to bring up the constellation menu. From here, the player will have to search through the constellations using the L and R buttons until their friend's name appears.



Start playing with friends

Once you see your friend's name, click it and they'll appear in front of your character. However, this is not the true embodiment of that friend.

Tap them and move the pointer up until you're on an icon that looks like a person standing next to a dotted line leading to a triangle (it looks like someone is flying a kite at a glance).



This is the Join Friend button and when you press it, everyone's character will be switched to your friend's location. Now everyone can play games together, complete puzzles, release souls and grow their wings.

You finished reading the article "**How to play Sky: Children of the Light with friends**" edited by the [TipsMake](#) team. We hope this article has provided you with many useful tech tips and tricks. You can search for similar articles on tips and guides. Thank you for reading and for following us regularly.