

How to make a photo frame in Photoshop

If you own Photoshop software on your computer, then you can make your portrait photos more unique and fancy by framing. If you do not know how to create a photo frame in Photoshop, please refer to the following article.

If you own Photoshop software on your computer, then you can make your portrait photos more unique and fancy by framing. If you do not know how to create a photo frame in Photoshop, please refer to the following article.

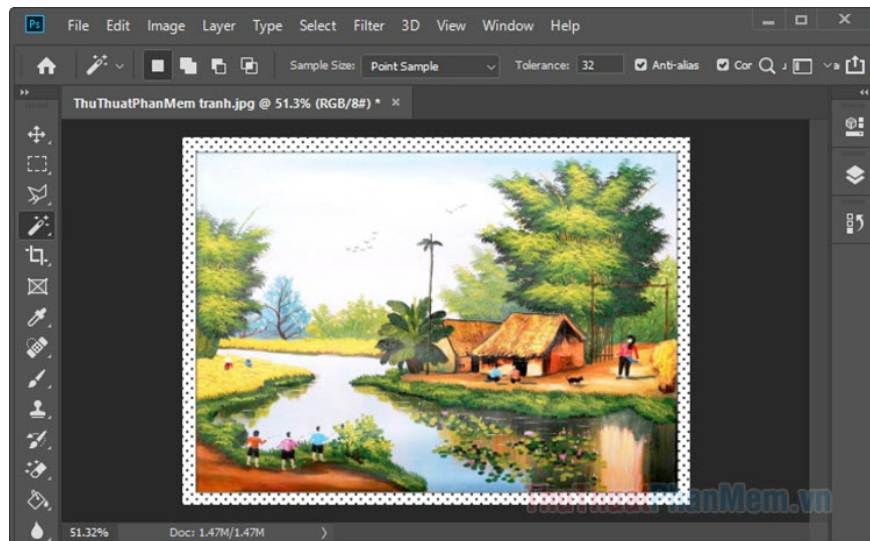

1. Create a photo frame in Photoshop simply with the Stroke tool

Step 1: Open the image you need to frame with Photoshop. Next, select the **Marquee Tool** (1) and select the entire image by clicking and delineating the image or pressing **Ctrl + A** (2).



Step 2: Right-click on the middle of the working screen of Photoshop and select **Stroke** .

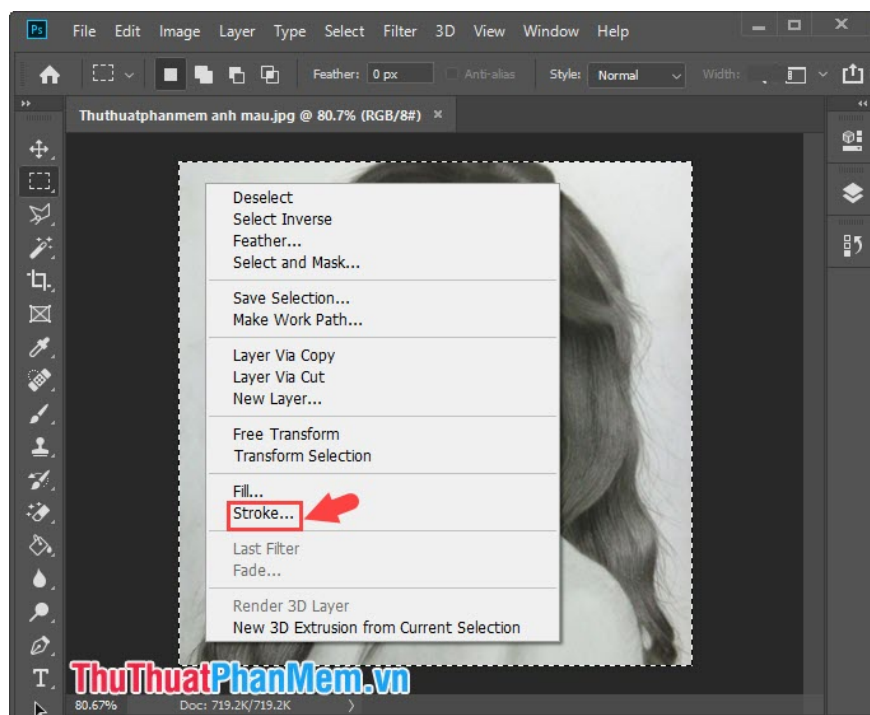

Step 3: Choose the frame thickness in **Width (1)** , you should choose a minimum thickness of 10 pixels to make the picture more prominent. For **Color (2)** , choose your preferred color. Next, check the **Center** option **(3)** and click **OK (4)** to finish.

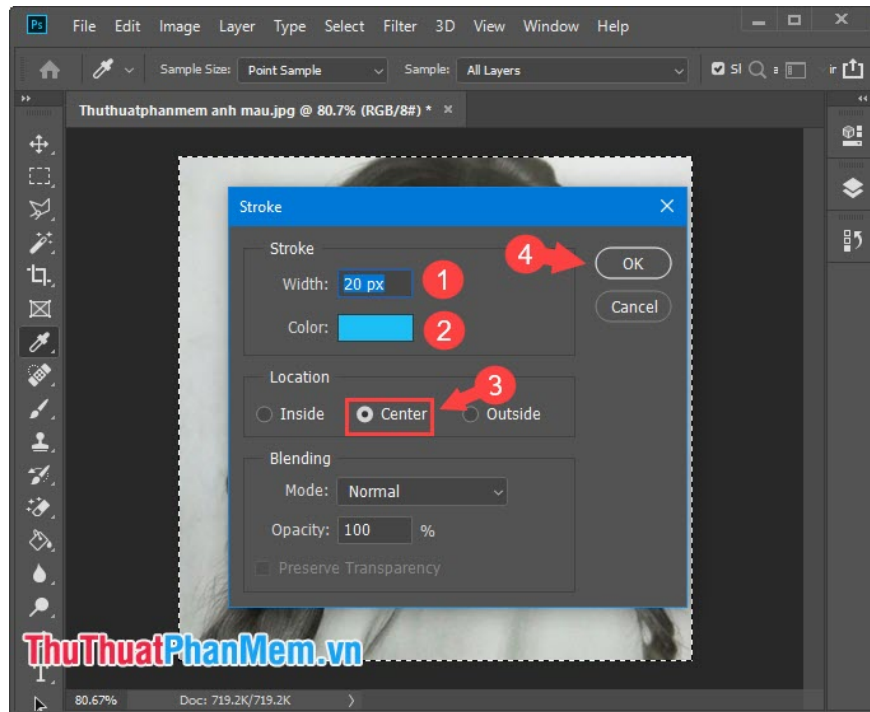

Step 4: So we have framed the photo. Please save the image as is.

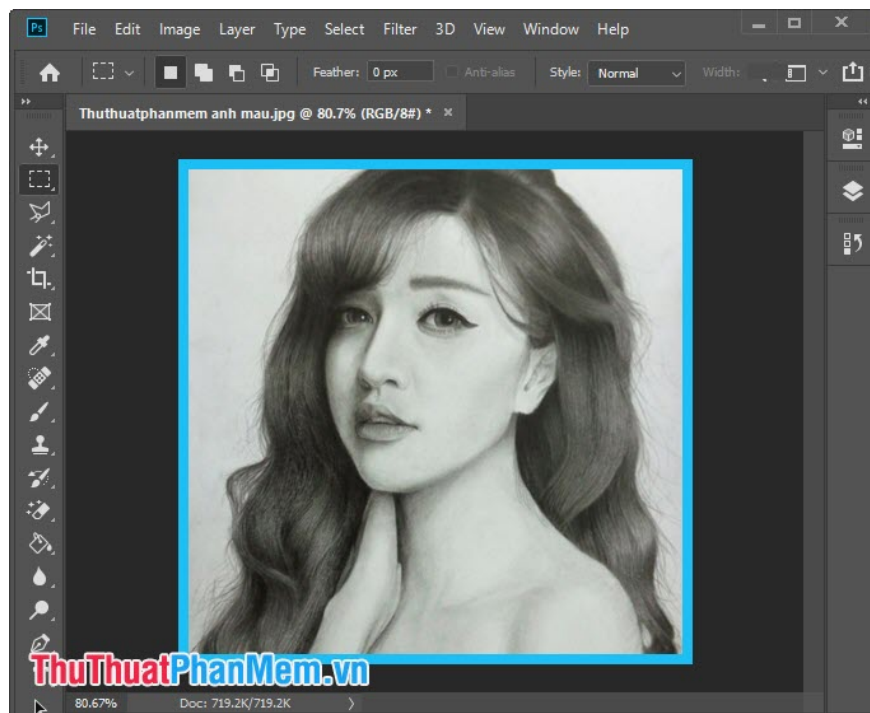

2. Create a photo frame with a pattern using the Fill tool in Photoshop

Step 1: You create a small border around the image. Choose the **Marquee Tool** (shortcut **M**) and localize the entire image or use **Ctrl + A** to quickly highlight. Next, right-click on the working screen of Photoshop and select **Stroke**.

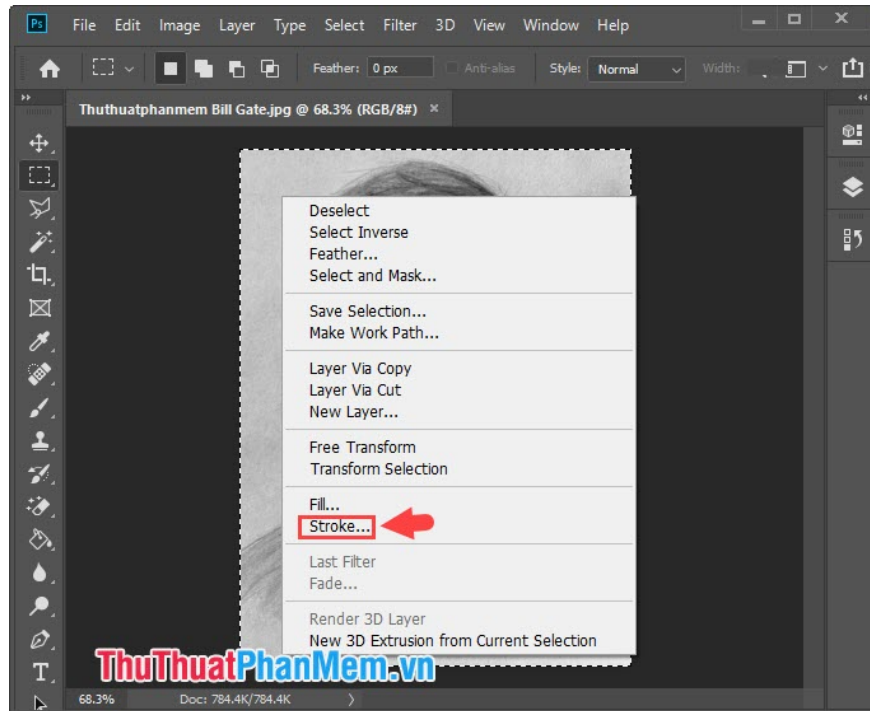

Step 2: You set the **Width (1)** at 1-2 pixels. **Color (2)** you can choose any color you like but you should choose a dark color like black is suitable. For **Location**, leave **Center (3)** and then press **OK (4)** .



Step 3: Choose the **Crop** tool (1) => **Crop Tool (2)** .



Next, drag the crop area to the four corners to create a frame for the image. Then press **Enter** to finish creating the white border.

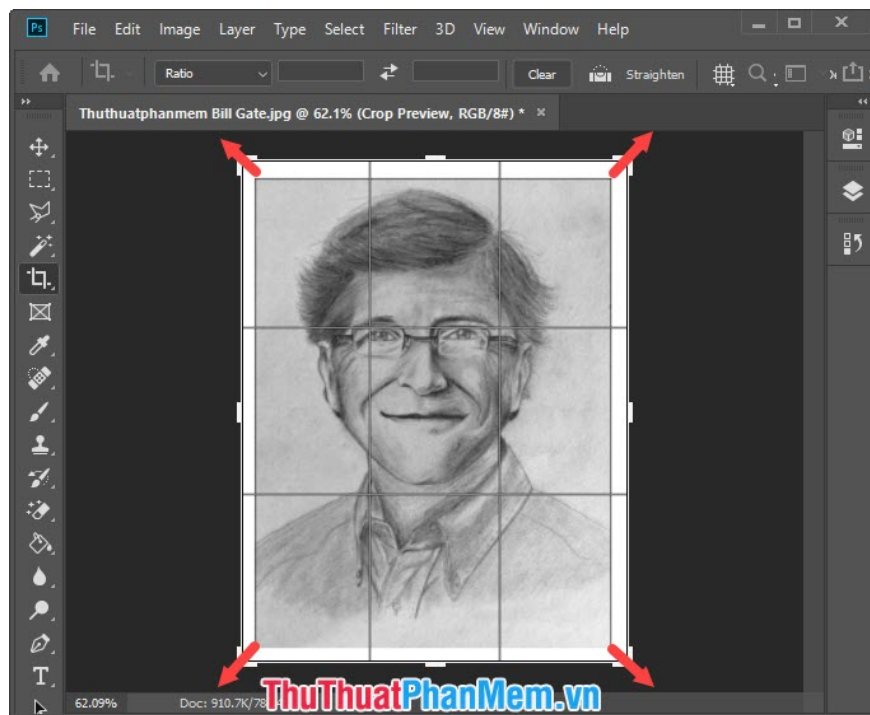

Step 4: Select the **Select tool (1)** => **Magic Wand Tool (2)** .

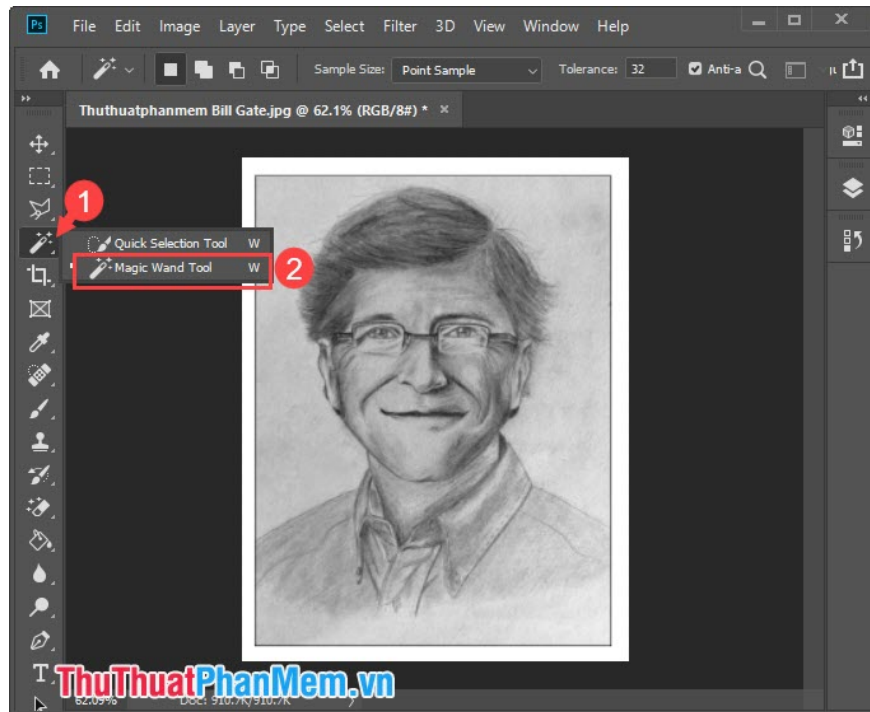

Next, click on the white border to select the entire white border.



Step 5: Go to **Edit** menu (1) => **Fill** (2) or use the key combination **Shift + F5** .

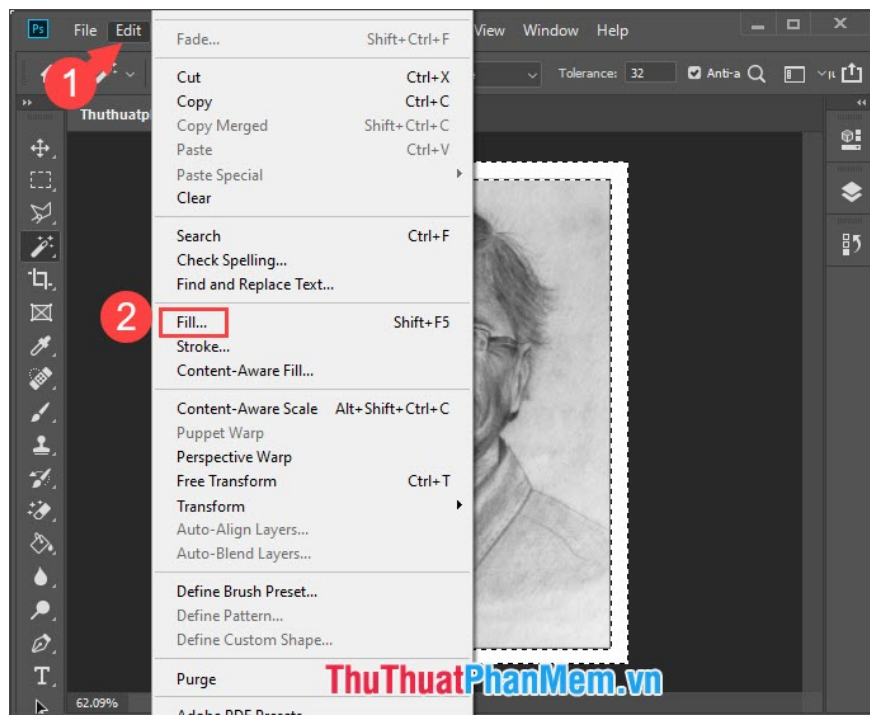

Step 6: In the **Fill** dialog box, select **Contents** as **Pattern** (1) . Then click **Custom Pattern** (2) and select the appropriate pattern (3) . Next, click **OK** (4) to finish.

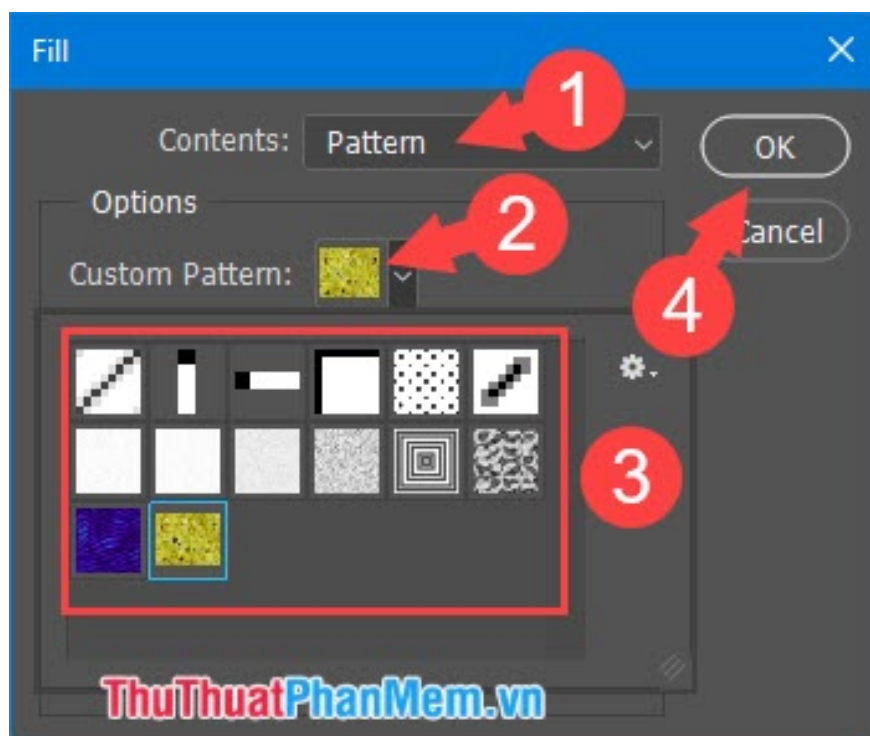

And finally you have the finished picture with a beautiful pattern border. Press **Ctrl + D** to delete the **Marquee Tool** selection .

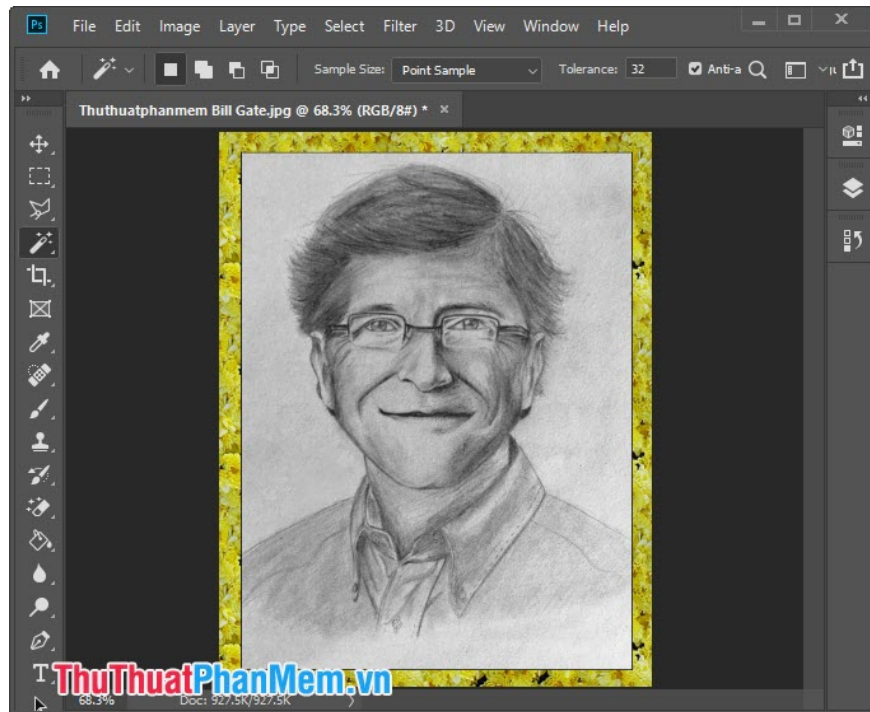

So we have completed the steps to create a photo frame in Photoshop. If readers have difficulty or have questions about the steps in the article, please send comments, questions to TipsMake.com in the comment section below!

You finished reading the article "**How to make a photo frame in Photoshop**" edited by the [TipsMake](https://TipsMake.com) team. We hope this article has provided you with many useful tech tips and tricks. You can search for similar articles on tips and guides. Thank you for reading and for following us regularly.