

# How to lock Google Chrome profile with a password

Chrome allows you to easily switch profiles during web browsing. Suppose in case if you lend your computer to another user and you don't want them to access your Chrome profile - containing bookmarks, browsing history and even a password, ... then you can lock the profile. My Chrome with a Google account password.

**Chrome** allows you to easily switch profiles during web browsing. Suppose in case if you lend your computer to another user and you don't want them to access your **Chrome profile** - containing bookmarks, browsing history and even a password, . then you can lock the profile. My Chrome with a Google account password.

To **lock Chrome profile** with a Google account password, you must add a new user so Chrome considers it a monitoring user. In the article below, Network Administrator will guide you through the steps to lock your profile.

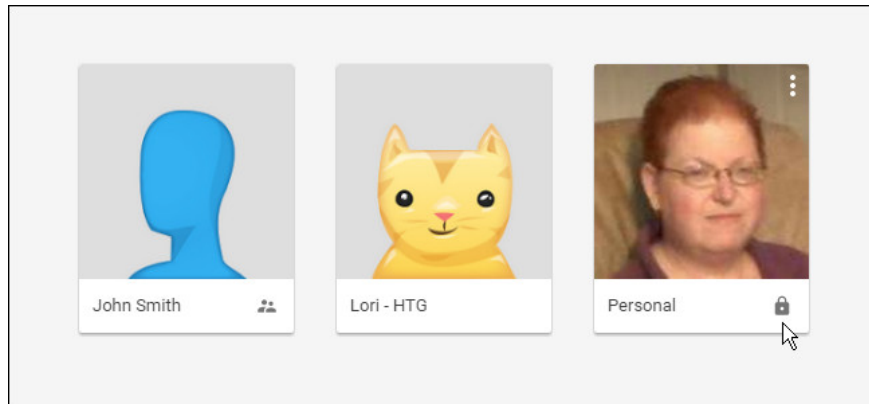

## How to lock Google Chrome profile with a password

To do this, you must use the new profile manager on Chrome. First you have to activate the new profile manager on Chrome flag. Enter the command below and browse the address bar and press Enter:

```
chrome:// flags / # enable-new-profile-management
```

**Note :**

You do not have to use this new profile but must have at least one supervised user so you can access profile lock options.

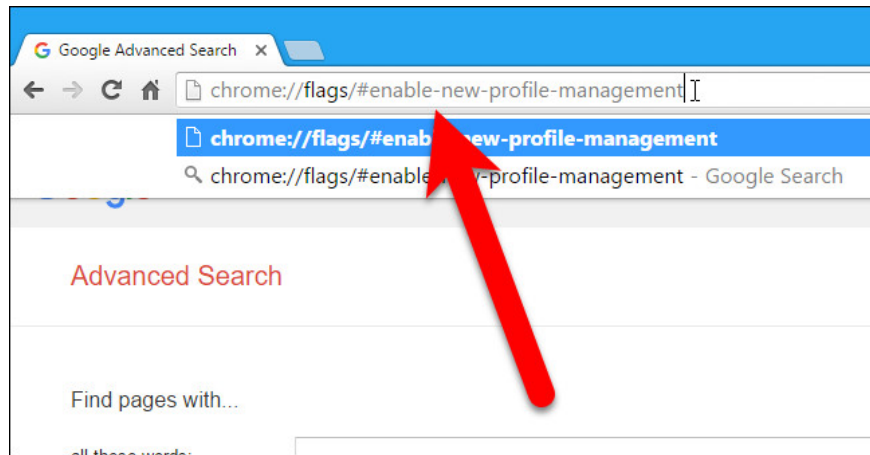

On the new window that appears on the screen, at the **New profile management system** dropdown menu , click **Enabled** .

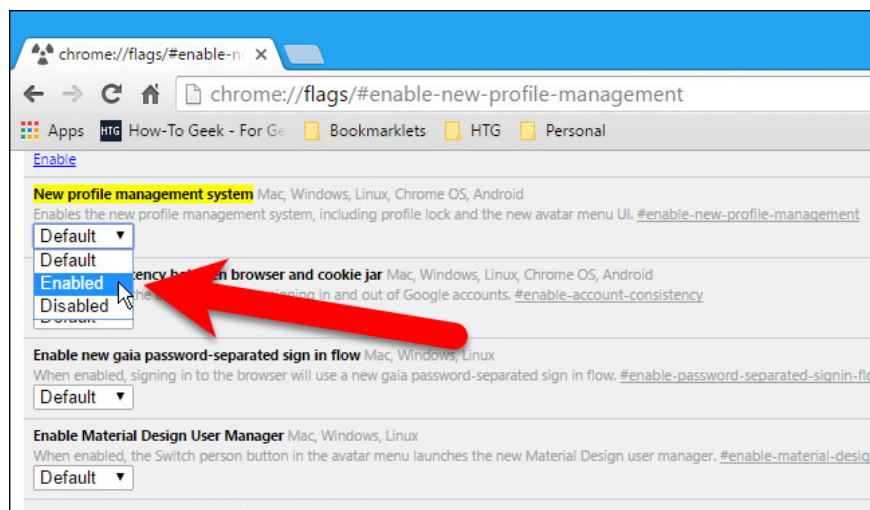

Chrome will force reboot to apply changes, so you scroll down to the bottom of the **flags** list, find and click **Relaunch Now** .

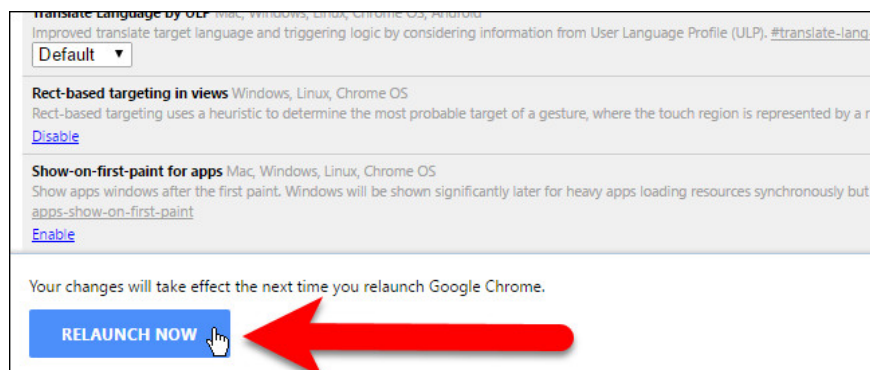

After Chrome has reopened, click on the menu icon (3 dots or 3 lines in line) in the top right corner of the browser window, select **Settings** .

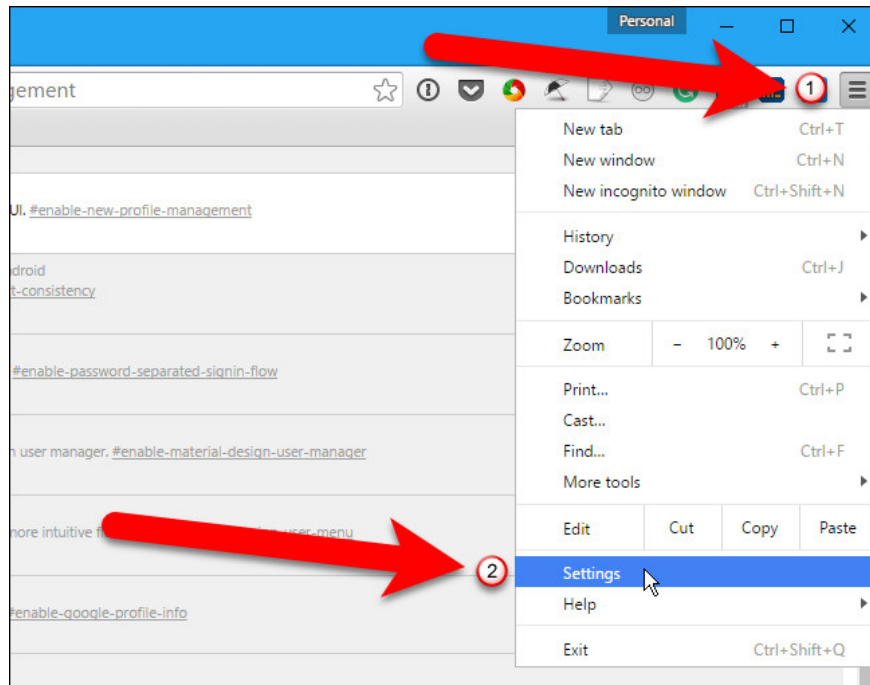

The Settings page will be opened on a new tab. Here you find **People** , then click **Add person** .

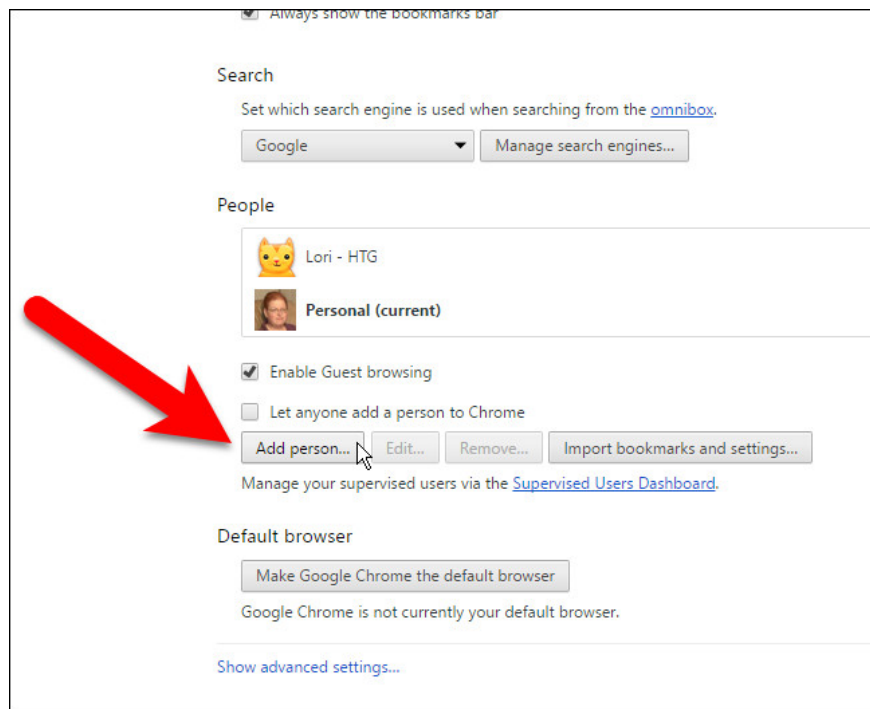

On the Add person dialog box, enter the name of a new user that you like and then check the **Control and view the websites this person visits from youremail@gmail.com** .

If you want, you can change the image related to this user by clicking on a descriptive image then clicking **Add** .

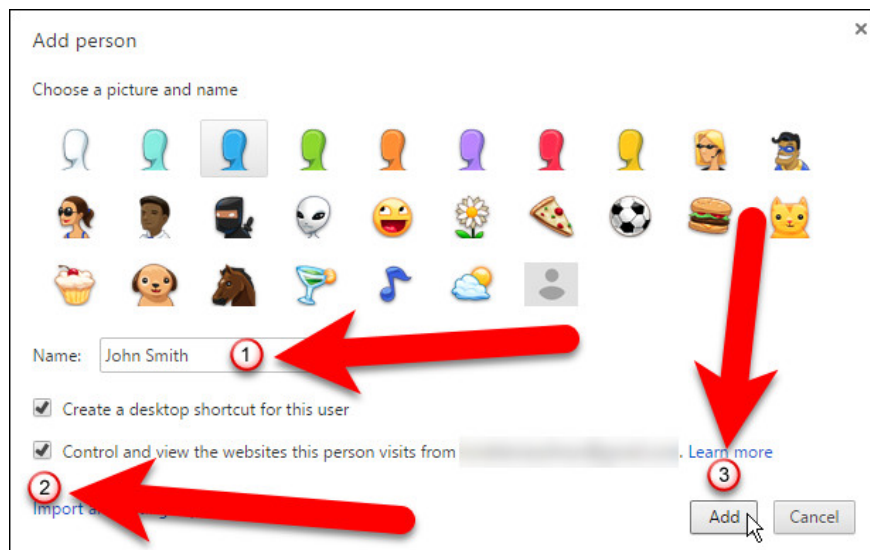

The next dialog box will notify you that the new user you just added is a monitoring user. You can manage the settings for the monitoring user by clicking on the link [www.chrome.com/manage](http://www.chrome.com/manage) on the dialog box, then clicking **OK**, got it.

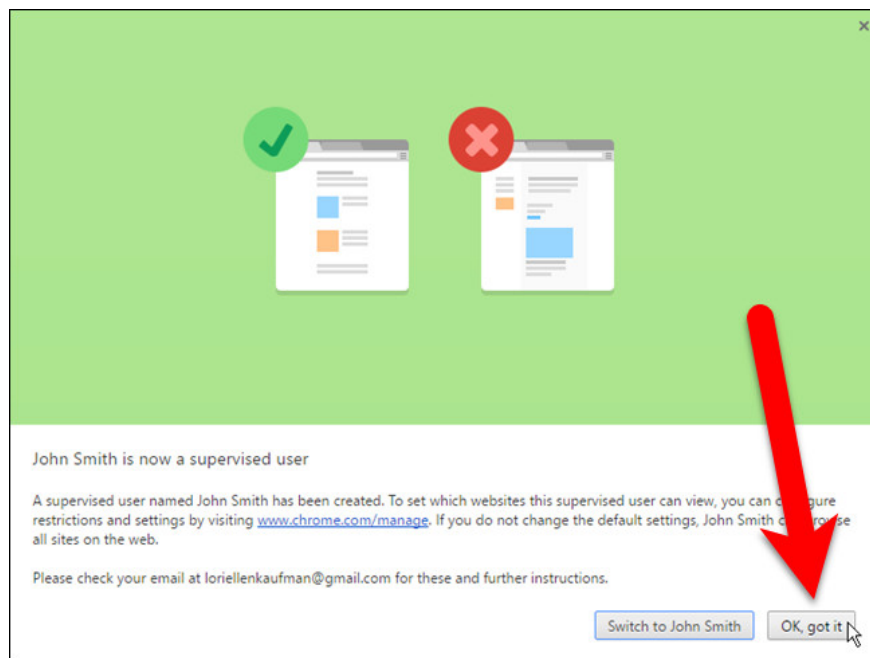

And you will see a new user on the People list with **Supervised** text located next to the username.

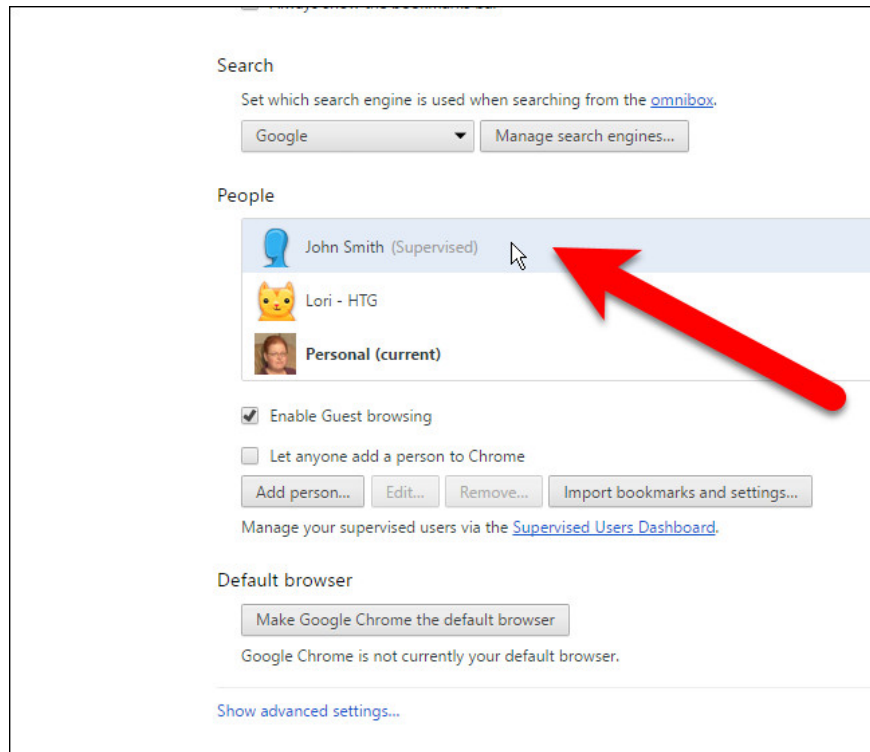

Now you can click the button in the top corner of the browser window with your profile name, then select **Exit and childlock** to close the Chrome window and lock your profile .

**Note :**

To lock the profile, you must exit Chrome using the **Exit and childlock option** on the profile conversion menu. If you exit Chrome in the normal way, your profile will be unlocked.

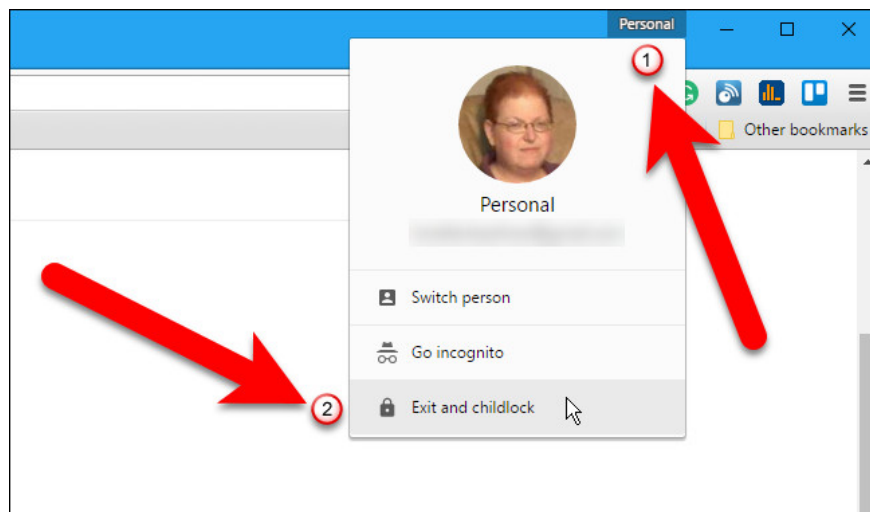

The Google Chrome profile dialog will automatically display the selected account and be ready to " *accept* " your password. If you don't want to reopen Chrome browser right away, click the **X** icon in the top right corner to close the dialog box.

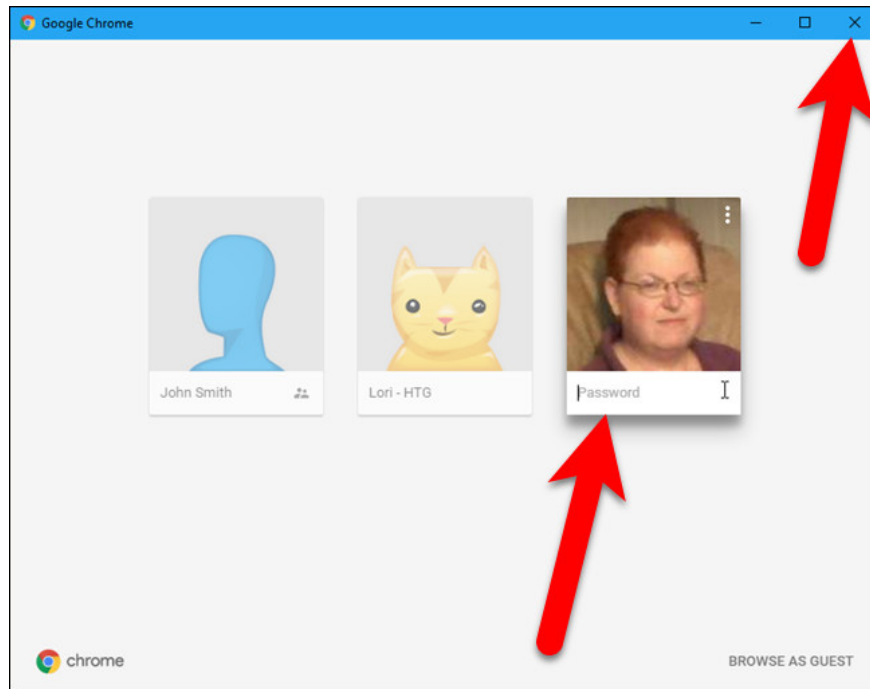

If you want to open Chrome with a " *protected* " profile using your password, enter your Google account password and press Enter.

When your profile is locked, and you **open Chrome with that profile** , a dialog box will appear on the screen. On this dialog you will see the lock icon on the profile you set up to protect. Click on that user **profile** and enter the password to open Chrome with the account you locked.

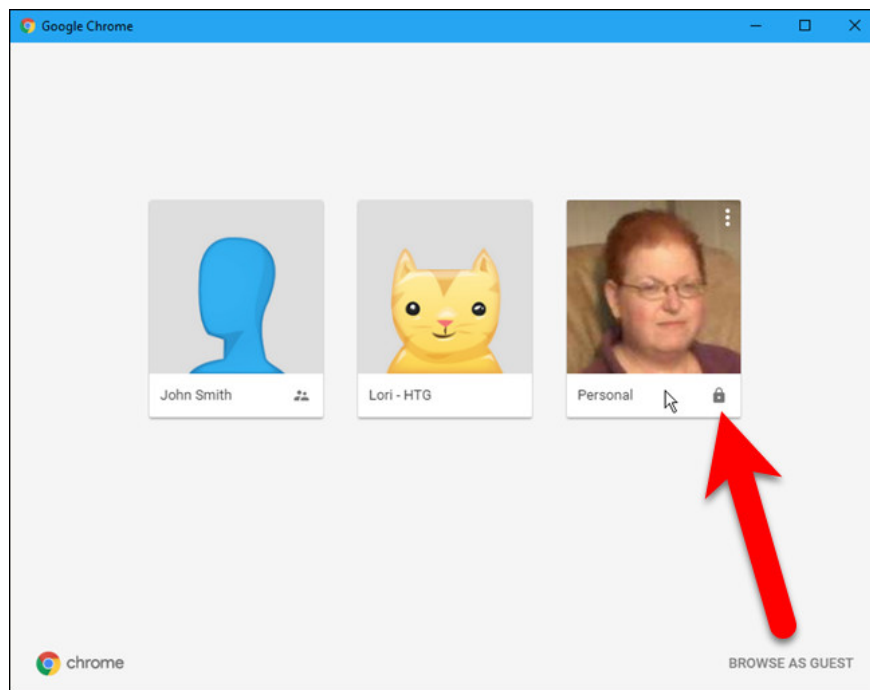

**Refer to some of the following articles:**

1. Instructions for setting up BIOS and UEFI passwords to protect data on your Windows 10 computer safely
1. Instructions for changing Windows passwords without having to remember the old password
1. Instructions on how to activate the Admin account or reset the Admin account password

**Good luck!**

You finished reading the article "**How to lock Google Chrome profile with a password**" edited by the [TipsMake](#) team. We hope this article has provided you with many useful tech tips and tricks. You can search for similar articles on tips and guides. Thank you for reading and for following us regularly.