

How to Install Printer for Computer, Laptop Simple and Fast

Installing printers on computers and laptops is a constant requirement for office workers. Are there any simple and quick ways to install them on both devices?

Computers, laptops and printers are closely linked devices in offices. How to **install printers** quickly and easily is always a constant question for office workers. For those who do not know how to install printers with PCs and laptops, do not miss the smart installation suggestions below.

1. How to install a wired printer for your computer



In order for your computer and printer to be able to connect with each other, these two devices must use the same internal network, which can be a wifi network or a LAN network. Then, both computers connected to the printer need to have the Driver installed. This driver must be compatible with the printer to be able to use it.

After completing the above steps, proceed to install the printer on your computer as follows:

Step 1: Plug the printer cable into the computer



Step 1: Type **Printers & scanners** in the search bar > Select **Printers & scanners** .

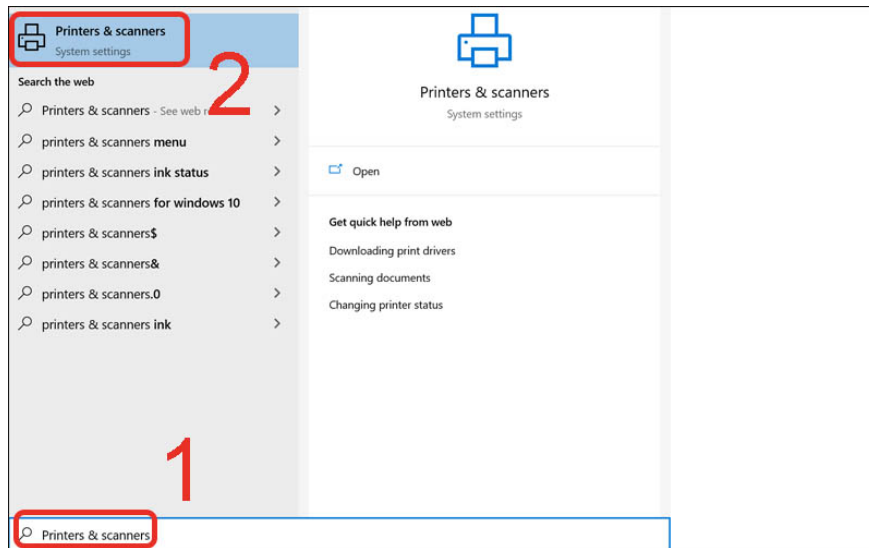

Step 2: Click **Add a printer or scanner** > Click the name of the printer you want to connect to your computer.

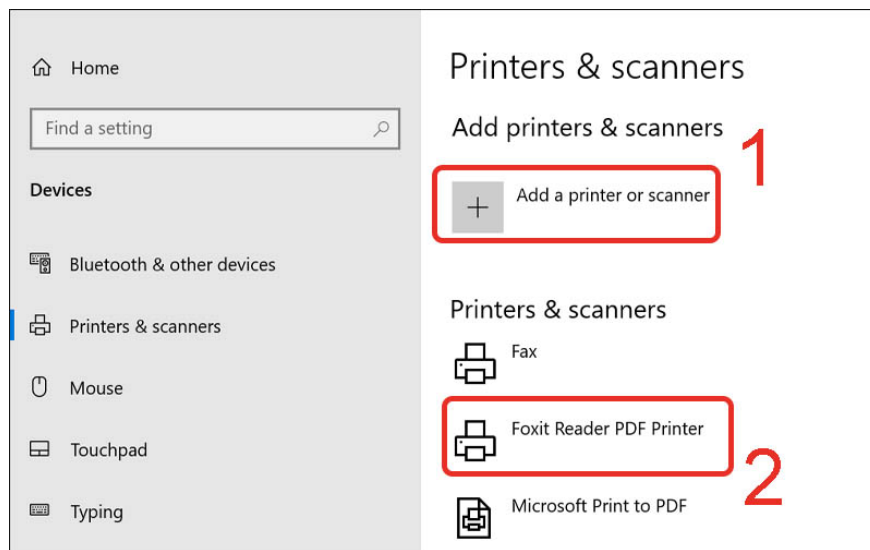

Step 3: Once you have completed the above steps, check which computer is being shared in the LAN/wifi network and then link to the printer's IP address using the formula Windows + R, open the Run dialog box, enter the server IP or printer name and you're done.

2. How to connect wireless printer (wifi/bluetooth) to laptop

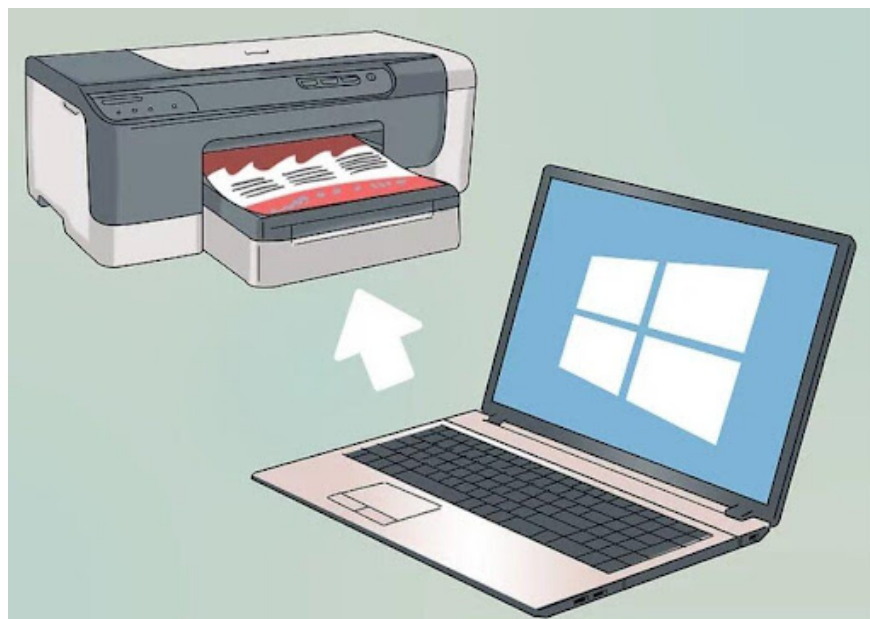

New printer models are now appearing quite a lot on the market and they can connect to the printer via wifi or bluetooth very easily. These wireless laptops to install with the printer need to do the following:

Step 1: Place the computer and printer close together (so that the two machines can connect via Bluetooth), turn on the wireless printer and then turn on the power.

Step 2: Wireless printers will have instructions on how to connect them to your computer.

Step 3: Connect the printer to the wifi network and the computer must also use the same wifi. If connecting via bluetooth, select the Pair button on the printer to connect.

Step 4: On your laptop, select Start, select Settings, then click Devices and select Bluetooth & other devices

Step 5: Here, click Add a printer or scanner or Add Bluetooth or other device

Step 6: If you connect to wifi, select the printer name and the printing operation is complete. If you connect to bluetooth, select the printer name, press Connect and select Pair.

3. How to connect a wired printer to a Macbook



Macbook or Mac has a slightly different way of using compared to Windows operating system. So to connect the printer to this operating system, the way to do it will be significantly different:

Step 1: The user opens his macbook and updates to the new version, keeping the computer close to the printer so that the cord is not stretched.

Step 2: For the printer, you plug in the power, turn on the power and plug the USB into your laptop. Each Macbook model will have its own USB port connection type and sometimes there is no traditional USB Type A but only a USB Type C port. So you should equip an additional USB Type C for more convenience in using the printer.

Step 3: When the printer and laptop are successfully connected, the computer will automatically notify and display that the connection has been made. Then, you just need to select Install and follow the instructions.

Step 4: The first time you connect the two devices together, you will have to install the printer by clicking Download & Install and the system will automatically perform the linking operation for you.

Note: When using the printer, you should not turn off the server because this will cause the printer to stop working and other computers will not be able to use the printer. Connecting the computer to the printer wirelessly or wired has its own advantages and disadvantages. Each working environment, you should flexibly handle so that the work can go as smoothly as possible.

4. Some common errors when connecting and using the printer

Error cannot connect printer

Not being able to connect the printer via LAN makes it difficult for users to connect, affecting the user's printing work. To fix this error, you can do the following:

- + Share printers over LAN properly.
- + Check Driver.
- + Use the Troubleshooter.
- + Rerun the printer finder on Windows 10.
- + Troubleshooting 101.

Windows computer error cannot find printer

When your Windows computer cannot find the printer, it may be due to a problem in the connection between the computer and the printer when first purchased and used.

Not only that, incompatible operating systems, limited LAN networks or virus-infected servers are also reasons why Windows computers cannot find printers.

To fix this you need:

- + Fix errors caused by incompatible operating systems.
- + Check the IP address of the host computer.
- + Fix limited LAN network error.
- + Fix errors caused by server infection.

Computer error does not recognize printer

The main reason why the computer does not recognize the printer may be because the connection cable is broken or not plugged in tightly. Besides, you may have forgotten to turn on the printer or due to hardware or cartridge technical errors.

To fix the above situation, try:

- + Restart the Print Spooler service.
- + Uninstall the printer driver.
- + Create new local port.
- + Copy "mscms.dll" manually.

Printer error does not receive print command

The printer not receiving print commands may be due to an operating system error on your computer or an IP error on your printer.

In addition, it is also possible that the cable connecting the printer to the computer is broken or loose, causing the printer to not be able to connect. In addition, printer driver errors will also prevent the printer from receiving print commands when you need them.

To fix this error you can do the following:

- + Check the connecting cable for damage or looseness.
- + Restart your computer.
- + Check printer power source.
- + Make sure the printer is not jammed.
- + Let Windows fix the error by itself using Troubleshoot.
- + Restart the Print Spooler process.
- + Check IP on printer.
- + Update Driver for printer.

Printer error receives command but does not print

At some point, your printer is working fine and you press the next print command and suddenly the printer receives the command but does not print.

The cause could be an internet error or the printer receiving too many print commands at the same time. In addition, the computer's operating system or printer driver error will also cause the printer to not receive print commands.

When you encounter this situation, you need to do the following :

- + Check the printer and WiFi transmitter connection again.
- + Restart the printer.
- + Install additional anti-virus software.
- + Restart the Print Spooler process.

5. Answer some related questions

Waiting for a long time but the computer cannot detect the printer?

- **Answer** : Please check if your computer is connected to the same network as the printer. If connected via USB cable, please check the connection ports again.

Also, if you're waiting for a long time, click on the link " **The printer that I want isn't listed** " and follow the instructions on the screen!

How to install printer driver?

- **Answer** : To install the printer driver, you first need to determine your operating system and computer configuration, then search for the appropriate driver version and download and install it for your computer (you can find it on the printer manufacturer's homepage).

Printer not showing up in Devices and Printers?

- **Answer** : When you do not see the printer displayed in Devices and Printers, you need to fix it in the following ways:

+ Add printer to Devices and Printers yourself

+ Restore printer icon in Devices and Printers

+ Reinstall computer operating system

Hopefully, the above sharing of **Hoang Ha Computer** about how to **install a printer** for laptop/desktop/Macbook has helped you have more useful information to serve your work process. Connecting a printer and a computer has probably become simpler and faster than ever.

You finished reading the article "**How to Install Printer for Computer, Laptop Simple and Fast**" edited by the [TipsMake](#) team. We hope this article has provided you with many useful tech tips and tricks. You can search for similar articles on tips and guides. Thank you for reading and for following us regularly.