

How to insert images below the word on PowerPoint

Inserted photos into PowerPoint will either overlap slide content or overwrite other images. However, you can move the position of the image below the text, or another location.

Manipulating images into Word, Excel or PowerPoint content is extremely basic and simple. Just click the Insert tab and select Picture to select the image to insert into the content. And by default, when inserting images into PowerPoint, the image will overwrite the contents of the entered text or previously imported images.

However, it is possible to change the position of the image with the Text content so that the text is overwritten on the image or just one line of text overlaps the image. The following article will show you how to change the image position, overlap the text in PowerPoint.

1. How to insert text into images in PowerPoint
2. Beautiful PowerPoint wallpapers for impressive presentation slides
3. How to add borders to PowerPoint slides

How to change the location of PowerPoint images

Step 1:

First, click on the **Insert tab** and then select **the Picture section** to insert the image into PowerPoint.

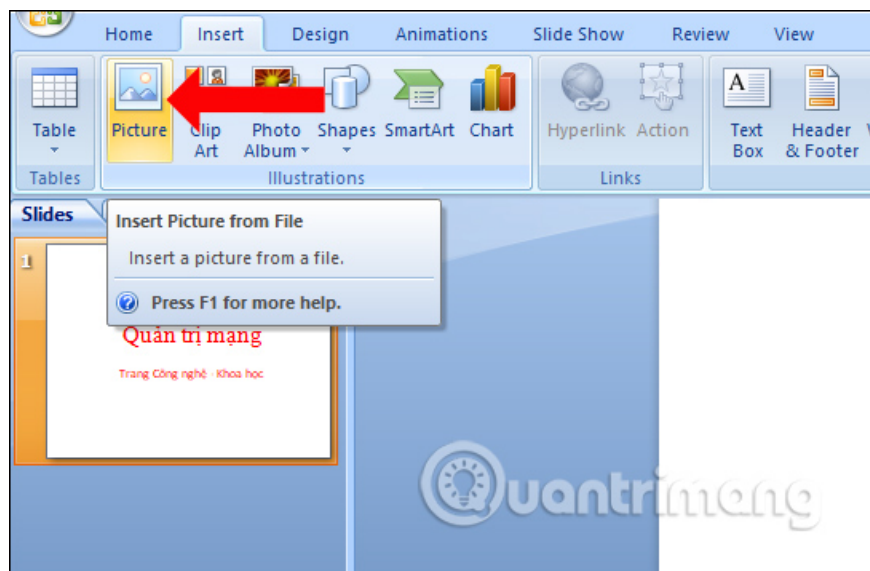

Step 2:

Click the image you want to insert into the content and then click Insert. The image will be inserted into the PowerPoint content as shown below. The whole text will be under the image.

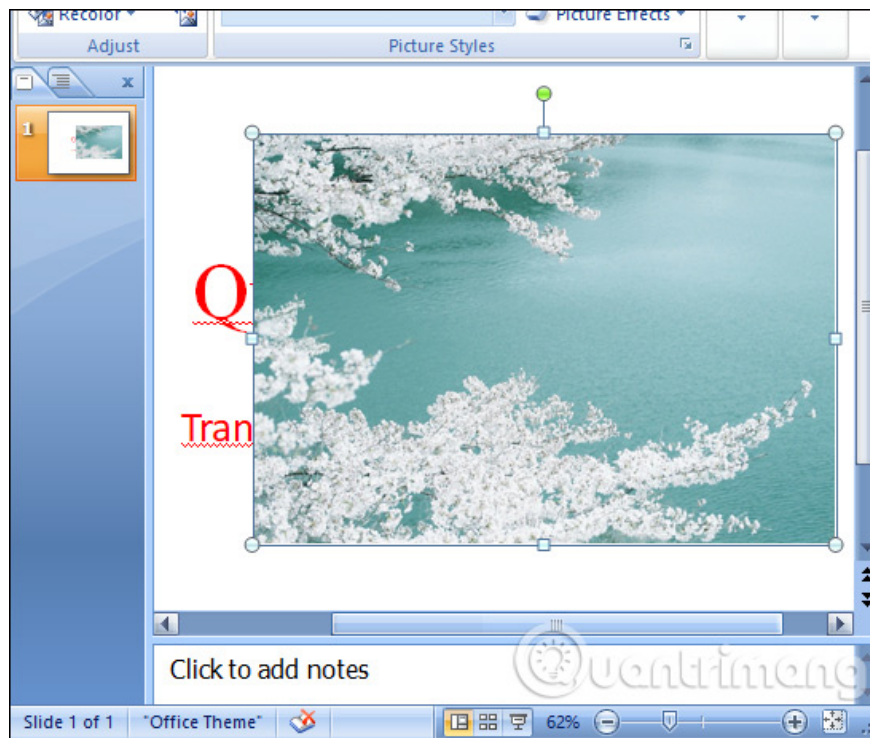

Step 3:

To change the position of the image, right-click on the image and then select **Send to Back** . There will be two different options, Send to Back and Send Backward.

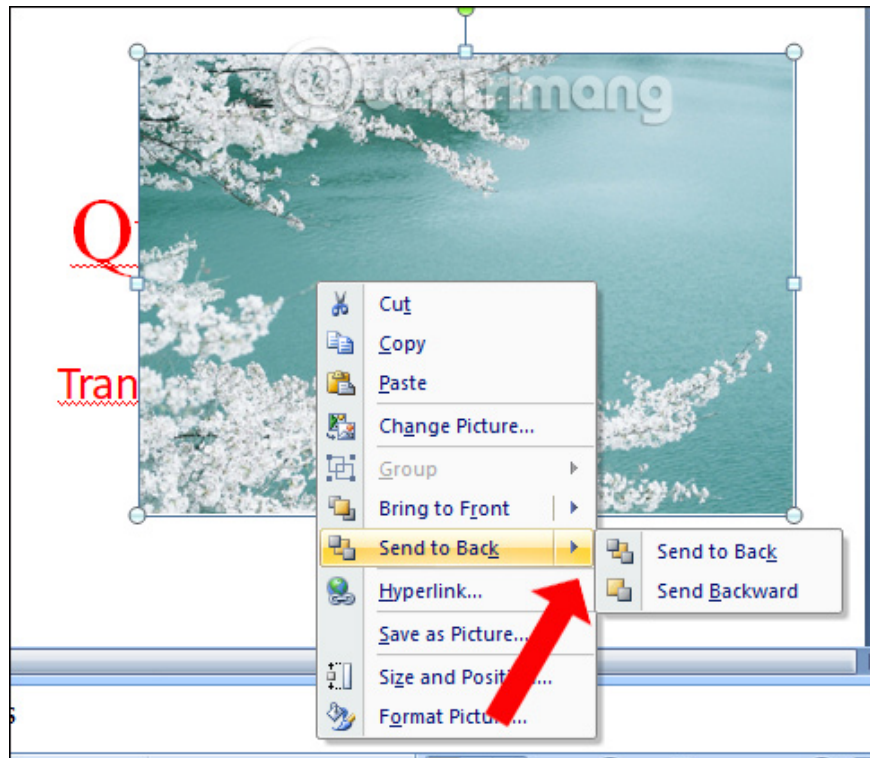

To move the image below the text, we will click **Send to Back** . The text will be inserted into the image as shown below. This is also a way to write images on words, in case you have already written content on PowerPoint.



After changing the position of the image below the text, we can still customize the text format, such as color, font, body text, . Blacken the text and right click then select the content you want Edit in the custom dialog box.

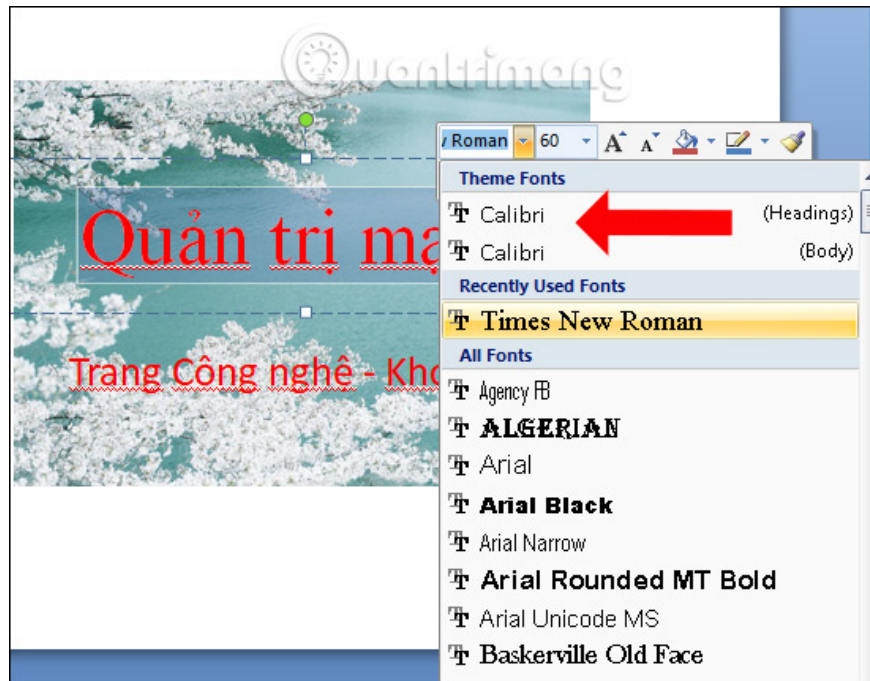

A trick of adjusting PowerPoint image insertion is extremely simple, but you can change the position of the image with the text in the slide. Written words after being inserted into images may change the format of the user.

Video tutorial to insert photos under the word PowerPoint

I wish you all success!

You finished reading the article "**How to insert images below the word on PowerPoint**" edited by the [TipsMake](#) team. We hope this article has provided you with many useful tech tips and tricks. You can search for similar articles on tips and guides. Thank you for reading and for following us regularly.