

# How to insert a background image in Word

You want to create a background image for your text more vivid, leaving an impression in the reader. In this article help you create a background image for your text on Word. To create a background image for the text page you do the following: Step 1: Select the text to insert the background image

You want to create a background image for your text more vivid, leaving an impression in the reader. In this article help you create a background image for your text on Word.



To create a background image for a text page, do the following:

**Step 1:** Select the text to insert the background image -> on the **Home** tab -> **Page Color** -> **Fill Effects** .

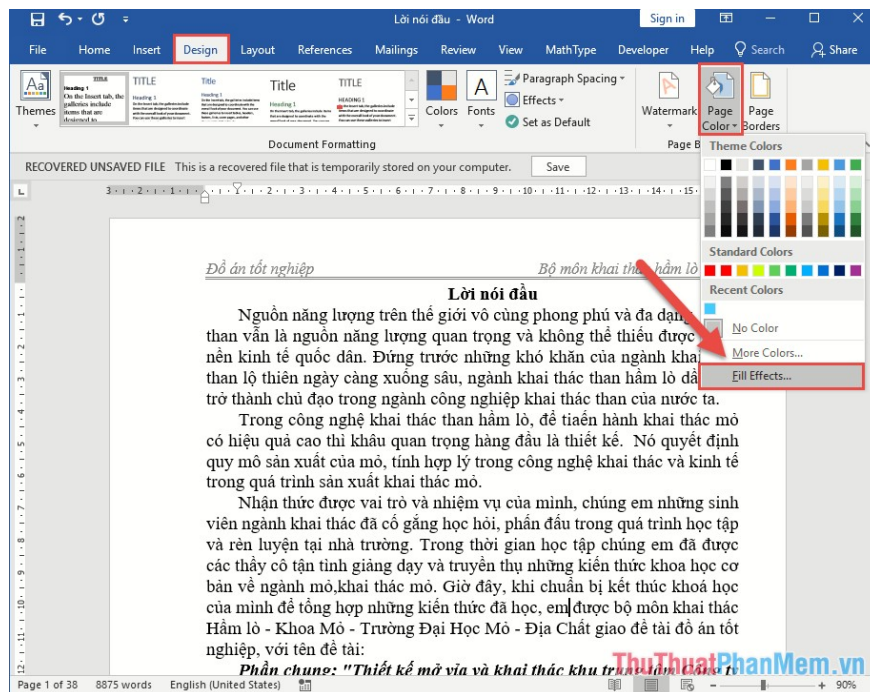

**Step 2:** Next the **Fill Effects** window appears, click the **Picture** tab -> **Select Picture:**

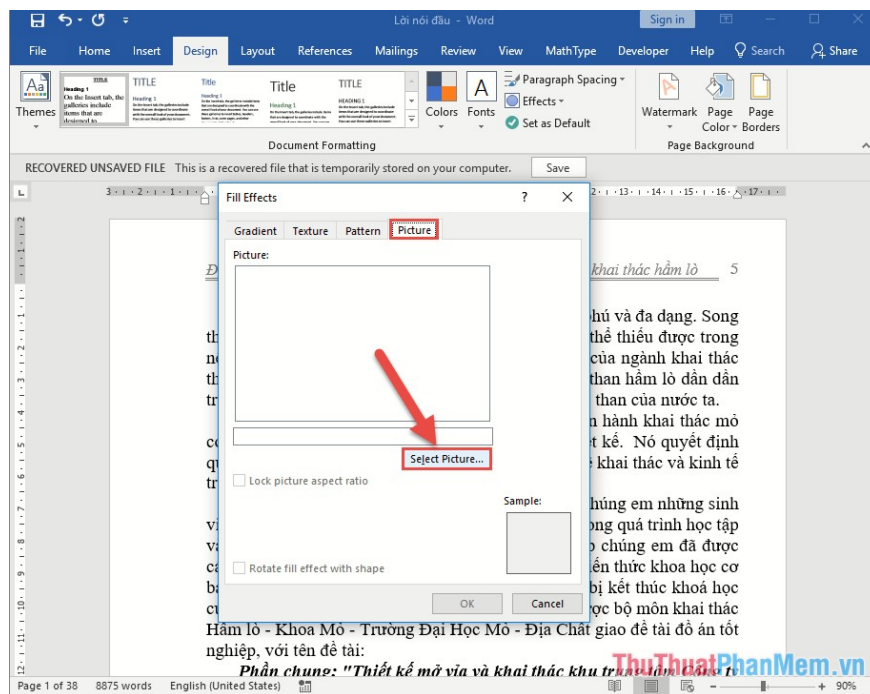

**Step 3:** A dialog box appears that provides three features for you to select the image to be inserted as the background image:

- **From a file:** Select a background image available on your computer.
- **Bring Image Search:** Select the background image by searching for images on the Internet.
- **One Driver Personal:** Select photos available on your **Driver** .

For example, here select the background image by searching for images on the Internet -> enter the search term related to the image selected as the background image in the **Bring Image Search** section:

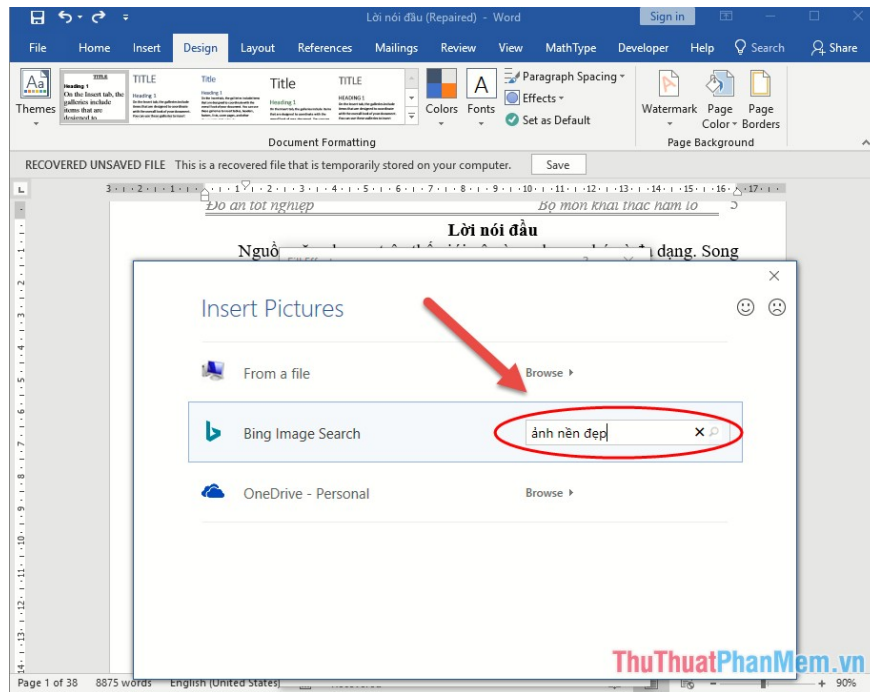

**Step 4:** After pressing **Enter** the image related to the search term is displayed -> select the image you want to select as a background image -> select **Insert**:

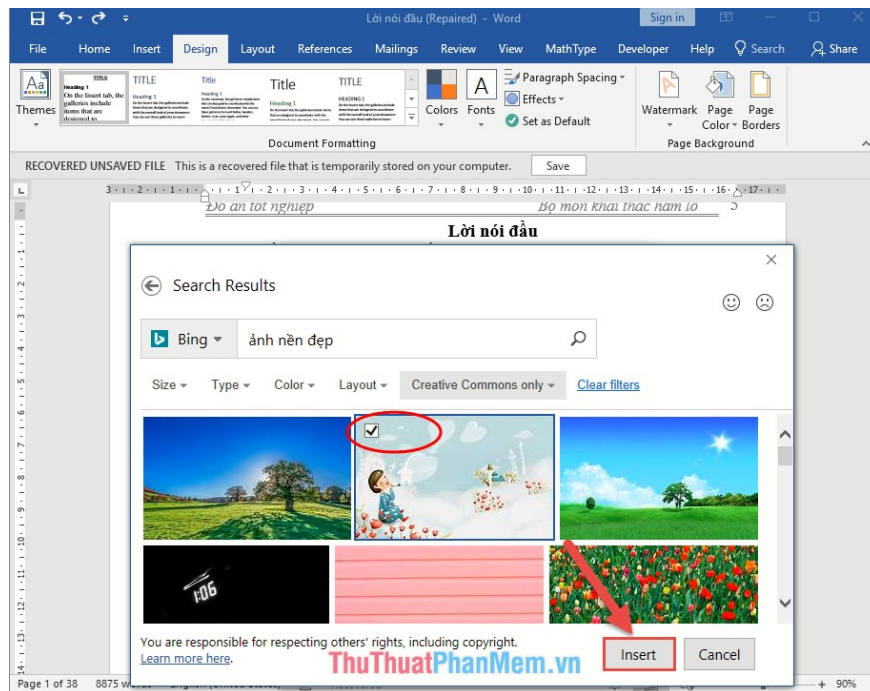

**Step 5:** Continue to click **OK**:

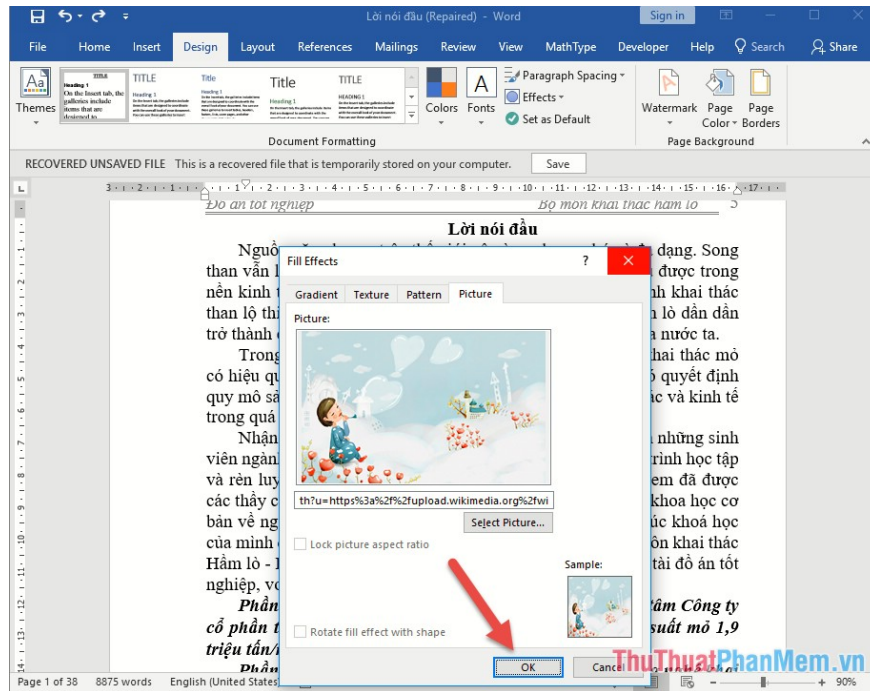

As a result, you have created a background image for your text. Note here that the image selected as the background image fits just enough on one page of the text:

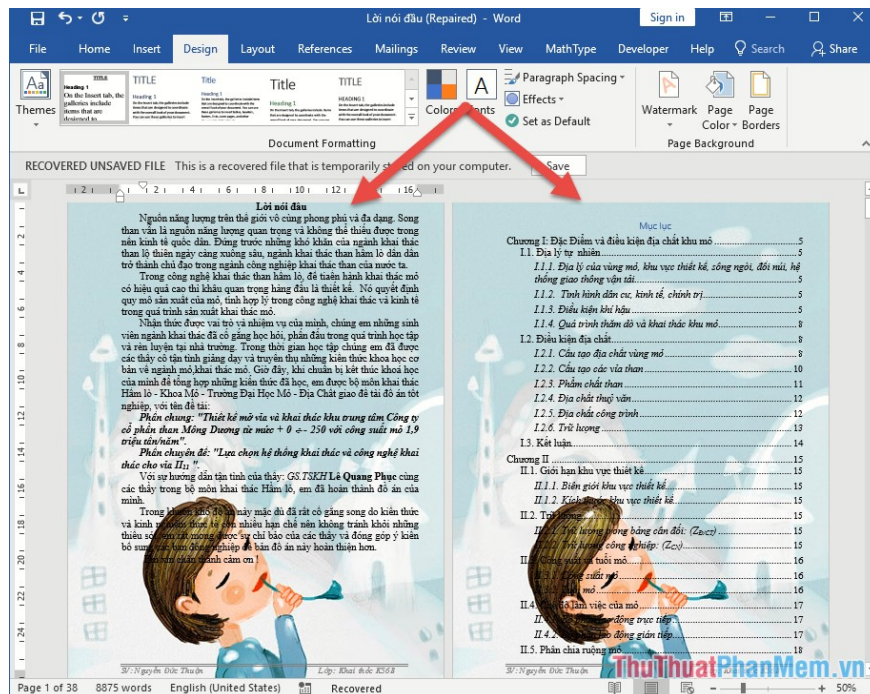

If you select the image as a background image smaller than the size of A4 paper size, the selected background image will include multiple images until the page has just 1 page. The example here inserts heart shape size 275 \* 183 (pixels):

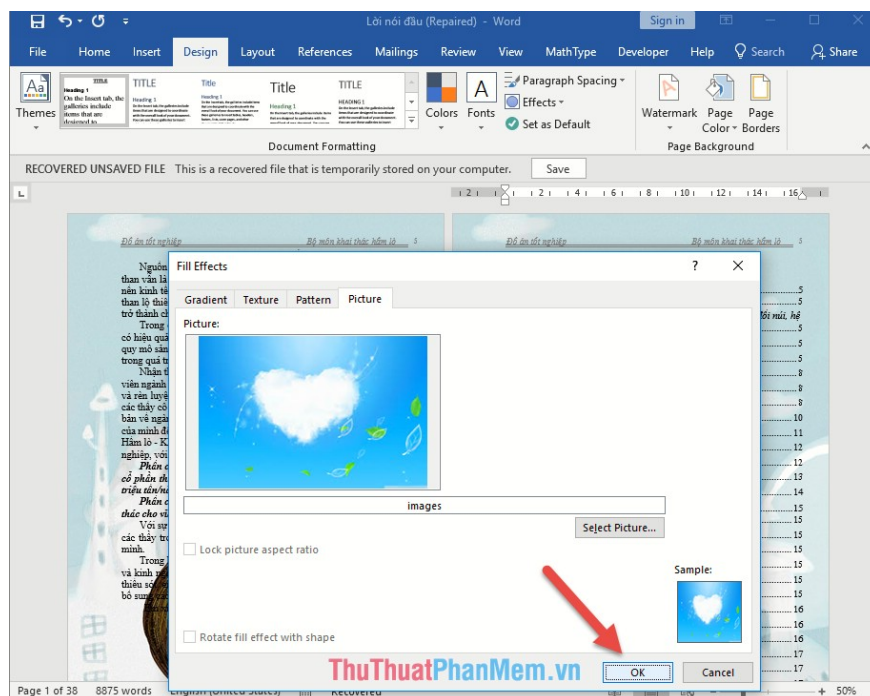

Heart wallpaper is 275 \* 183 (pixels): much smaller than A4 size (when converting pixels about 1123 \* 794 pixels), so when selecting a background image, there will be many images until enough A4 paper size:

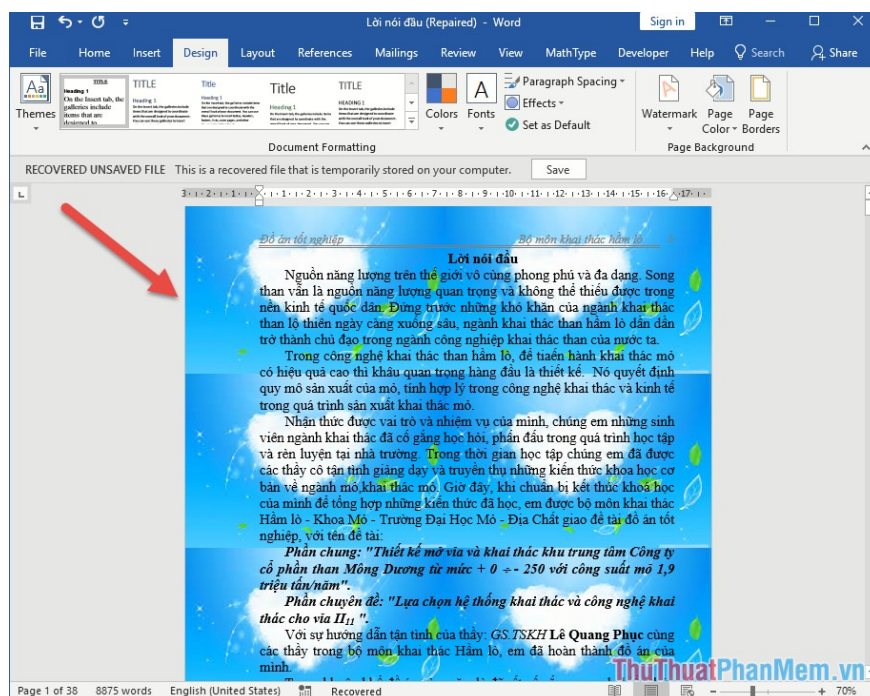

So in the process of choosing a background image, you should choose an image that is the right size for the paper size so as not to duplicate multiple images in the background image.

In case you want to remove the background image, you just need to go back to **Page Color** -> select **No Color**:

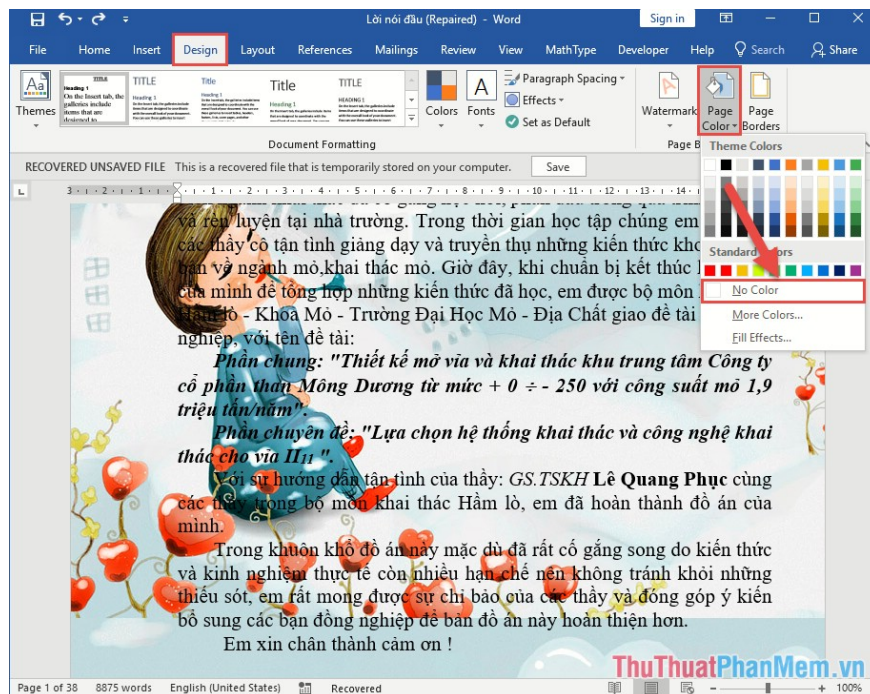

As a result, you have removed the background image on your text:

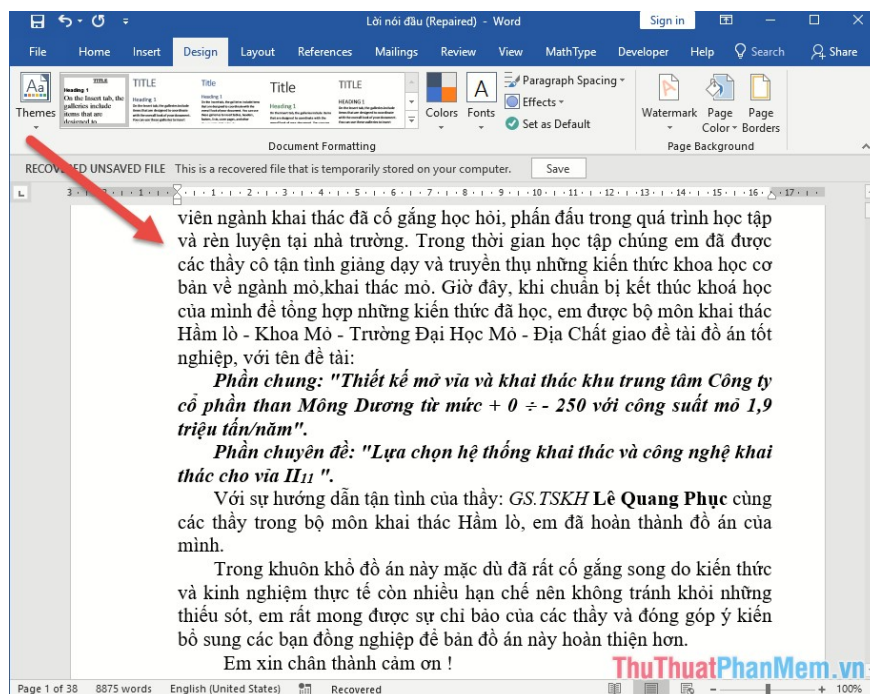

So you can create background images for your text. With its own pictures and sweet messages, it's a meaningful letter for the one you love. Good luck!

You finished reading the article "[How to insert a background image in Word](#)" edited by the [TipsMake](#) team. We hope this article has provided you with many useful tech tips and tricks. You can search for similar articles on tips and guides. Thank you for reading and for following us regularly.