

# How to Fix Keyboard Input Wrong Character Error

If your keyboard is not typing the correct characters, the input language may not be selected correctly. Modern operating systems come with multi-language input features, and if multiple language modes are enabled, it's easy to accidentally switch between them. If you use a laptop with a touch pad, the NumLock key may be the culprit.

## Windows 10 operating system

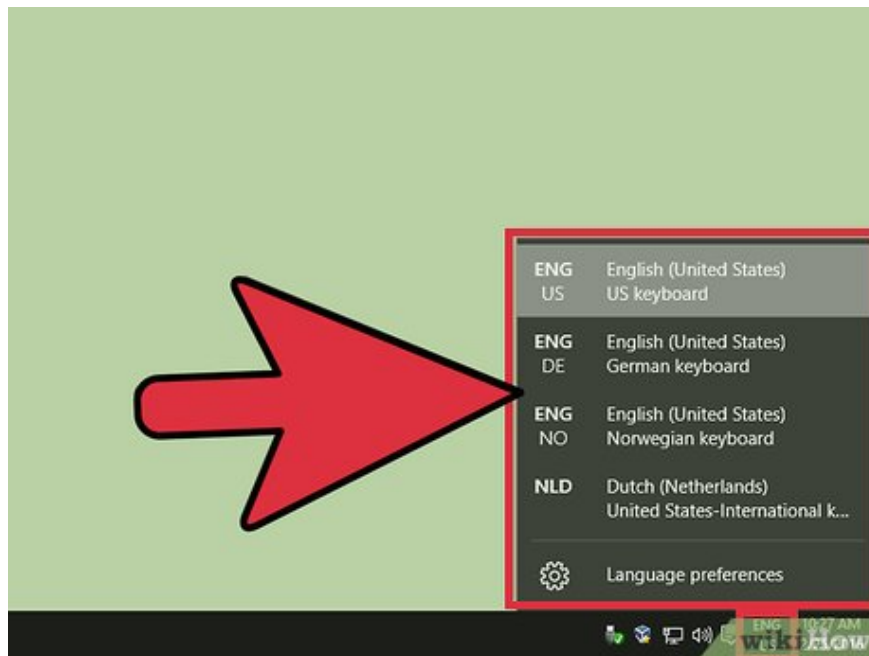

**Switch between keyboard layouts.** If you have more than one keyboard layout installed and need to use different keyboard layouts, you can change them quickly. There are two different ways to do it:

Click the Language button in the System Tray and select the language you want to use. This feature appears when you have more than one input language or keyboard installed.

Press ? Win+ Spaceto cycle between the input languages ??and keyboards you have installed.

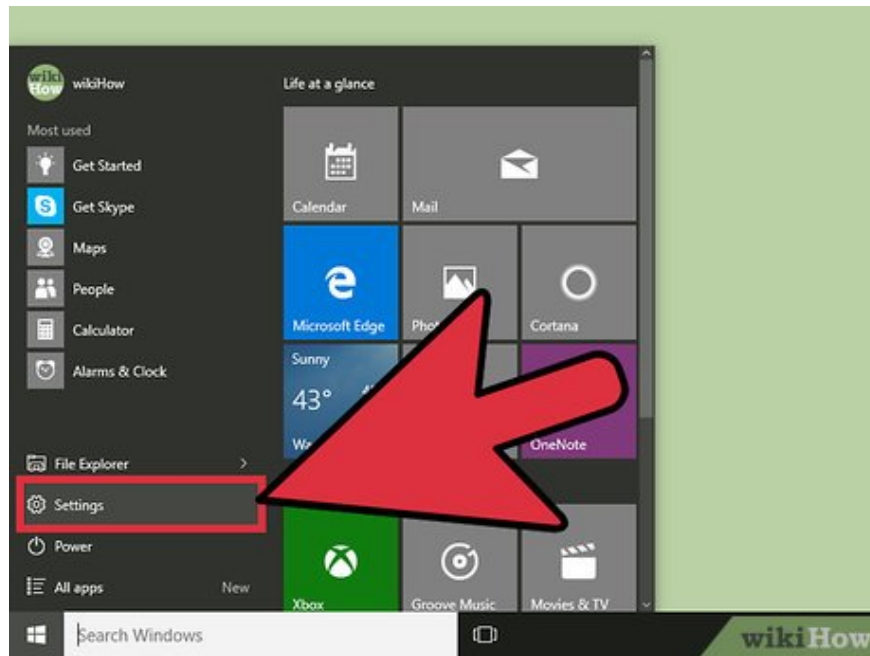

**Open the Start menu and select "Settings".** If the keyboard you're typing on doesn't work, or you can't select the correct setting, you can change it from within the Settings menu.

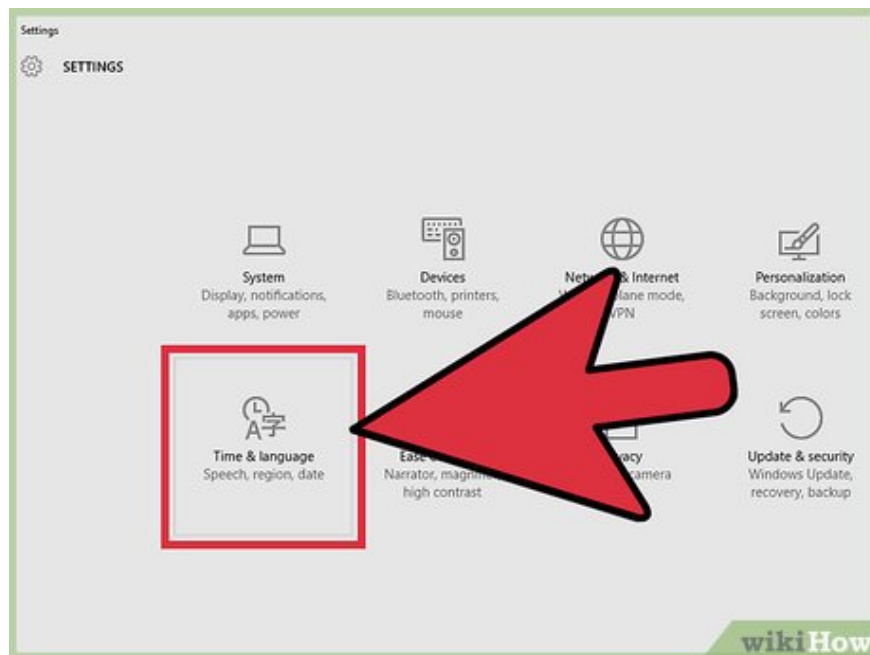

**Select "Time & language".** Your computer's regional settings will open.

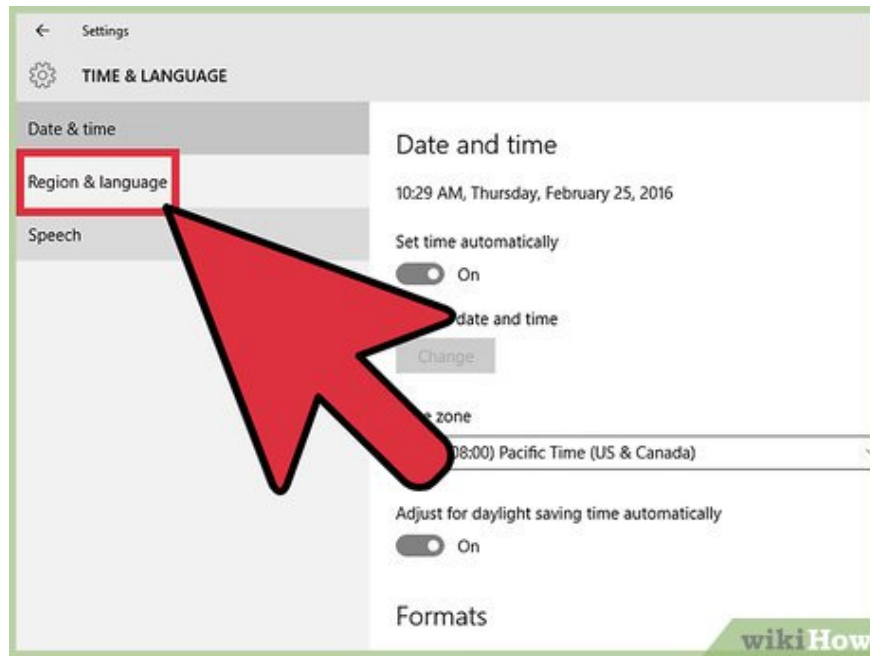

Select "Region & language". You will be able to choose from the languages ??installed on your computer from this menu.

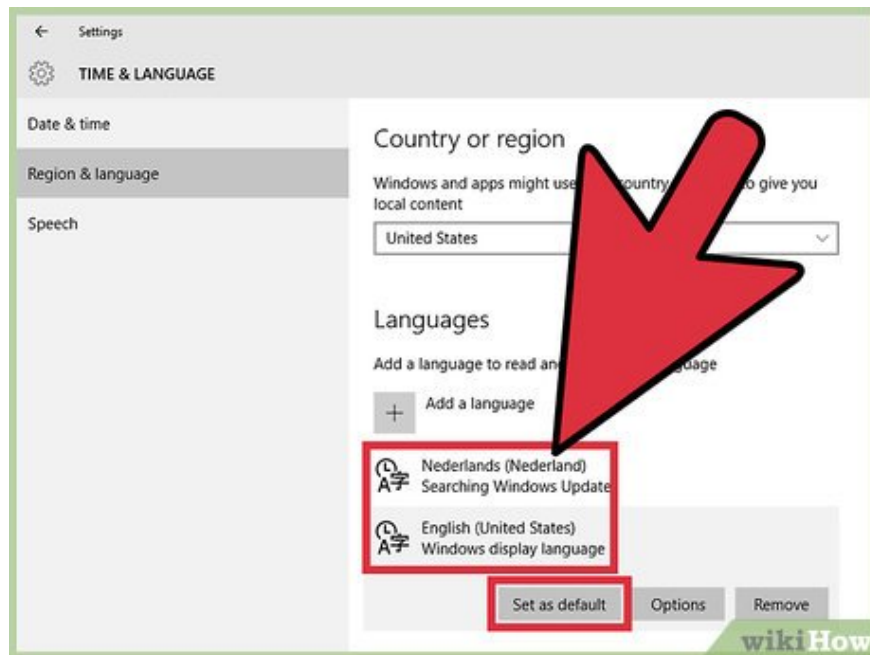

**Set preferred default language.** If more than one language is present, the wrong language may be selected and cause the keyboard to function incorrectly. Select the language you want to use as your default input language and click the "Set as default" button.

Note: The display language will be changed to the new default language when you log out and log back in.

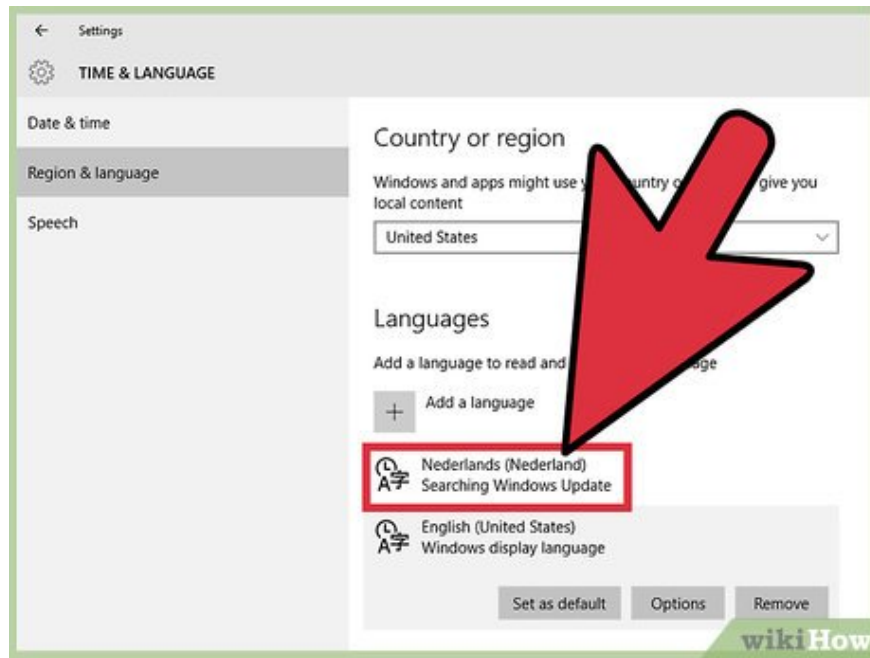

**Click your language.** Usually, there will only be one language listed here, but if you have more choices, click on the currently selected language.

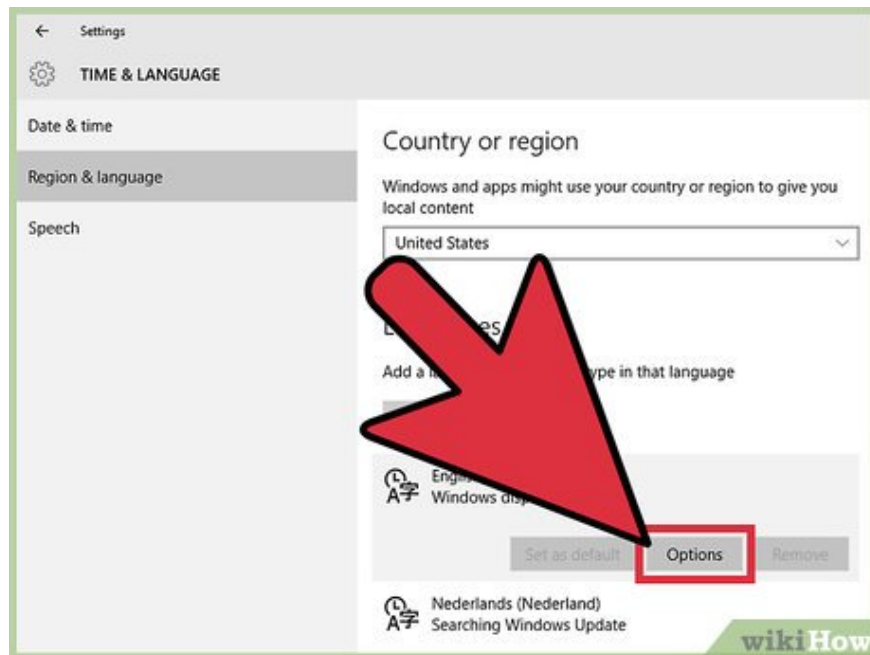

**Click the "Options" button to open additional options for the installed language.**

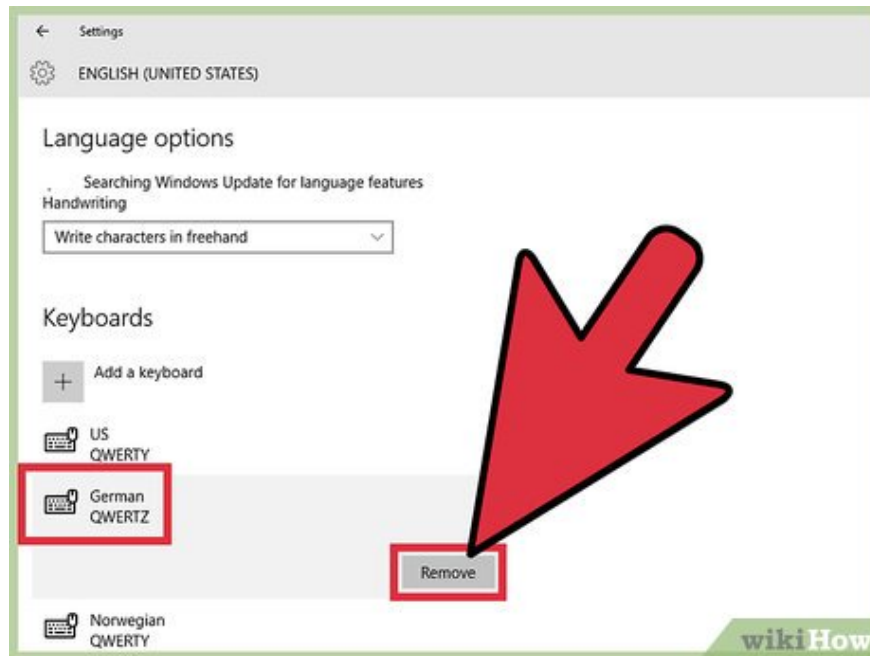

**Remove keyboard layouts you don't want to use.** If there are multiple keyboards listed in the "Keyboards" section, delete the model you don't use. This will ensure that only the correct layout type is selected.

Click on an installed keyboard that you want to remove and click the "Remove" button.

Keyboards with patterns other than "QWERTY" often result in incorrect characters appearing when keys are pressed.

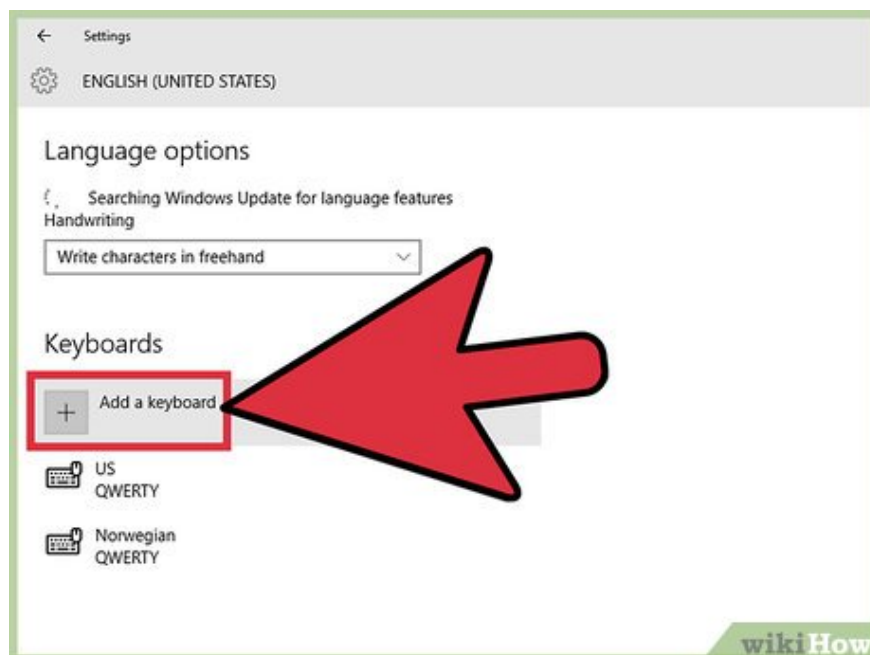

**Add the desired layout if your computer doesn't already have it.** If the regular keyboard layout isn't listed, click the "Add a keyboard" button and find the keyboard you want to use.

**Windows 8 and 8.1 operating systems**

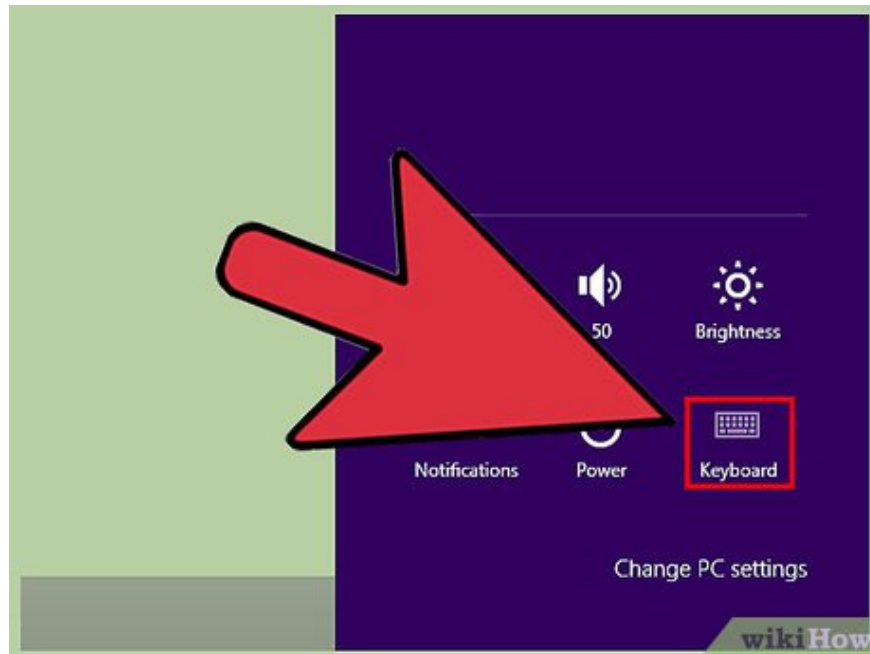

**Switch between installed keyboards.** There are several ways to change the input language if you have more than one keyboard style installed:

Open the Charms bar and tap "Settings." Click the "Keyboard" option and select the keyboard you want to use.

Click the current language in the system tray and select the keyboard you want to use.

Press ? Win+ Spaceto cycle between the keyboards you have installed.



**Open the Charms menu.** Move the mouse to the upper right corner of the screen, press ? Win+ C, or swipe from the right here. You'll be able to install new keyboards or delete ones you don't use.

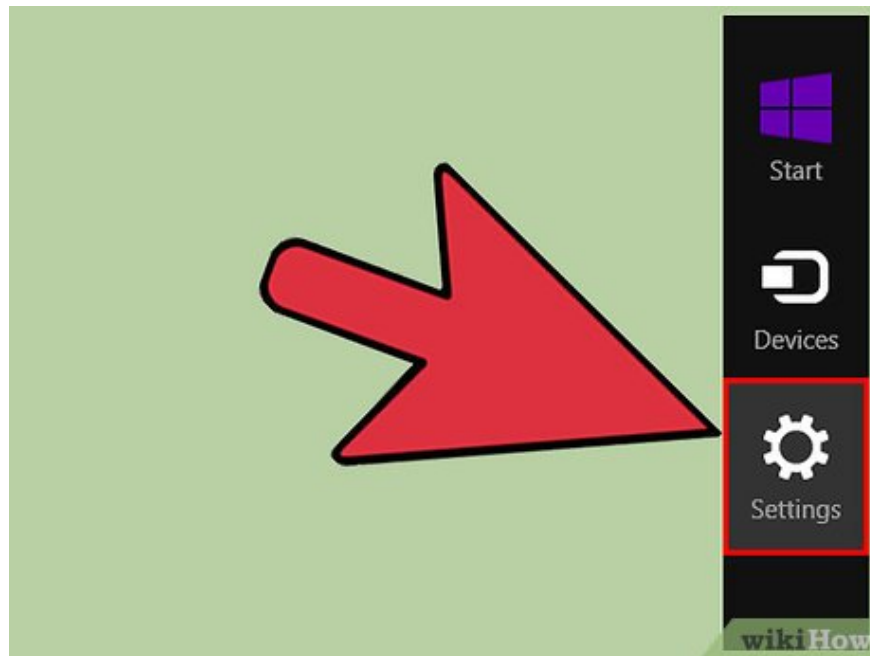

Click or tap "Settings" to expand the Charms bar.

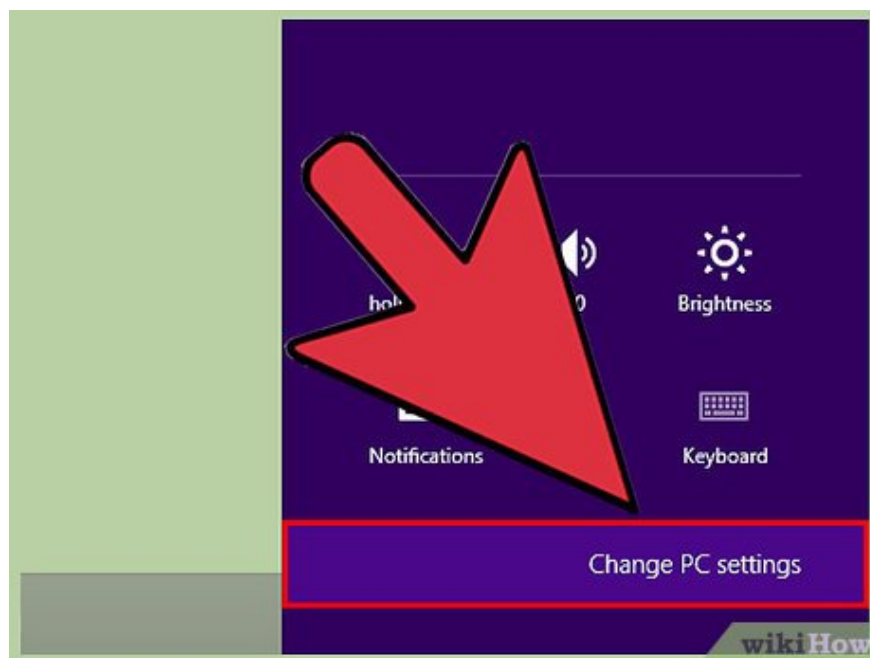

Select "Change PC settings". The "PC settings" screen will open.



Select the **"Time and language"** task. The date and time settings will appear.

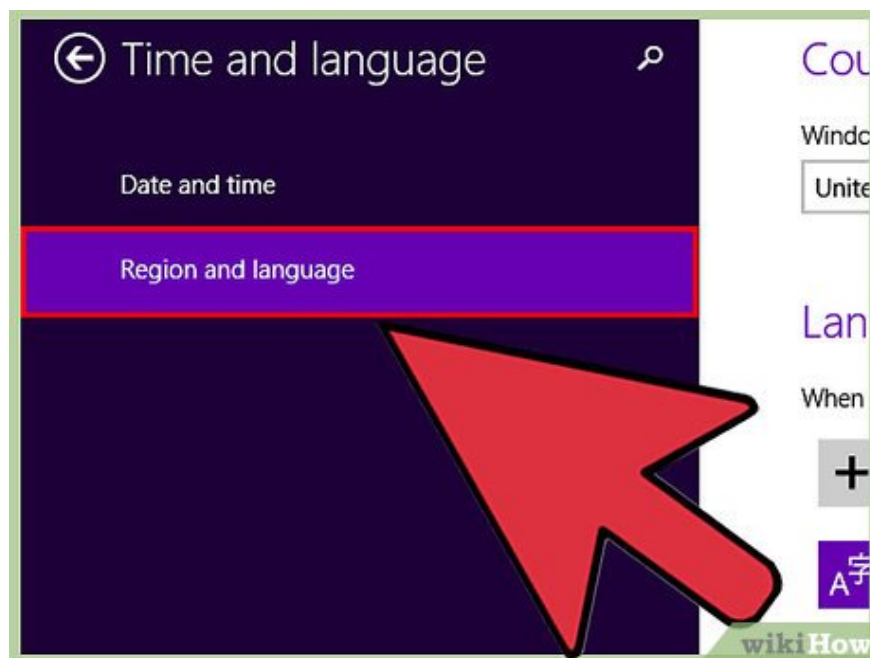

Click or tap **"Region and language."** Language options will appear.

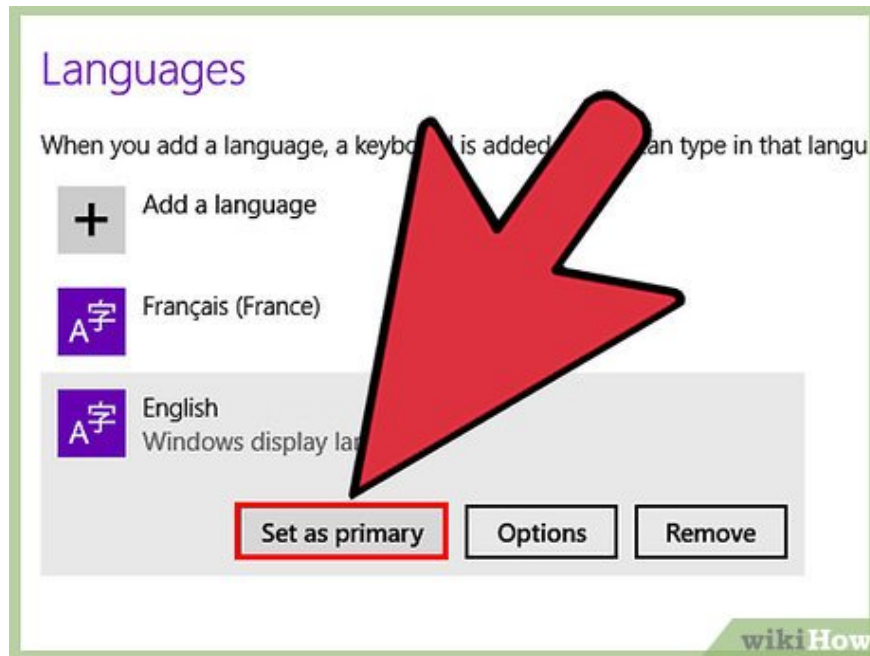

**Set the desired default language if you install multiple languages.** If you use multiple languages on your computer, they will all be listed here. Select the language you want to use as your default, then click the "Set as primary" button.

Note: This will change the display language to the top language the next time you sign in.

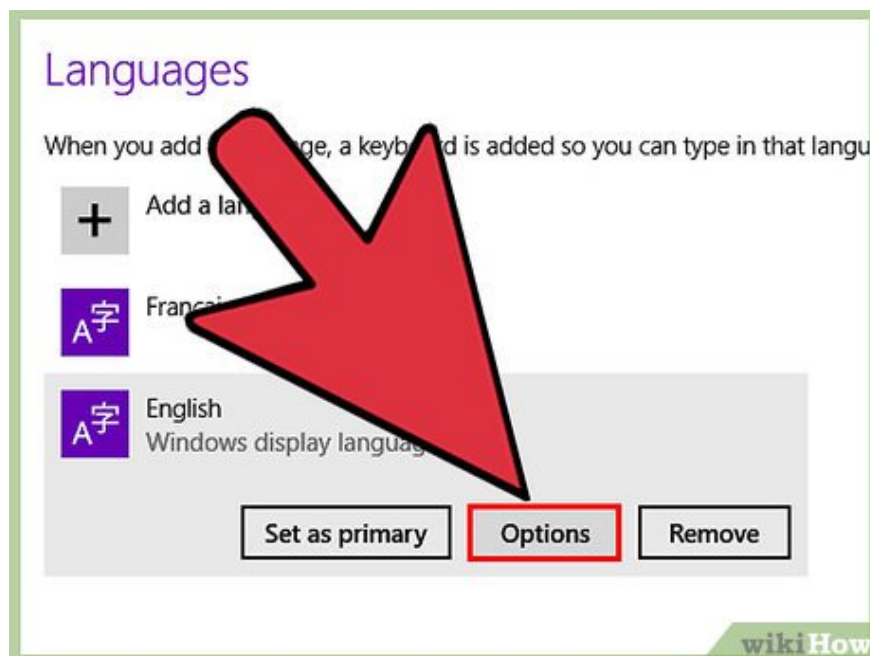

**Select the language you use and click "Options."** The installed language can have multiple active keyboard models. The installed keyboard will display at the bottom of the screen.

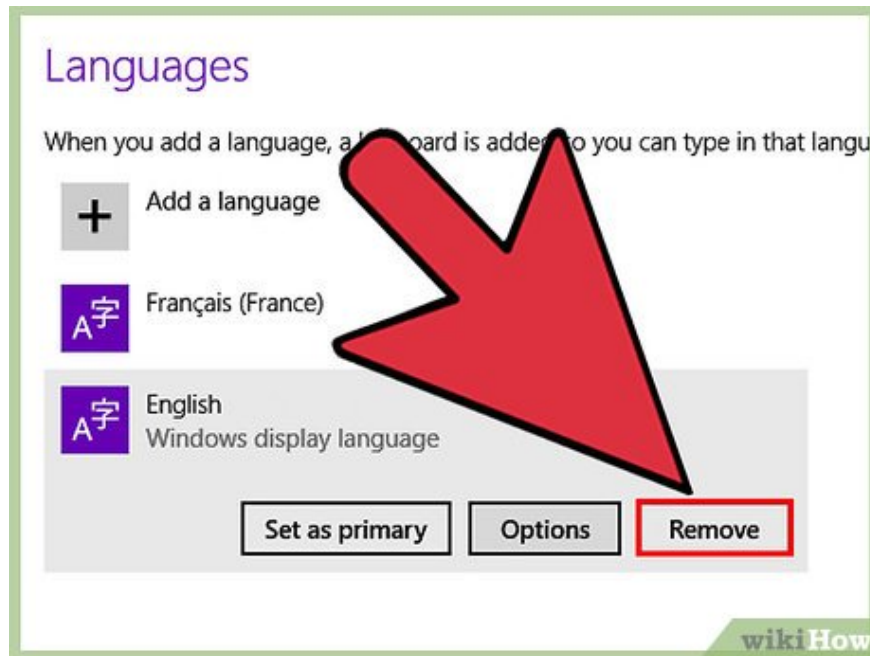

**Delete unused keyboards.** If there are keyboards in the list that you don't use, delete them so you don't make the wrong choice.

Select the keyboard you want to remove and click "Remove."

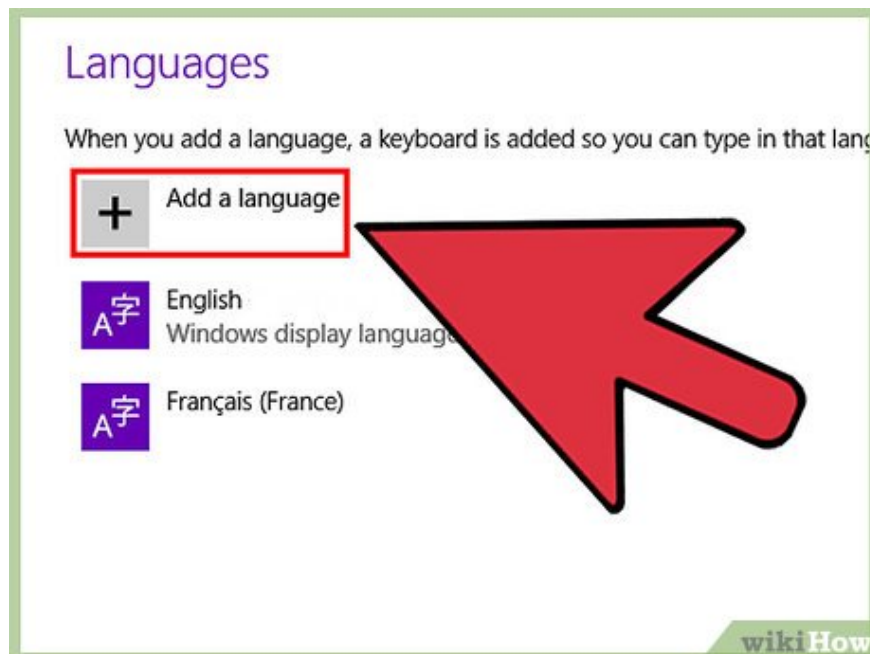

**Add the correct keyboard if not already installed.** If the keyboard layout you want to use is not listed, you can set it by clicking "Add a keyboard" and selecting it from the list.

**Windows 7 operating system and earlier**

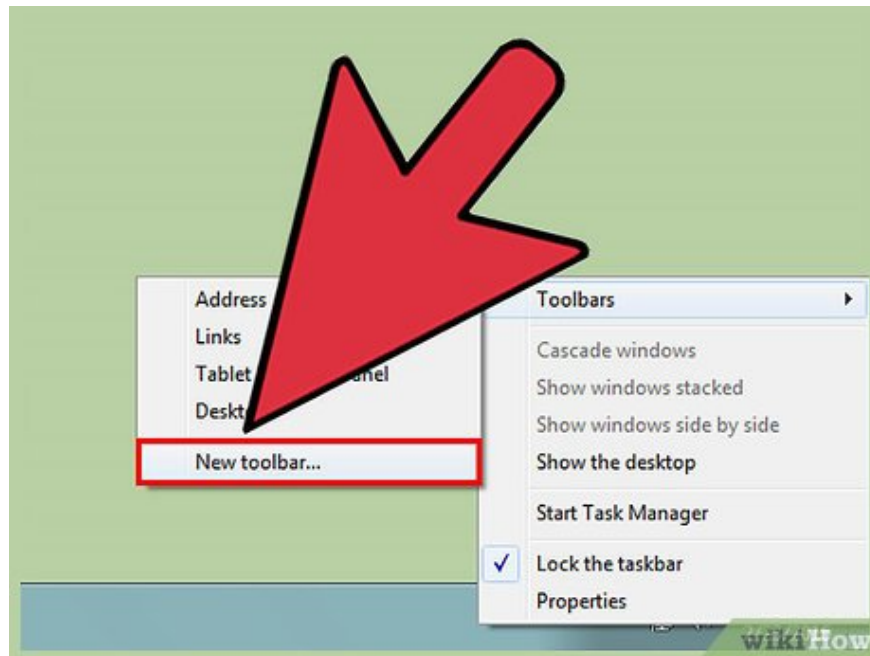

**Switch between installed keyboards.** If you want to switch between multiple installed keyboards, here are a few ways you can do it:

Click the input language button in the language bar, located next to the system tray. If you don't see it, right-click the taskbar and select "Toolbars" ? "Language bar".

Press ? Win+ Spaceto cycle between installed languages.

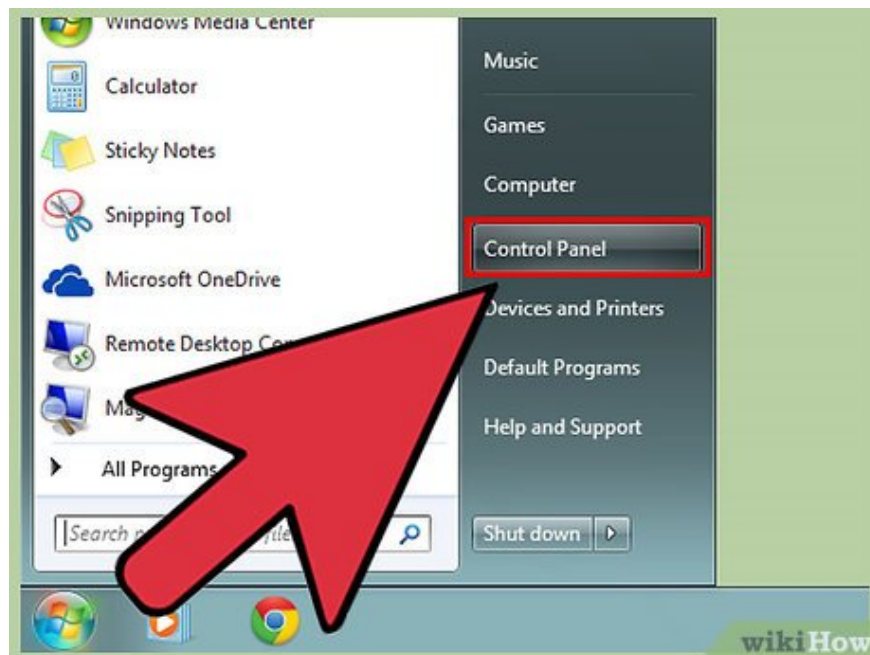

**Open the Start menu and select "Control Panel".** The Control Panel will open and you can delete the keyboards or install additional necessary features.



Select "Clock, Language, and Region" then click "Region and Language." A new window will appear.

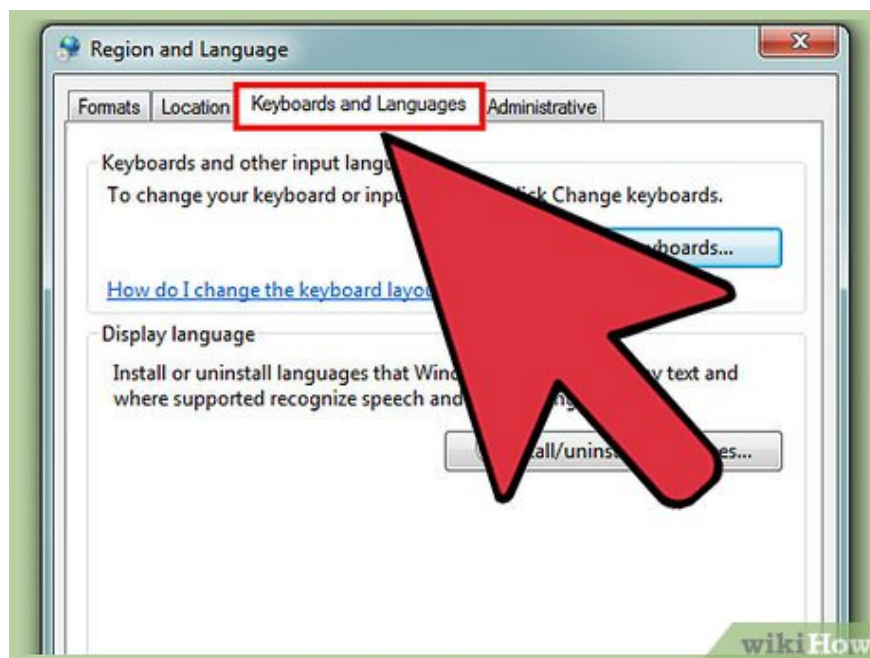

Click the "Keyboards and Languages" tab to open keyboard options.



Click "Change keyboards". A list of installed keyboards will appear in a new window.



Select the keyboard you want to use from the "Default input language" drop-down menu. This will be the language the keyboard uses for input.

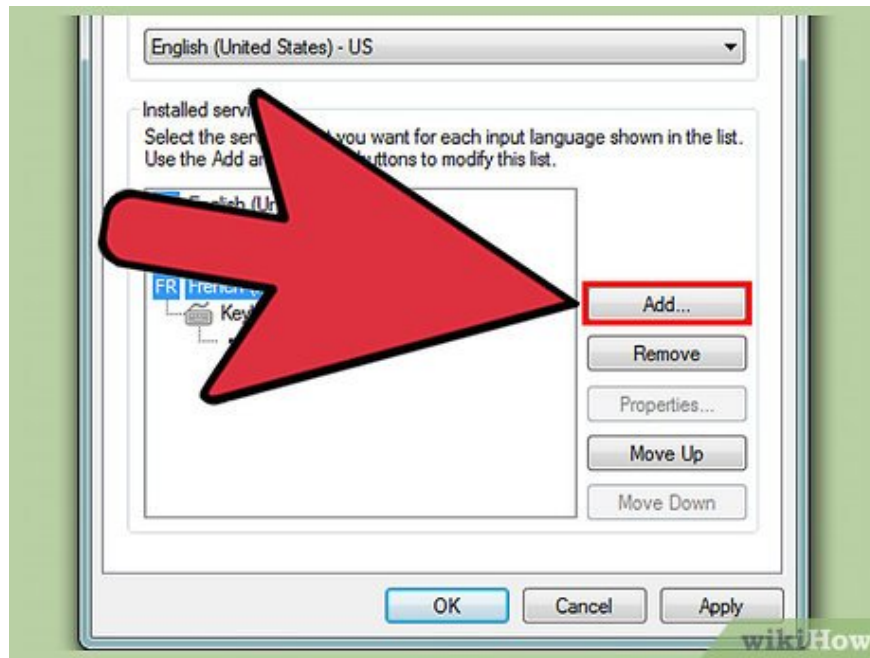

**Click the "Add" button and add the language if you don't already have one.** If your preferred input language is not available, click "Add." to browse through available input languages.

Once you find the languages you want to add, expand the folder tree and check the specific keyboards you want to install.

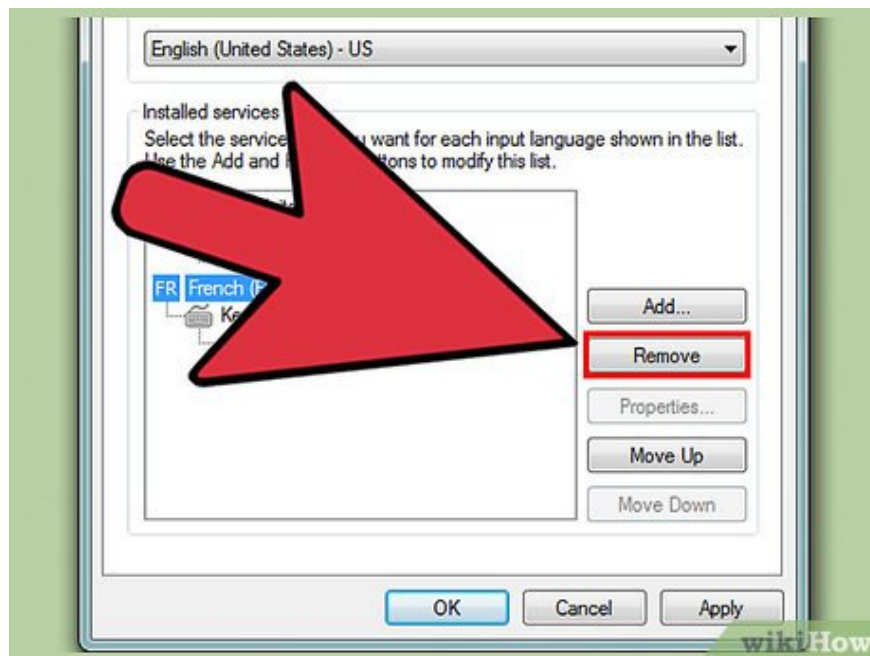

**Get rid of unused keyboards.** By excluding unused keyboards, you'll be less likely to accidentally select them:

Select the keyboard you don't use from the list of installed keyboards.

Click the "Remove" button to delete.

## Mac OS X operating system

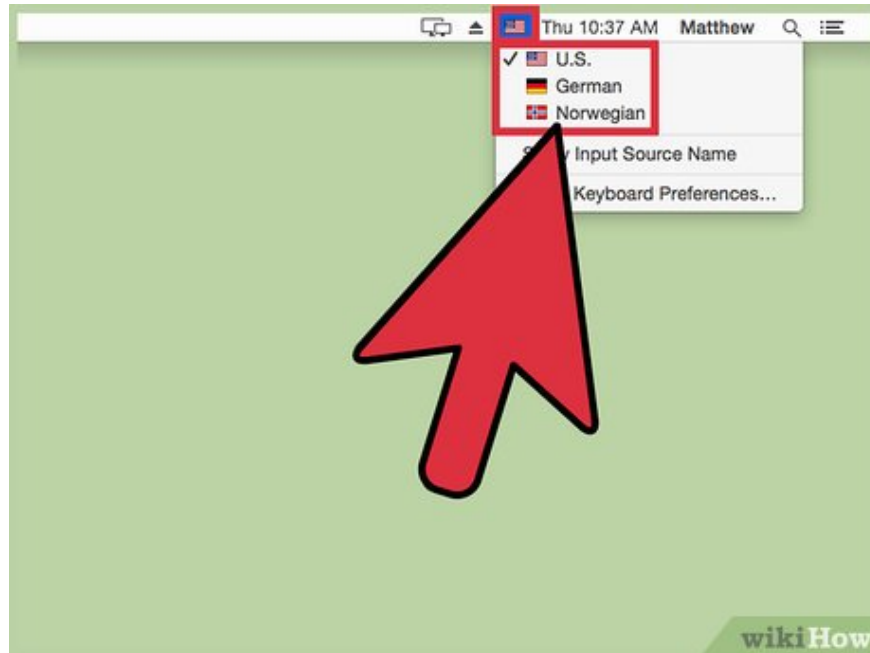

**Switch between pre-installed languages.** You can switch between the built-in languages ??in several different ways:

Click the flag icon for the language you want to select in the language bar.

Press ? Command+ Spacecycle between installed languages.

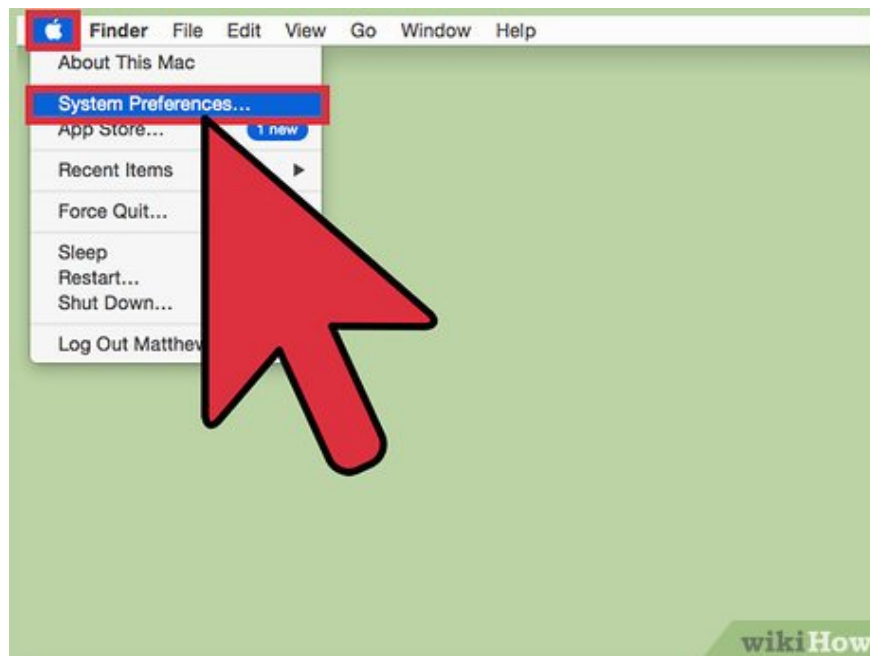

**Click the Apple menu and select "System Preferences."** The System Preferences menu will open, you can select the input language available on your computer.



Click the "Keyboard" option. Keyboard settings will appear.

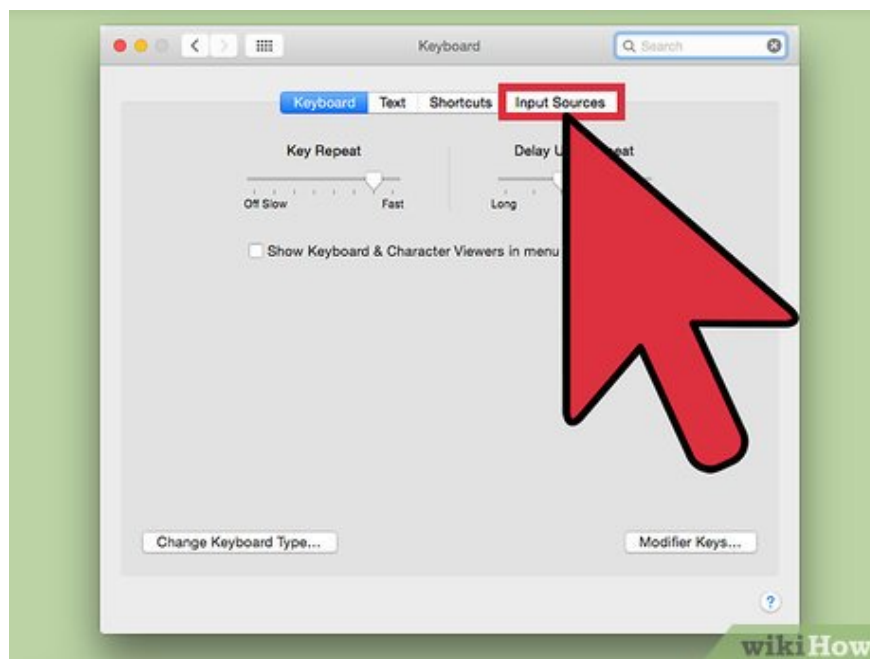

Click the "Input Sources" button to view and choose from installed languages.

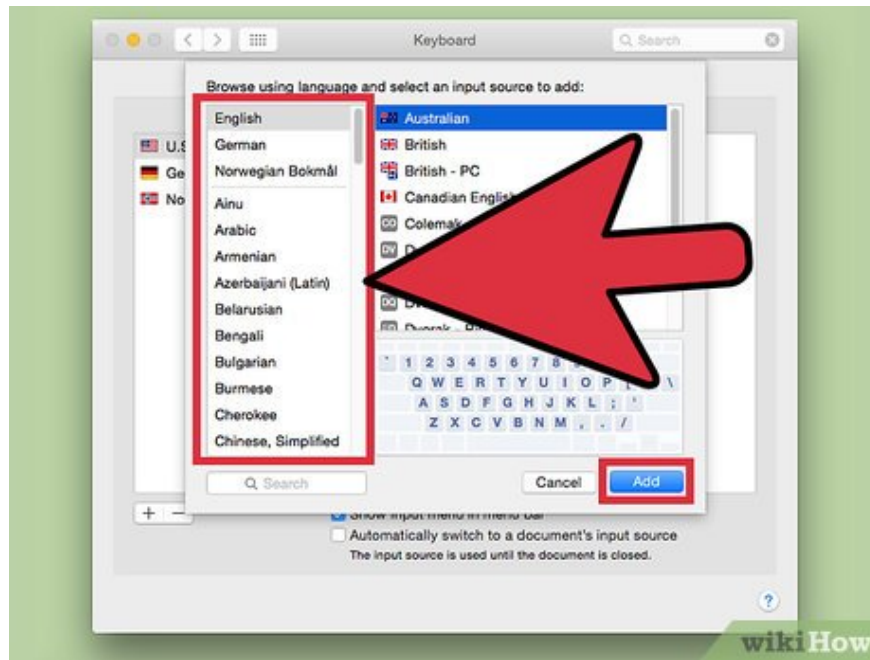

Check the boxes for the languages ??you want to enable. They will be selected as the input method.

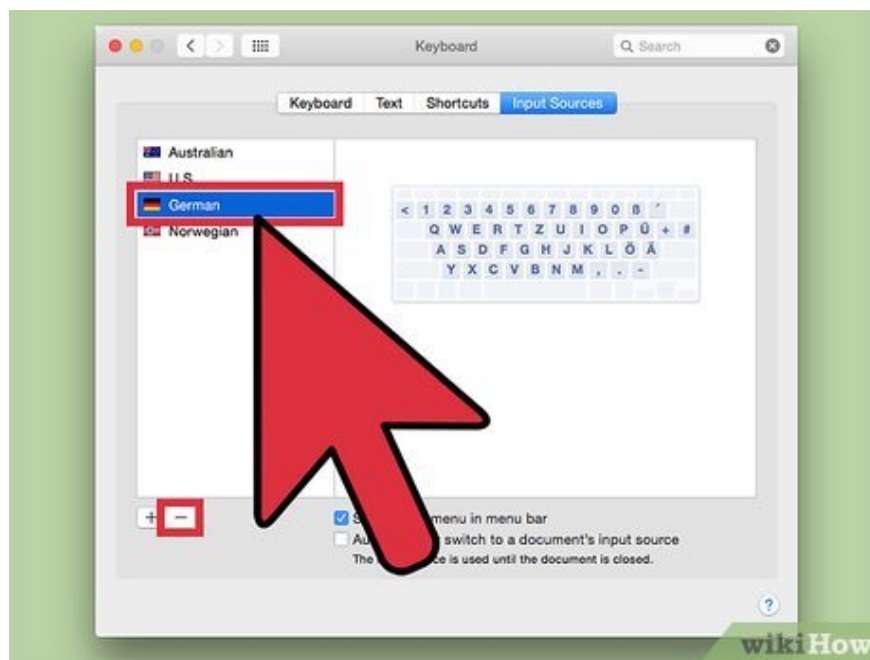

**Uncheck unwanted cells.** If you have many languages ??selected but do not use them, deselect them to limit accidental conversions.

You finished reading the article "**How to Fix Keyboard Input Wrong Character Error**" edited by the [TipsMake](#) team. We hope this article has provided you with many useful tech tips and tricks. You can search for similar articles on tips and guides. Thank you for reading and for following us regularly.