

How to fix Google Play Store white screen error

Google Play Store white screen error is definitely annoying because you will not be able to do anything needing the app store anymore, if this is the case, you should immediately apply the white screen fixes when into CH Play is shared below.

Google Play Store or Play Store is one of the busiest Google apps on an Android device and like other apps, it's also prone to crashes. While some users get errors like waiting to download, others can't even see the list of apps in it. When they open Play Store, all they see is a blank white screen.

As a result, you cannot download or update apps from the Google Play Store due to the white screen issue. Closing the application does not fix the problem. So what's the solution? Do you need to factory reset your device? No, at least before you try 13 ways to fix the **white screen of Google Play Store** are shared by TipsMake shortly.

13 ways to fix white screen error CH Play

1. Reboot the device

Before trying the more drastic solutions, you should start by rebooting your phone. If you are using Wi-Fi to download apps from the Play Store, restart your router as well. Then open Google Play Store and see if the white screen error has been fixed.

2. Check the date and time

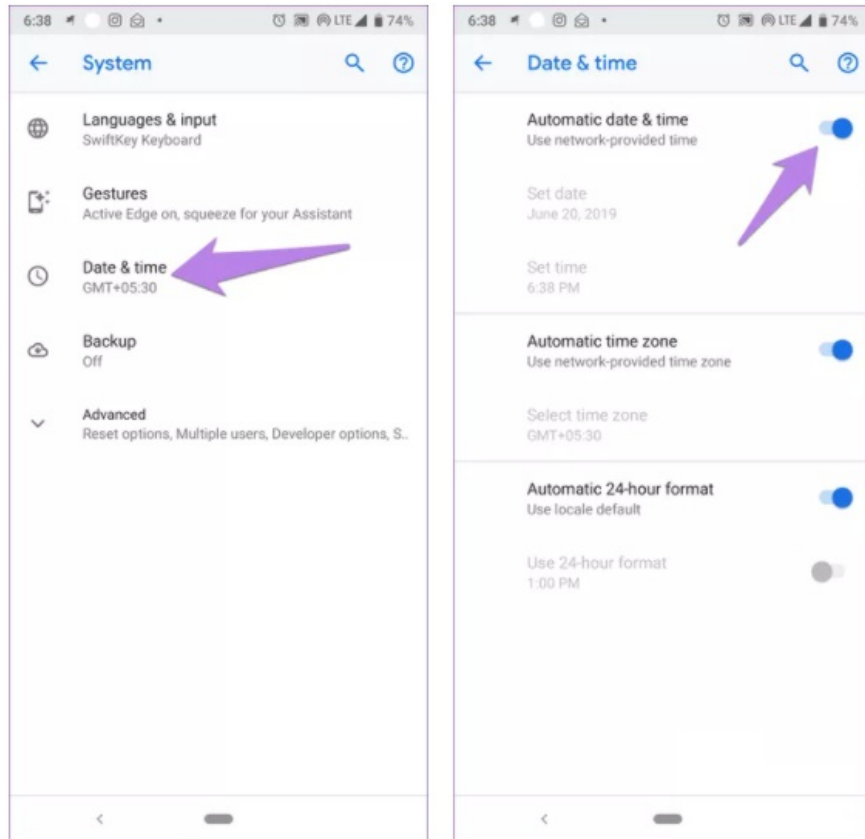

Many times, the problem arises due to the incorrect time on your phone. So check the date and time by going to Settings> System or General Management. Then, click on Data and time and reset the time to be correct. You can even turn on Automatic date and time for better results.

3. Turn on / off airplane mode

Turning on flight mode turns off all network connections on your phone. Doing so will fix network problems that could cause the Play Store not to load and thus show you a blank screen.

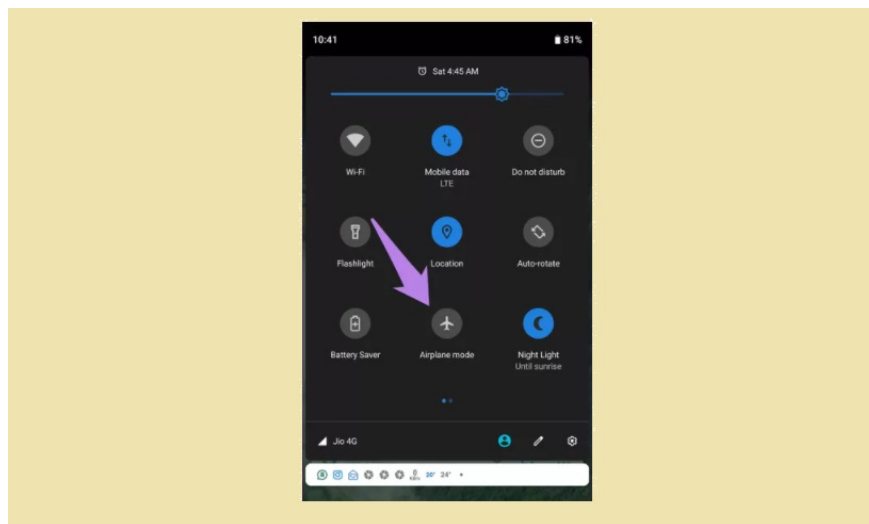

To turn Airplane mode on, go to Settings> Network & Internet (or Connections) and turn on Airplane Mode. Or simply open Quick Settings by swiping down from the top of your phone's screen and turn on airplane mode. Then wait a while and turn it off.

4. Switch network connection

You should try opening the Play Store on a different network. For example, if you're using Wi-Fi, switch to another Wi-Fi network or use cellular data, and vice versa.

5. Allows the use of data in mobile data

Occasionally, Play Store and other affiliated applications do not have permission to download apps or update via mobile data. That could be the reason for the white screen error when entering Play Store. To fix, do the following:

Step 1: Open Settings> Apps & notifications or Installed apps.

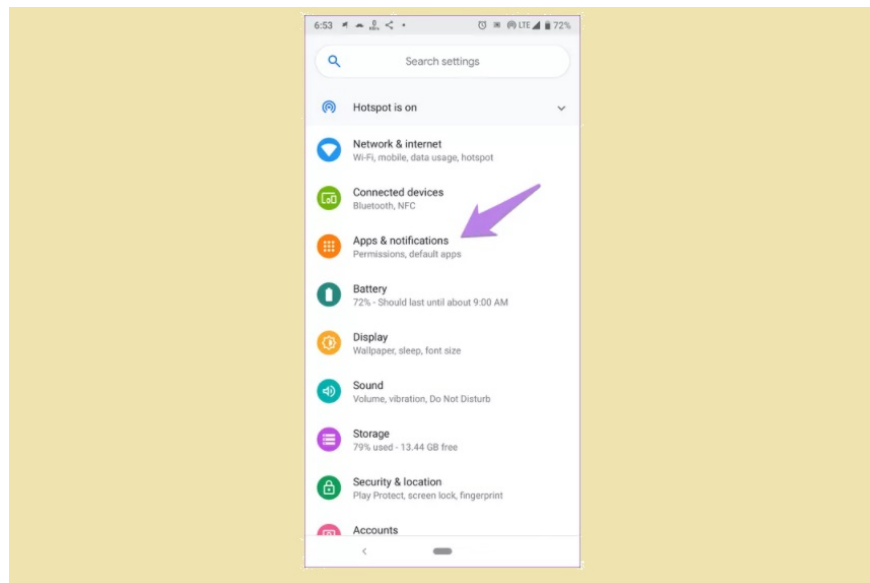

Step 2: In the All apps section, tap Google Play Store.

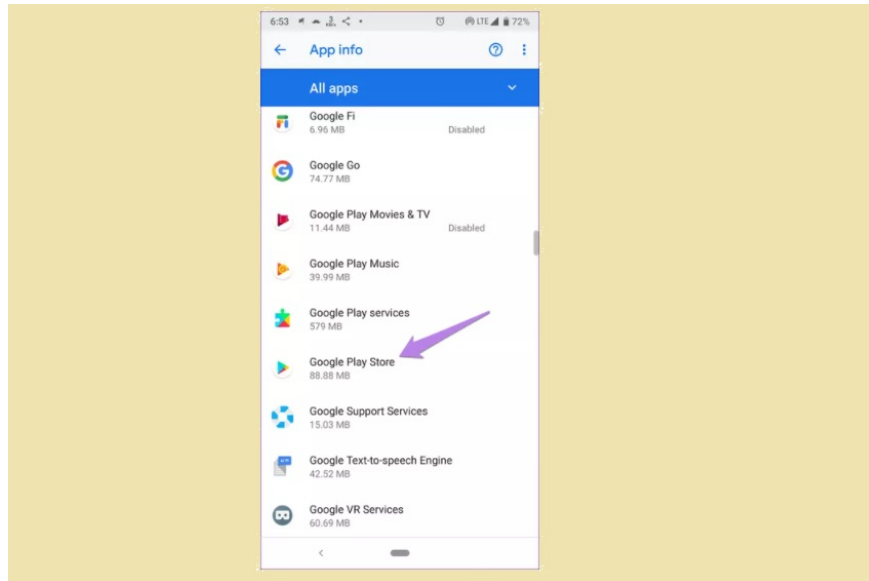

Step 3: Tap Mobile data & Wi-Fi (or Data usage) and turn on the Allow background data usage option.

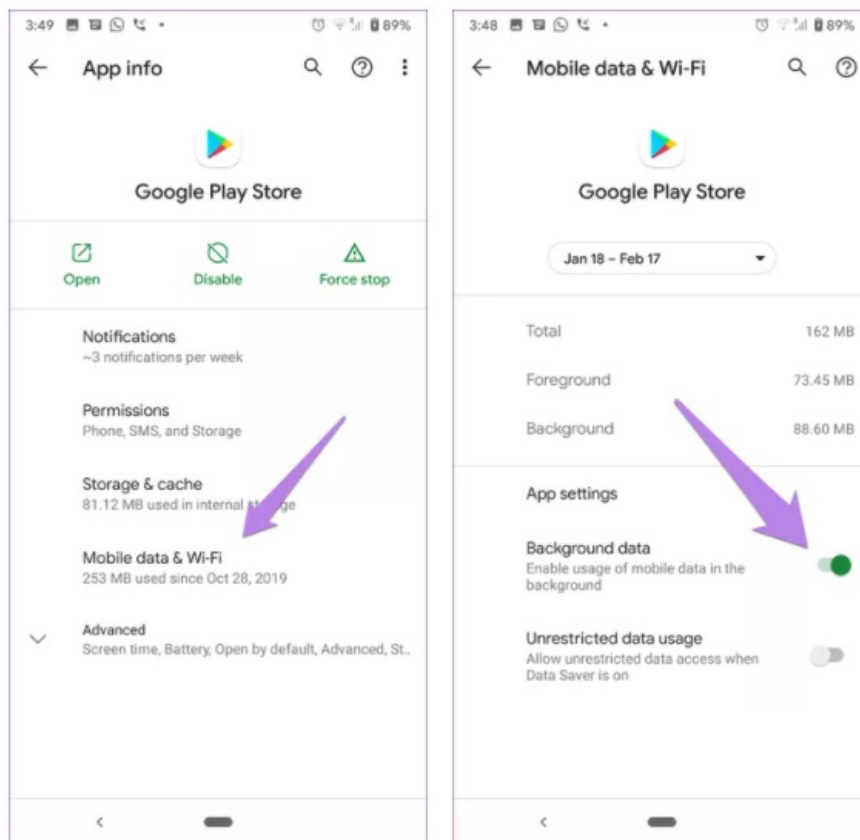

Step 4: Repeat the same steps as above for Google Play Services and the File app or file manager pre-installed on your phone. Finally, reboot the device.

6. Turn off VPN

Are you using a VPN on your phone? Disable it now and try opening the Play Store. Sometimes, VPNs and proxy networks interfere with the Play Store as well.

7. Clear cache and data

One of the fixes that can fix most Google Play Store related problems is to clear its cache and data. Start by clearing the cache first and check if the issue has been resolved. If that doesn't work, please proceed to delete the data. Don't worry, clearing the data or the cache won't delete installed apps or any other personal information on your phone. Deleting data will only reset the current settings in the Play Store app. You do the following:

Step 1: Open Settings > Apps & notifications or Apps.

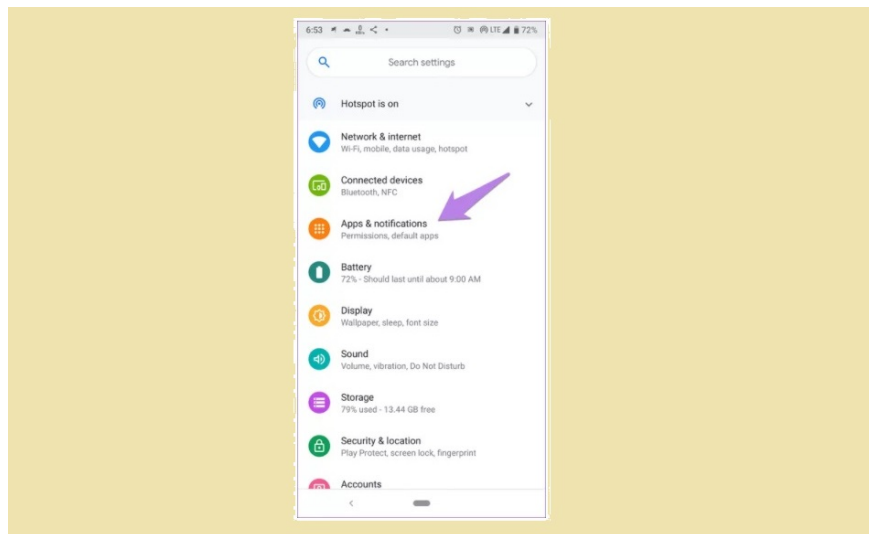

Step 2: In the All apps section, tap Google Play Store.

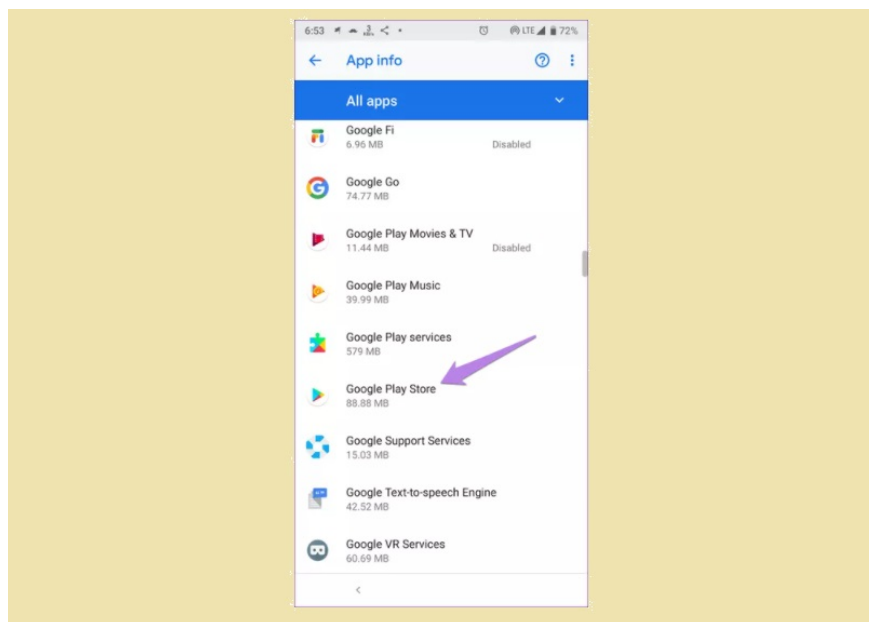

Step 3: Tap on Storage> Clear cache. Then, reboot the phone. If the error persists, tap on Clear storage or Clear data.

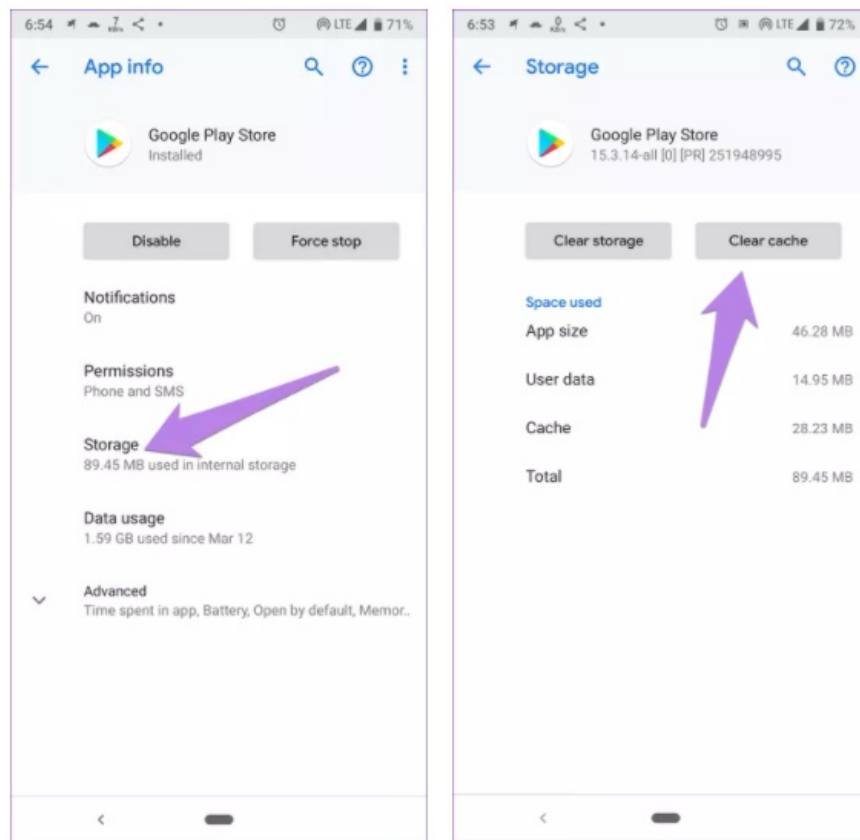

Step 4: Repeat steps for Google Play Services if the problem is not fixed.

8. Uninstall Google Play Store updates

You cannot uninstall Play Store as it is a pre-installed and system app, but you can uninstall its updates. Many Android users have fixed the Play Store black screen and white screen error when applying this approach.

Step 1: Go to Settings> Apps> Google Play Store.

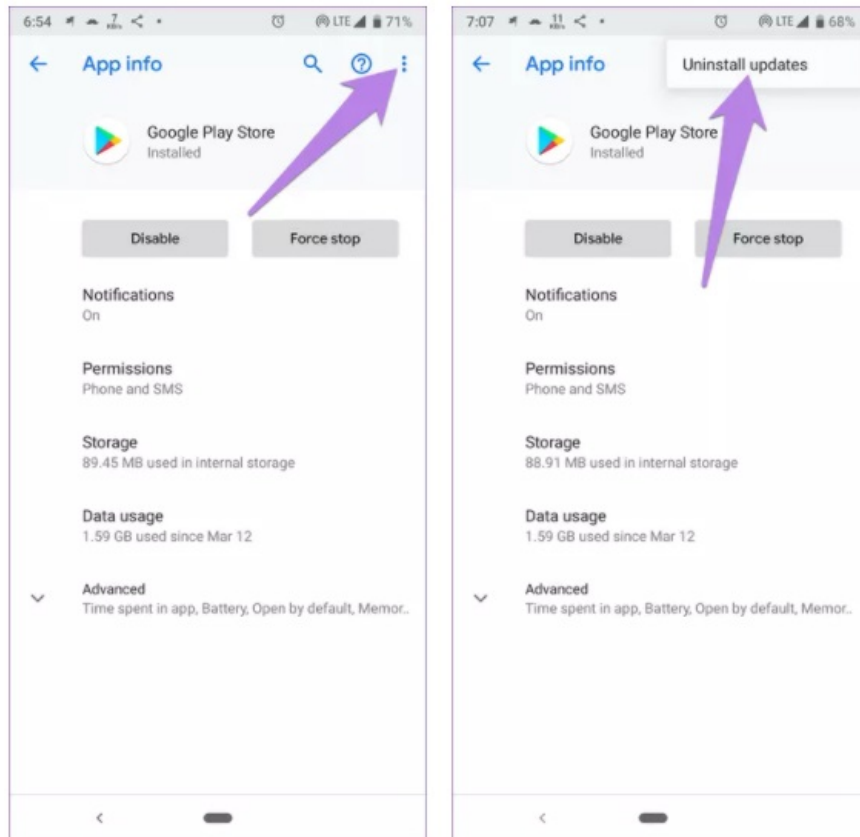

Step 2: Tap on the menu with 3 dots and choose Uninstall updates. Reboot your phone and wait 3-5 minutes for the Play Store to update automatically in the background.

9. Disable security apps

Do you use antivirus, cleaner, and booster apps? If so, try disabling or uninstalling them to see if that makes the Google Play Store working properly again.

10. Reset App Preferences

You should also try resetting the App Preferences on Android device. That won't delete any personal data but will reset all settings on the device to their defaults. Hence, if a problematic installation is the cause of the white screen issue on Play Store, it will be fixed. You do the following:

Step 1: Open Settings > Apps.

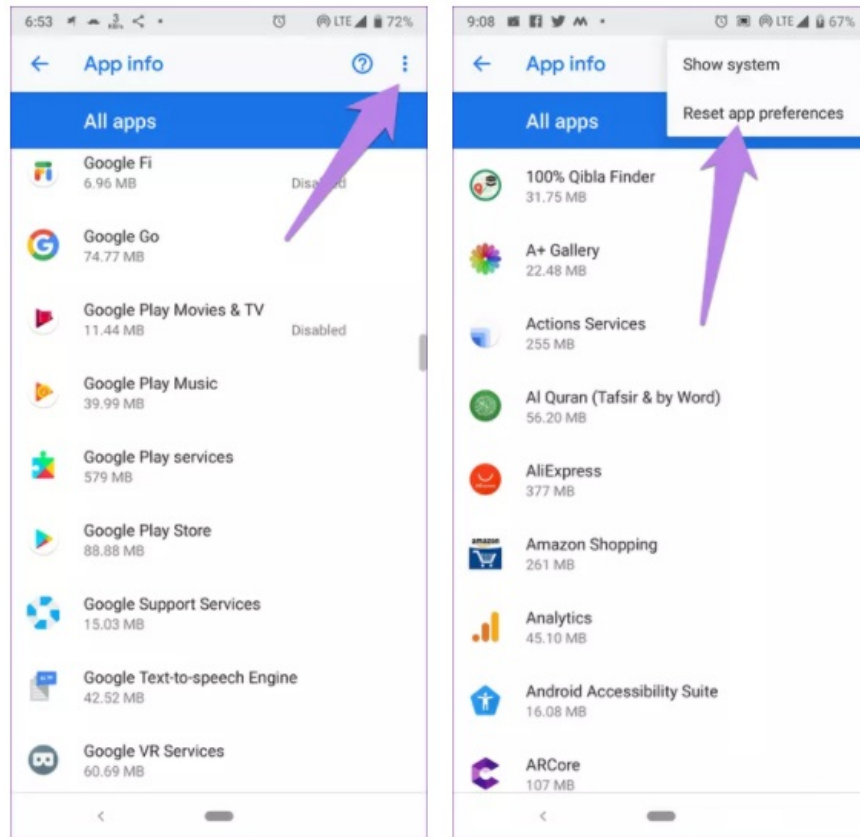

Step 2: Tap the 3-dot menu in the upper right corner of the screen and select Reset app preferences.

11. Update operating system

There may be incompatibility between the Play Store version and device operating system. So check if your phone has been upgraded to the latest version by going to Settings> System> Software update.

12. Manually update Play Store

Sometimes the problem could be with your current version of Play Store. Usually, the Play Store updates automatically. However, you can manually update the app store with these steps:

Step 1: Open Settings> Apps & notifications or Apps.

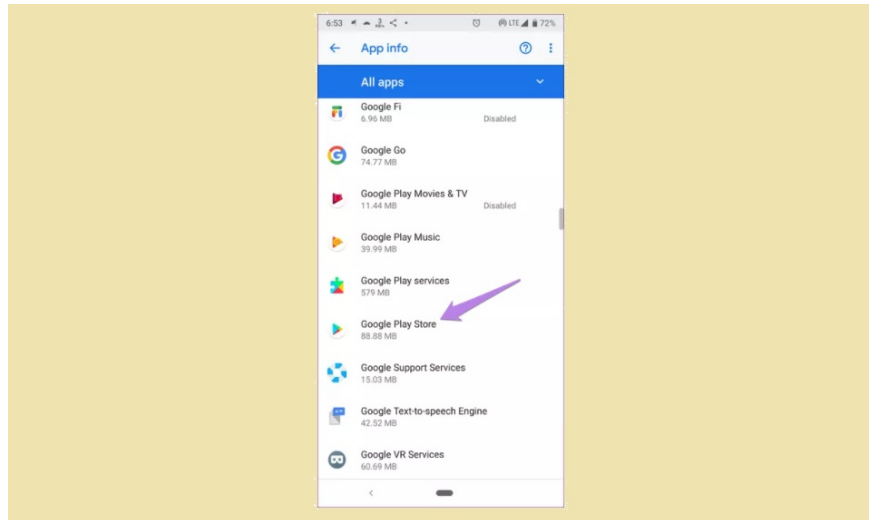

Step 2: In the All apps section, tap Google Play Store.

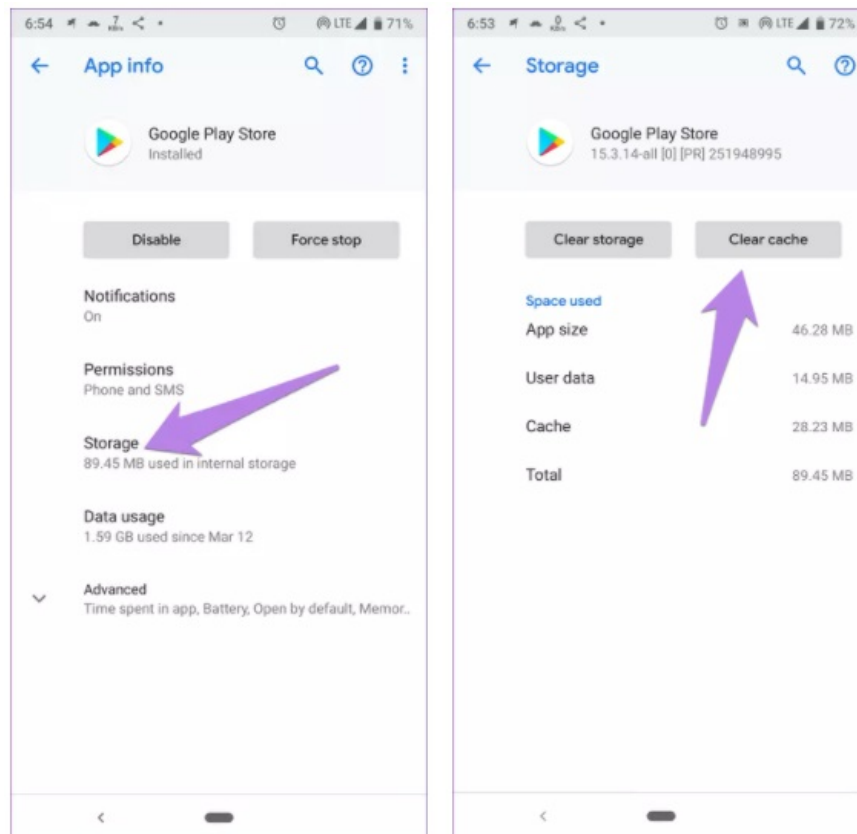

Step 3: Tap on Storage> Clear cache and Clear data. Then, reboot your device and wait about 2-3 minutes for the Play Store to update automatically.

13. Delete Google account

If the above methods don't work, you should remove your Google account from your phone. By going to Settings> Accounts, tap on Google account and press Remove account.

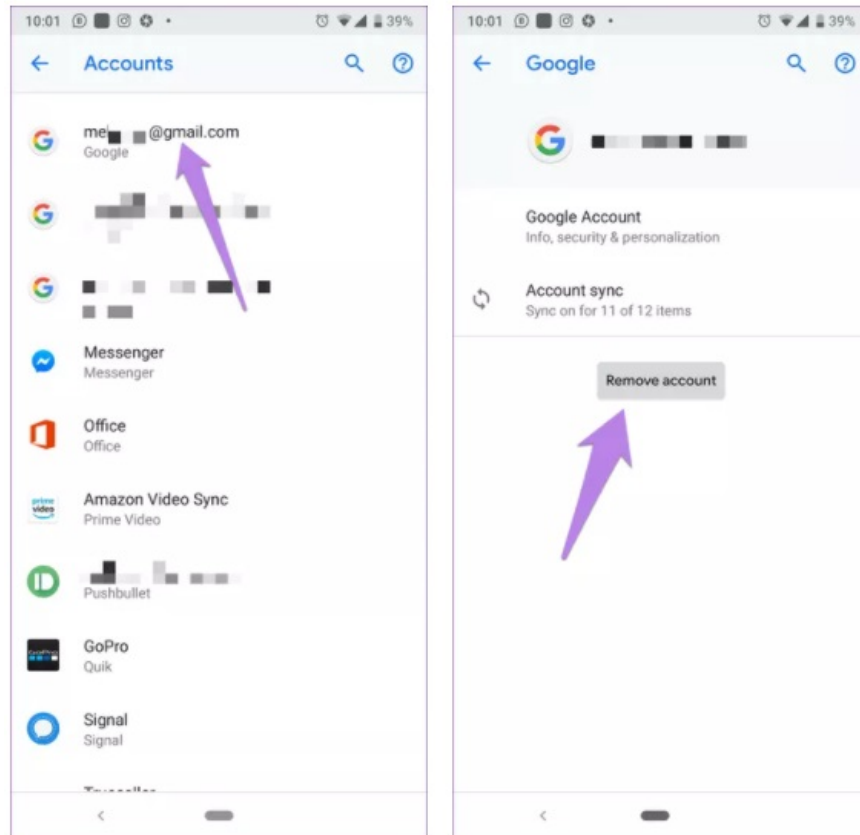

Similar to other applications on the phone when it fails, you can hardly determine the exact cause of the error to apply the right remedy immediately. Therefore, you should try the methods shared in the posts one by one until the app store is working properly again.

Good luck.

You finished reading the article "**How to fix Google Play Store white screen error**" edited by the [TipsMake](#) team. We hope this article has provided you with many useful tech tips and tricks. You can search for similar articles on tips and guides. Thank you for reading and for following us regularly.