

# How to Find a Saddle in Minecraft

In the game Minecraft, saddles are used to ride horses, mules and pigs. However, unlike many other things in the game Minecraft, although it feels necessary, you cannot make a saddle. Instead, you need to look for a riding saddle. If you have all the necessary equipment, you can find saddles in many chests scattered in dungeons and temples. If you have a lot of items, you can exchange emeralds with villagers for saddles. Those who are passionate about fishing also have a chance to catch a saddle. Players who want to get their saddles right away can use a few simple cheats.

## Search the saddle in the chest



**Search for rare chests on your journey.** Saddles *cannot* be crafted, so one of the best ways to find one is to open every chest you come across. In most chests you find, saddles have a low probability of appearing. The chances of being lucky enough to find one are higher in certain areas of the world.



**Enter the dungeon.** You will be able to find the best saddles in the dungeons scattered throughout your world. Chests in dungeons have a 54% chance of having a saddle dropped. You know you're in a dungeon when you see cobblestones + a moss-covered ceiling, floor, and stone walls. In dungeons there are usually undead, bones, spider spawners, and a chest or two. Although very rare, it is still possible to find a dungeon without chests. If there are two chests, the probability of luck will be higher and you will have a chance to find a saddle in one of those two chests.

Dungeons can appear anywhere in the overworld.

Since Minecraft version 1.10, the chance of dropping a saddle is 29%.



**Rush into the Nether and search for the hellish fortress.** Nether fortress is also a location where saddles have a higher chance of dropping from chests. To enter hell, you need to build a Nether portal with obsidian blocks. You can learn how to make a hell gate in the game Minecraft for more detailed information. Hell is a dangerous place, so you need to make sure you bring plenty of powerful equipment and necessary supplies.

You will have a 40% chance of finding a saddle in the chests of the hell fortress. This probability will decrease to 35% in version 1.9.



**Search for desert temple.** This structure appears in the desert area, and the temple floor is always located at Y:64. That means the temple will be partially or completely covered by sand.

When searching for the temple, you need to find the blue clay block in the middle of the floor. When you dig this block, you will find a secret room containing four chests. The chance of each chest dropping a saddle is 15%, but will increase to 24% in version 1.9. This means that you will almost certainly find a saddle from those four chests.

Watch out for TNT explosive traps when you enter the secret room. When you first enter, don't drop anything to handle the pressure plate, because all items will explode.



**Search for the blacksmith's work in the village.** Villages often have a high probability of creating blacksmith works. This building usually has a chest with a 16% chance of finding a saddle inside.



**Search the jungle temple and the abandoned mineshaft.** These two locations often include chests that can contain saddles, but the probability of finding them is only about 15% for each chest in those locations. The jungle temple contains two chests covered in traps, while the abandoned mine shaft may include multiple chests placed in a cart depending on the size of the mine shaft.

In version 1.9, saddles will no longer appear in abandoned mines.

**Trade for a saddle**



**Find a leather worker in the village to make a trade.** If you're playing the PC or console version of Minecraft, you're allowed to trade items for emeralds and vice versa with villagers you encounter in every village around the world. . After completing the available exchanges, you will open up many new trading opportunities. The village leather craftsman (wearing a white apron) can trade you a saddle if you choose the third-tier trade option.

Cannot be traded in Minecraft PE version.

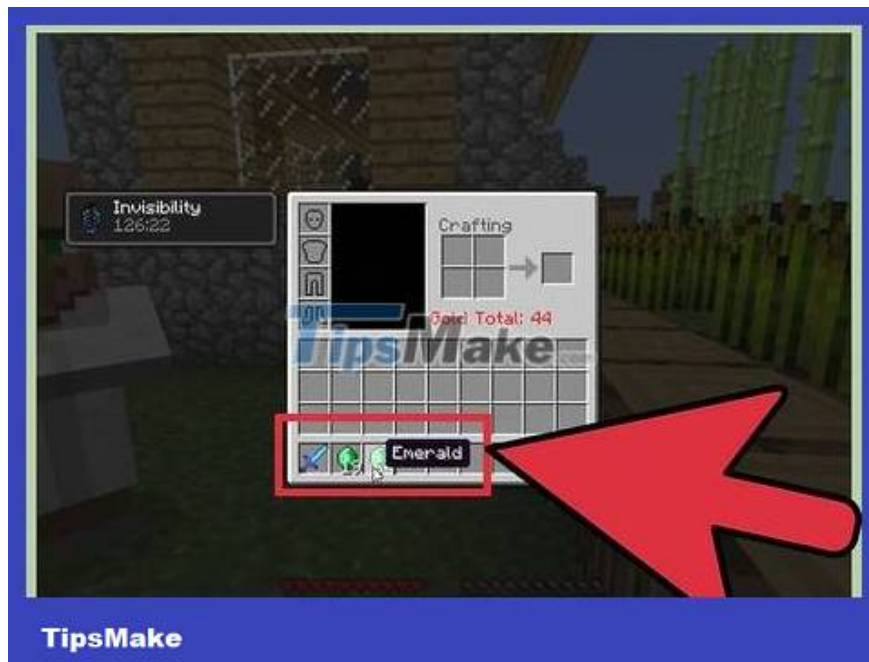

**Collect some emeralds.** You need 9 to 16 emeralds to unlock the ability to buy a saddle, then another 8 to 10 emeralds to buy a saddle. Emeralds can be found while mining, taken from chests, or while trading with other villagers. You can learn how to find emeralds in Minecraft for some tips on finding emeralds while digging.



**Open the barter interface with leather artisans.** Once you have a few emeralds in hand, right-click on the leather craftsman to open the trade interface.



**Use 2 to 4 emeralds to buy leather pants.** Close the interface after making the exchange. This causes leather artisans to move to the next level of bartering.



**Open the exchange interface again and buy a leather tunic.** This will cost you between 7 and 12 emeralds. Make sure to close the exchange interface again to proceed to the next level.

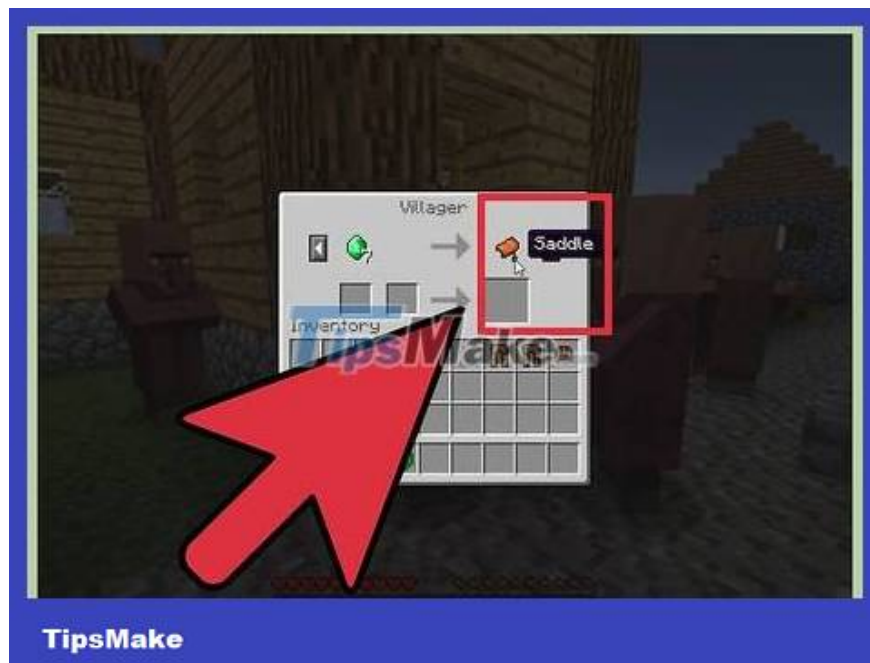

**Open the trade interface a third time to see the saddle.** Leather artisans will now sell saddles for 8 to 10 emeralds. Buy a saddle if you have enough gems.

**Try to saddle up and ride**



**Keep an eye on your saddle while fishing.** Although the probability is low (less than 1%), it is possible to catch a saddle while fishing. You probably wouldn't expect this to be your primary method of getting a saddle, but if you fish often you may come across one.



**Manufacturing fishing rods.** You can make a simple fishing rod from three sticks and two pieces of string. Sticks can be made from wooden planks, while fibers can be made from cobwebs and spiders.

Place the three sticks diagonally, from the bottom left of the crafting window to the top right. Place the two pieces of yarn in the remaining two positions of the right column.



**Access any body of water.** You can fish in any body of water, and the fishing results will not change regardless of where you are standing.



**Drop the sentence.** Use your fishing rod to cast your line in the water. Pay attention to the fishing buoy to decide when to pull the fishing rod.



**Pull the fishing rod when the float is high and the fish sinks into the water.** This proves that you have caught something. Jerking the fishing rod at the right time will cause what you've caught to fly straight towards you.



**Apply enchantment to your fishing rod with the Luck of the Sea item.** This pressing helps increase the probability of finding valuable items when fishing. Step three of this compression process gives you a 1.77% chance of catching a saddle, up from 0.84%.

Cast with Lure if you're trying to fish for saddles or other rare items, as this will increase your chances of success.

You can learn how to make a pressing board in the game Minecraft to learn more detailed information about the pressing process.

## Cheat to get a saddle



**Turn on cheat mode.** To get the cheat options, you need to enable cheats for your world. There are two ways to enable cheats depending on whether you have created your world or not:

While creating a new world, you can enable cheats from the Create World menu.

If you have already created your world, open the Pause menu and select "Open to LAN". Turn on "Allow Cheats".



**Switch game mode to creative mode to easily get the saddle.** The easiest way to cheat and get a saddle is to open your world in creative mode and place a saddle right next to your character.

To convert, open your chat window (T key) and type the command `/gamemode c`. You are then allowed to select the saddle from the list of available items and place it in your world. When you switch back to survival mode (by command `/gamemode s`), you can pick up the saddle to use.



**Treat yourself to a riding saddle by typing the command.** You can use Console commands to create a saddle in your inventory. Open the chat box by pressing the key T and then type the following command to receive a riding saddle:

```
/give tênng??ich?i saddle 1.
```



**Summon a tamed horse with a saddle.** If you don't want to go through the trouble of searching for a horse to tame, you can use the cheat feature to create a complete horse with a saddle. Open the chat box by pressing T, then type the following command:

```
/summon EntityHorse ~ ~ ~ {Tame:1,SaddleItem:{id:329,Count:1}}
```

## Use a saddle

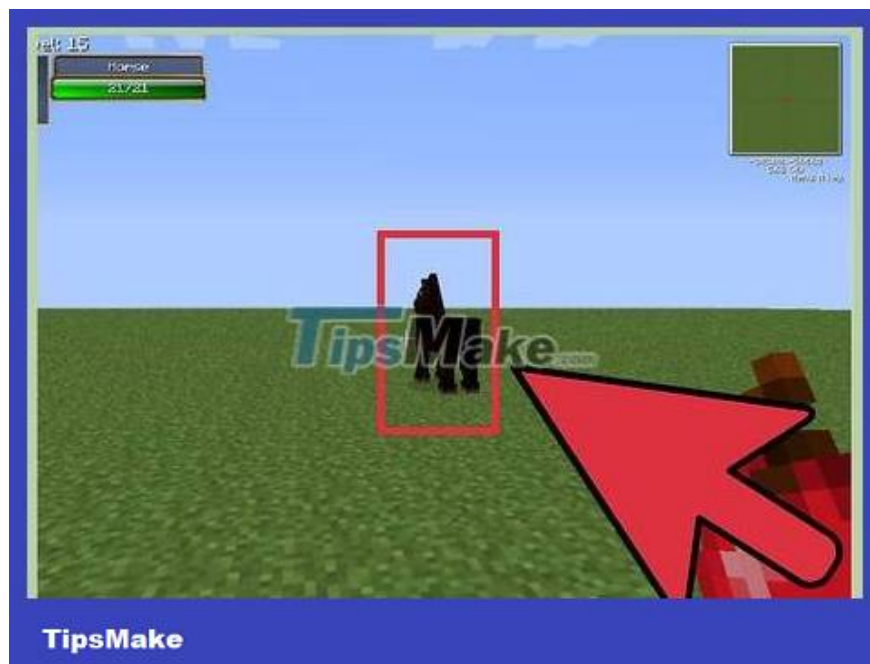

**Tame a wild horse by approaching it and using your bare hands.** You need to get on the horse's back and there's a good chance you'll be thrown off. After a few tries, the horse will be willing to let you ride on its back and reveal heart-shaped emotions.



**Open your inventory while on horseback.** Make sure you have a saddle ready to use.



**Place a saddle in the saddle position right next to the horse image.** Now you can ride your horse around by pressing the control keys as usual. Horses can charge their jumps when you press and hold the Jump key.



**Remove the saddle.** To remove the saddle from the horse, you need to select the horse and take the saddle out of the inventory.



**Ride a pig.** Horses aren't the only animals you can ride! You have the right to put a saddle on a pig and ride it around the world:

While holding the saddle in your hand, click on the pig you want to saddle. The saddle will be worn on the pig forever.

Control the saddled pig with a carrot on a stick. A moment later, the pig will be able to run away 5 blocks per second.

You cannot remove the saddle from a pig without killing it.

You finished reading the article "**How to Find a Saddle in Minecraft**" edited by the [TipsMake](#) team. We hope this article has provided you with many useful tech tips and tricks. You can search for similar articles on tips and guides. Thank you for reading and for following us regularly.

---