

How to enable/disable battery saving mode on Windows 11 laptop

Windows 11's Battery saver mode is a feature designed to extend the battery life of your laptop.

Windows 11 Battery saver is a feature designed to extend the battery life of your laptop. When enabled, the Battery saver feature reduces power consumption by reducing the device's performance and limiting background activities. Users can manually configure various parameters of the battery saver mode in Windows settings. Here are instructions on how to enable and disable Windows 11 battery saver mode.

How to manually turn on/off battery saving on Windows 11 laptop

Use the taskbar to turn on Windows 11 battery saver

First, in the system tray, **click on the WiFi icon** to display the interface with customization tools. Now you just need to **click on the Battery saver icon to turn on battery saving mode** on Windows 11 laptop.

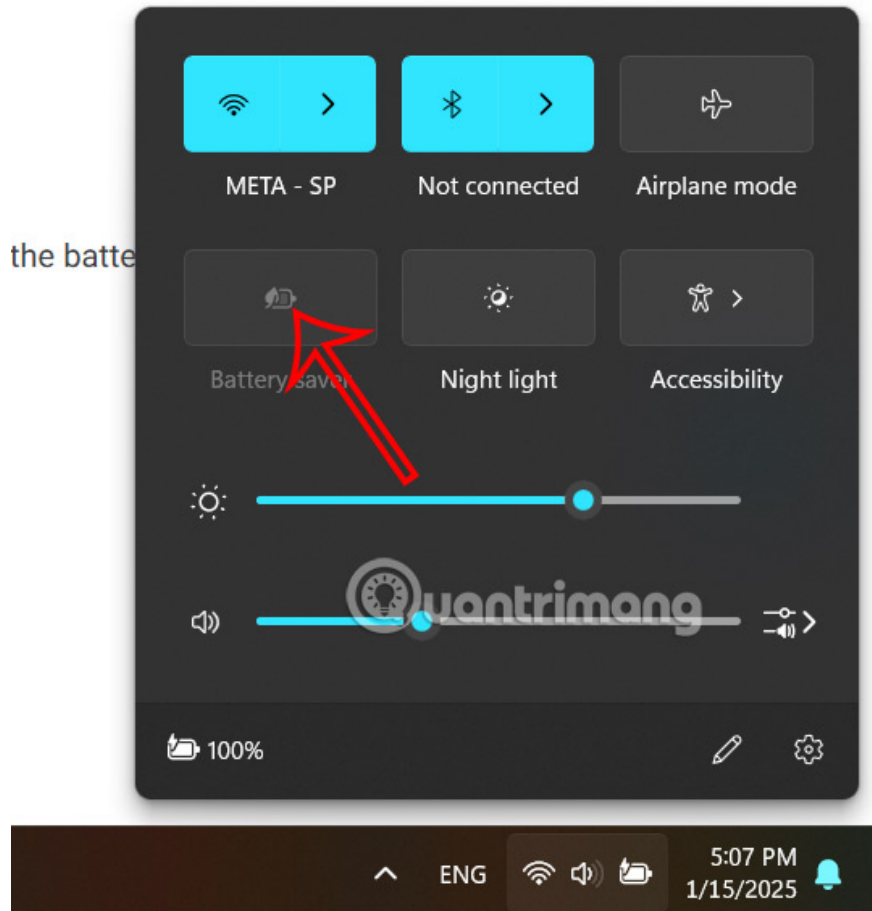

Turn on/off battery saving on Windows 11 laptop via Settings

Step 1:

First, press the **Windows + I** key combination to access Settings, then click on **System** in the left pane and **select Power & battery** in the right column.

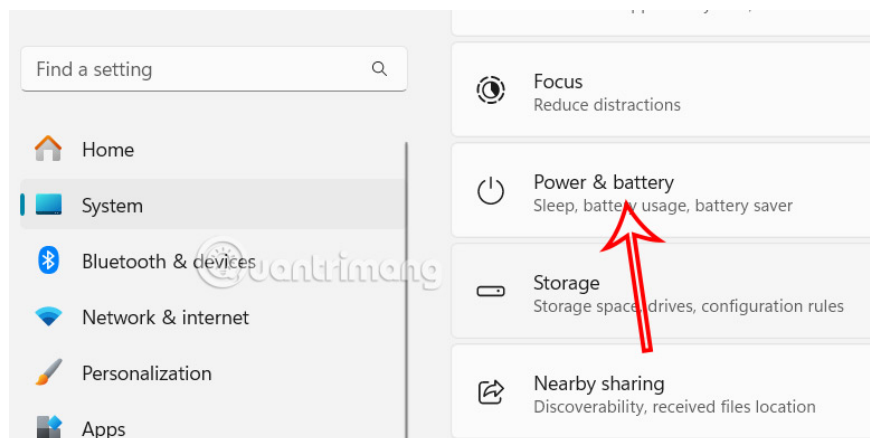

Step 2:

In this custom interface, we continue to click on **Battery saver in Battery** .

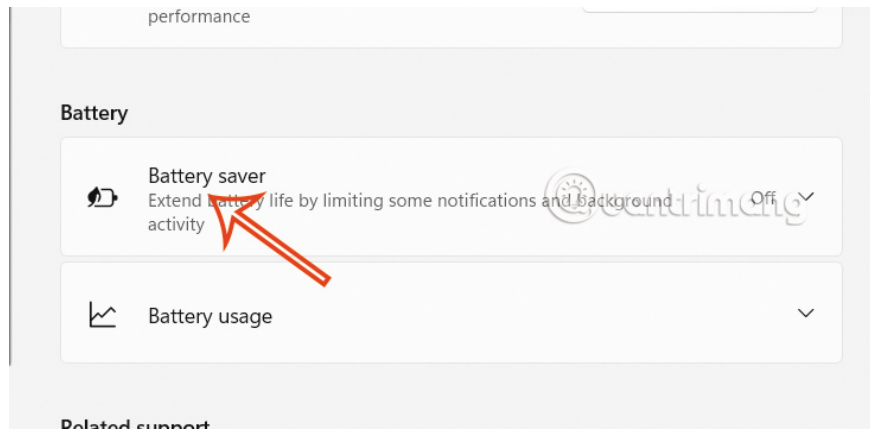

Then the user needs to **switch to Turn on now mode** to enable battery saving mode on Windows 11.

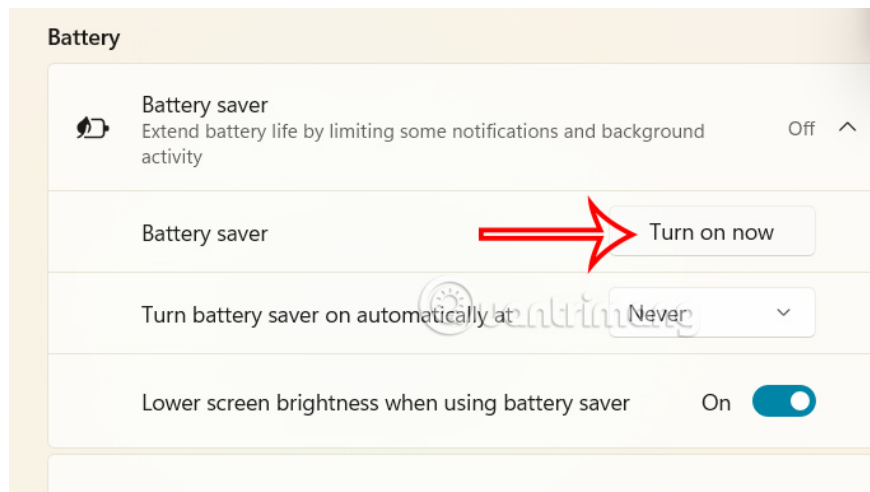

How to turn on battery saving on Windows 11 automatically

In Windows, you can set battery saver mode to automatically turn on or off, eliminating the hassle of having to set it manually every time.

Turn on automatic battery saving via Settings

In the Battery saver Windows battery saving mode customization interface, at the **Turn battery saver on automatically at** line, we **select the computer battery capacity %** to automatically put the laptop into battery saving mode.

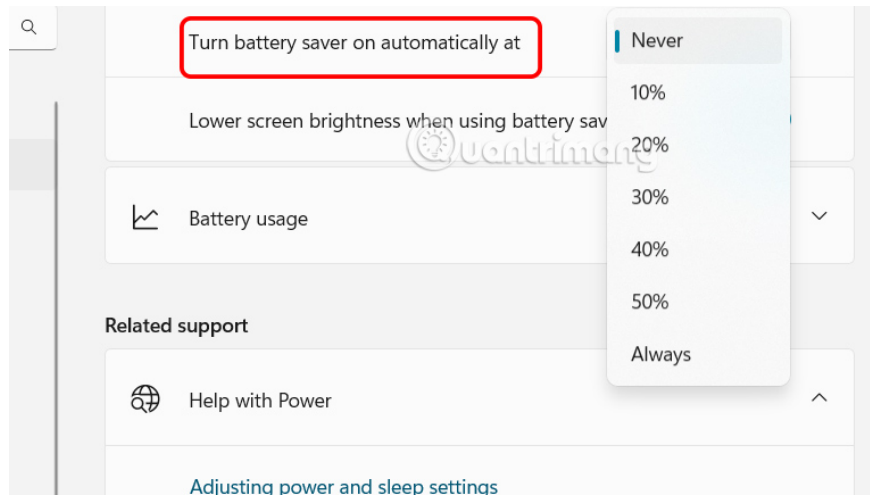

Using Windows PowerShell

Step 1:

First, you **enter the keyword PowerShell** in the search box on your computer and then insert it into the results.

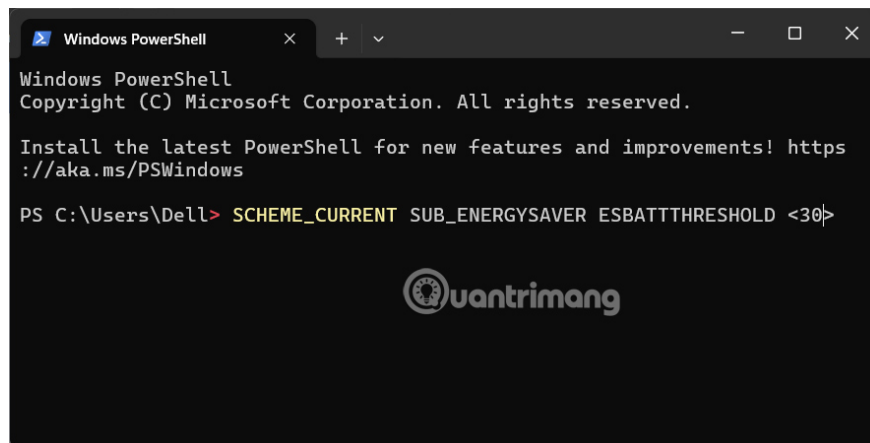

Step 2:

In the new interface, the user pastes the following command and presses Enter to run.

```
powercfg /setdcvalueindex SCHEME_CURRENT SUB_ENERGYSAVER ESBATTTHRESHOLD
```

Note **at is a number from 0 to 100** . When you set it to 0, it means battery saver is off, when you set it to 100, it means battery saver is always on, and when you set it to 20, it means battery saver will automatically turn on when there is still 20% battery left.

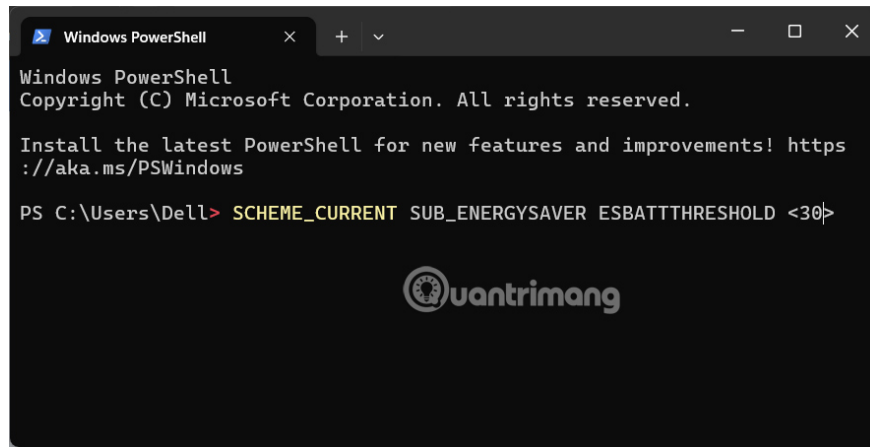

```
Windows PowerShell
Copyright (C) Microsoft Corporation. All rights reserved.

Install the latest PowerShell for new features and improvements! https://aka.ms/PSWindows

PS C:\Users\Dell> SCHEME_CURRENT SUB_ENERGYSAVER ESBATTTHRESHOLD <30|>
```

The screenshot shows a Windows PowerShell window with a dark background. The title bar reads "Windows PowerShell". The terminal output includes the standard PowerShell copyright notice and a message about installing the latest version. The command being entered is `SCHEME_CURRENT SUB_ENERGYSAVER ESBATTTHRESHOLD <30|>`. At the bottom of the terminal, there is a watermark logo for "uantrimang".

You finished reading the article "**How to enable/disable battery saving mode on Windows 11 laptop**" edited by the [TipsMake](#) team. We hope this article has provided you with many useful tech tips and tricks. You can search for similar articles on tips and guides. Thank you for reading and for following us regularly.
