

How to enable Near Share on Windows 10

Windows 10 has a new feature for easy file transfer to any computer. It is called Near Share, and here are steps to enable this feature in version 1803.

On Windows 10, "Near Share" is a new feature that allows users to share any file type and web link for nearby devices using Bluetooth or Wi-Fi connectivity.

If you've ever used Apple's AirDrop, you will feel familiar with the Near Share feature of Windows 10. When you need to quickly send a report to your boss or send a link, a screenshot for that one is near you. This feature makes it easier to transfer content without sending email attachments, using cloud storage services or setting up file sharing. In this article, you will learn how to enable Near Share on Windows 10 (version 1803).

How to enable Near Share on Windows 10

1. How to enable the Near Share feature using Settings
2. How to enable the Near Share feature using Action Center

How to enable the Near Share feature using Settings

Follow the steps below to enable Near Share feature on desktop, laptop or tablet computer.

Step 1: Open **Settings**.

Step 2: Click **System** .

Step 3: Click **Share experiences** .

Step 4: Turn on **Near Share** .

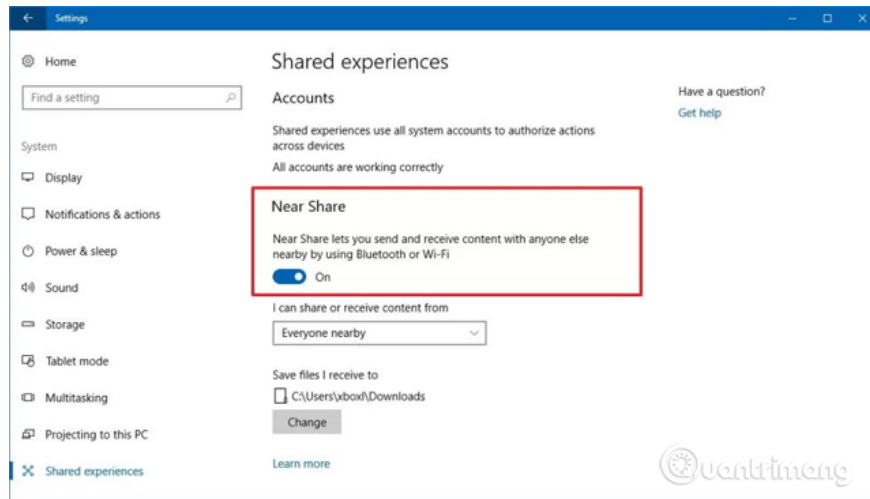

After completing the above steps, when you click the **Share** button on Microsoft Edge, File Explorer, Photos and other applications, you will see a new section with a list of configured devices to receive wireless files by use Near Share.

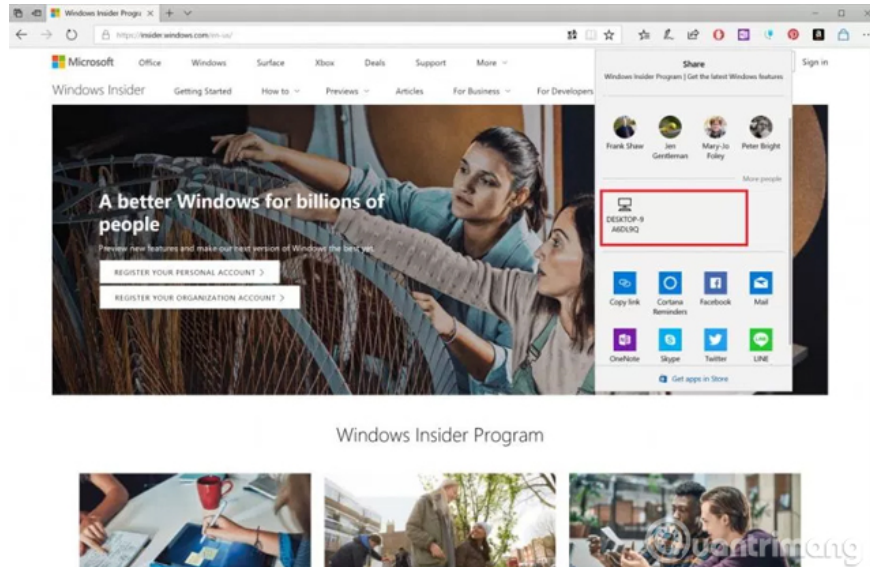

After sharing the content, the recipient will receive a notification, accepting to receive the file. By default, all received files will be downloaded to the **Downloads** folder but users can change the download location by using the " **Save files I receive to** " option.

The Near Share feature is designed to share content with any device, but with " **I can share or receive content from** " drop-down menus, you can restrict sharing only content with your device.

How to enable the Near Share feature using Action Center

Also, you can turn on Near Share in Windows 10 with Action Center.

Step 1: Open **Action Center** (press Windows + A key).

Step 2: In Quick actions section, click the **Near Share** button.

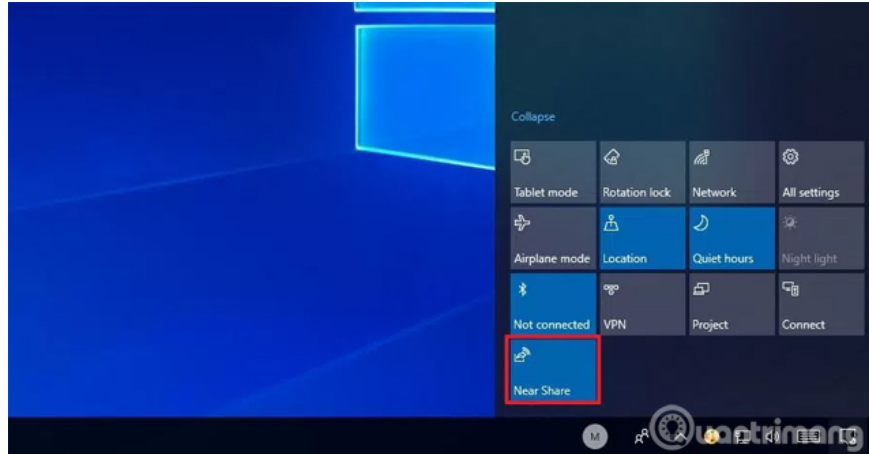

After completing the above steps, you can start sharing and receiving content from other devices. Note to receive files with Near Share, both devices must run Windows 10 build 17035 or newer.

I wish you all success!

See more:

1. This is a way to transfer files from your computer to your Android phone without a USB cable
2. 5 ways to transfer data between phone and computer without connecting cable
3. Create a wireless connection between two laptops

You finished reading the article "**How to enable Near Share on Windows 10**" edited by the [TipsMake](#) team. We hope this article has provided you with many useful tech tips and tricks. You can search for similar articles on tips and guides. Thank you for reading and for following us regularly.