

How to enable BitLocker encryption on computers that do not support the TPM chip

How to enable BitLocker encryption on computers that do not support the TPM chip. TPM is only integrated on newer laptops or motherboards, so if you do not support TPM when enabling BitLocker, you will receive an error message.

BitLocker is a feature built into Windows that helps us encrypt and protect data against unauthorized access or theft of data on our computer. However, to use this feature, your computer must be integrated with a security chip called Trusted Platform Module (TPM), usually this chip is only integrated on newer laptops or motherboards. Computers that do not support TPM when enabling BitLocker will have an error message. But do not worry, if your computer does not support TPM we can still activate BitLocker in the system, of course the security will not be as high as the computers that support TPM. Please follow along the following tutorial of TipsMake.com to know how to do it.

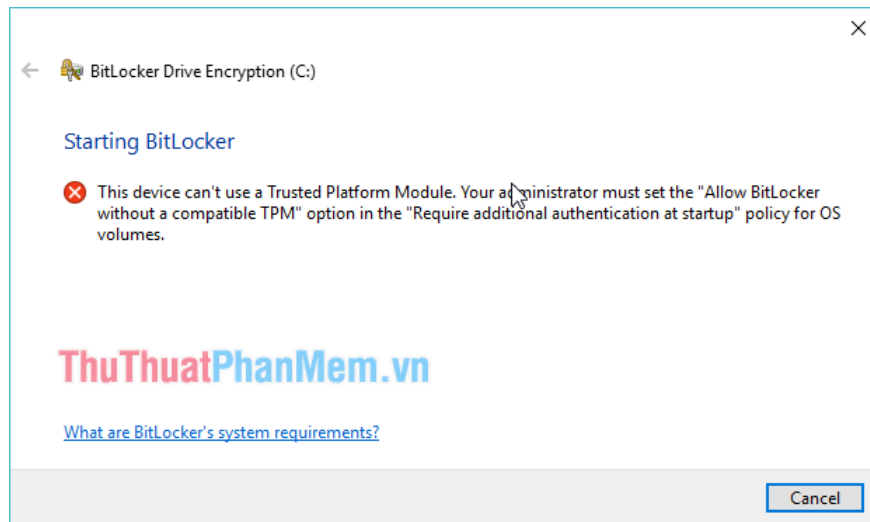

Step 1: You press Windows + R key combination to open the Run dialog box, then enter the command **gpedit.msc** and press Enter

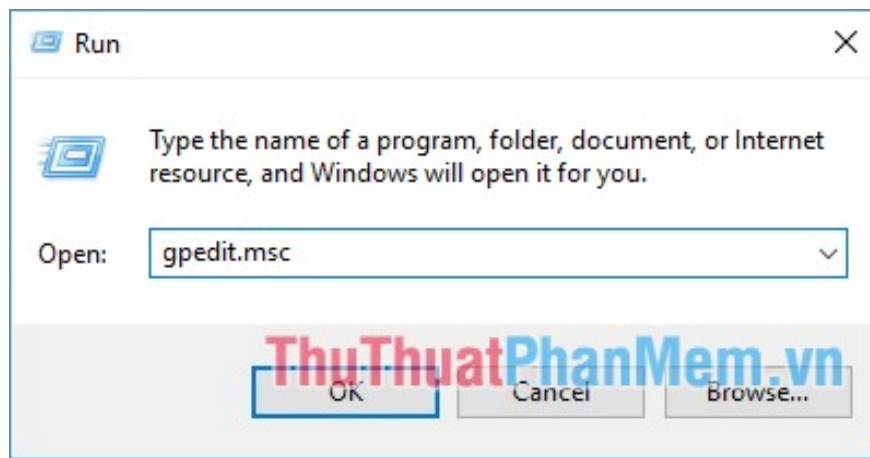

Step 2 : The Local Group Policy Editor window appears, you browse for the following link:

Computer Configuration > Administrative Templates > Windows Components > BitLocker Drive Encryption > Operating System Drives

Then in the right window, double-click the **Require additional authentication at startup** line

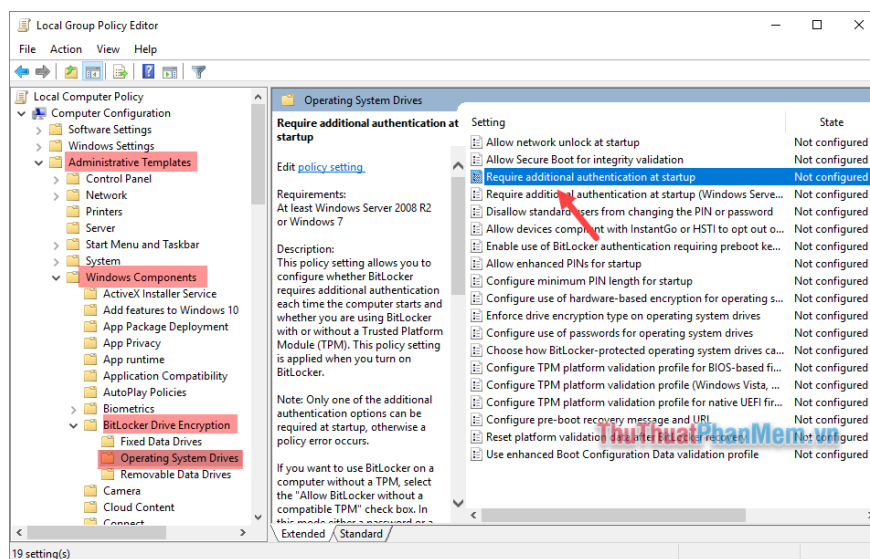

Step 3: In the new window, select Enabled then go to the bottom, select **Allow BitLocker without a compatible TPM**. Finally, click **Apply** to save the settings and exit the window.

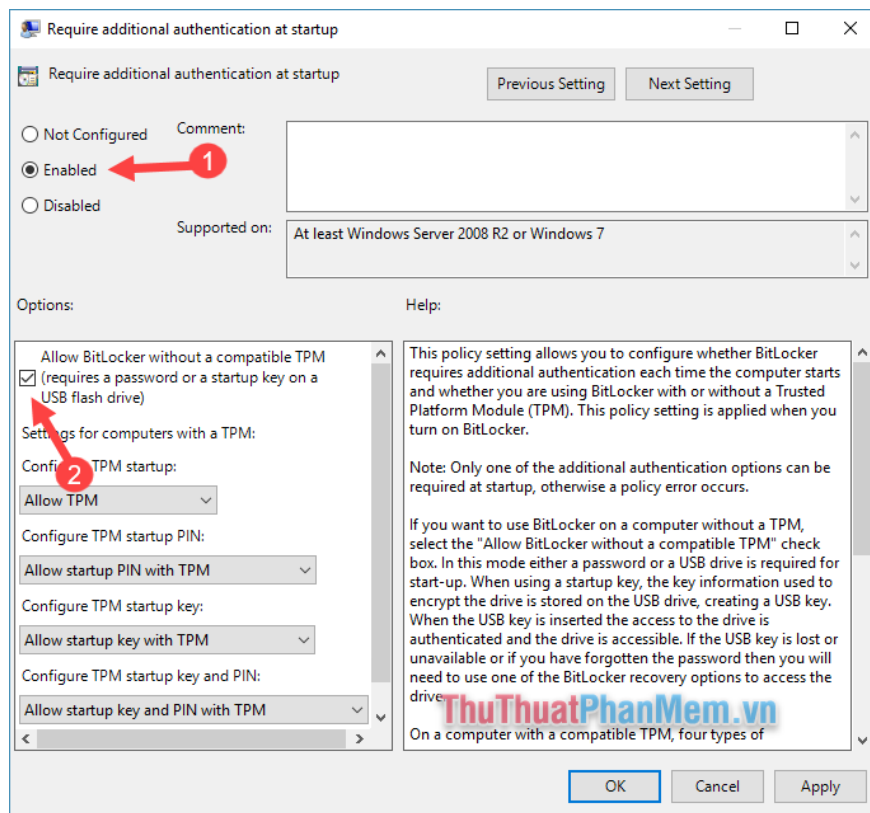

Now you can try to enable the BitLocker feature on a certain drive partition, such as drive C, to see no error messages anymore:

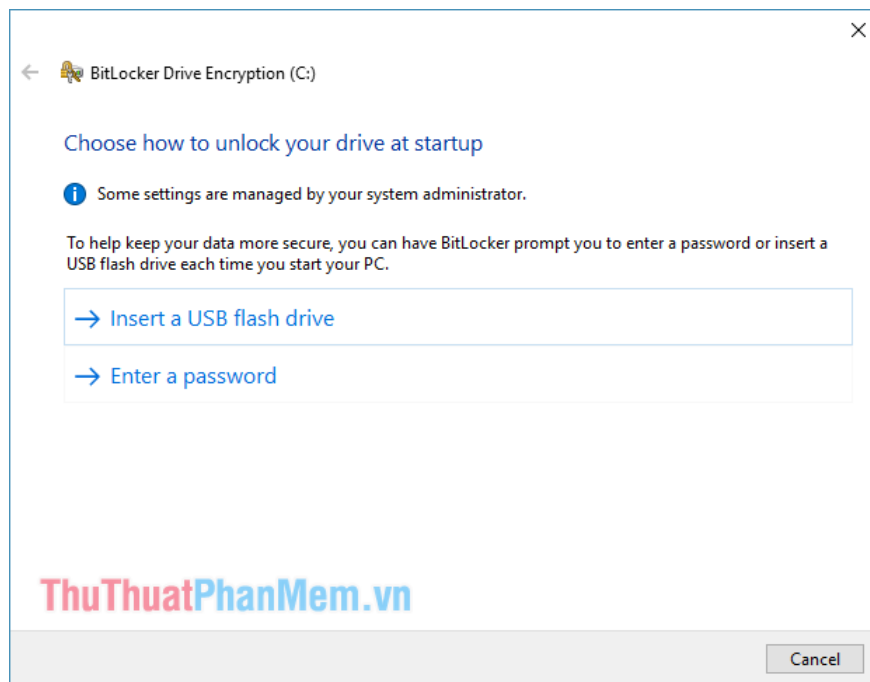

So with just a few simple steps, we can enable BitLocker encryption on computers that do not support TPM chips, hope you will find the article useful. Good luck.

You finished reading the article "**How to enable BitLocker encryption on computers that do not support the TPM chip**" edited by the [TipsMake](#) team. We hope this article has provided you with many useful tech tips and

tricks. You can search for similar articles on tips and guides. Thank you for reading and for following us regularly.
