

How to draw borders for text in GIMP

Using the free GIMP image editing application, you can also create custom text and create outline for it with colored borders to your liking.

The text outline (drawing more borders) in documents or publications will become eye-catching and attractive. The text can even appear in 3D. Fortunately, you don't need an expensive software program to create it. Using the free GIMP image editing application, you can also create custom text and create outline for it with colored borders to your liking. It is important to use GIMP layer tools.

1. Open GIMP. Go to the **"File"** menu , click **"New"** and select **"OK"**. Or, press **"Ctrl + N"** to open a new image.

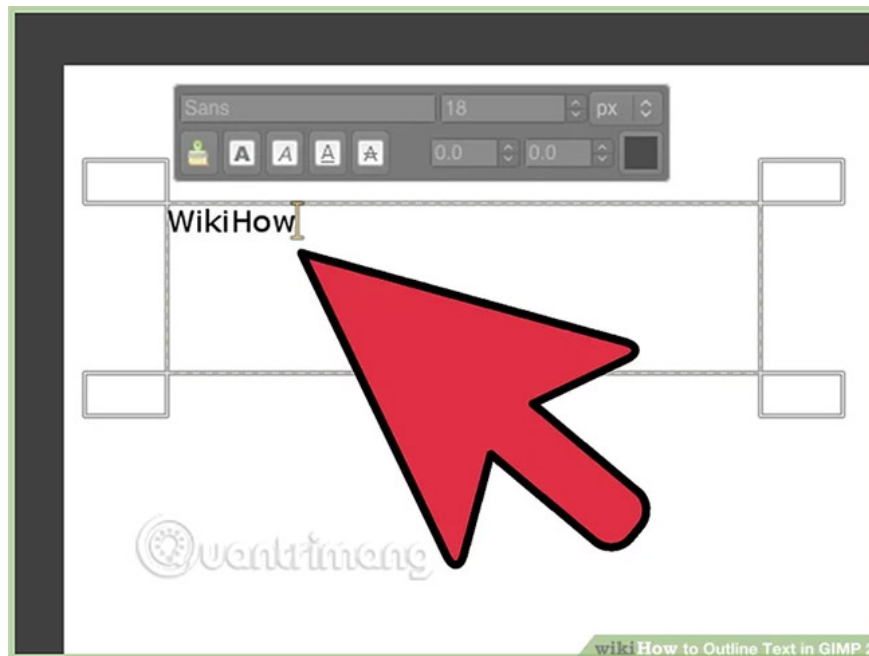

2. Click the **"Text Tool"** button in Toolbox or go to the **"Tools" menu** and select **"Text"**. Click on the canvas image to open the **GIMP Text Editor** . Enter the text you want and click **"Close"**. Choose a font, size and color in the **Text** section of Toolbox. Reselect the text and click the **" Path from Text "** button in Toolbox.

3. Go to the **"Layer"** menu and select **"New Layer"**. Select **"Transparency"** and click **"OK"**. Go to the **"Select"** menu and click **"From Path"** to select the outline of the text in the new layer.

