

How to remove Copilot and other AI features in Windows

If you don't mind having more bloatware on your system, there are several ways to remove or disable Windows Copilot on Windows 11.

Microsoft Copilot and many other AI features are now integrated into Windows. However, they are not mandatory; you can disable most if you don't like AI. This guide will cover all methods for removing Copilot and other AI features from Windows.

Uninstall Copilot in Windows

Although removing Copilot was initially difficult after its introduction, it's now much easier as it's a standalone application. If you're using the latest version of Windows 11, you can uninstall Copilot just like any other application in Windows.

In Windows Settings, go to **Apps > Installed apps**. Find the Copilot app and select **Uninstall** from the **More options** menu next to it.

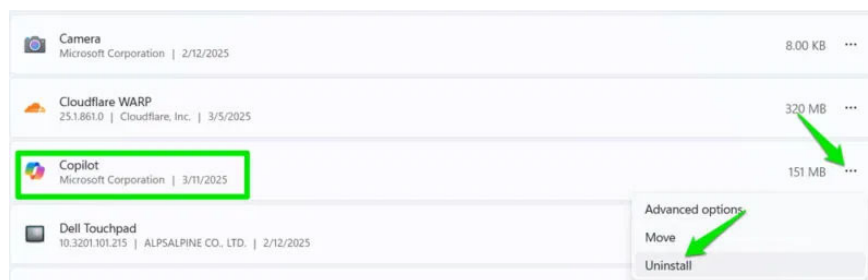

This will uninstall the Copilot application, but it will not render Copilot unusable in other applications. However, it will close some background processes that Copilot runs, even if you are not using the application.

Microsoft Edge AI is primarily found in the Copilot sidebar, AI typing suggestions, and AI search features. Fortunately, you can disable these AI features from the settings or Edge flags.

Remove the Copilot button from the Edge toolbar.

Microsoft Edge has a Copilot button on the toolbar that you can click to open Copilot in the sidebar for interactive use while browsing. You can disable this button in Edge's settings.

From the Edge main menu, click **Settings** , then go to **Copilot and sidebar** -> **Copilot** .

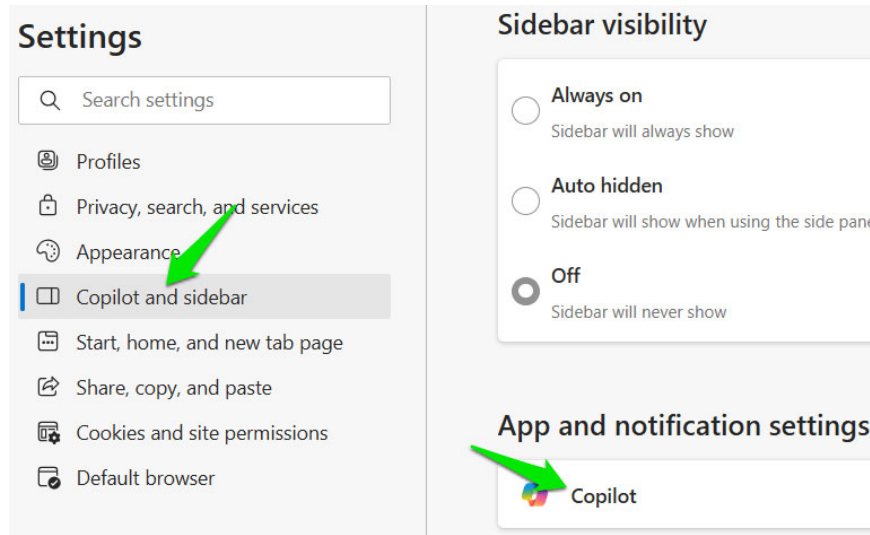

Turn off the toggle switch next to "**Show Copilot button on the toolbar** ," and the Copilot button will be replaced with a sidebar button.

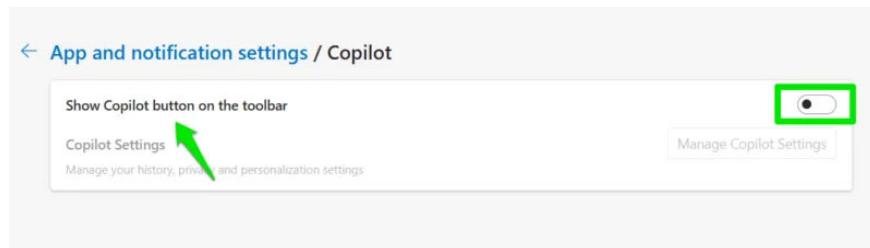

Disable AI writing assistant

Edge includes Microsoft Editor for grammar and spelling suggestions, but it now also uses an AI-powered writing assistant to help you rewrite text and adjust your style. This additional functionality can be turned off through the settings.

In Edge settings, go to **Languages** ??and turn off the "**Collaborate with Copilot as you write on the web**" option .

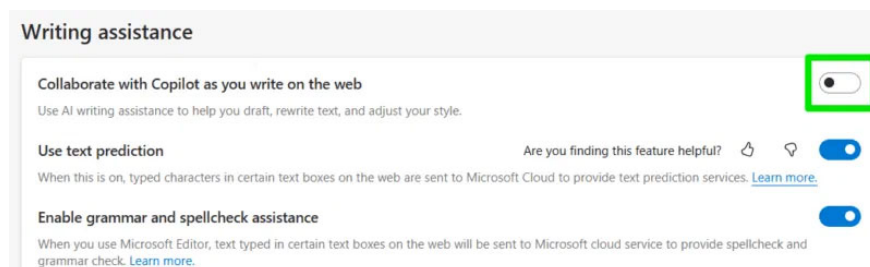

Disable AI in DevTools

Microsoft Edge can help you resolve website errors within DevTools (**Ctrl + Shift + I**) via AI. Click the Copilot button next to the error, and Copilot will help you learn more. If you don't need this additional help, you can disable it from Edge flags.

Enter **edge://flags/** in the address bar to open the experimental features. Search for "explain devtools with AI" in the top search bar and select **Disabled** next to the **Explain DevTools with AI** flag . You will need to restart your browser for the changes to take effect.

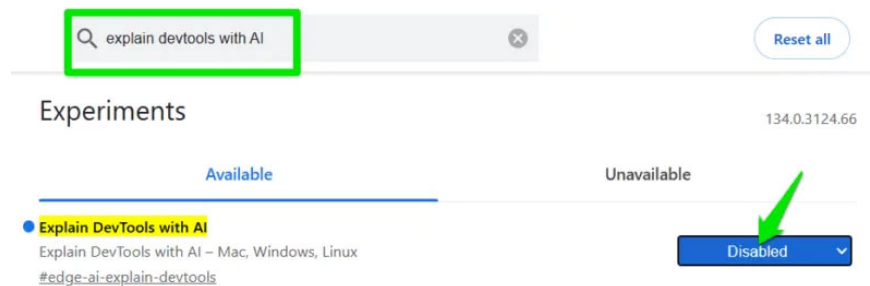

Remove AI features from Notepad

Modern Notepad has many powerful features, and Microsoft didn't take long to add AI capabilities to it. When taking notes, you can click the **Rewrite** button in the upper right corner to rewrite the content or change the tone/formatting via AI. You can remove this button in Notepad settings if you wish.

Click on Notepad settings next to the **Rewrite button** and **turn off the Rewrite** option in the **AI ??Features** section .

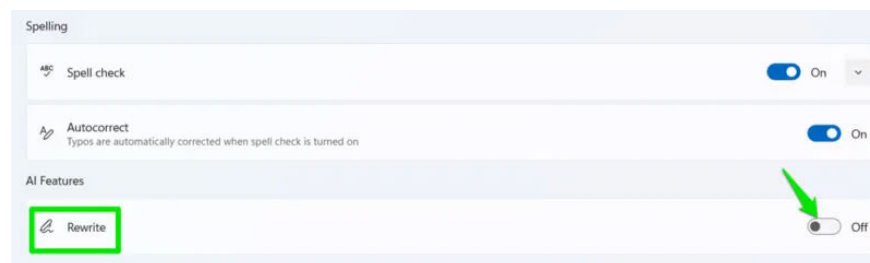

Disable Copilot in Microsoft Office

Whether it's Word, Excel, or PowerPoint, Copilot is now part of the Microsoft Office suite – there's always a dedicated button for quick access to it. Fortunately, you can disable all AI features from a single option if you don't want to use AI in Microsoft Office. When using any of these Office applications, you can disable Copilot by following the steps below.

Navigate to **File -> Options** and go to the **Copilot** section . Uncheck the box next to **Enable Copilot** . You will need to perform these steps for each application individually and must have the latest version to disable Copilot.

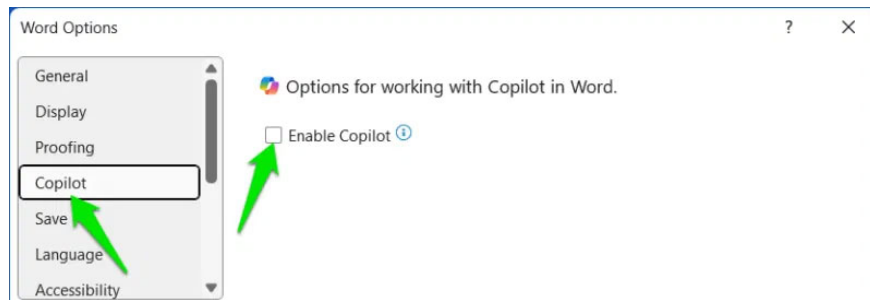

Additional: Disable Scareware AI blocker.

Microsoft Edge has another AI feature: the Scareware Blocker. At the time of writing, this feature is disabled by default, but you may want to ensure it remains enabled. This feature is supposed to detect scareware attempts by analyzing every page you visit, something many users may not want. Find this option in Edge's settings by going to **Privacy, search, and services -> Security -> Scareware blocker** .

These steps will minimize the impact of AI and remove Copilot, giving you better control over Windows. However, Microsoft isn't slowing down in integrating AI, so you might want to explore the amazing things Copilot can do before removing it.

You finished reading the article "**How to remove Copilot and other AI features in Windows**" edited by the [TipsMake](#) team. We hope this article has provided you with many useful tech tips and tricks. You can search for similar articles on tips and guides. Thank you for reading and for following us regularly.