

# How to create Intro in PowerPoint like Star Wars movie

Creating your PowerPoint presentation by running the word like in Star Wars is a great way to engage your audience, make them more interested and participate in your presentation.

Creating your PowerPoint presentation by running the word like in Star Wars is a great way to engage your audience, make them more interested and participate in your presentation.

1. Create text effects like Star Wars movie Poster in Photoshop
2. How to create effects for photos on PowerPoint
3. How to create handwriting PowerPoint effects

## How to create an introduction like in Star Wars movie

First, you need to add a clear, starry night sky image as the background for the slide. You can find this image online or take a picture yourself if you want.

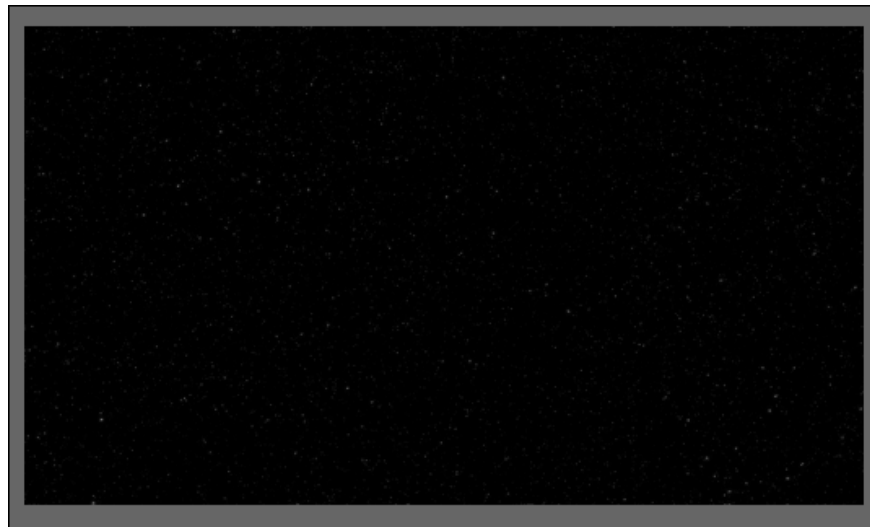

When placing an image into PowerPoint, you will need to insert a text box to enter the introduction. To add a text box, click the **Insert** tab.

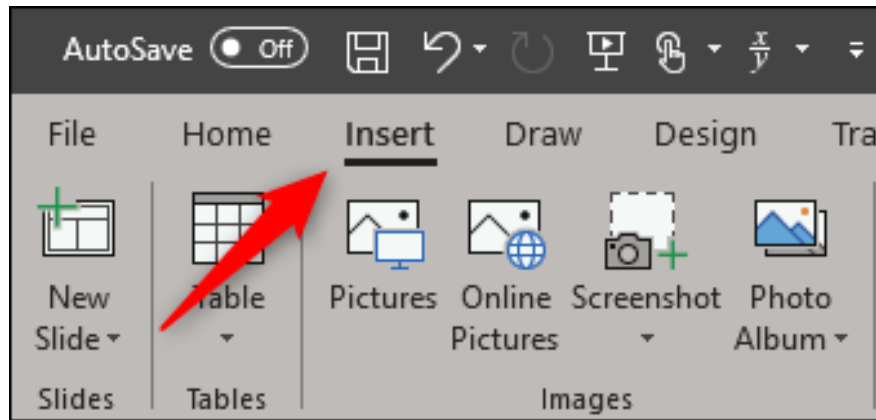

Next, click on the **Text Box** button.

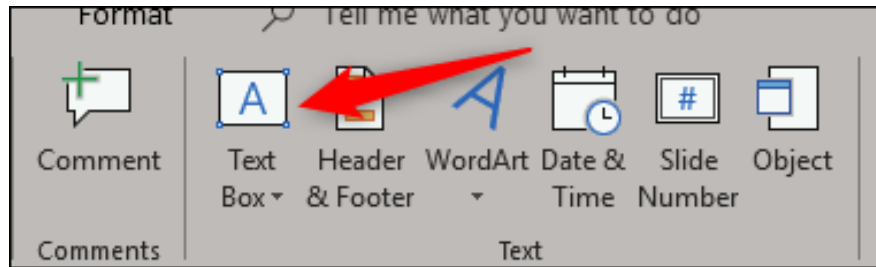

Click and drag to draw the text box, ensuring enough space for your introduction.



You need to make sure the image is placed behind the text. Type the introduction you want to display. In recent Star Wars movies, the font style has changed a bit. If you want the font type in 1997 version, you need to set the following parameters:

1. **Color** : Yellow (Red 250, Blue 190, Green 0)
2. **Typeface** : News Gothic MT; bold
3. **Font size** : 44 pt.
4. **Typeface** : Justify (spread both sides)

After adjusting your settings, you will get an introduction similar to this one.

**How-To Geek is an online technology magazine and one of the top 500 websites in the US. Since it was created more than a decade ago, the site's 10,000+ in-depth articles have been read over 1 billion times. More than 15 million people read our articles every month.**

Now it's time to create the effect for the text. First, select the text box.



Next, switch to the **Format** tab and click the **Text Effects** button.

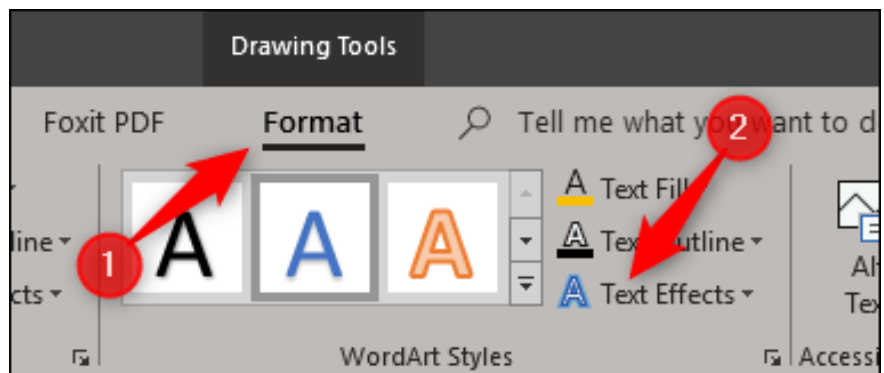

From the drop-down menu that appears, select **3-D Rotation** .

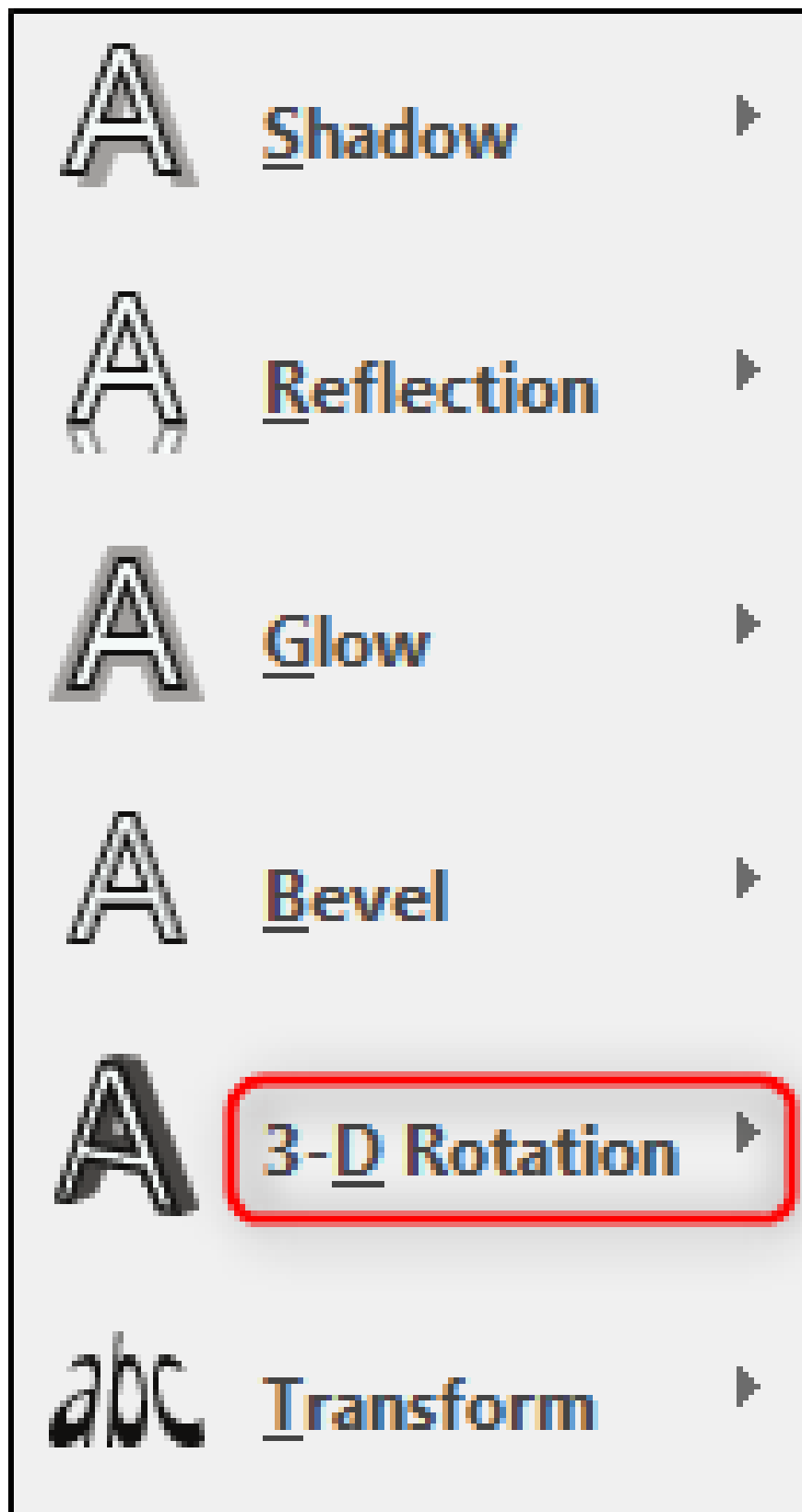

Another menu will appear, select the **Relaxed Perspective Moderately** option from the **Perspective** group.

## No Rotation

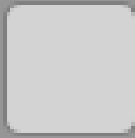

## Parallel

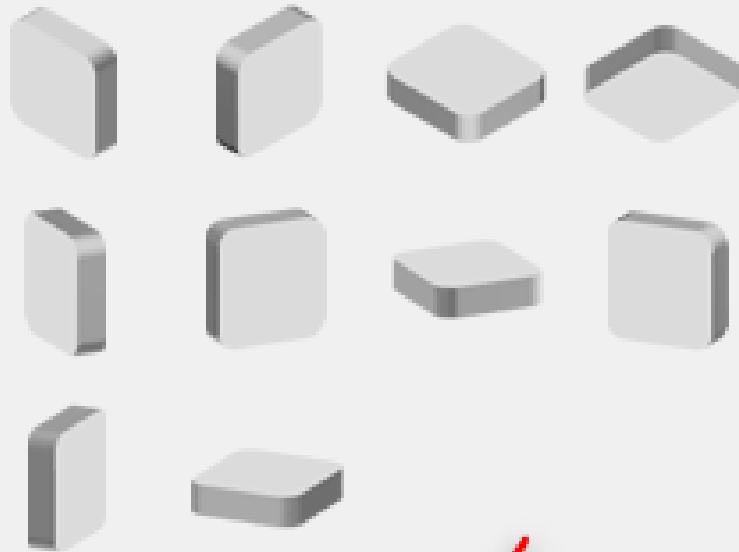

## Perspective

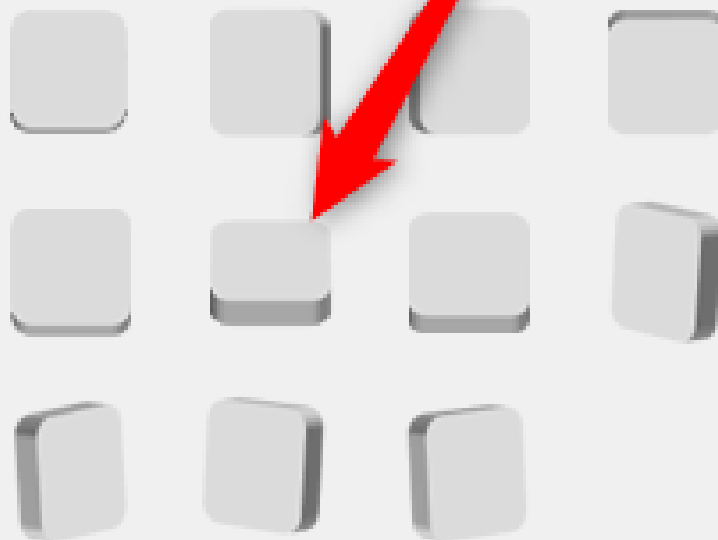

## Oblique

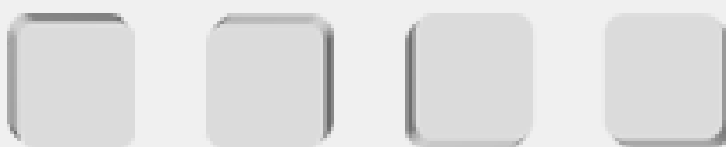

3-D Rotation Options...

Next, go back to the menu select perspective, but this time, choose **3-D Rotation Options** at the bottom.



You'll see the **Format Shape** pane appear on the right. At the bottom of the pane, change the **Y Rotation** value to 320 degrees and the **Perspective** to 80 degrees.

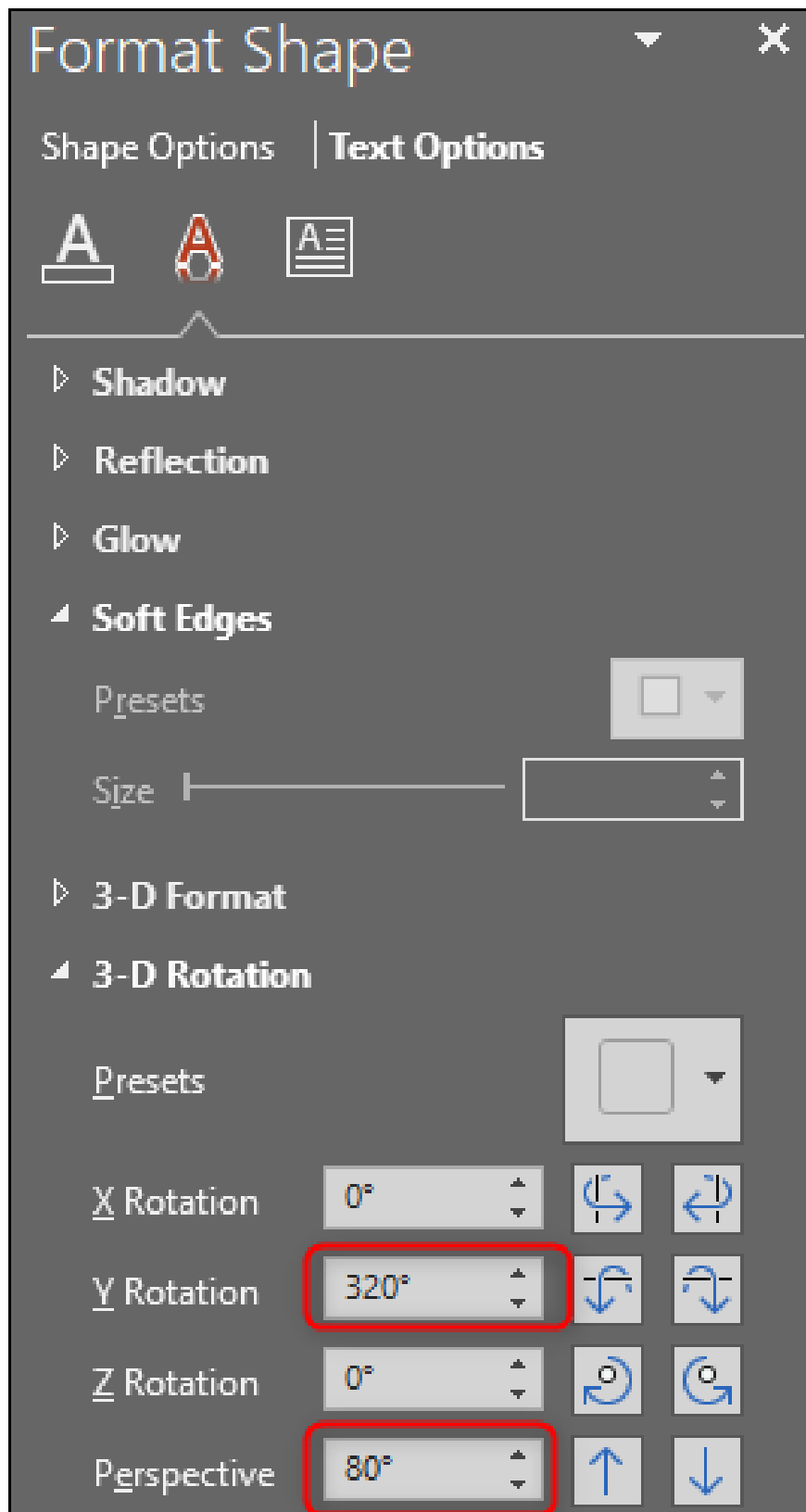

Next, you need to position the text box so that the top part of the text is at the bottom of the slide. Also, make sure the text is in the middle of the slide. To do this, click and drag the text box, adjust the text box width to make sure the top line of the text has the same width (or nearly the width) of the slide.



Next, go to the **Animations** tab and select the down arrow at the bottom right of the **Animation** group.



At the bottom of the menu that appears, select **More Motion Paths** .

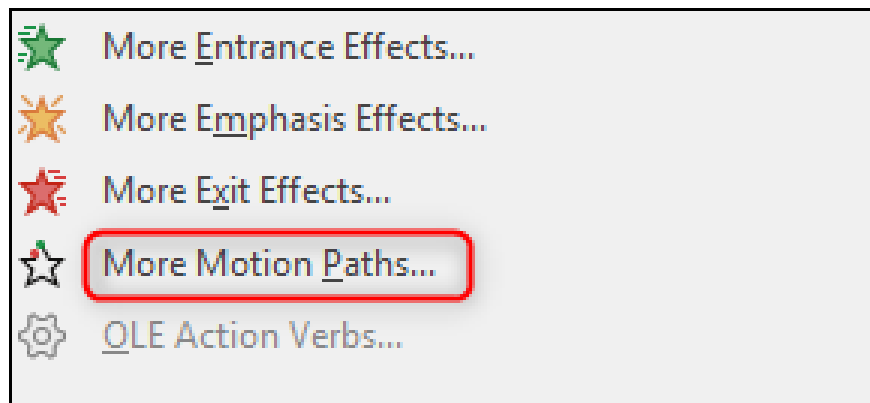

On the **Change Motion Path** menu that appears, select **Up** and then click **OK** .

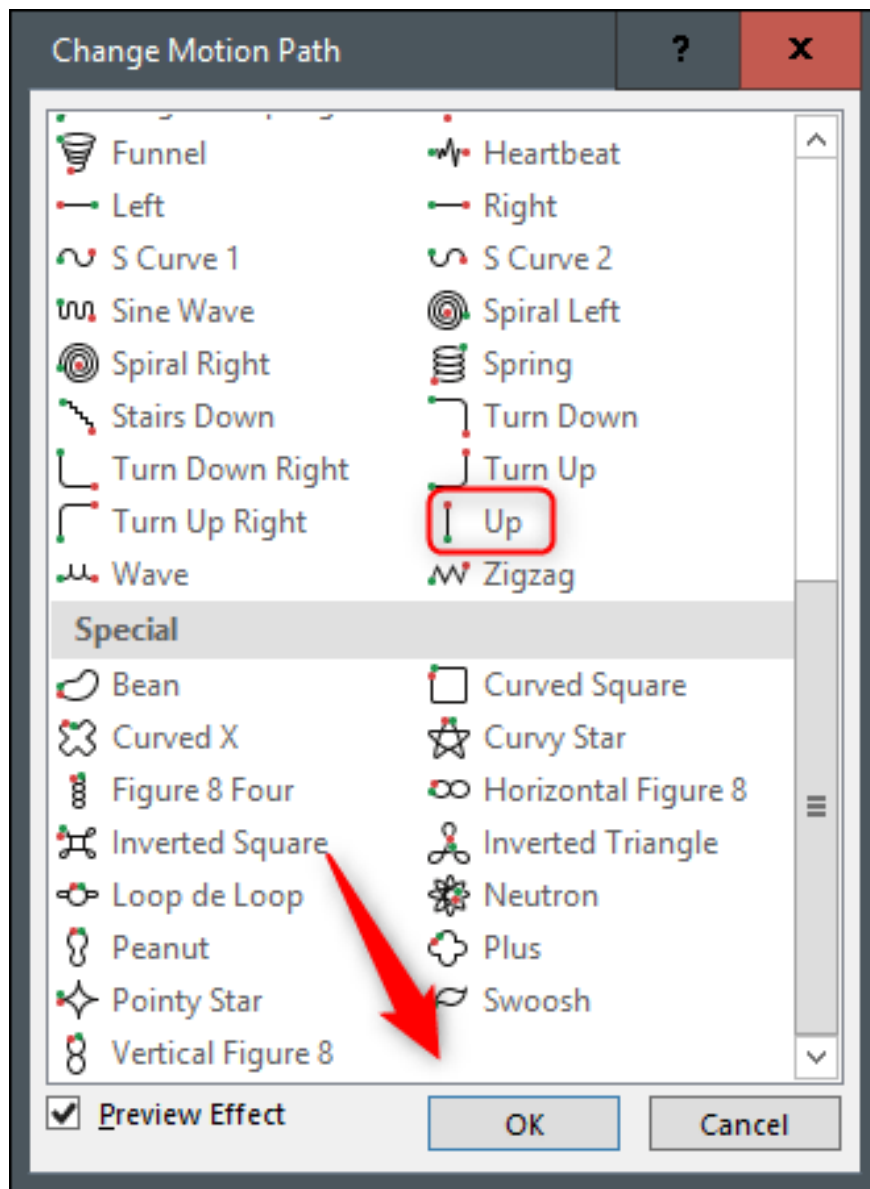

You will see a red and green arrow appear, indicating the end and start of the animation. Click and drag the red arrow to the top of the slide. Hold Shift while dragging to keep the line straight.

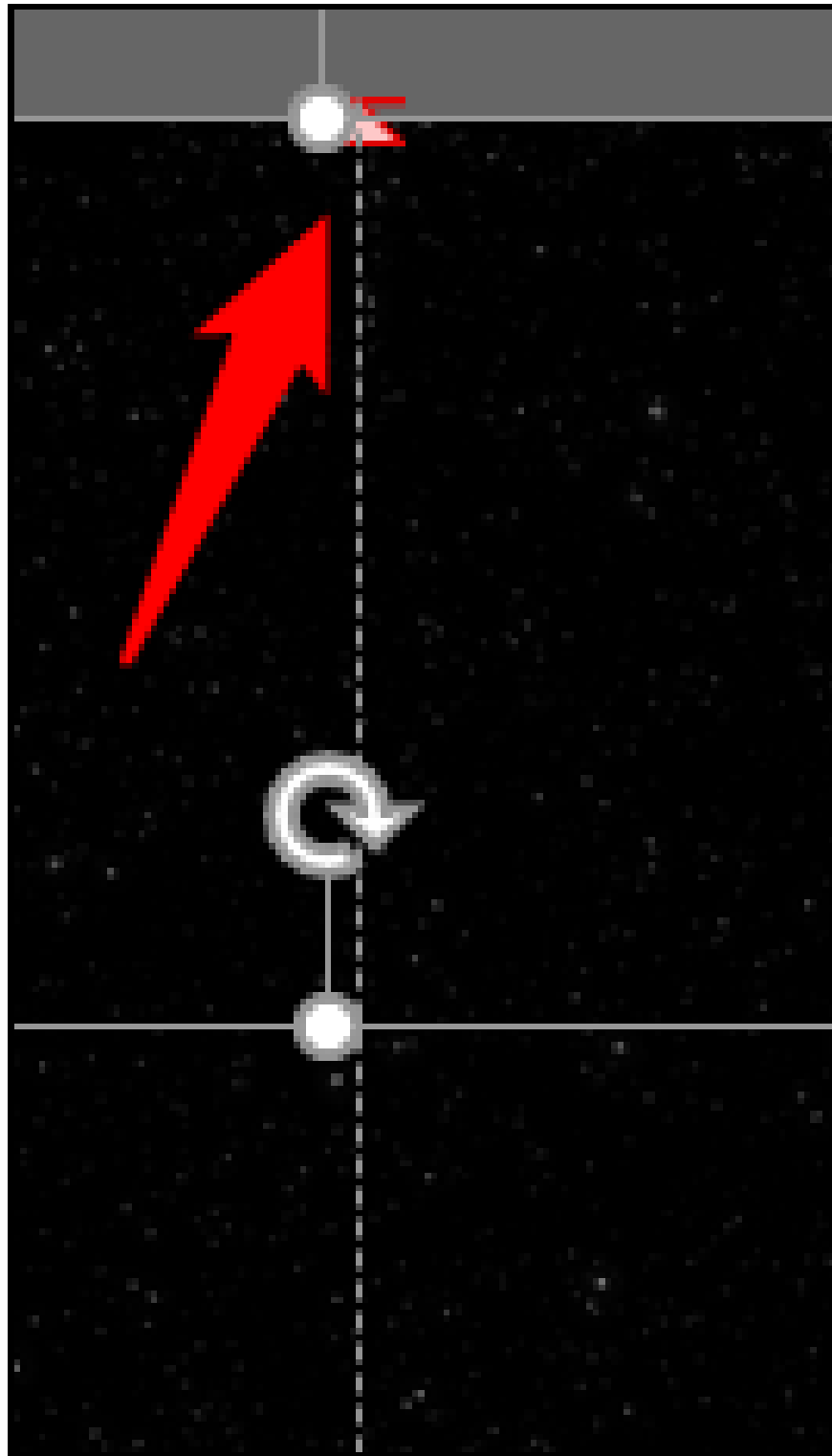

Now go to **Advanced Animations** group and select the **Add Animation** option.

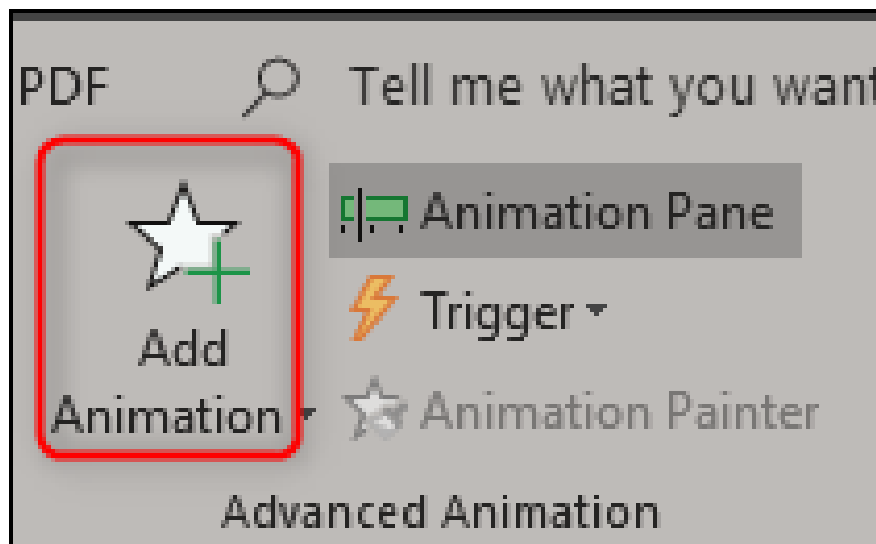

Choose **Grow / Shrink** from the **Emphasis** group.

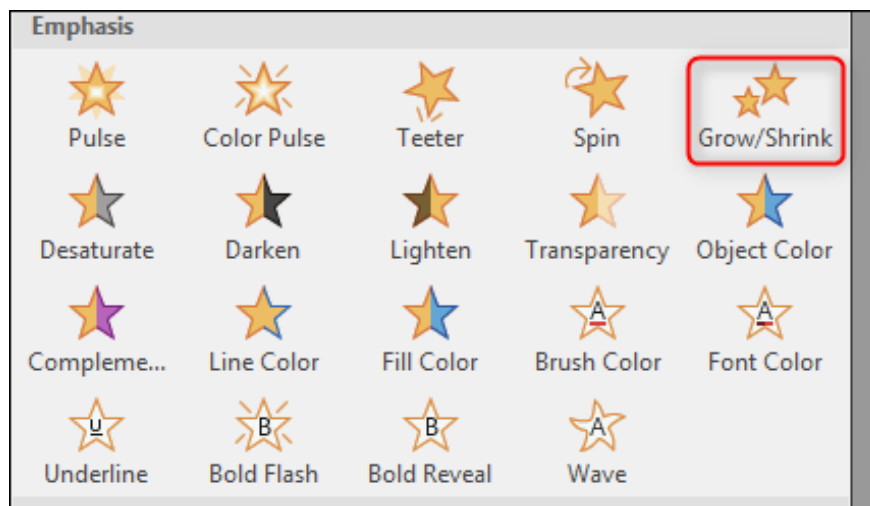

Return to the **Advanced Animation** group and select **Animation Pane**.

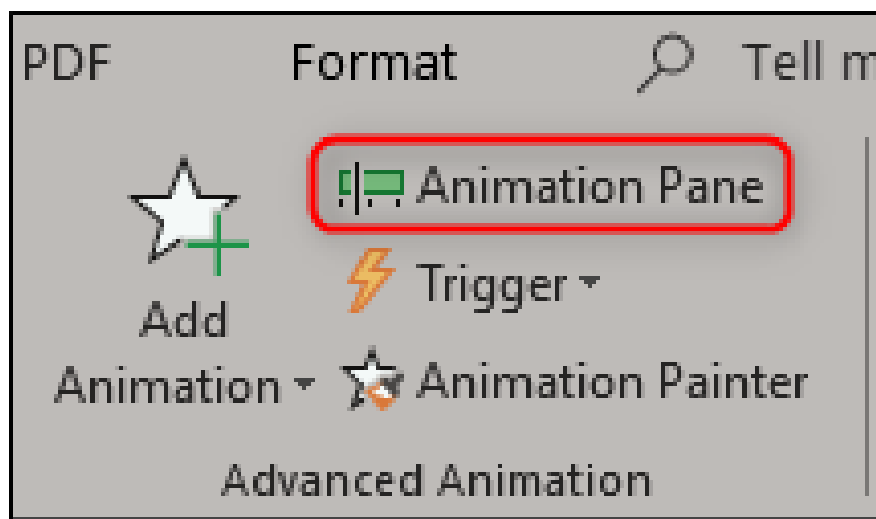

You will see a frame showing the effects selected on the right side of the window. Here, double-click the **Up** effect.

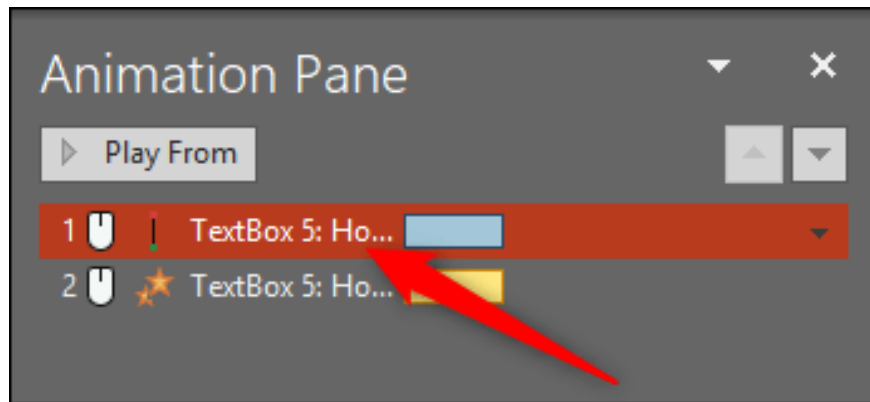

A window appears, showing some options for the Up effect. Here, change the settings of **Smooth start** and **Smooth end** to 0 and then click **OK**.

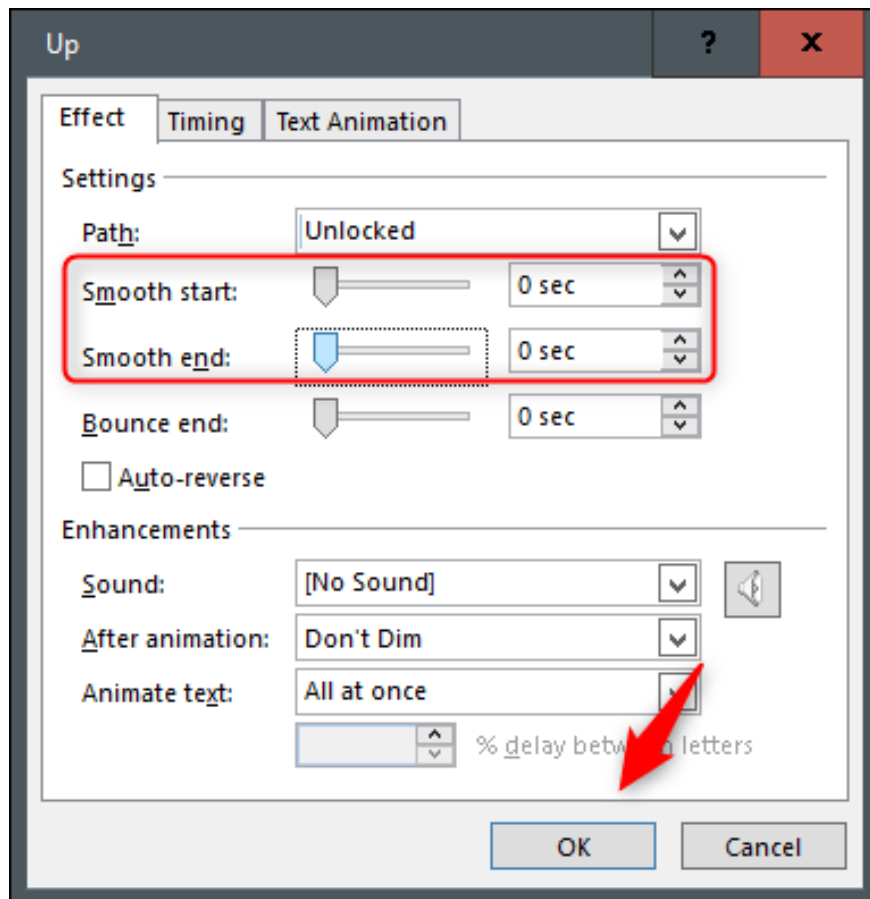

Next, double-click the **Grow / Shrink effect** from the list to open its installation window. In the **Settings** section, click the arrow next to the **Size** option. In the drop down menu, enter 10% in the Custom option and press **Enter**.

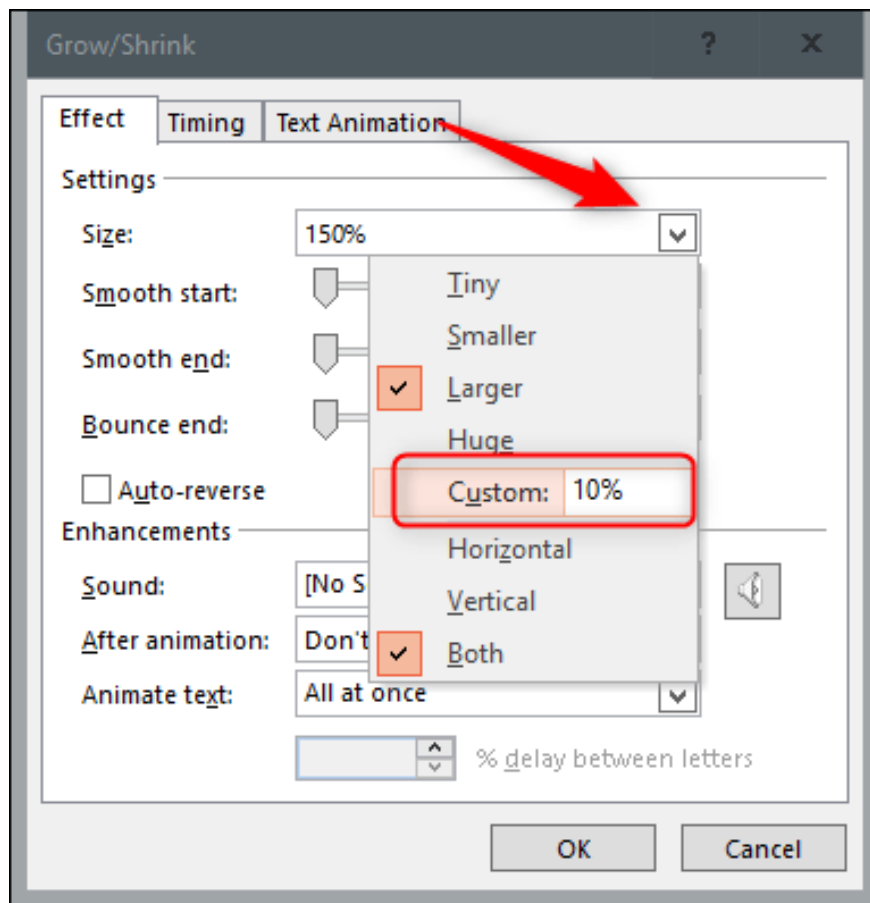

Go to the **Timing** tab and select the arrow next to the **Start** option. Select **With Previous** and then click **OK**.

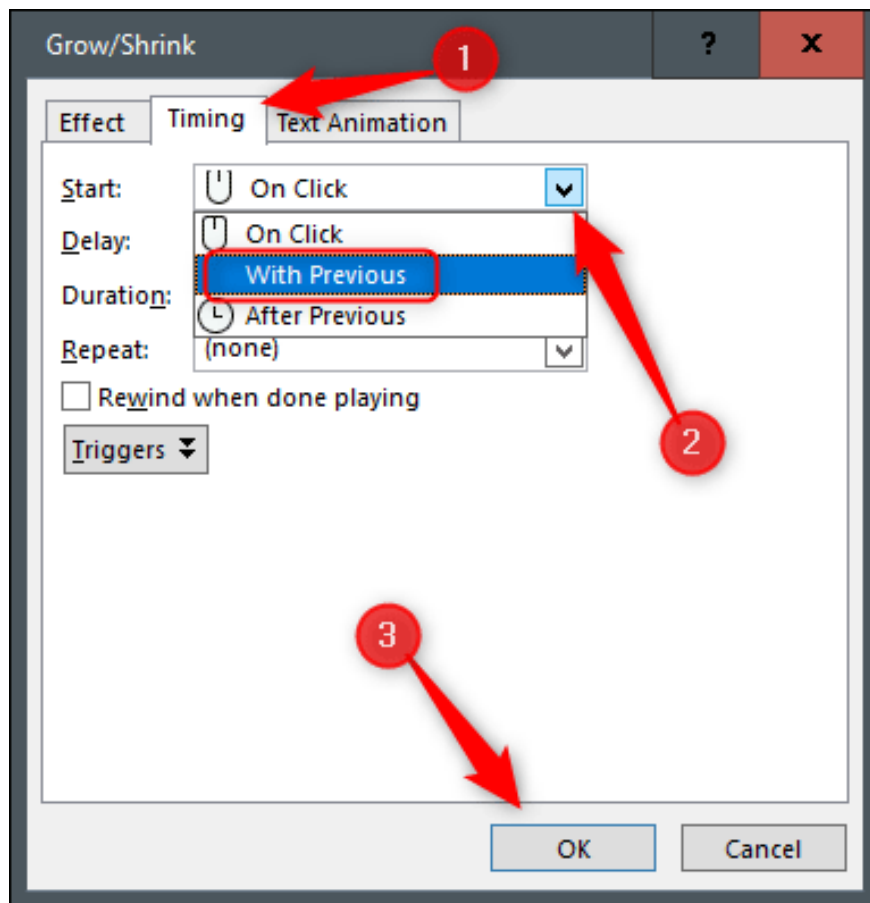

Now, you need to adjust the length of the **Up** effect. By default, the effect length is two seconds, this time is so fast that you need to change it.

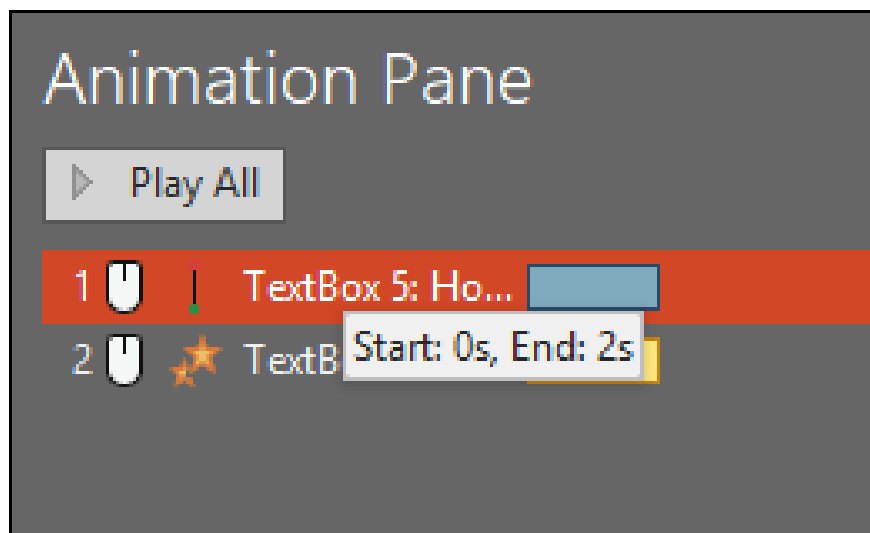

To adjust the time, click and drag the end of the color bar next to the effect. Time depends on the amount of text you have. Here we set it to 30 seconds.

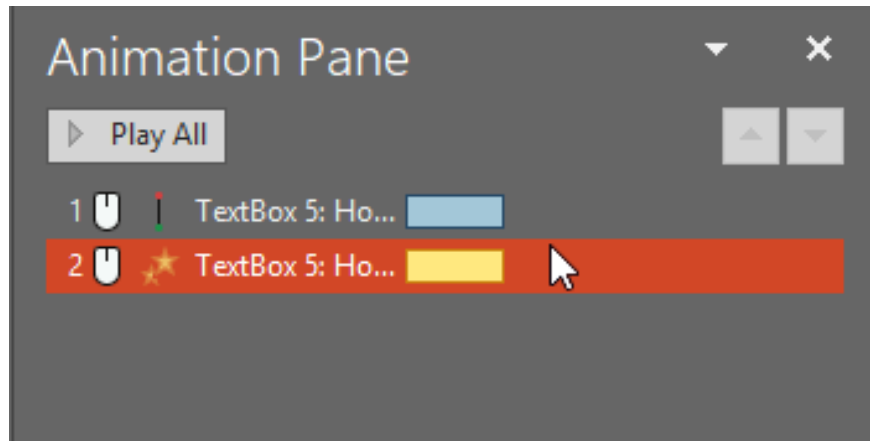

Do the same for the **Grow / Shrink effect** . Now, we need to add a shape using the same image as the background. Go to the **Insert** tab and select the **Shapes** option from the **Illustrations** group.

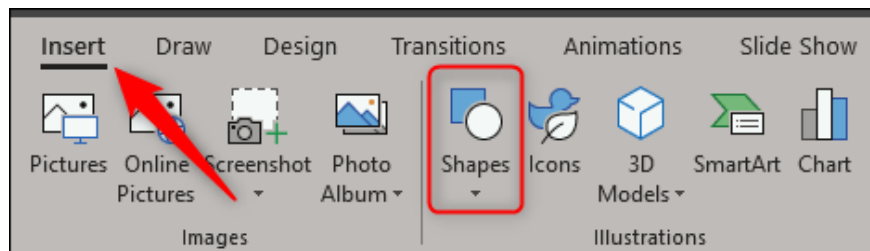

On the drop-down menu that appears, select **Rectangle** from the **Rectangles** group.

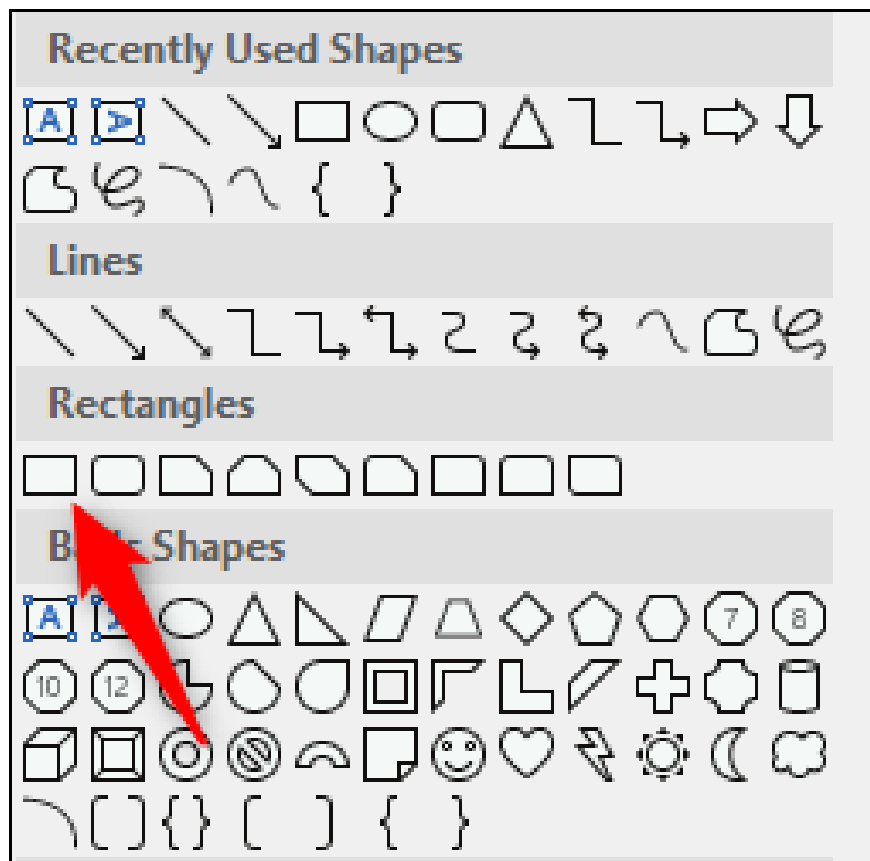

Draw a rectangle so that it covers the top half of the slide.

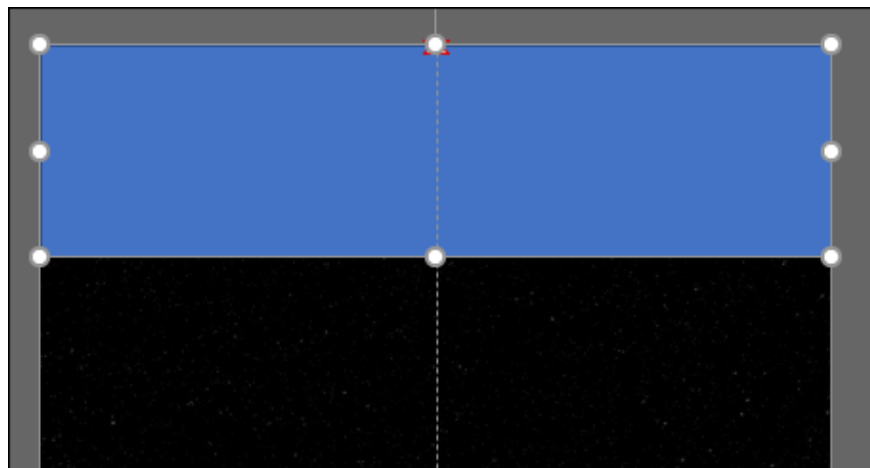

Now we need to remove the outline of the rectangle, make sure to select the image and access the **Home** tab, click on **Shape Outline** .

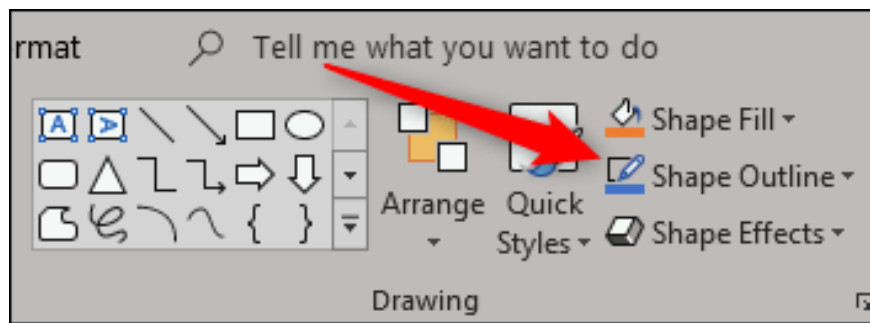

From the drop-down menu that appears, select **No Outline** .

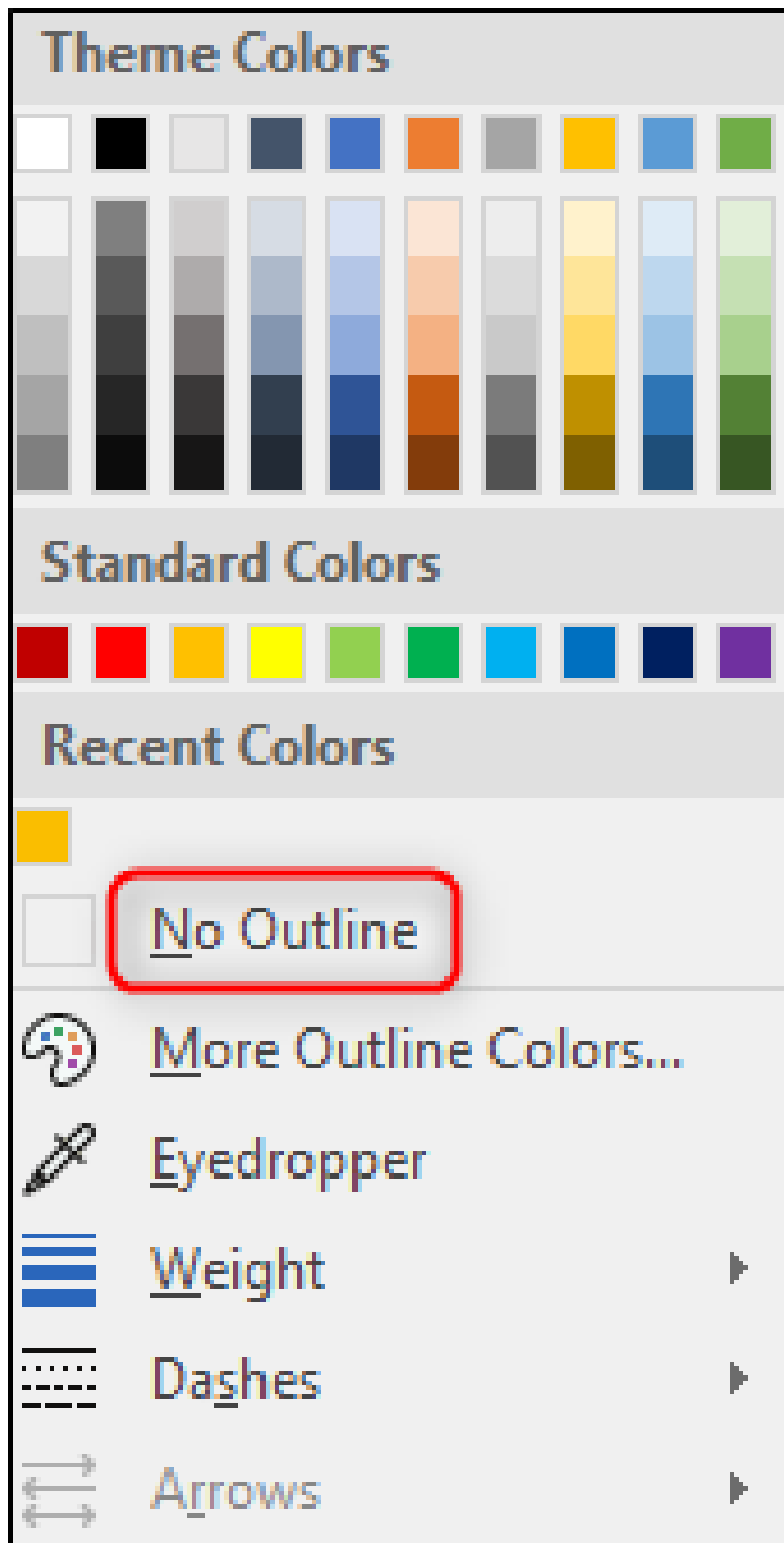

Next, we need to add the same background image to this shape. To do so, access the **Drawing** group and select **Shape Fill** .

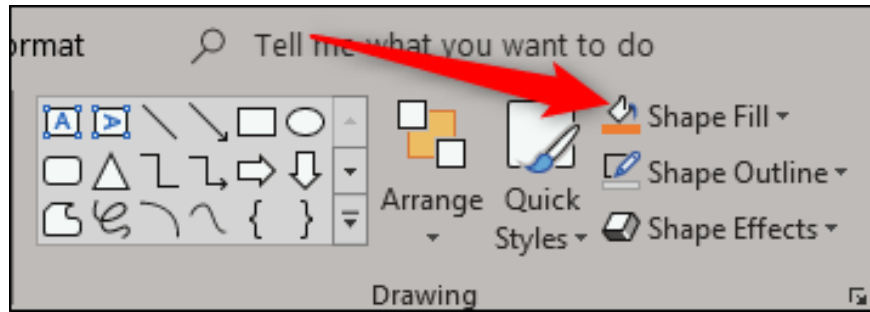

From the drop-down menu, select **Picture** , browse to the location of the image used for the background and select it.

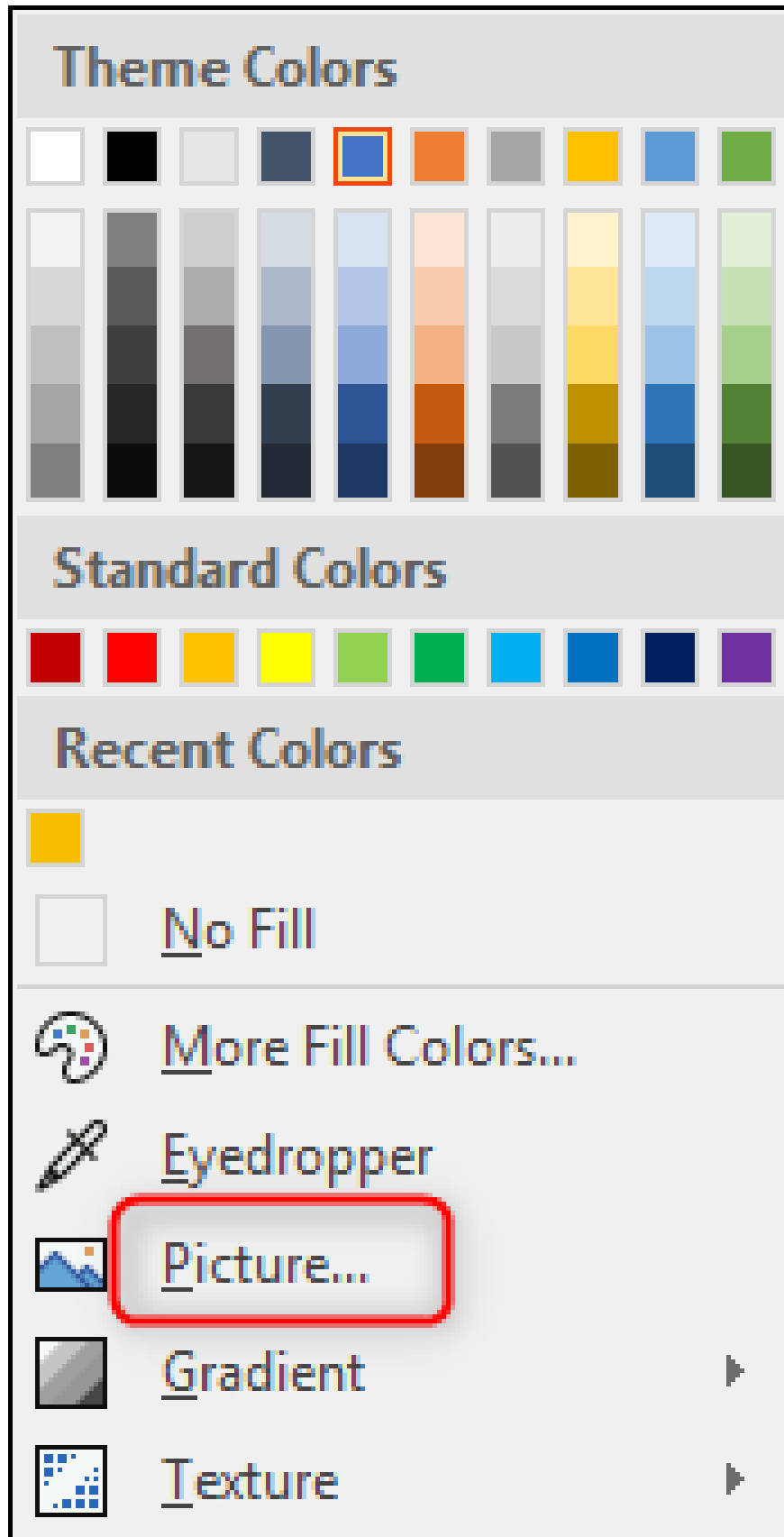

Now it looks like your background, now just let the text appear behind it. If you run the slide now, the text will suddenly disappear at the end. To avoid this, select the image and access the **Format** tab and select **Picture**

Effects from the **Picture Styles** group.

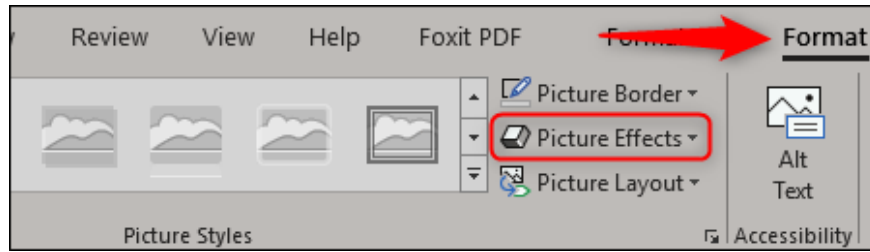

Select the **Soft Edges** type from the drop down menu.



Preset



Shadow



Reflection

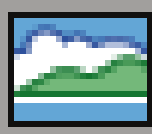

Glow

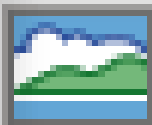

Soft Edges



Bevel



3-D Rotation



In the **Soft Edge Variations** group, select the last option.

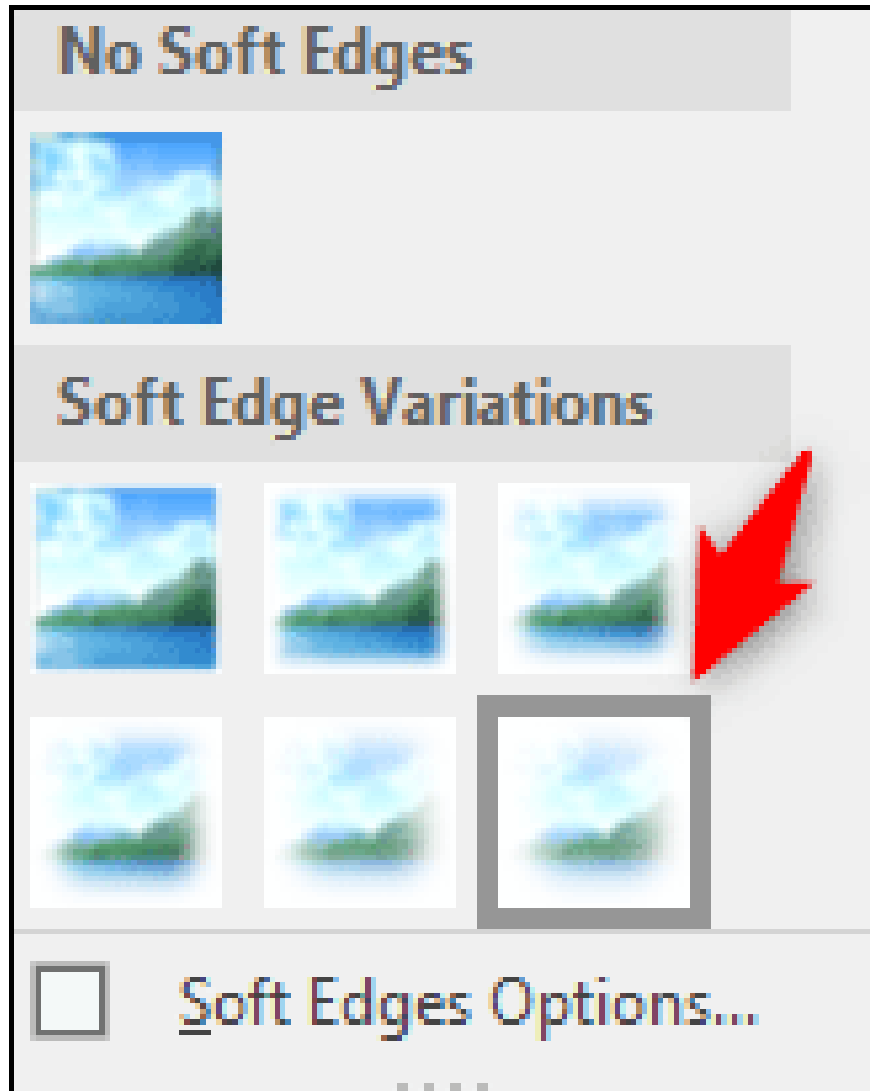

That's it, you will have an intro similar to this video.

I wish you all success!

You finished reading the article "**How to create Intro in PowerPoint like Star Wars movie**" edited by the [TipsMake](#) team. We hope this article has provided you with many useful tech tips and tricks. You can search for similar articles on tips and guides. Thank you for reading and for following us regularly.