

How to create a blur border in a Photoshop image

Creating blurred borders in Photoshop images is like creating Spotlight images, focusing on one pixel and blurring the surrounding area.

Creating borders in Photoshop has many different ways of implementation and you can design, create many types of borders to refresh images if you do not know much about photo editing in Photoshop. This kind of blurry border is often used for taking portraits and things when you want to focus more on the main subject of the picture. Users can choose the color blur according to their own preferences to match the image. The following article will guide you how to blur photos in Photoshop.

Guidelines blur image in Photoshop

Step 1:

We open the image we want to edit and click on **the Elliptical Marquee Tool** and draw an **ellipse around the character or subject** of the image.

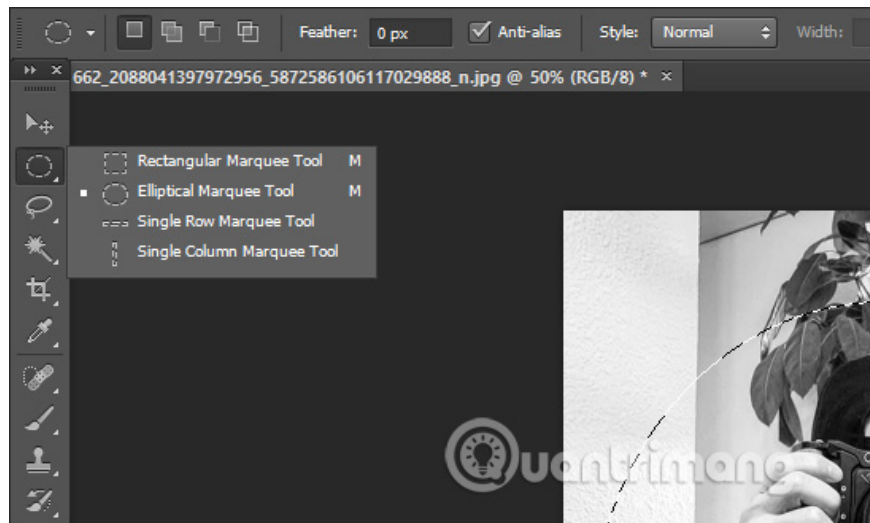

Step 2:

We will right click on the border and select **the Feather feature** .

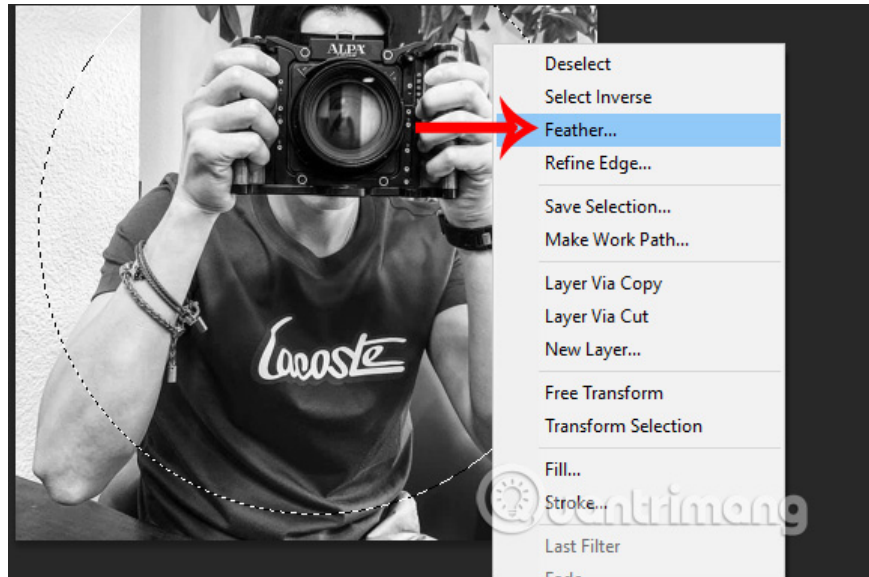

In the current interface, **select 50**, then click OK to save.



Step 3:

Click right mouse button **Select Inverse** to select the area outside the ellipse. At this point the user will see dotted lines surrounding the image.

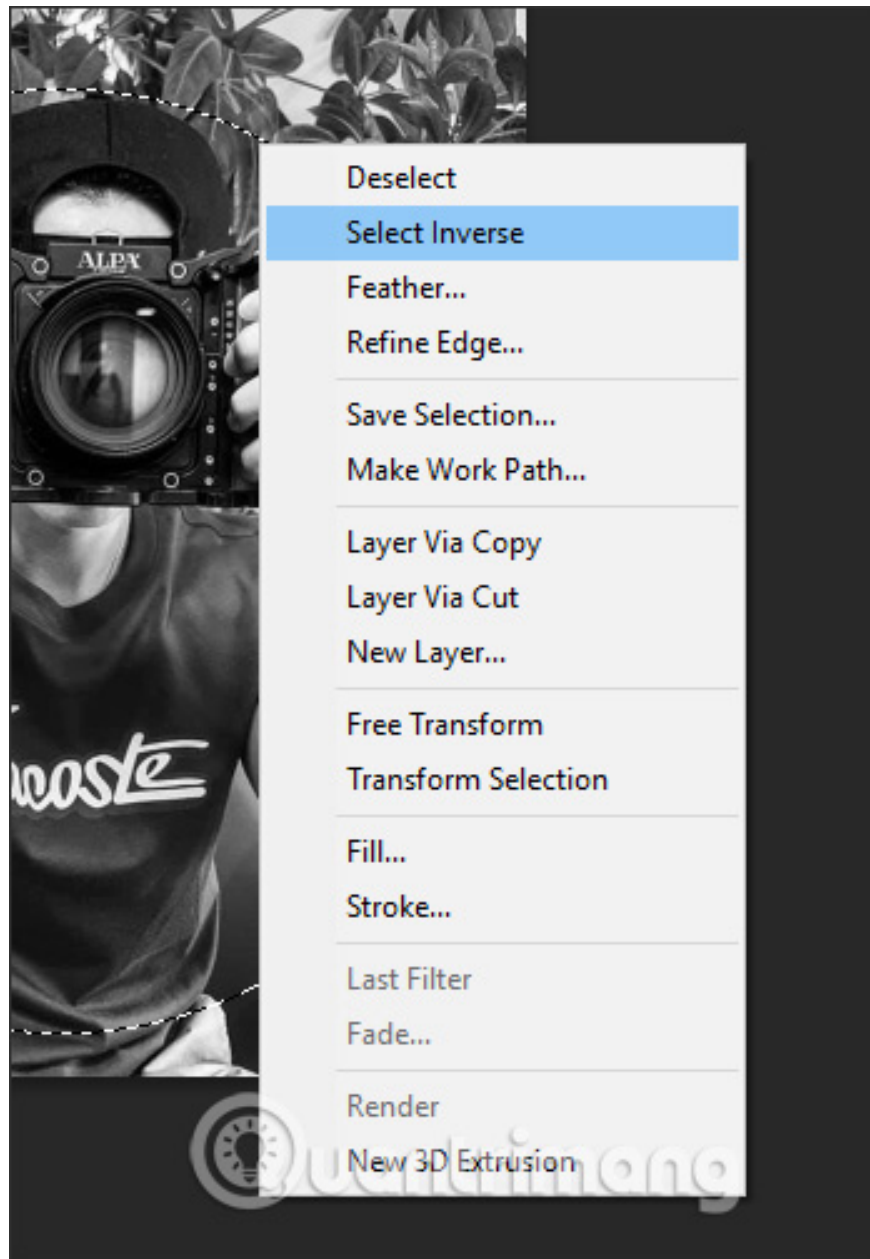

Step 4:

Looking at the toolbar, click **Windows and** select **Swatches** to choose the color of the image border.

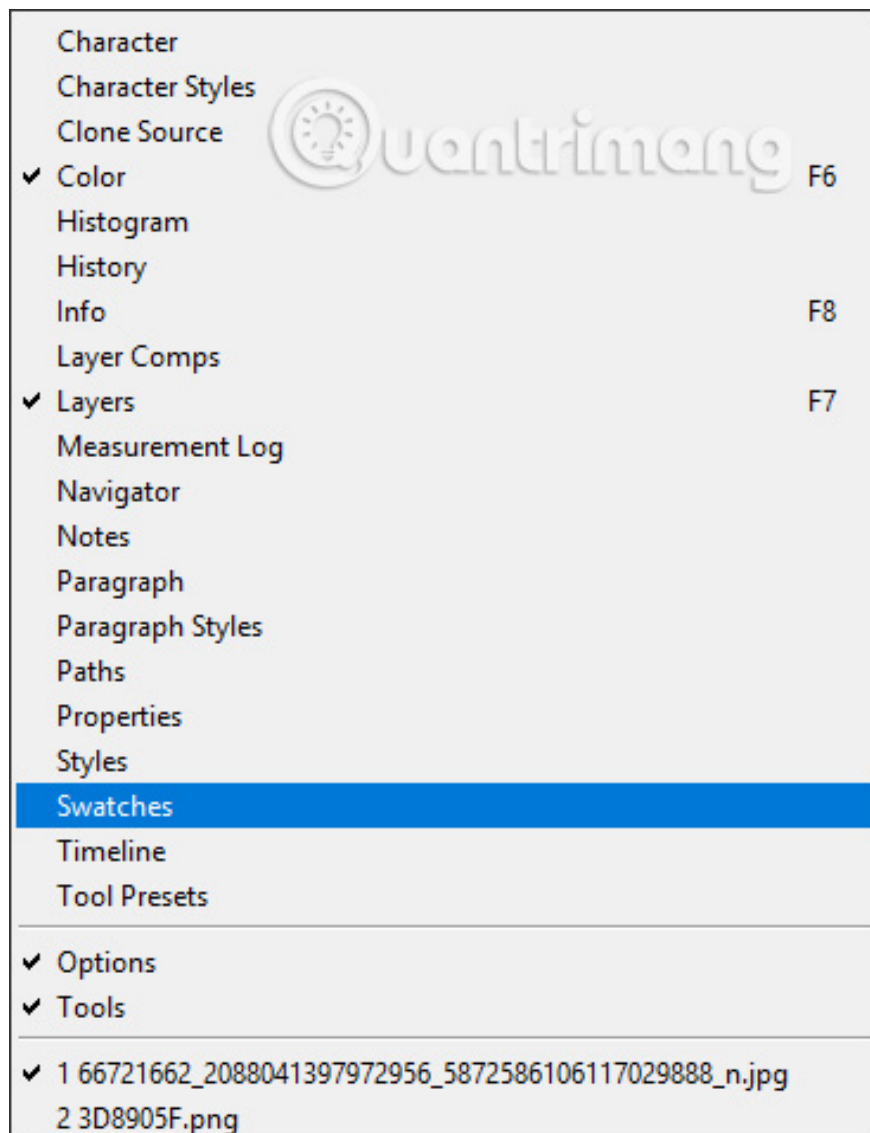

Looking to the right edge of the interface we will see the color palette for you to choose. Usually to make the image border blur you should choose black or white background.

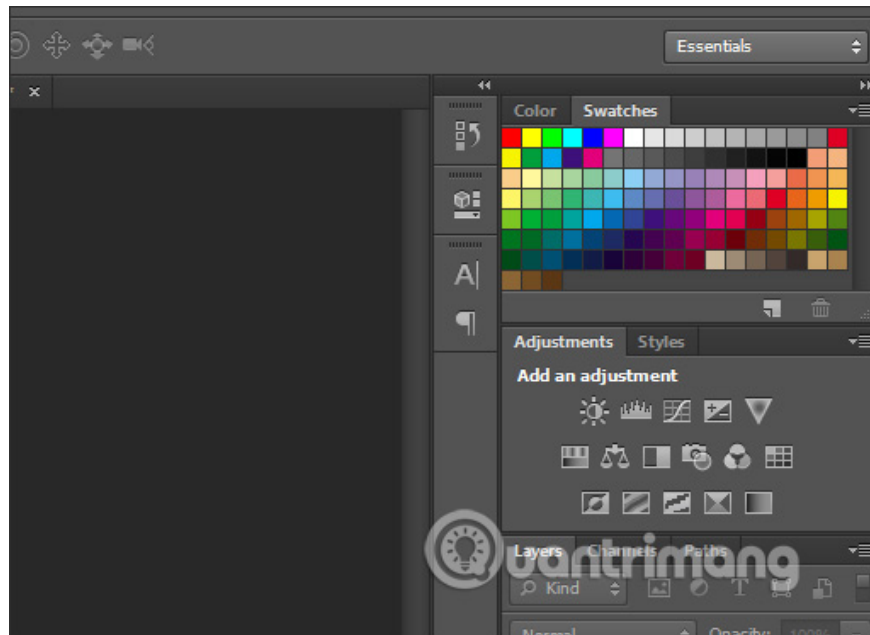

Step 5:

Click **Edit**, select **Fill** or press Shift + 5. Display the setting interface, in the **Contents** section, select **Foreground Color** and **Opacity at about 70** to reduce the intensity of the background border color. Finally click OK.

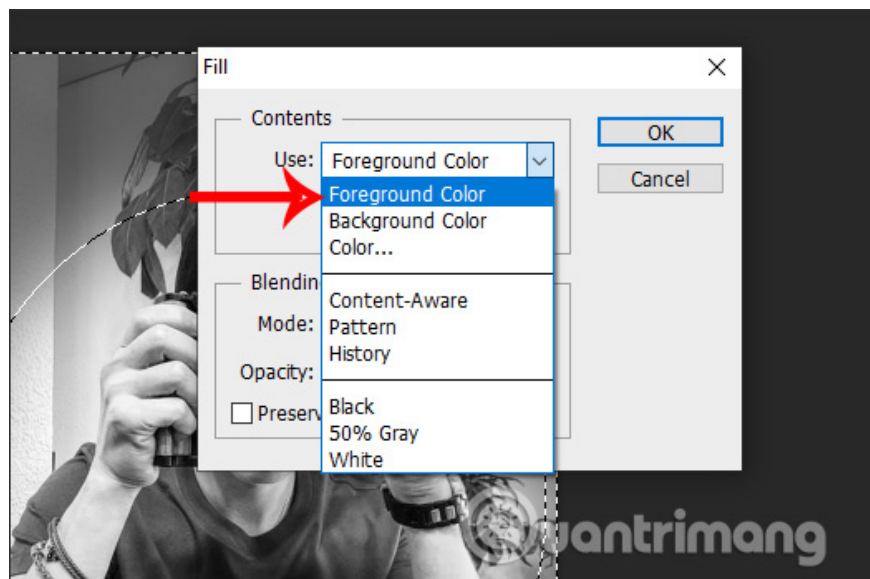

The result you will see around the image is covered by a colored background layer as shown below. If you prefer a darker border, increase the Opacity.



You finished reading the article "**How to create a blur border in a Photoshop image**" edited by the [TipsMake](#) team. We hope this article has provided you with many useful tech tips and tricks. You can search for similar articles on tips and guides. Thank you for reading and for following us regularly.
