

# How to control auto-fix feature on iPhone / iPad

The Auto-Correction auto-correction feature on iOS devices sometimes annoys users when we edit text content.

Auto-Correction auto-correction feature is available on both Android and iOS devices. For those who often have to send work email, or simply text, chat on Facebook, . this feature will help you fix spelling errors automatically. However, in fact, this feature is not used by many people, because in case you want to type a special character, the automatic correction of spelling errors will be annoying when using. The best way to turn off this feature is to make it easier to enter text.

Besides, during text editing, iOS will set up some customizations and you can control them so that text entry is easier. The following article will suggest users some settings to control the automatic correction of spelling errors on iOS devices.

## 1. Turn off automatic correction of spelling errors on iPhone / iPad:

How to disable automatic error correction on the device is very simple. Go to **Settings> General> Keyboard** . At the keyboard setup interface, you will see a lot of different options, **pushing the horizontal bar to the left at Auto-Correction** to turn off auto-correction.

No SIM

4:38 PM

90% 

## Settings

 Bluetooth OFF >

 Cellular No SIM >

 Notifications >

 Control Center >

 Do Not Disturb >

 General >

 Display & Brightness >

 Wallpaper >

 Sounds >

 Siri >

No SIM

3:45 PM

94% 

[< Settings](#)

General

Background App Refresh >

Restrictions

Off >

Date & Time >

Keyboard >



Language & Region >

Dictionary >

iTunes Wi-Fi Sync >

VPN

Not Connected >

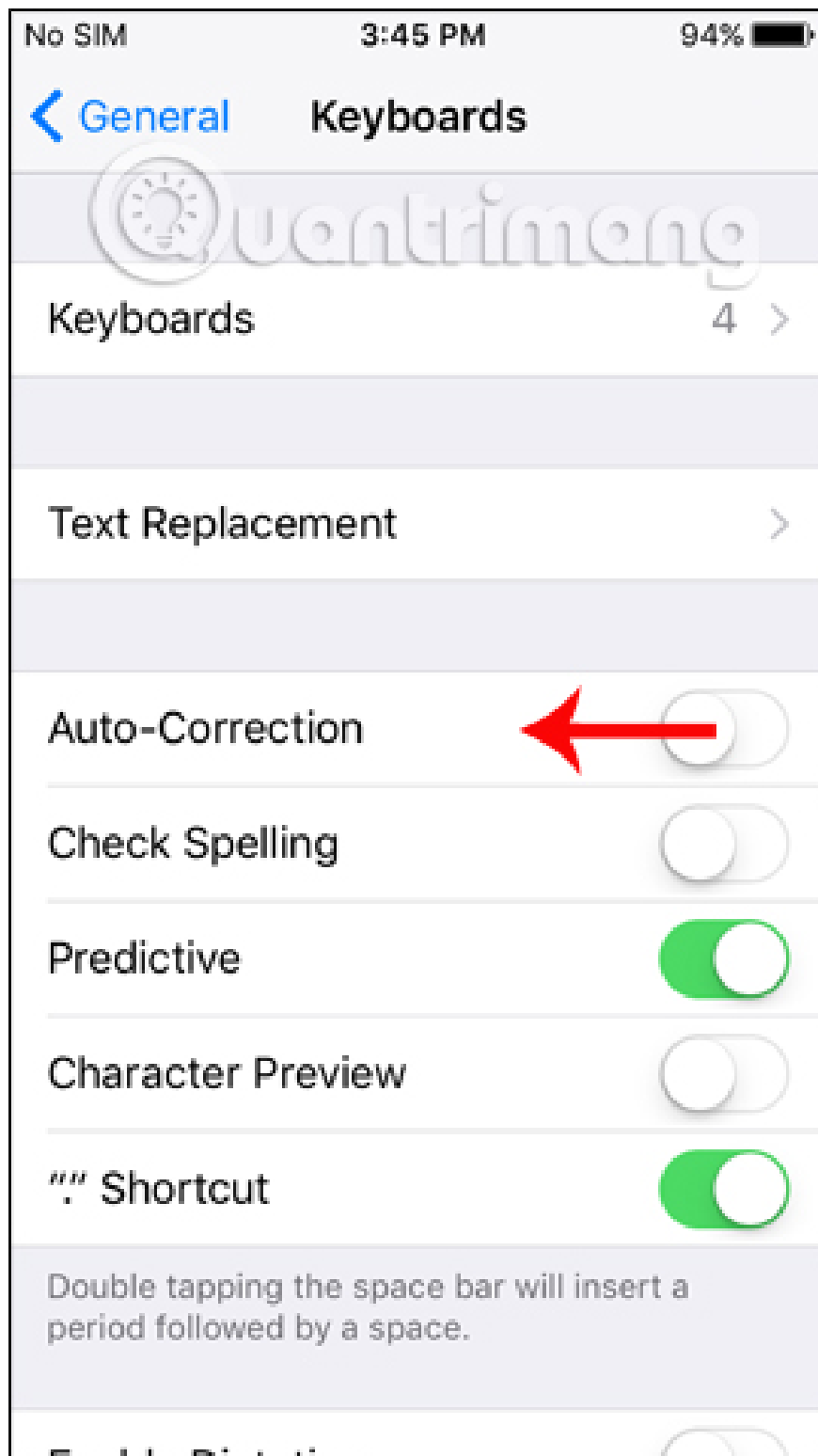

## 2. Set up your own dictionary:

To be able to type in a specific word, a specific noun or word that we often use, we can set the abbreviation in the text replacement section. Thus, if you need to enter the word just press the abbreviated abbreviation to display the complete content.

Go to **Settings**> **General**> **Keyboard**> **Text Replacement** .

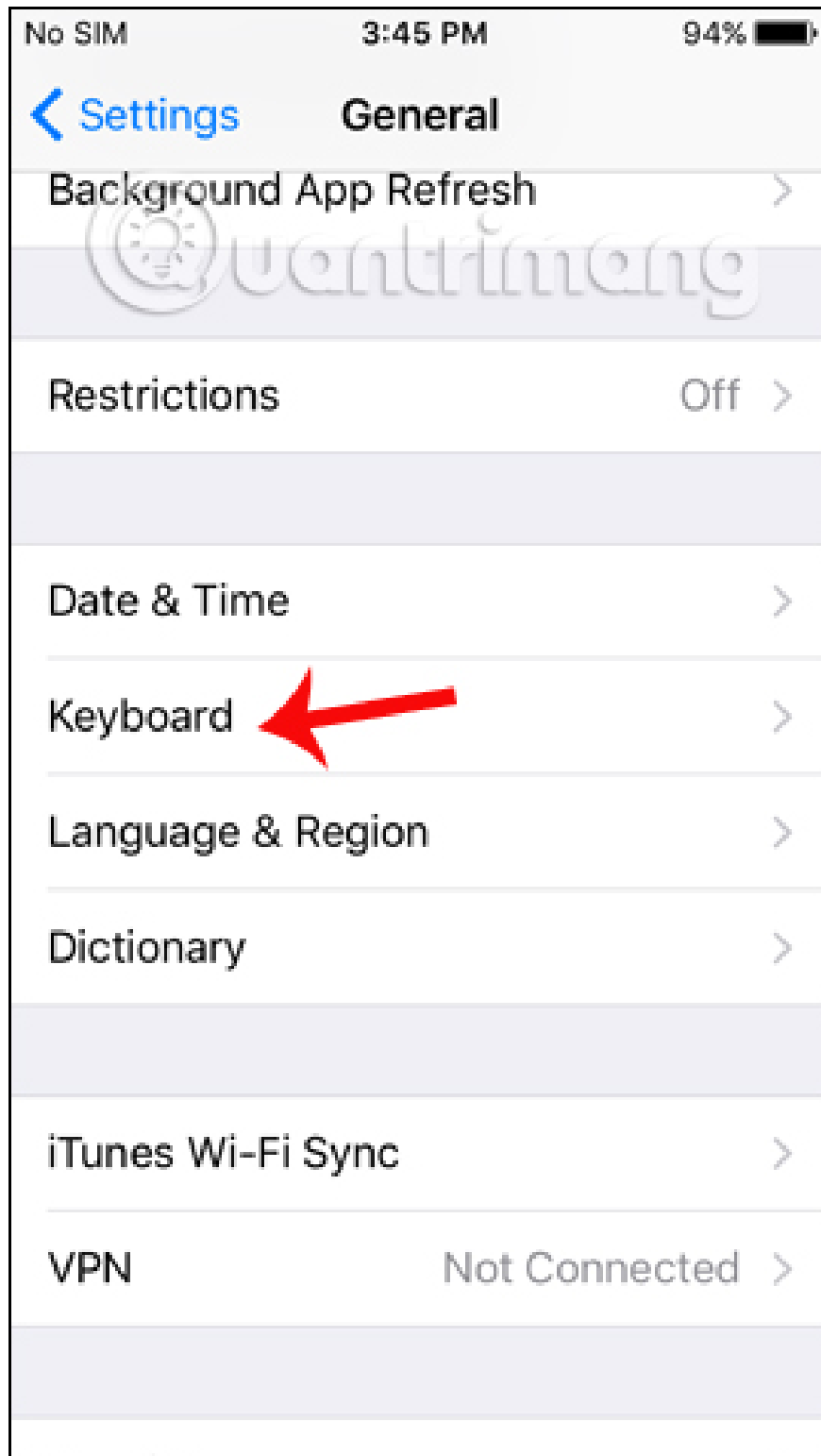

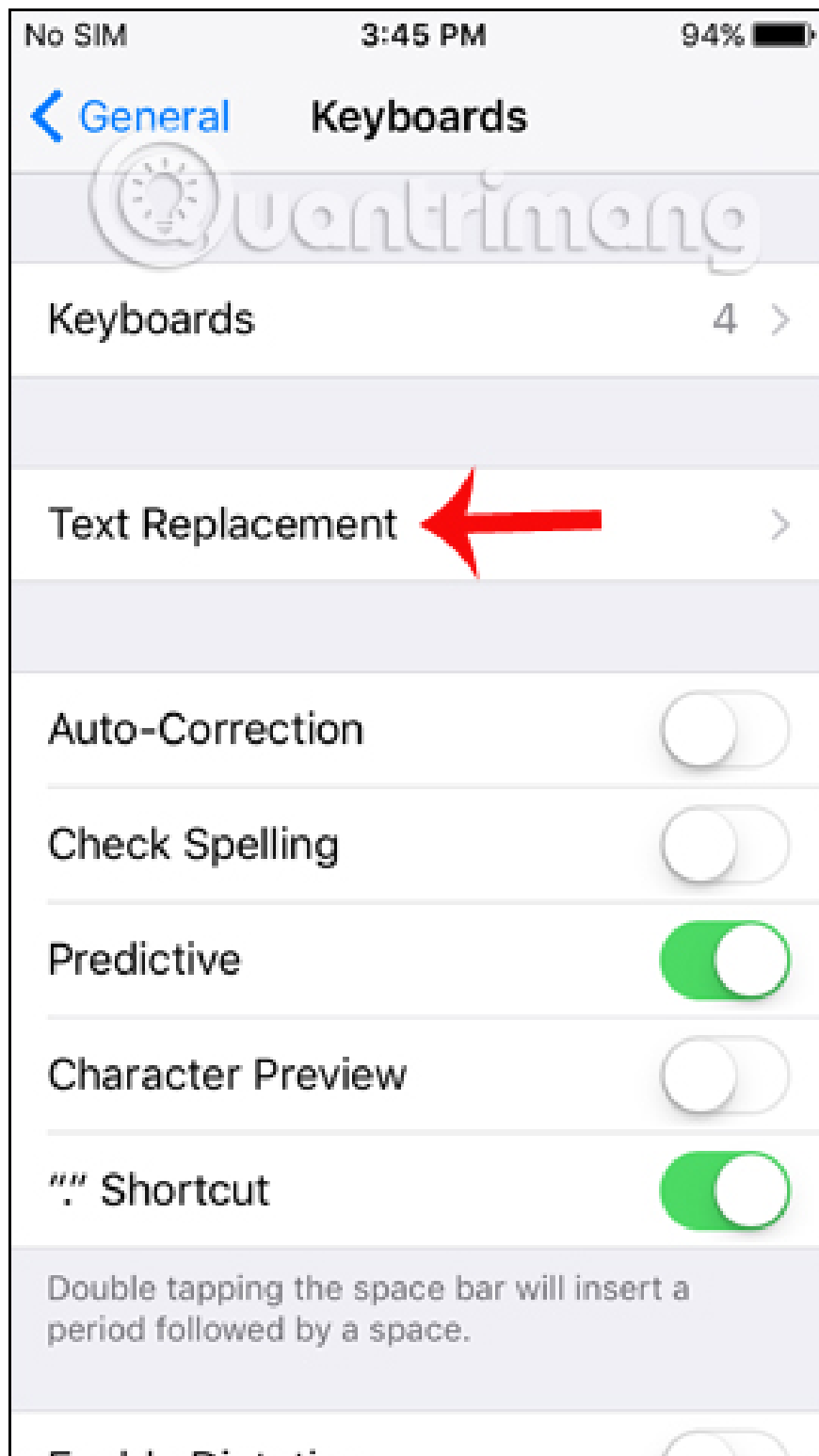

Then click the plus sign above to add complete word content in **Phrase** and the acronym at **Shortcut** .

No SIM

3:54 PM

93% 

[← Keyboards](#) **Text Replacement**  [+](#)

 Search

**D**

dtd

Đang trên đường!

**O**

omw

On my way!

**V**

VN

Việt Nam!

 Quentrimeng

A  
B  
C  
D  
E  
F  
G  
H  
I  
J  
K  
L  
M  
N  
O  
P  
Q  
R  
S  
T  
U  
V  
W  
X  
Y  
Z  
#

[Edit](#)

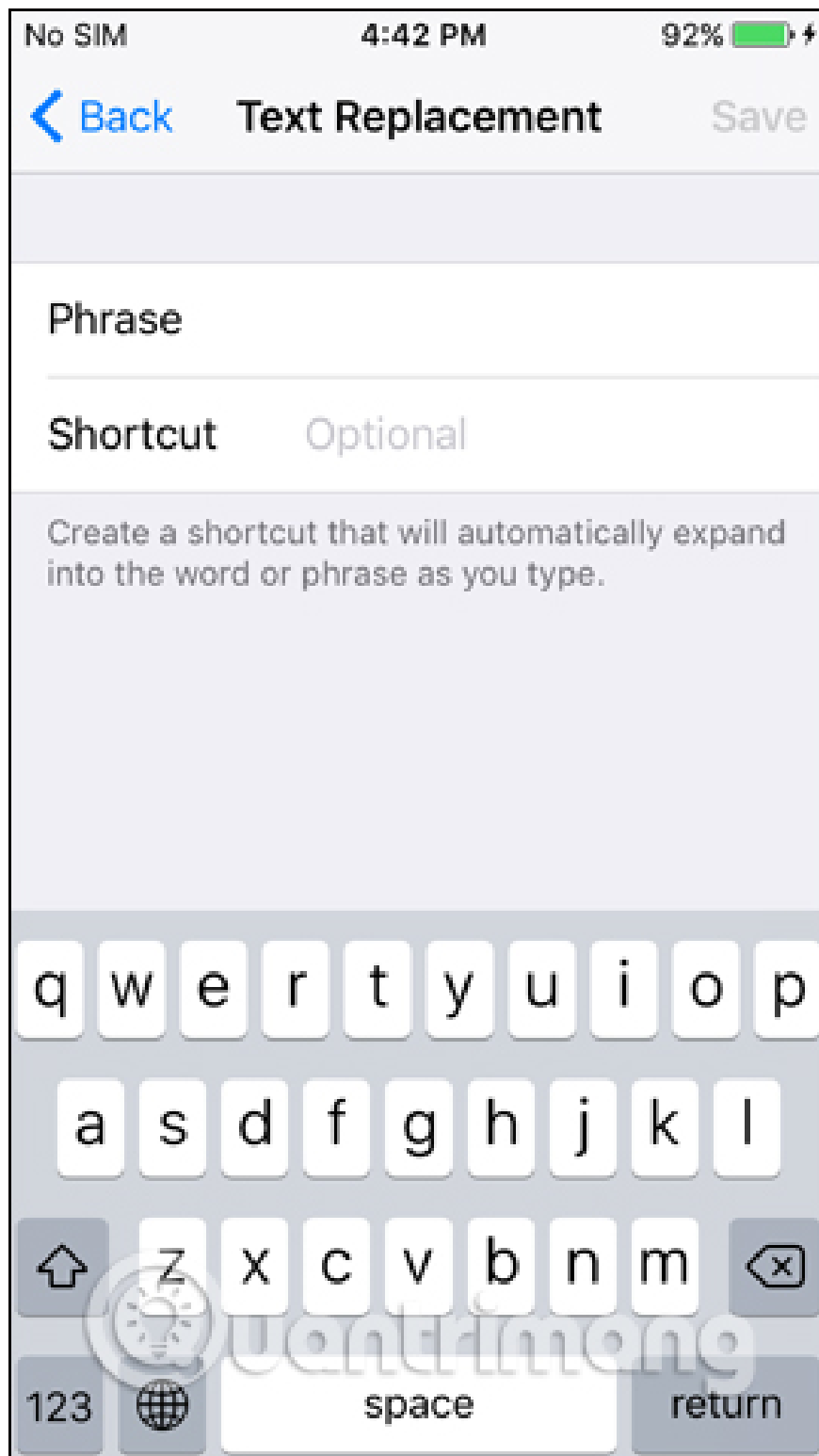

If you use a lot of acronyms, it will be harder to control after 1 time. Now you should refresh the dictionary, go to **Settings> General> Reset> Reset Keyboard Dictionary** and then click **Reset Dictionary** to reset the keyboard dictionary.

No SIM

3:56 PM

93% 

 Settings

General

Date & Time >

Keyboard >

Language & Region >

Dictionary >

iTunes Wi-Fi Sync >

VPN

Not Connected >

Regulatory >

Reset >



No SIM

3:56 PM

93% 

 General

Reset



Reset All Settings

---

Erase All Content and Settings

---

Reset Network Settings

---

Reset Keyboard Dictionary

---

Reset Home Screen Layout

---

Reset Location & Privacy

---



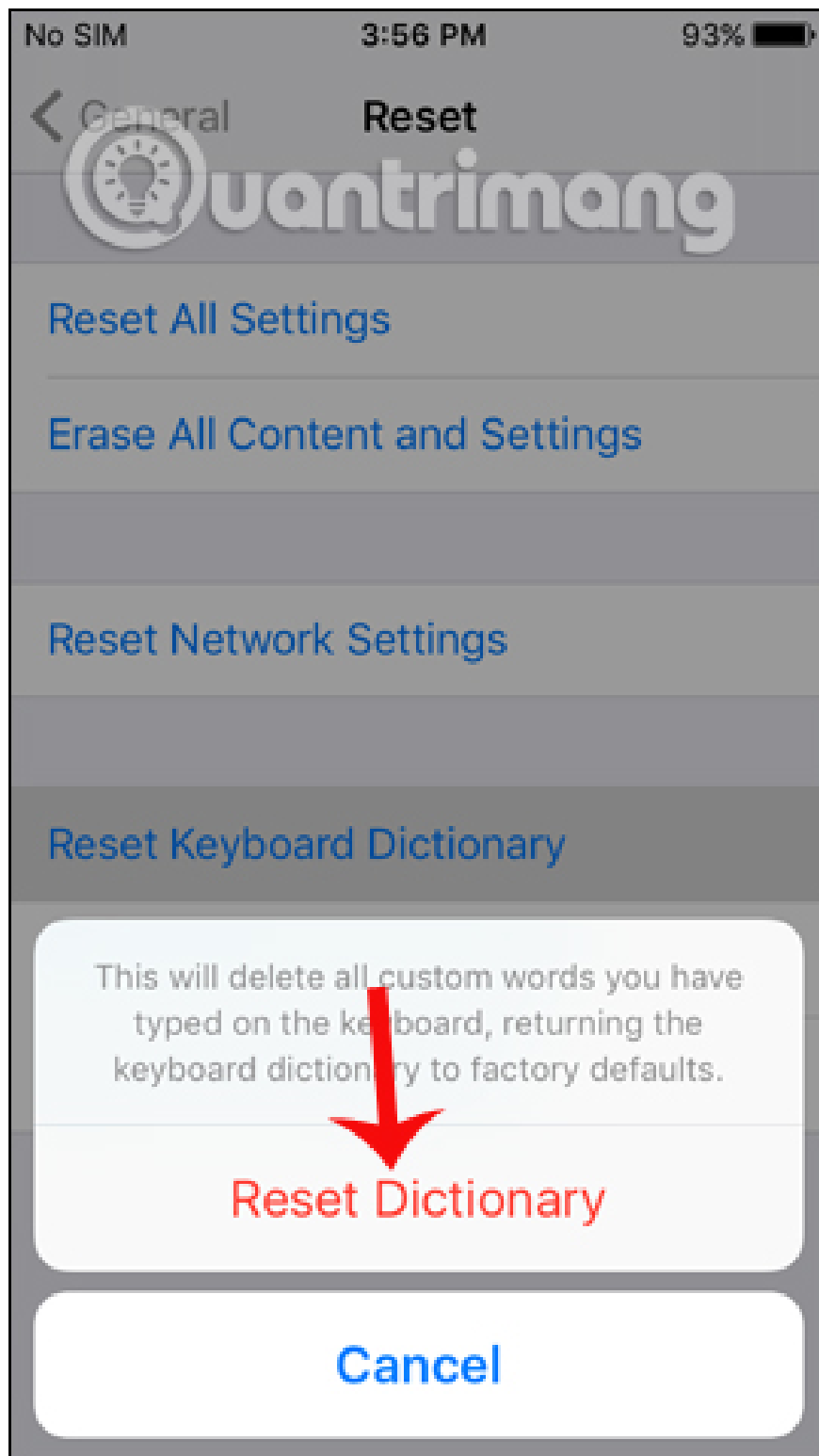

### 3. Turn off the text prediction feature:

This hint feature will help you quickly type words, when giving suggested words, based on the previous input as appropriate. But if you enter the wrong word, predict the word will also be done wrong, causing trouble for users. If you do not want to use the word suggestions, you can turn them off.

We also access **the Keyboard item** on the device and then find **Predictive** and **push the horizontal bar to the left** to turn it off.

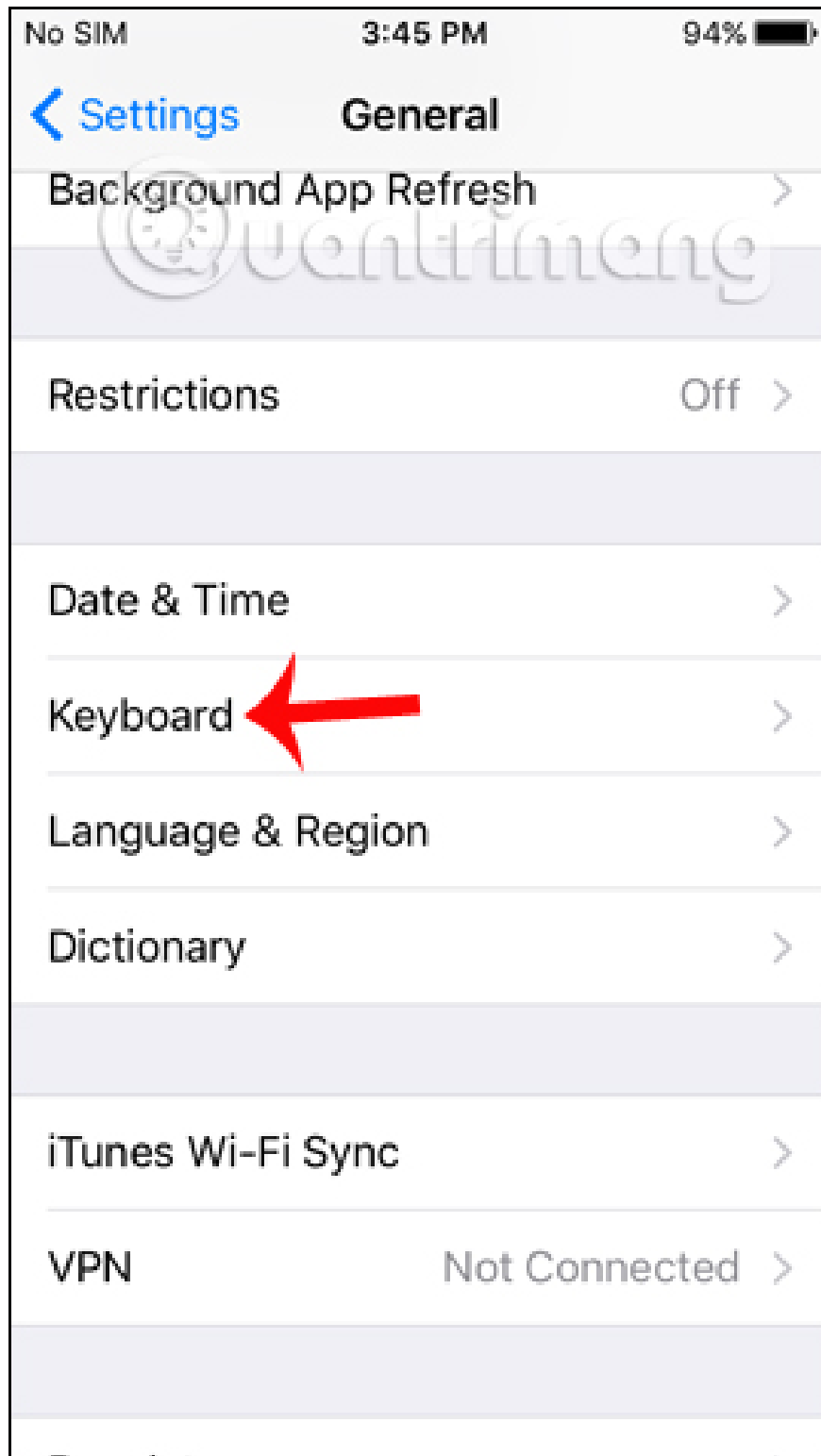



#### 4. Set up exact word suggestions:

During the import of text content, the device will give text suggestions for users to enter. But not every hint of a word is correct, may suggest a wrong word. If you want to stop suggesting these wrong words, when the suggested words appear incorrectly, turn them off. Gradually the device will stop recommending other words.

Here are some tips for you to control the input of text content, turn off the automatic correction of spelling errors on iOS devices. Depending on the usage habits of each person, we can adjust the above settings, turn off or turn on to facilitate the input.

Hope this article is useful to you!

You finished reading the article "**How to control auto-fix feature on iPhone / iPad**" edited by the [TipsMake](#) team. We hope this article has provided you with many useful tech tips and tricks. You can search for similar articles on tips and guides. Thank you for reading and for following us regularly.