

How to connect Bose Bluetooth headphones to your phone or computer.

Learn how to easily connect your Bose headphones to your phone or computer. Check out these detailed Bluetooth pairing steps for beginners.

How to connect Bose headphones is information many people search for when they first own a pair of the company's Bluetooth headphones. Although the process is quite simple, if you are unfamiliar with Bluetooth or have never paired a device before, you may find it a little confusing.

How to connect Bluetooth headphones to devices

Before proceeding, ensure the headphones have sufficient power and that pairing mode is activated. Upon the first power-on, the device will usually automatically enter Bluetooth connection mode without requiring further setup.

With a phone

Connecting Bose headphones to an Android or iPhone is similar. Simply follow the steps below to complete the setup.

1. **Step 1:** Turn on the headphones and activate pairing mode.



1. **Step 2:** Go to **Settings ? Bluetooth ? Turn on Bluetooth .**

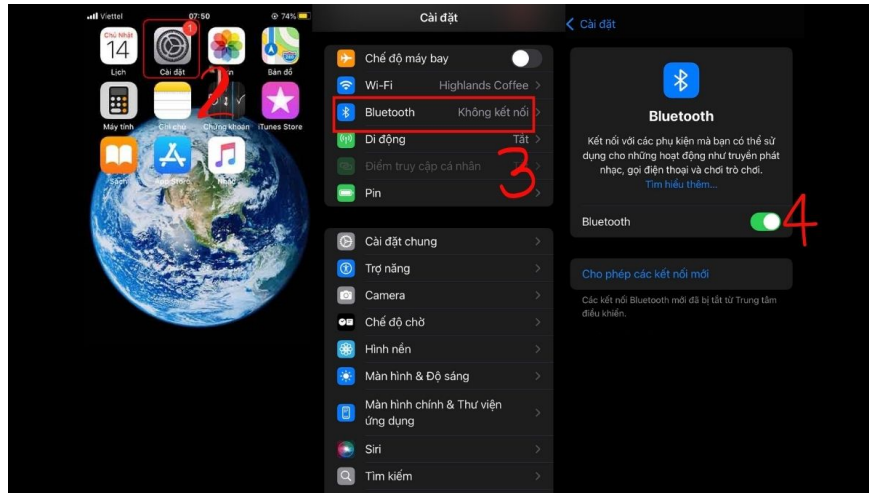

How to connect Bose headphones to an iPhone

1. **Step 3:** Find and select the Bose headphone name, then connect.

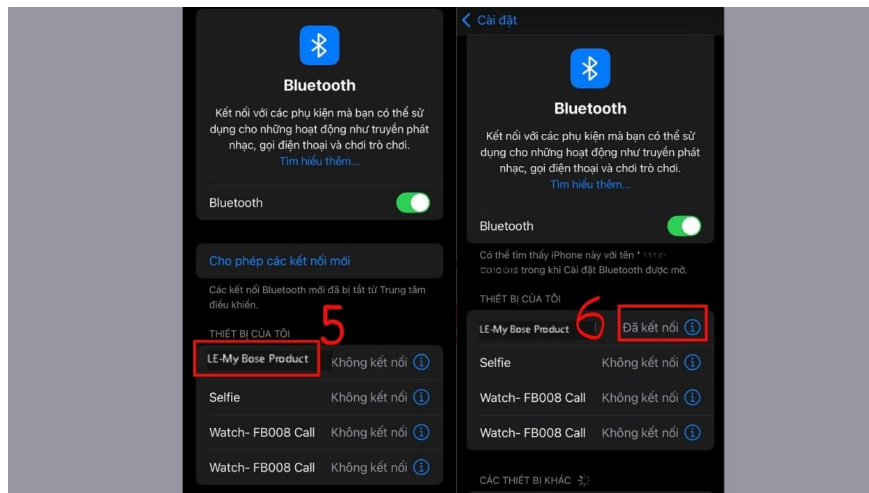

Using outdated Bose headphones inevitably results in unstable connections. Upgrade to the Bose QuietComfort Ultra with Bluetooth 5.3/5.4 for a perfect experience. Buy now and take advantage of limited-time offers!

With a laptop/computer

Connecting Bose headphones to a Windows laptop or MacBook is fairly simple, although the interface will be slightly different. If your computer doesn't have built-in Bluetooth, you can use a USB Bluetooth adapter to support the connection.

1. Turn on the headphones in pairing mode:

1. Similar to your phone, make sure your headphones are in pairing mode.



2. Open Bluetooth settings on your computer:

1. On Windows: Go to **Settings ? Bluetooth & devices ? Turn on Bluetooth.**

3. Add new devices:

1. Select ' **Add device** ' (Windows) ? **Bluetooth** and wait for the correct headphone name to appear.

4. Connection complete:

1. Select the headset and the system will display ' **Connected Mic, Audio** ', then you can use the headset to listen to music, watch movies, or participate in online meetings.

Note: These instructions are for a Windows laptop. Connecting to a MacBook is similar, but the interface is different.

Basic usage instructions for Bose headphones.

After successfully connecting your Bose headphones to your phone or laptop, you should familiarize yourself with some basic operations for more effective use. On most Bose Bluetooth headphone models, you will find physical or touch controls such as:

1. Power button.
2. Volume up/down buttons.
3. Play/pause button.
4. Call answer/receive button.
5. The button to activate the virtual assistant.

Some high-end headphone models integrate the ability to use the Bose Music app on smartphones . Through this app, users can take advantage of many supporting features and customization options.

1. Check the battery level.
2. Customize noise cancellation settings.
3. Update the software.
4. Manage connected devices.

Common problems when connecting Bose headphones

During the process of connecting Bose headphones, some common problems may occasionally arise. Below are some common issues along with basic troubleshooting steps for your reference.

The headphones don't appear in the Bluetooth list: This is a fairly common situation when users first try connecting Bose Bluetooth headphones or after resetting the device.

How to handle it:

1. Check if the headphones are already in pairing mode.
2. Turn Bluetooth off and then back on your device.
3. Restart your headphones.

Connected but no sound: This situation often confuses many people because the device indicates a connection, but the headphones still don't produce any sound.

How to fix it:

1. Check the volume levels of both your headphones and your playback device.
2. Also, confirm that headphones have been selected as the default playback device in the sound settings.

Headphones suddenly lose connection: This error can occur during use, especially when you're moving around a lot or the headphone battery is running low.

Solution:

1. First, check the remaining battery capacity of your headphones.
2. Ensure the distance between the two devices is within the permitted range (usually not exceeding 10m).
3. If the problem persists, remove the headphones from the Bluetooth list and try pairing them again from the beginning.

Tips for a stable Bose headphone connection

To ensure a smooth pairing process for your Bose headphones, you can apply a few tips. Doing it correctly will not only make the connection smoother but also help optimize battery life.

1. Maintain a reasonable distance and avoid holding the headphones too far from the device.
2. Minimize signal interference by avoiding placing the headphones near Wi-Fi routers or other high-powered broadcasting devices.
3. It is recommended to check and update the firmware periodically through the Bose Music app to ensure the device operates stably and has all the latest features.
4. If your headphones are saved to too many devices, delete some to avoid confusion when connecting.

Hopefully, this article has helped you understand how to easily connect your Bose headphones to your phone and computer. With just a few basic steps, you can quickly enjoy convenient wireless sound.

Frequently Asked Questions

Can Bose headphones connect to multiple devices simultaneously?

Some Bose headphone models support multipoint connectivity, allowing connection to two devices simultaneously. Although they can be paired with multiple devices, the headphones only play audio from one source at a time.

Do Bose headphones have an automatic connection mode?

Yes. After the initial pairing is complete, the headphones will automatically reconnect to the previously connected device when turned on. If multiple devices have been paired before, the headphones will prioritize the most recently used device.

Is it possible to connect Bose headphones to a device that doesn't support Bluetooth?

If your device doesn't have Bluetooth, you can still use Bose headphones. If:

1. The headphones support wired connection via a 2.5mm port (use the included 2.5mm to 3.5mm adapter cable to plug into the playback device).
2. You use a separate Bluetooth transmitter that plugs into the device.

You finished reading the article "**How to connect Bose Bluetooth headphones to your phone or computer.**" edited by the [TipsMake](#) team. We hope this article has provided you with many useful tech tips and tricks. You can search for similar articles on tips and guides. Thank you for reading and for following us regularly.