

How to combine Gemini with NotebookLM to improve the quality of research reports.

Some people have previously combined Gemini with Google Maps to assist with photo capture. Therefore, combining Gemini with NotebookLM is the latest experiment in optimizing the research process.

The research process in NotebookLM has a minor flaw. However, despite its meticulous selection, the information sources in NotebookLM are isolated. The world is constantly changing, with news and context located elsewhere on the web. Each tool has its own limitations. NotebookLM has changed the way people learn and work with knowledge.

Gemini is changing the way we search the web. When Google quietly integrated NotebookLM into Gemini in late 2025, many people almost missed it in the drop-down menu. After trying it out, people realized the potential of combining these two AI tools. Some had already combined Gemini with Google Maps to assist with photo taking. So, combining Gemini with NotebookLM is the latest experiment in optimizing the research process.

Gemini fills the gaps that your notebook can't answer.

Let your curated sources of information and the web communicate with each other.

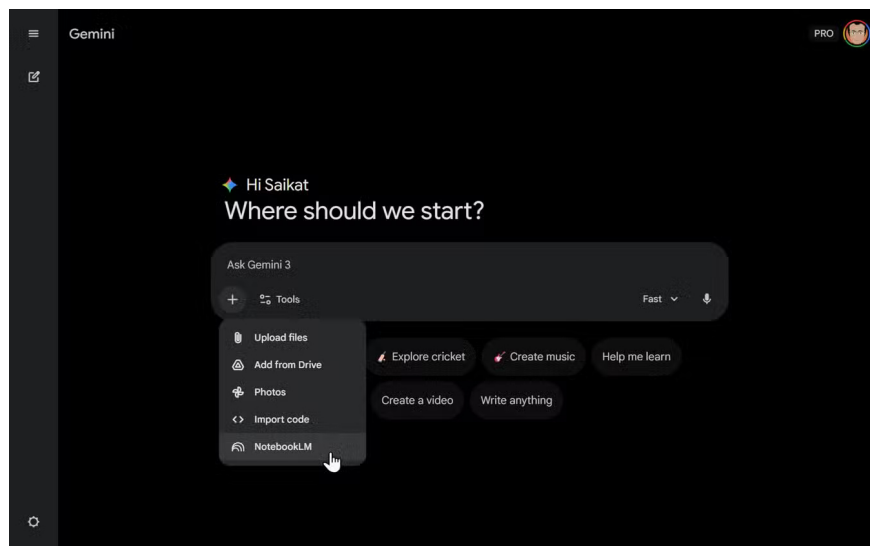

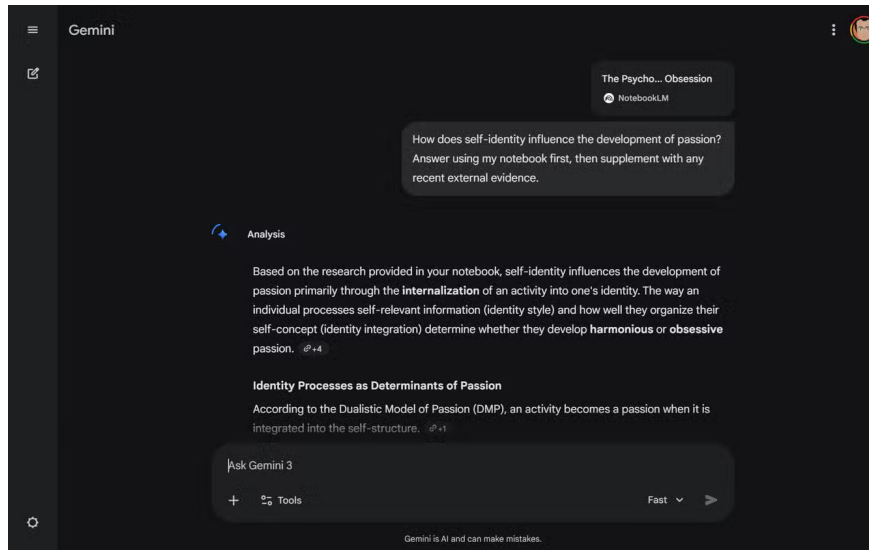
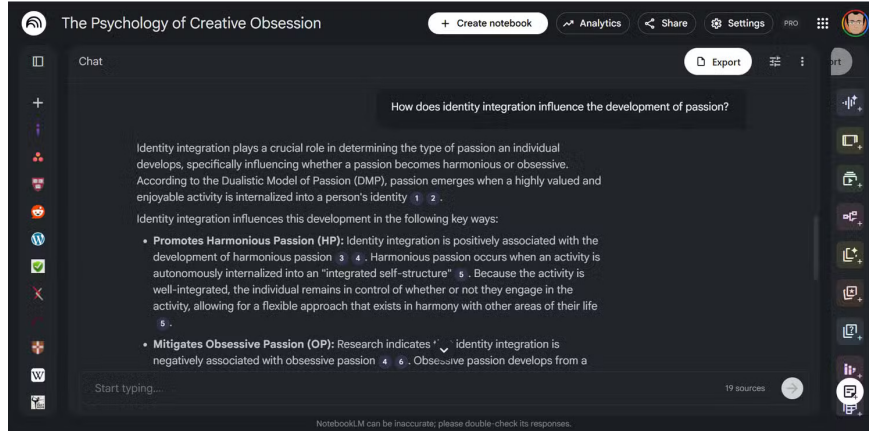

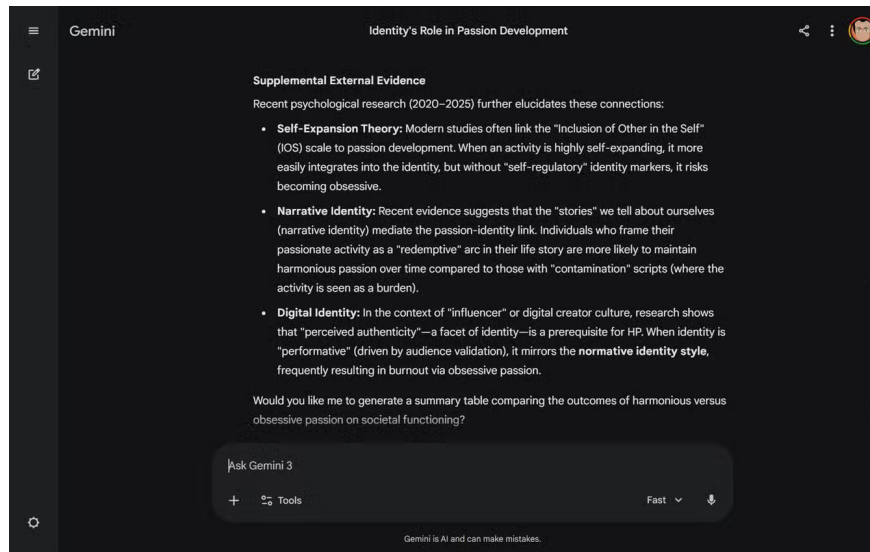

NotebookLM is very good at finding answers in the documents you choose and upload. This eliminates the illusion of it not knowing. But as soon as you ask something not mentioned in the source, it will simply say it doesn't know. Attaching your notebook to Gemini breaks that barrier. You can set Gemini to prioritize using uploaded sources, and then search the web when the initial information runs out.

The first instinct is that mixing reliable sources with open-web searches will mess up attribution. How would you know which information came from your notebook, and which came from a random, low-quality website that Gemini found? After all, Google hasn't done a good job of prioritizing the best search results.

Fortunately, Gemini is surprisingly transparent. It labels which answers come from your notebook and which come from external sources. That separation really makes managing, saving, or removing citations easier. The key is to ask clearly with a prompt:

Tr? l?i b?ng cách s? d?ng notebook c?a t?i tr??c, sau ?ó b? sung b?ng b?t k ? b?ng ch?ng bên ngoài g?n ?ây nào.

Deep Research reports will evolve into a reusable source of knowledge.

Start Gemini Deep Research and complete it in NotebookLM.

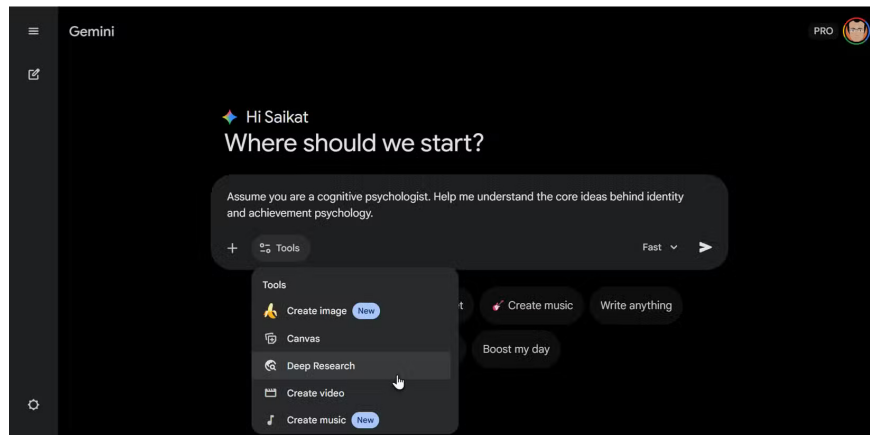

Gemini's Deep Research feature generates dense, multi-page reports by gathering information from dozens of sources (including Google Drive, Gmail, and Chat). Sometimes, the verbosity of the report makes it difficult to understand everything that needs to be understood. NotebookLM can handle this as if it were an imported source. Within a notebook, you can analyze this report the way you would analyze any other essay, with the full suite of Studio tools and intelligent prompts that make NotebookLM even more useful.

You might ask whether Gemini has already aggregated the web results into a single report, or if re-uploading them to NotebookLM is just an unnecessary step that offers no benefit? And what about NotebookLM's own Deep Research option, since both use the same underlying LLM?

The benefit here is the depth and ability to understand the issue from every angle. Gemini's report is a complete summary. For example, you can draft a strong thesis with Gemini before you start gathering sources in NotebookLM. As a NotebookLM data source, it's now the raw material for you to search for specific topics, compare with other sources you've uploaded, and create study guides or summaries from it. You're no longer just consuming research but actively working with it. You can also conduct Deep Research directly in NotebookLM by selecting the Web or Drive option from the drop-down menu.

Allows multiple notebooks to communicate with each other.

Gemini can manage more than one notebook.

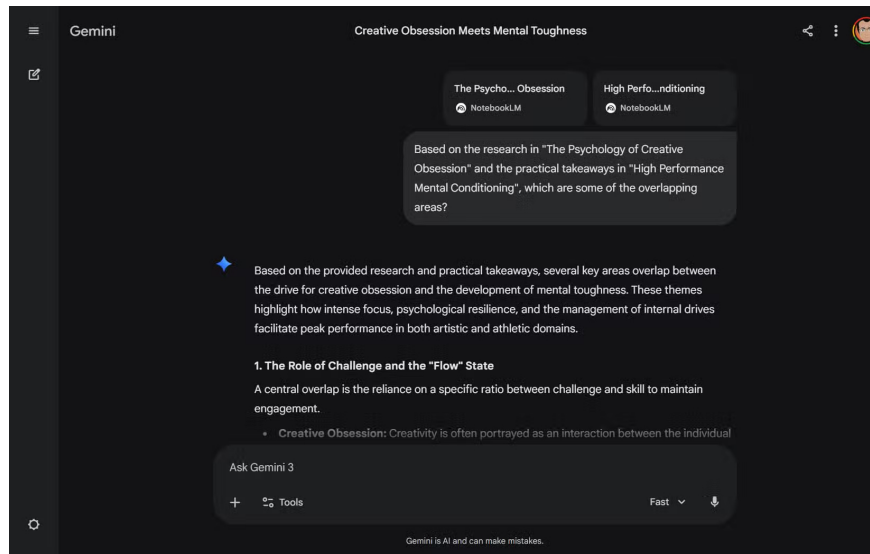

One of the biggest frustrations with NotebookLM is its isolation. Each notebook is like a separate container, which keeps things organized but hinders interdisciplinary thinking. Inside Gemini, you can connect multiple notebooks simultaneously and ask questions that encompass all of them, something NotebookLM itself hasn't been able to do naturally until now.

Many people worry that this will increase the density of knowledge and create a mess. Mixed answers could dilute the focus of each individual notebook.

The solution is specific. Instead of asking general questions, ask targeted questions, such as:

D?a tr?n nghi?n c?u trong notebook A v? nh?ng bài h?c th?c ti?n trong notebook B, ?âu là m?t s? l?nh v?c tr?ng l?p?

The risk of providing inaccurate answers remains, but this also forces Gemini to treat each notebook as a separate source of information rather than a single large block of data. Experience shows that comparing these two large notebooks is always quite time-consuming for Gemini.

A notebook might help Gemini avoid hallucinations.

Attaching NotebookLM helps control Gemini.

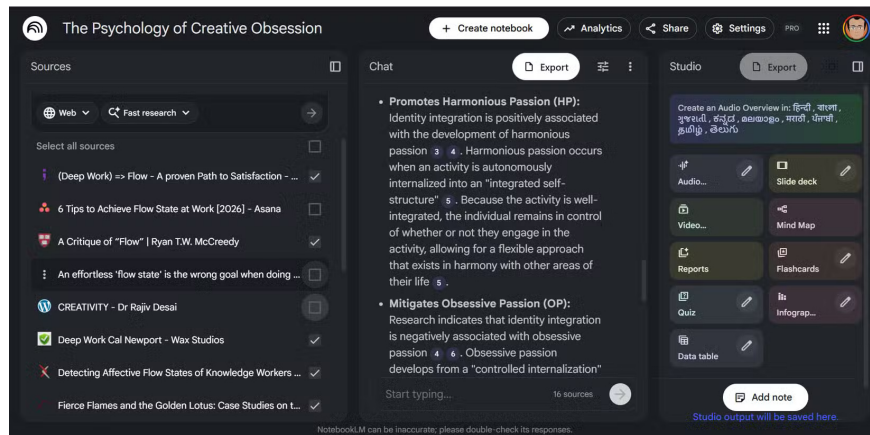

Gemini is a generative model, meaning it can and will improvise when a solid foundation is lacking. For technical writing, legal summaries, or anything where accuracy is paramount, AI illusions are a real risk. Attaching a notebook with reliable source documents forces Gemini to adhere to the rules. You can make the most of both prepared research and the search for new ideas.

But this only works if the sources in the notebook are reliable. If you upload low-quality or outdated documents, you'll only be giving Gemini a false answer that sounds confident but lacks proper citations.

This might seem counterintuitive to building better research habits. It now forces you to thoroughly vet sources instead of letting NotebookLM automatically filter them. A well-maintained notebook can become a permanent quality filter, making all Gemini results better by default.

Combine Gemini with NotebookLM for a powerful second brain.

Shifting from selective to proactive research

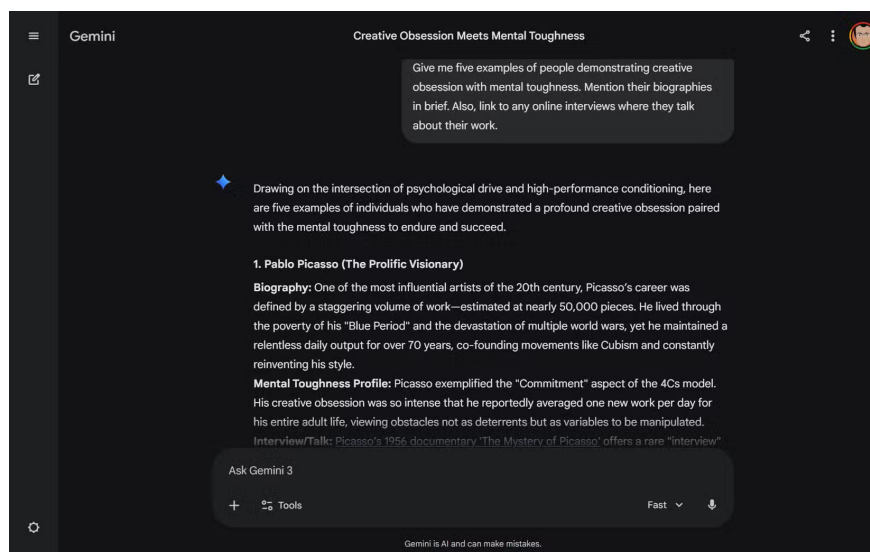

You can conduct many interesting experiments by combining Gemini with NotebookLM. For example, you sometimes find that the outlines generated by NotebookLM seem a bit dry and repetitive. It adheres so closely to

the source material that the final summary or abstract lacks real creativity or rhythm.

That's where Gemini comes into play for adding variety. Take a well-structured but boring outline from NotebookLM, then you can ask Gemini to add relevant examples or compelling comparisons to make your writing more engaging.

You can bring this back to NotebookLM. Then, use the Audio Overview feature to convert it into a podcast -like format . Sometimes, you can use Gemini to search for relevant YouTube videos and convert them into learning podcasts on NotebookLM.

You finished reading the article "**How to combine Gemini with NotebookLM to improve the quality of research reports.**" edited by the [TipsMake](#) team. We hope this article has provided you with many useful tech tips and tricks. You can search for similar articles on tips and guides. Thank you for reading and for following us regularly.