

How to change the computer wallpaper according to the amount of battery

To change Windows background image according to time or battery amount, you can use Chameleon application.

Previously, setting computer wallpaper was relatively simple, often using still images. However, later there were many software to change the background image in many special ways such as placing video as a Windows wallpaper, or changing the computer background.

Chameleon is a completely free open source application to automatically change the wallpaper according to various options such as battery capacity, weather, etc. Background images will be selected according to the image available in the album and us. Can set wallpaper as you like. The following article will guide you how to use Chameleon on Windows 10.

1. How to automatically change wallpaper in real time Windows 10
2. Error 'can't change desktop wallpaper' on Windows 10, this is how to fix it
3. How to prevent anyone from changing Windows wallpaper?

Instructions to change Windows 10 wallpaper with Chameleon

Step 1:

Users access the link below to download the Chameleon application to their computer. There are 2 versions for Windows 64-bit or 32-bit Windows.

1. <https://github.com/ianmartinez/Chameleon>

Download

[Chameleon latest release x86](#)

[Chameleon latest release x64](#)

Wallpaper Pack:

A collection of high quality 4K wallpapers for each setting. You can use them as the Chameleon executable and launching the program. On startup, it will download and apply the images. This may take a while (a couple minutes), depending on your CPU.

Minimum Requirements

Chameleon is fairly light on resources while it's running. The minimum requirements are:

Step 2:

After downloading, just click on the installation file to launch without performing the usual settings. The application icon will be displayed in **the computer system tray** .

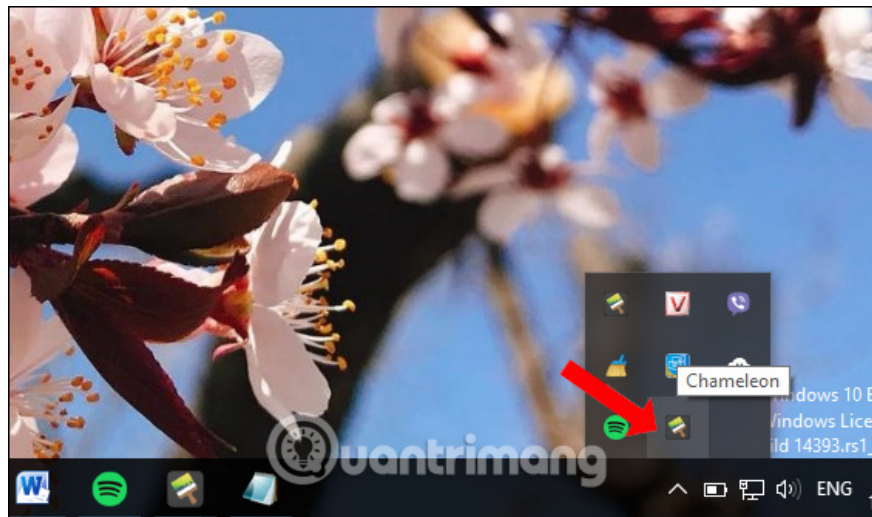

Step 3:

In the application interface, we will see there are options to change the wallpaper in the Change By section like follow battery capacity (Battery), time (Time), according to Weather Conditions, temperature (Temperature), .

For example, to change the wallpaper automatically according to the battery capacity clicked on **Battery** .

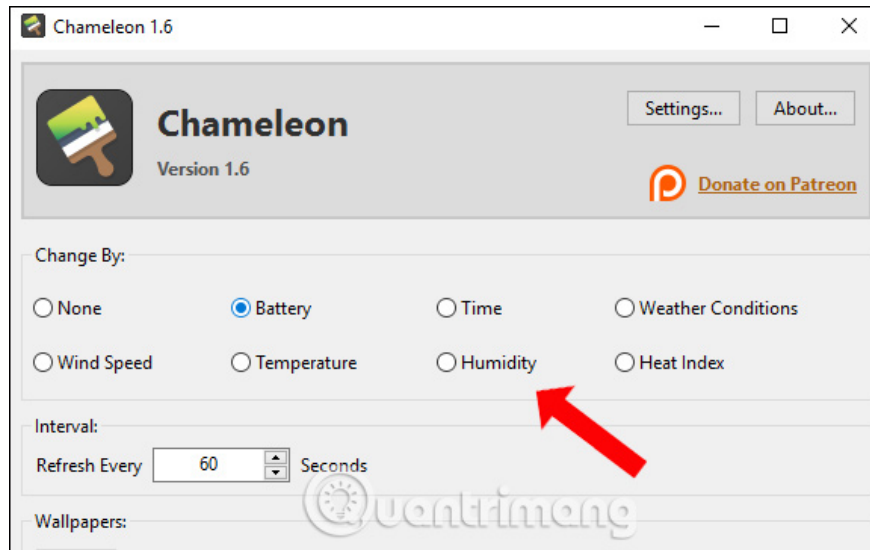

Step 4:

Scroll down to the bottom of **Wallpapers** to use to set the background image corresponding to the theme of changing the background image above. If you change the background image according to the battery capacity, click on **Battery**.

The change of background image according to the battery will be divided into Chameleon% different milestones. Click **Pick Image .** to select the wallpaper. After selecting, click **the Run button** to apply.

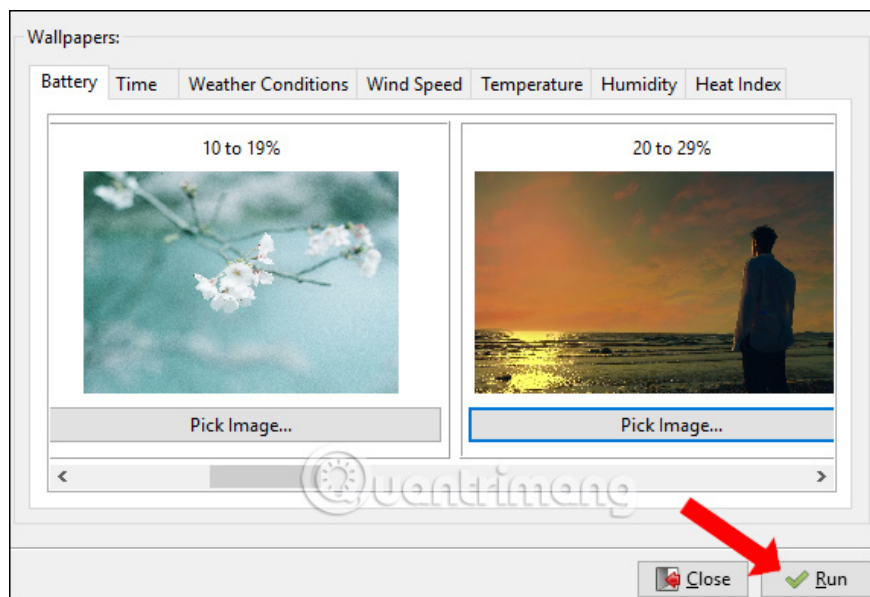

If you want to **change the wallpaper from time to time** , select **Time** at **Change by** and also select **Time** under **Wallpapers**. Photos will be changed every hour and start from 0 hours.

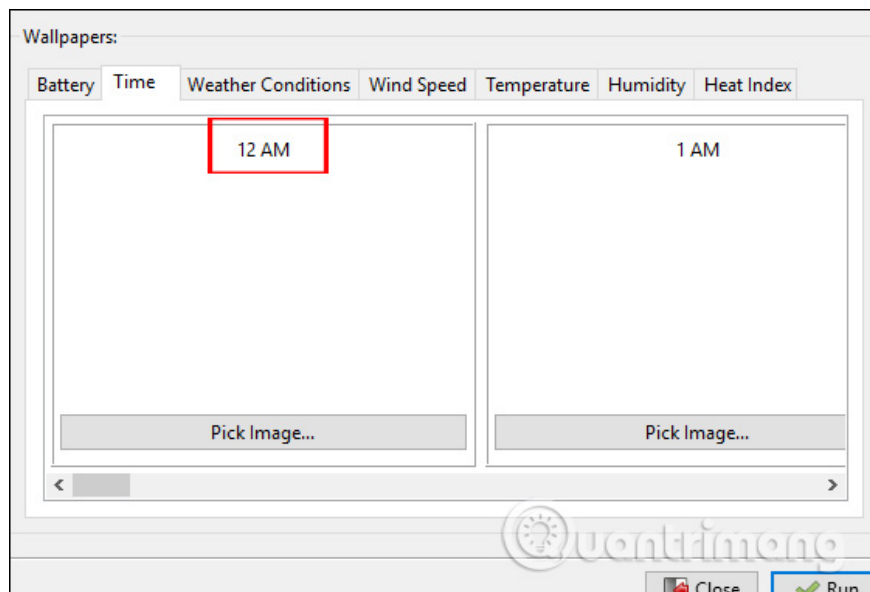

So you have more tools to refresh your desktop wallpaper. The image will automatically be changed according to the element that the user has set up.

See more:

1. 3 useful applications that automatically change Windows wallpaper
2. How to change Win 10 computer wallpaper
3. Instructions for installing different wallpapers on each Windows 10 screen

I wish you all success!

You finished reading the article "**How to change the computer wallpaper according to the amount of battery**" edited by the [TipsMake](#) team. We hope this article has provided you with many useful tech tips and tricks. You can search for similar articles on tips and guides. Thank you for reading and for following us regularly.