

How to browse the web on Chrome via voice using LipSurf

LipSurf utility on Chrome will control via voice, help you browse the web quickly.

Web browser shortcuts, or Windows shortcuts, make performing tasks faster, compared to traditional ones. So have you ever tried to browse the web by voice?

LipSurf utility on Chrome gives users the ability to control Chrome via voice, with 75 control commands for basic browsing such as opening pages, closing pages, stopping video playback, etc. The utility will provide a list of commands available. We read it every time we use Chrome. The following article will guide you how to use LipSurf on Chrome.

1. How to surf the web quickly on Google Chrome with the keyboard
2. How to control Chrome quickly by command
3. Summary of useful Windows 7 shortcuts

How to browse Chrome web by voice

Step 1:

You download the LipSurf utility under the link below and install it on Chrome browser.

1. Download the LipSurf utility on Chrome

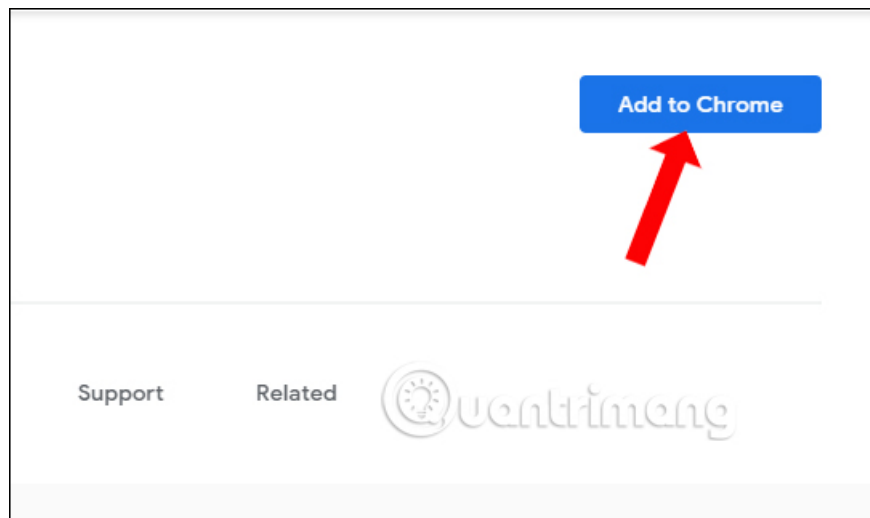

Step 2:

After the installation is completed, it will display the utility homepage. Users will be asked if they want to log in to their Google account for use, or use as a guest account.

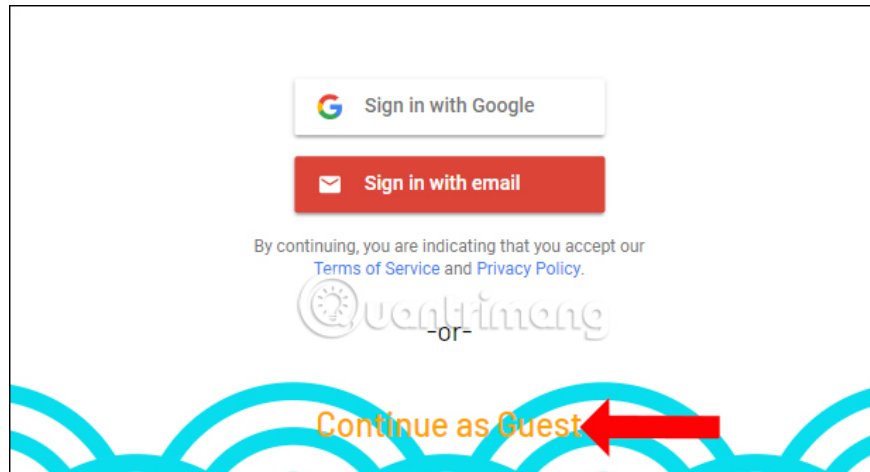

Step 3:

To use the utility, you need to agree to **use the microphone** on the browser, press **the Allow button** .

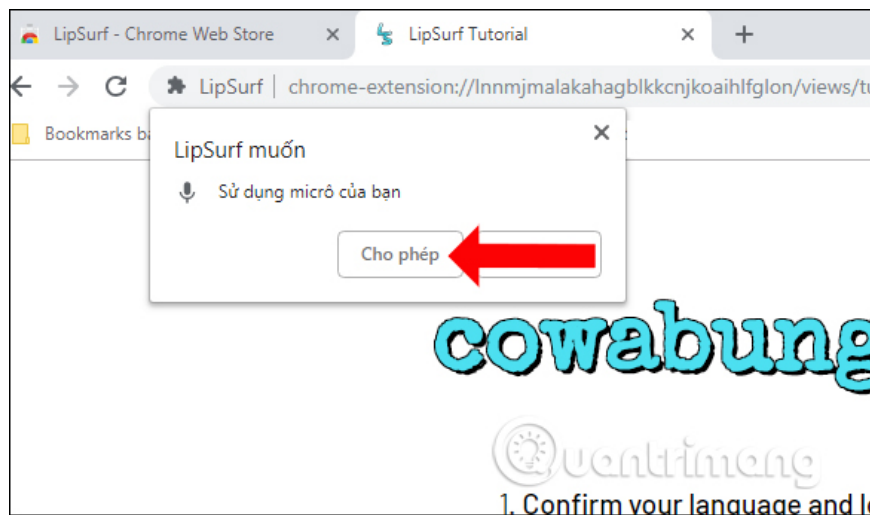

Next, the user will see the languages ??that the utility supports to use in the browser. By default English (English - US) has been selected.



Step 4:

Now **tell Next** to test the utility's voice control capabilities, and switch to the next page.

The following pages will show how to use the voice commands while browsing the web. We can see later in the Options section.

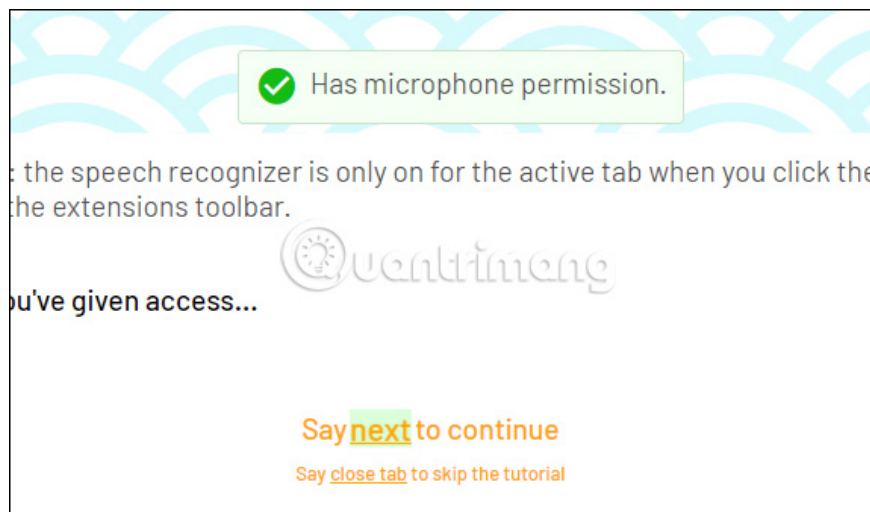

Step 5:

To view the voice commands when browsing the web, **right-click the utility icon** , click **Options** .

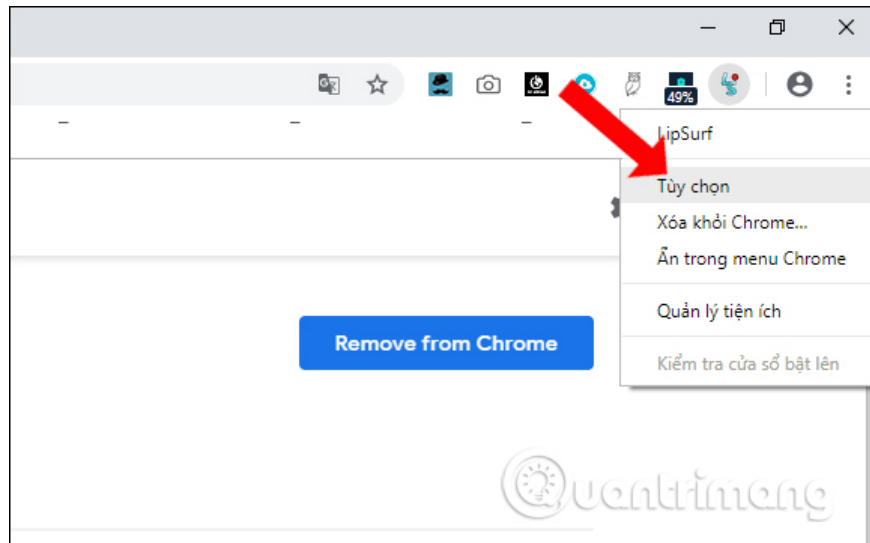

Step 6:

In the new **General** interface you will have some settings when using the utility. Users will be given the option to automatically turn off LipSurf. The default will be 5 minutes, or may increase or decrease depending on the user.

If you want the utility to work continuously, switch to 0.

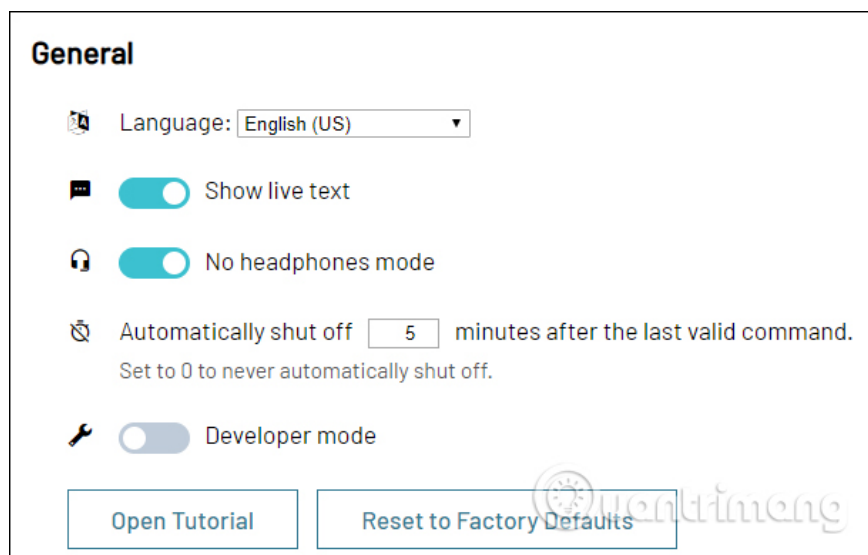

The commands are divided into different groups. In websites visited on Chrome, users will have a number of common usage commands.

1. Auto scroll / Automatic scroll: Automatically scrolls the page.
2. Scroll to top / Scroll vào ??u c?a trang / Scroll vào ??u c?a trang: Scroll to the top of the page.
3. Bottom / Bottom of the page / Bottom of the page: Scroll to the bottom of the page.
4. Open abc.com: Open abc.com page.
5. New tab / Open tab: Open a new tab.
6. Previous / Previous page: Return to the previous page.

7. Play / Play videos: Play videos.
8. Pause / Pause video: Stop playing video.
9. Mute: Mute.
10. Mute all: Mute all sounds in the browser.
11. Help: Open the help section showing support commands on the current page.
12. Settings / Options: Open the utility settings page.

In some actions there will be more than 2 commands so users can choose which commands to use, or which commands to read when needed.

Pause Video		pause pause video
Resume Video	Continue play ing a video that has already started.	resume
Refresh	Refresh the page.	refresh
Scroll Bottom		bottom bottom of page bottom scroll bottom scroll to bottom scroll to the bottom of page scroll to the bottom of the page

There are also some commands for Google such as:

1. Add event to Google Calendar / Add to Google Calendar: Add events to Google Calendar.
2. Google Calendar: Open Google Calendar.
3. Google *: Perform a search on Google.

Name	Description	Command Words
Search global	Do a google search.	google *
Google Calendar global		google calendar
Add Event to Google Calendar global		add event to google calendar add to google calendar

With some popular, popular websites, the LipSurf utility also provides commands to access.

1. Amazon: Open Amazon.com.
2. Facebook: Open Facebook.

3. Instagram: Open Instagram.
4. YouTube: Open YouTube.

Name	Description	Command Words
Youtube global		youtube
Wikipedia global		wikipedia
Facebook global		facebook
Twitter global		twitter
Instagram global		instagram
Amazon global		amazon
Ebay global		ebay
VK global		vk

Step 7:

Each command will have an on or off button. If you do not want to use any command, just **push the circle button to the left** to disable that command separately.

<input type="checkbox"/>	Visit Post	Equivalent of clicking a reddit post.
<input type="checkbox"/>	Expand	Hit the top most expando on the screen
<input checked="" type="checkbox"/>	Expand by Rank	Expand a preview of a post, or a comment by it's position (rank)
<input type="checkbox"/>	Collapse	Collapse an expanded preview (or comment if viewing comment) Defaults to top-most in the view port.
<input checked="" type="checkbox"/>	Go to Subreddit	
<input type="checkbox"/>	Go to Reddit global	
<input checked="" type="checkbox"/>	Clear Vote	Unsets the last vote so it's neither up or down.

In case you want to disable certain voice commands, switch the **On button to the Off button** .

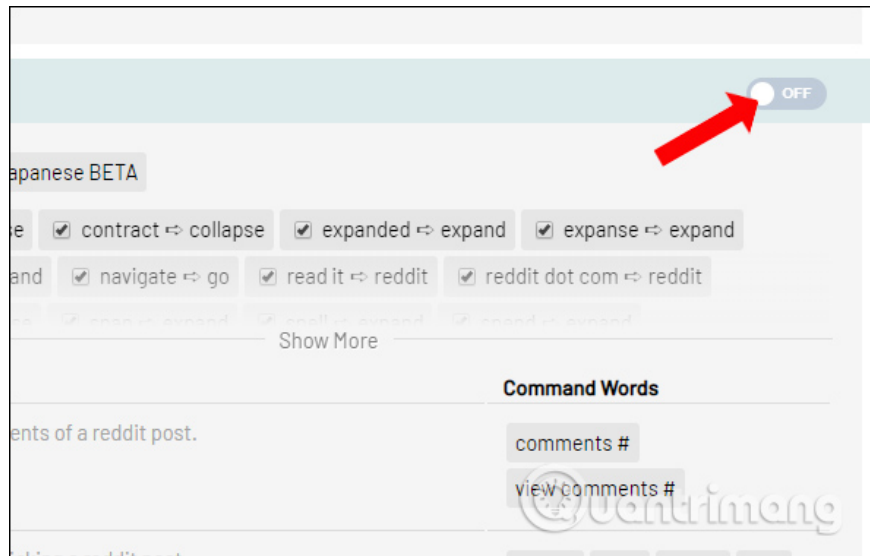

LipSurf utility brings a lot of voice control commands on Chrome. There will be commands for basic web browsing, at most websites, or controls at some special web sites. However, users should be aware that when speaking into the microphone, it is necessary to be slow and clear, so that the utility can detect the voice and execute the command.

See more:

1. Surf the web more easily with the Shift key
2. Trick to improve browsing speed with Chrome browser
3. 4 Chrome extensions to help you surf the Web faster

I wish you all success!

You finished reading the article "**How to browse the web on Chrome via voice using LipSurf**" edited by the [TipsMake](#) team. We hope this article has provided you with many useful tech tips and tricks. You can search for similar articles on tips and guides. Thank you for reading and for following us regularly.