

How to bring Night Shift feature to Mac with F.lux

F.lux is an application that reduces screen brightness on a computer, which is similar to the Night Shift feature on iPhone and iPad devices. When installing F.lux on macOS Mac, users can optionally adjust the screen color to change the screen brightness.

IOS 9.3 operating system has been updated to add Night Shift feature for iPhone and iPad devices. This feature will help reduce the brightness on the screen, especially the effect of screen brightness on the user's eyes when used at night.

So want to use the Night Shift feature on Macbook computers, how does iMac run macOS? On MacOS operating systems, the Night Shift feature is still in beta. However, users can bring this special Night Shift feature to macOS, using a third-party F.lux application. In the following article, we will show you how to adjust the brightness on a Mac with F.lux.

Step 1:

First of all, we download the F.lux software on the Mac following the link below.

1. Download the free F.lux software

Next, users proceed to install F.lux application on Mac as if installing other applications.

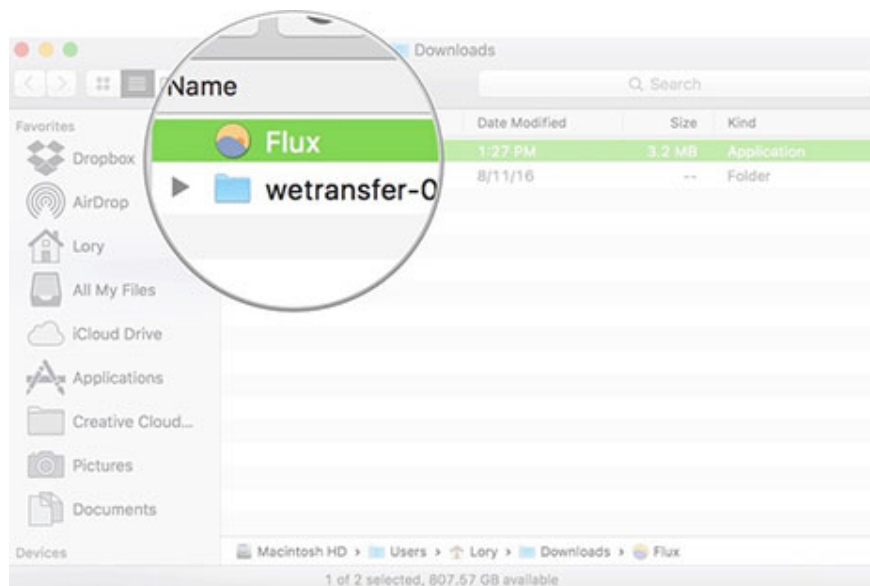

Step 2:

After installation is complete, a small message box of F.lux will appear, click **Open** . Then, click **Move to Applications Folder** to move the application to the appropriate location to use if you have a need.

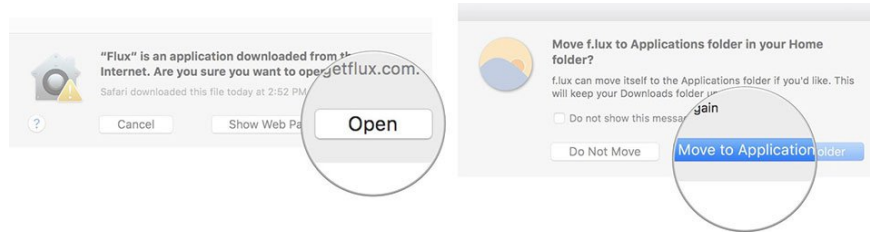

Step 3:

Go back to the Mac's screen interface. In the Menu bar above, you click on **the circle icon of F.lux** . Continue to select **Preferences** .

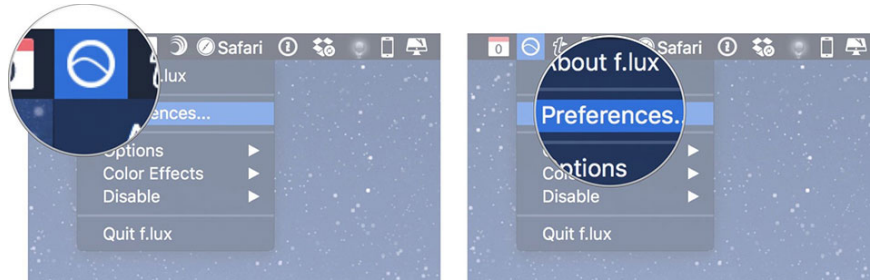

Step 4:

At the F.lux Preferences dialog box, **click Recommended colors** and **select Custom colors** . After that, click on **Daytime** below. Now, users **drag the color effect slider to the left** to change the screen brightness and color , thereby reducing or increasing the number of screen effects **from waking up to sunset** .

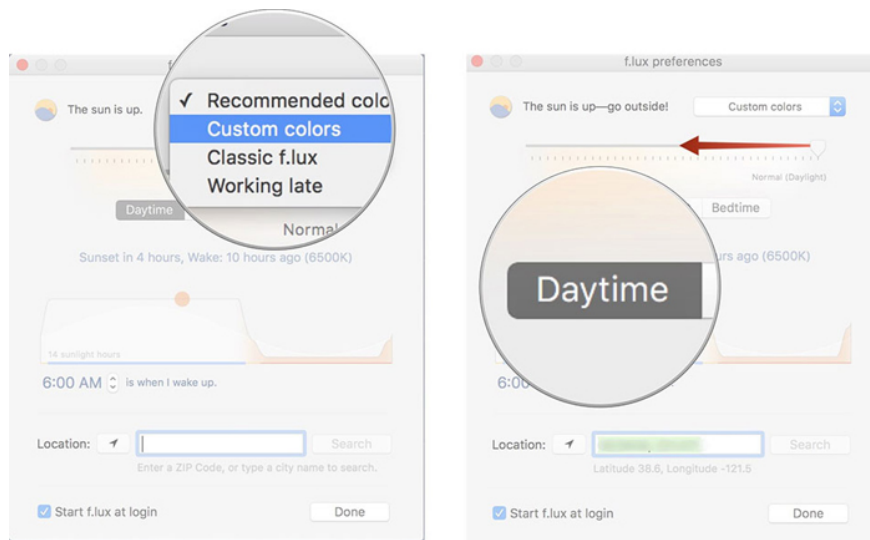

Step 5:

Next, the user **clicks Sunset** and **adjusts the color effect slider to the side** to change the screen's brightness and colors to increase or decrease the screen effect **from sunset to sleep** .

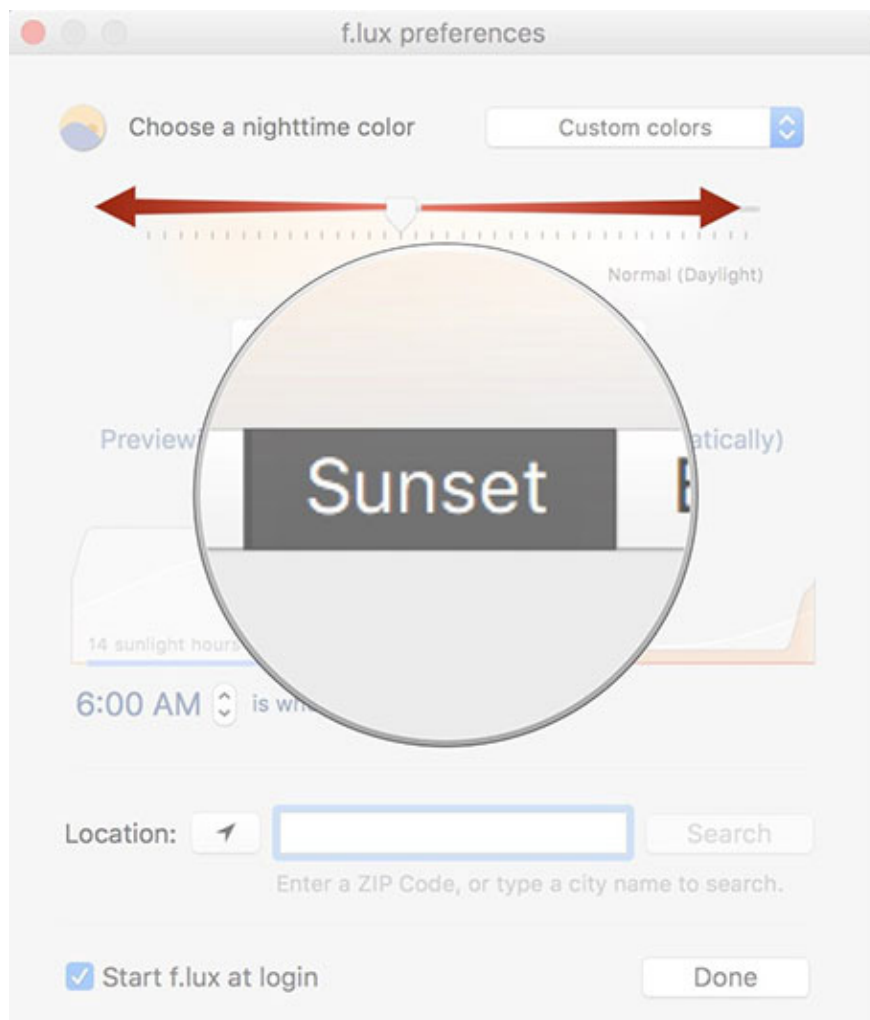

Step 6:

Click on **Bedtime** , **drag the slider left or right** to change the brightness and color to reduce or increase the number of effects from the time **before going to bed until the next morning** .

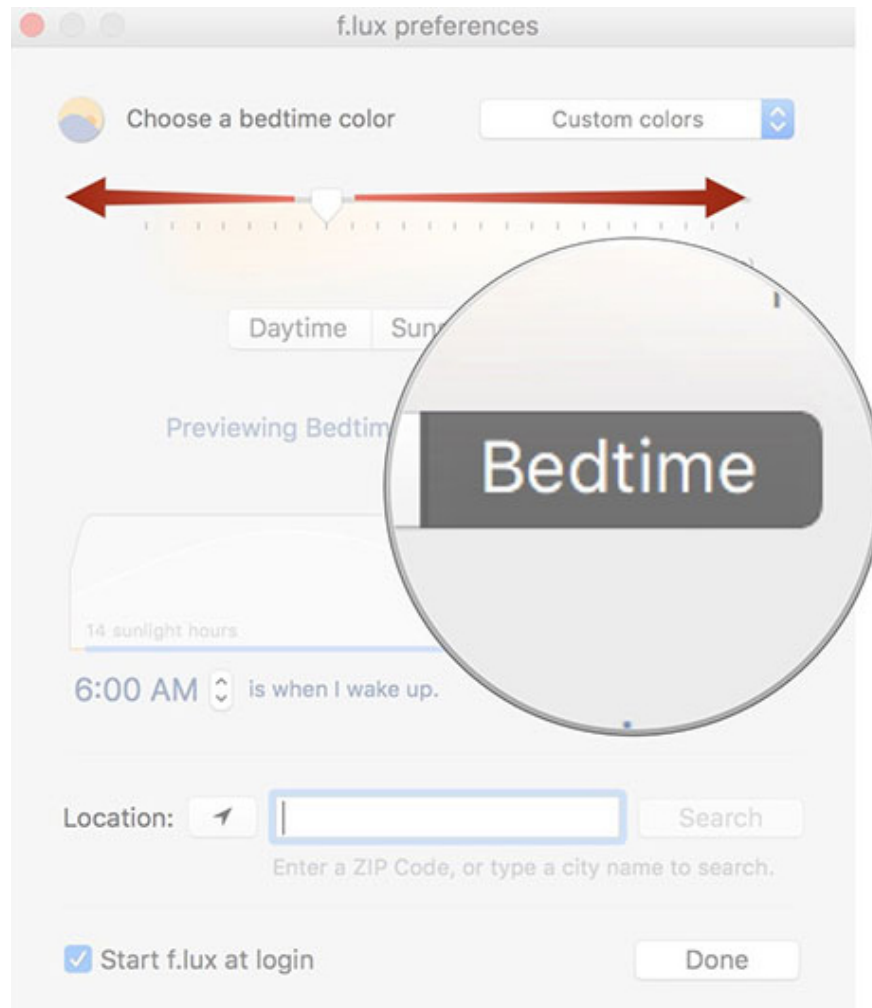

Depending on the user wants to adjust the screen effect at any time, click on that item. Overall, the F.lux application has a similar feature to Night Shift on iOS 9.3 operating system, enabling users to change the screen colors on macOS, reducing the harmful effects of screen lighting when using use.

Refer to the following articles:

1. Instructions on how to install macOS Sierra (clean install) 10.12 on Mac
1. How to create a MacOS Sierra installed USB drive 10.12
1. Old Mac acceleration runs as fast as when you first bought it with these tips

I wish you all success!

You finished reading the article "**How to bring Night Shift feature to Mac with F.lux**" edited by the [TipsMake](#) team. We hope this article has provided you with many useful tech tips and tricks. You can search for

similar articles on tips and guides. Thank you for reading and for following us regularly.
