

How to add unsupported cards to Apple Wallet

Apple Wallet will only add international credit and debit cards and other cards will not be added. However, when you install the Pass2U app, you may add unsupported cards to Apple Wallet.

There is no limit to the number of cards or categories when adding via Pass2U to Apple Wallet. The article below will guide you through adding unsupported cards to Apple Wallet.

Instructions for adding unsupported cards to Apple Wallet

Step 1:

First, install the Pass2U application according to the link below.

Next at the application interface, click on the plus icon to add a card. Then the user presses Scan the barcode on the card to scan the card code.

Quantrimang



No matching pass



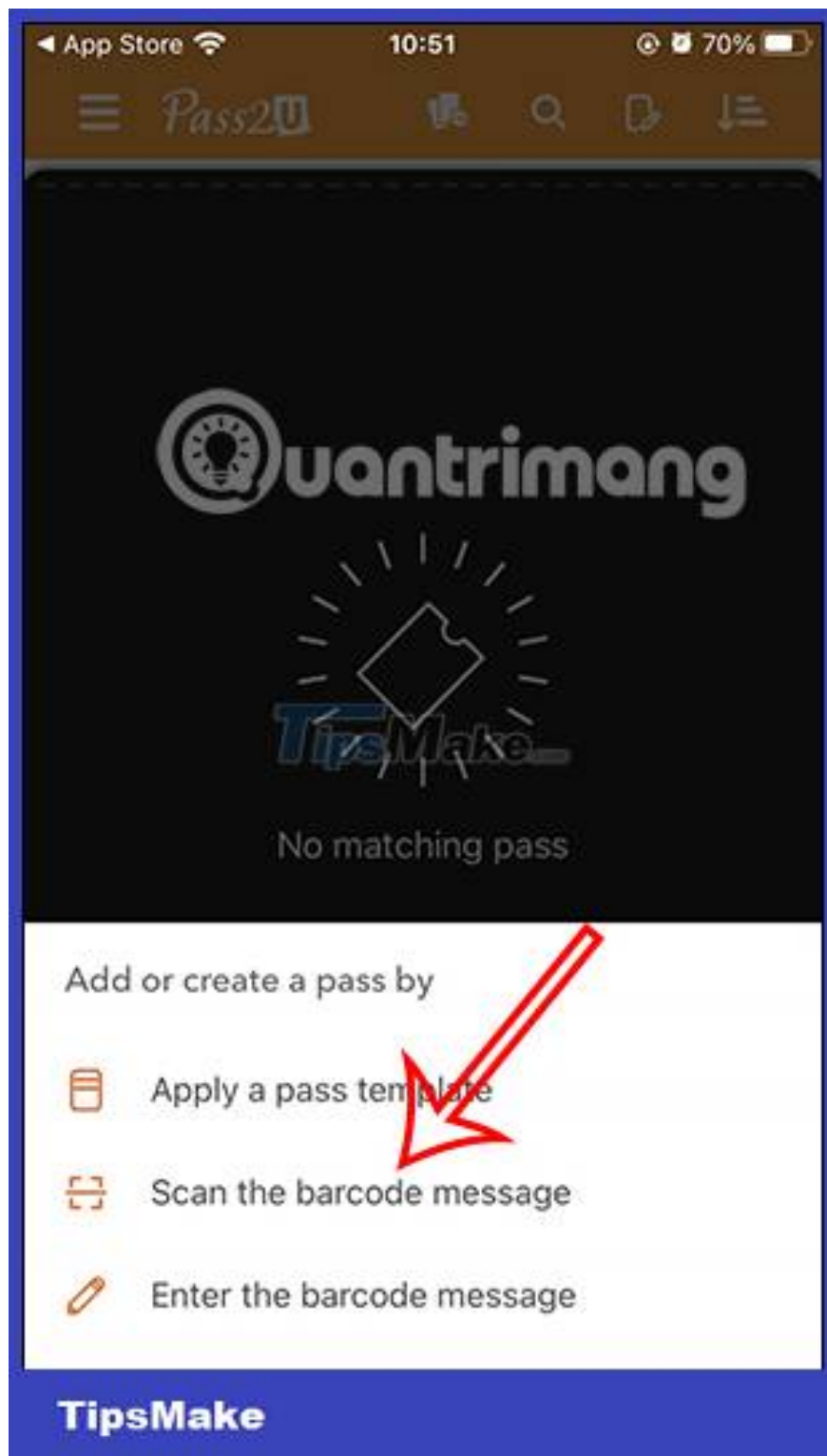

Step 2:

Now you need to agree for the application to access the camera. Then you need to align so the camera can scan the entire barcode on the card. Once scanned, the application will ask you to check if this card number sequence is correct, click OK to save.

Không có SIM

10:57

69%



Scan Code



**"Pass2U Wallet" muốn
truy cập camera**

Allow Pass2U Wallet to access
camera to capture images for
passes?

Từ chối

OK

TipsMake

Scan Code

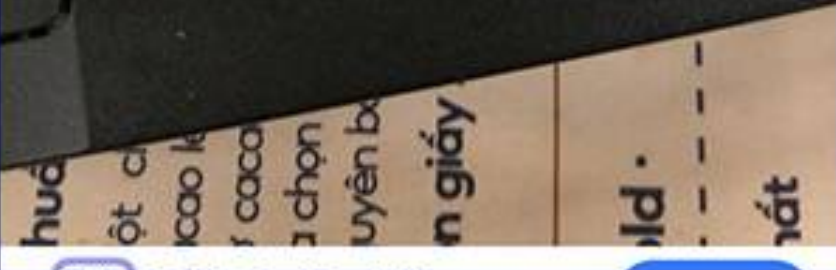

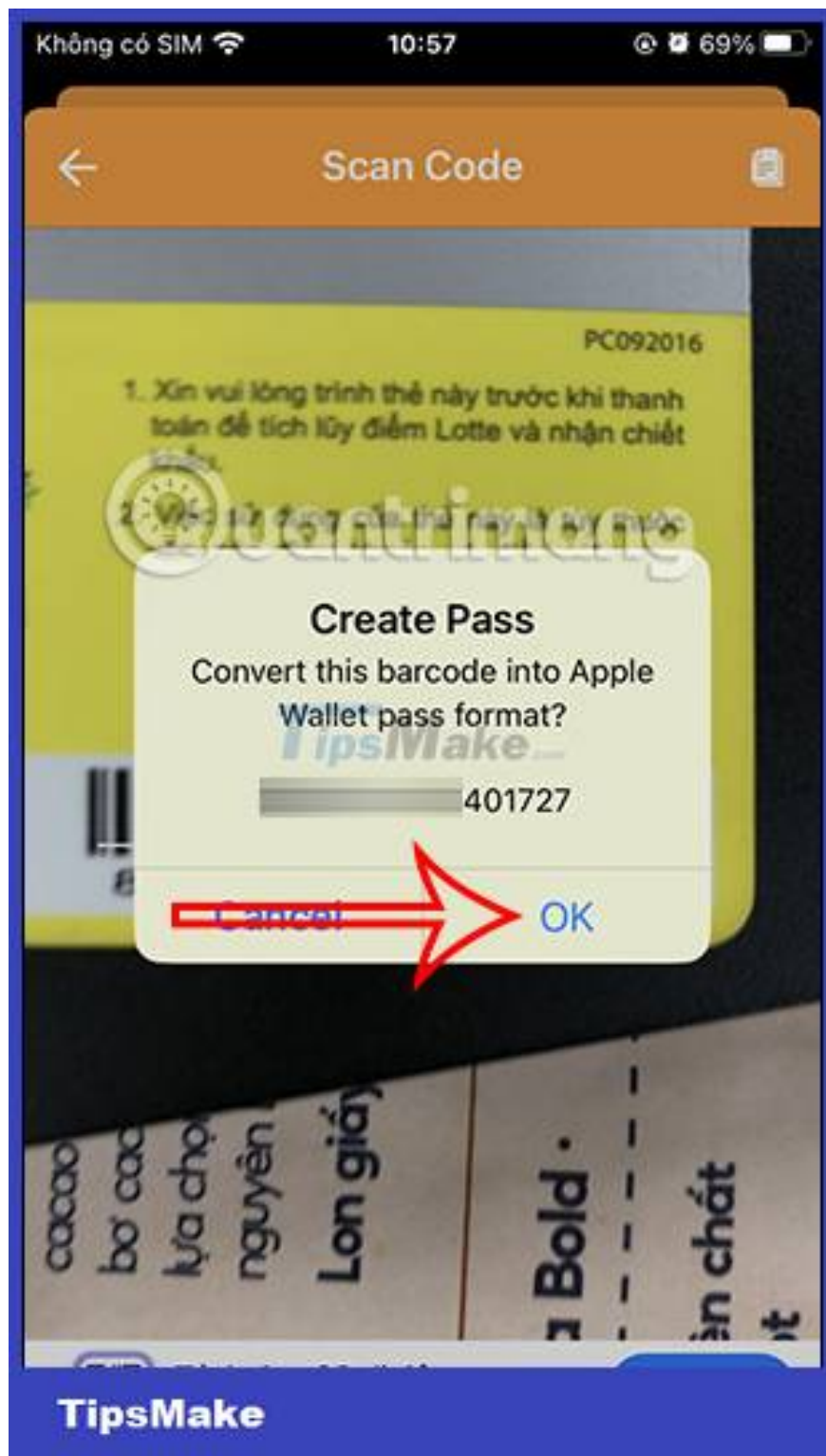

Step 3:

Next, click Store Card to save or select the card types below. Displays the interface so you can adjust the interface as well as add other information to the card.



Create Pass

Done

Category

None >

Barcode Content

Hidden >

Pass Type

Store Card >

Please choose a pass type

Boarding Pass

Coupon

Event Ticket

Store Card

Generic

tap to change color

Cancel



Create Pass

Done

Category

None >

Barcode Content

Hidden >

Pass Type

Store Card >

Pass Name



Reminder Icon (Required)

The image will be displayed with the lock screen message.



*The best size is 76x76 pixels.

Logo Text

Background

Label

Foreground

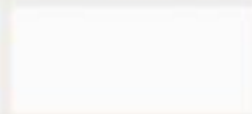

Tap to change color.

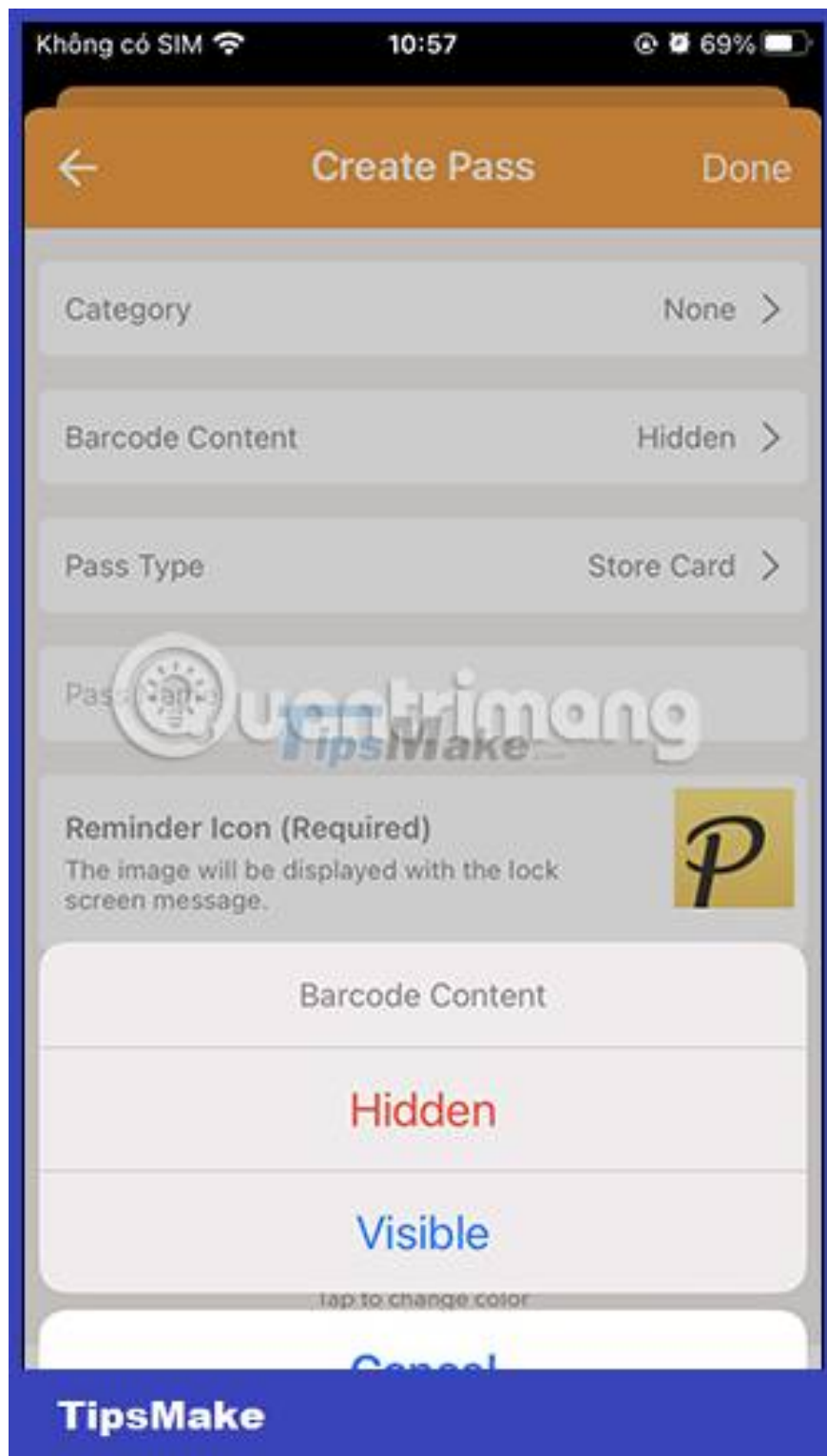

After adding information, click Done in the upper right corner to add and save card information.

Không có SIM

10:58

69%



Create Pass

Done

Category

None >

Background



Passcode

111

#5B4947

TipsMake...



Red

The

scr



*The



Lo

Confirm

Background

Level

Foreground

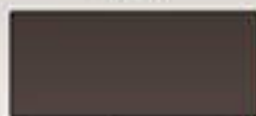

Tap to change color

TipsMake

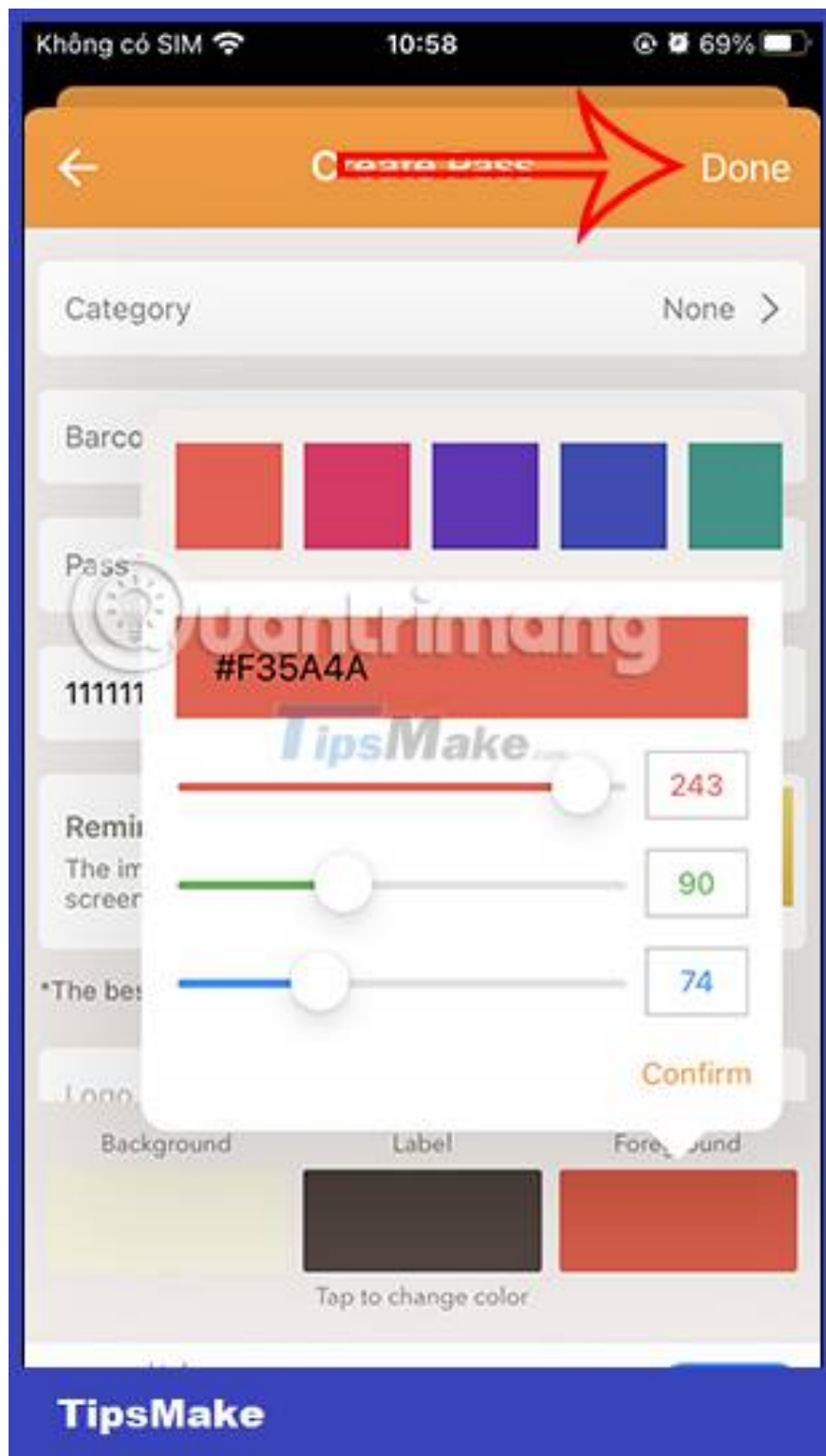

Step 4:

As a result, you will see the card along with the card display interface. Click Add in the upper right corner to add the card to Pass2U and Apple Wallet. We continue to press the plus icon to add another card if desired.

Click on the card added on Pass2U, then click on Wallet to immediately access the Apple Wallet application.

Không có SIM

10:59

69%

Hủy

11111

Thêm



TipsMake



You will immediately be transferred to the Apple Wallet application interface with the saved card photo. Click the 3-dot icon to choose to delete this card in Apple Wallet if desired.

Xong



TipsMake



Now you just need to access the Apple Wallet app to open card information, including cards that do not have additional support from Pass2U.



You finished reading the article "**How to add unsupported cards to Apple Wallet**" edited by the [TipsMake](#) team. We hope this article has provided you with many useful tech tips and tricks. You can search for similar articles on tips and guides. Thank you for reading and for following us regularly.